

Change Order

No. 1

Date of Issuance: _____ Effective Date: _____

Project: Mulberry Street Roadway and Sidewalk Improvements	Owner: Town of Shallotte	Owner's Contract No.:
Contract: Mulberry Street Roadway and Sidewalk Improvements		Date of Contract: August 7, 2024
Contractor: J.P. Russ & Son, INC.		Engineer's Project No.: 22.07019

The Contract Documents are modified as follows upon execution of this Change Order:

Description:

See work descriptions on attached Contractor's CO #1A, CO #1B, CO #2 and CO #3

Attachments (list documents supporting change):

See attached Contractor's CO #1A, CO #1B, CO #2 and CO #3

CHANGE IN CONTRACT PRICE:

Original Contract Price:

\$ 697,319.00

[Increase] [Decrease] from previously approved Change Orders No. _____ to No. _____

\$ 0.00

Contract Price prior to this Change Order:

\$ 697,319.00

(Increase) [Decrease] of this Change Order:

\$72,684.70 - \$35,000.00 (Allowance) = \$37,684.70

Contract Price incorporating this Change

\$ 735,003.70

CHANGE IN CONTRACT TIMES:

Original Contract Times: Working Calendar days

Substantial completion (days or date): 124

Ready for final payment (days or date): 138

[Increase] [Decrease] from previously approved Change Orders No. _____ to No. _____:

Substantial completion (days): _____

Ready for final payment (days): _____

Contract Times prior to this Change Order:

Substantial completion (days or date): 124

Ready for final payment (days or date): 138

[Increase] [Decrease] of this Change Order:

Substantial completion (days or date): _____

Ready for final payment (days or date): _____

Contract Times with all approved Change Orders:

Substantial completion (days or date): 124

Ready for final payment (days or date): 138

~~RECOMMENDED:~~

By: [Signature]
Engineer (Authorized Signature)

Date: 4/23/26

Approved by Funding Agency (if applicable): _____

ACCEPTED:

By: _____
Owner (Authorized Signature)

Date: _____

ACCEPTED:

By: [Signature]
Contractor (Authorized Signature)

Date: April 23, 2026

Date: _____



5621 Beach Dr SW
 Ocean Isle, NC 28469
 Phone (910) 754-6023 Fax (910) 754-5860

CHANGE ORDER

DATE September 18, 2024
CO # 1A
Job Name MULBERRY ST
 IMPROVEMENTS

Submitted To:
 McGill Associates
 712 Village Rd SW, Ste 103
 Shallotte, NC 28470

Proposal valid until: **October 15, 2025**
Prepared by: Aaron Black

Comments or special instructions:

Description	AMOUNT
Upsize culvert crossing pipe from 36" to 42":	
1. 42" HPP vs 36" HPP, 80 LF @ \$25 / LF	2,000.00
2. 4X6 PRECAST BOX VS. 3X5 PRECAST BOX, 2 @ \$1700	3,400.00
3. ADDITIONAL RETAINING WALL - 15 SF @ \$140	2,100.00
4. ENDWALL FOR DOUBLE 42" VS DOUBLE 36"	1,750.00
5. 6" #57 STONE BEDDING & BACKFILL TO SPRINGLINE IN LIEU OF STONE BASE - 40 TN @ \$60	2,400.00
6. EQUIPMENT (LARGER EXCAVATOR / RIGGING TO HANDLE ENDWALL) - \$500 / DAY X 5	2,500.00
7. PERMIT COST	1,500.00
8. BOND EXPENSE	313.00
TOTAL	\$ 15,963.00

Notes:

Payment to be made as follows: *Net upon receipt of invoice with a 1 1/2% monthly service charge on accounts over thirty (30) days past due which is an 18% annual rate*

All material is guaranteed to be as specified. All work to be completed in a workmanlike manner according to standard practices. Any alteration or deviation from above specifications involving **Authorized Signature** _____

extra costs will be executed upon written orders and will become an extra charge over and above

the estimate. All agreements contingent upon strikes, accidents of delays beyond our control.

Owner to carry fire, tornado and other necessary insurance.

Our worker's are fully covered by Workman's Compensation Insurance.

Acceptance of Proposal

The above prices, specifications, and conditions are satisfactory and hereby accepted.

You are authorized to do the work as specified. Payment will be made as outlined above.

Signature
Date of Acceptance



CHANGE ORDER

5621 Beach Dr SW
 Ocean Isle, NC 28469
 Phone (910) 754-6023 Fax (910) 754-5860

DATE September 15, 2025
CO # 1B
Job Name MULBERRY ST
 IMPROVEMENTS

Submitted To:
 McGill Associates
 712 Village Rd SW, Ste 103
 Shallotte, NC 28470

Proposal valid until: **October 15, 2025**
Prepared by: Aaron Black

Comments or special instructions:

Description	AMOUNT
Cost adjustments:	
1. 9.24.24 - spot utilities for surveyor (9 hrs x 5 man crew)	2,700.00
2. 11.22.24 - surveyor (retaining wall layout, horizontal / vertical location of water utilities)	1,300.00
2. Concrete cost increase	7,770.00
3. Stone base cost increase (1320 tn x \$3 / tn)	3,960.00
4. Asphalt increase (580 tn x \$5 / tn)	2,900.00
5. Fence increase (260 lf x \$3.50 / lf)	920.00
6. GC Markup (subs only) - 10%	1,685.00
7. Bond Expense (all items) - 2%	424.70
TOTAL	\$ 21,659.70

Notes:

Payment to be made as follows: *Net upon receipt of invoice with a 1 1/2% monthly service charge on accounts over thirty (30) days past due which is an 18% annual rate*

All material is guaranteed to be as specified. All work to be completed in a workmanlike manner according to standard practices. Any alteration or deviation from above specifications involving extra costs will be executed upon written orders and will become an extra charge over and above the estimate. All agreements contingent upon strikes, accidents of delays beyond our control.
 Owner to carry fire, tornado and other necessary insurance.
 Our worker's are fully covered by Workman's Compensation Insurance.

Authorized Signature _____

Acceptance of Proposal

The above prices, specifications, and conditions are satisfactory and hereby accepted.
 You are authorized to do the work as specified. Payment will be made as outlined above.

Signature
Date of Acceptance



CHANGE ORDER

5621 Beach Dr SW
 Ocean Isle, NC 28469
 Phone (910) 754-6023 Fax (910) 754-5860

DATE March 17, 2026
 CO # 2
 Job Name MULBERRY ST IMPROVEMENTS

Submitted To:
 McGill Associates
 712 Village Rd SW, Ste 103
 Shallotte, NC 28470

Proposal valid until: **April 16, 2026**
 Prepared by: Aaron Black

Comments or special instructions:
PER TERRACON SPECIAL INSPECTIONS

Description	AMOUNT
UNDERCUT DUE TO UNSUITABLE SOILS	
1. Terracon Report K6241068.0002, service date 2/09/2026: 3.4 cy undercut & replace w/ #57 granite	
2A. Terracon Report K6241068.0003, service date 2/10/2026: 17.8 cy undercut & replace w/ #57 granite	
2B. Terracon Report K6241068.0003, service date 2/10/2026: 58.7 sy geotextile fabric	
2C. Terracon Report K6241068.0003, service date 2/10/2026: 17.8 cy undercut & replace w/ #57 granite	
2D. Terracon Report K6241068.0003, service date 2/10/2026: 58.7 sy geotextile fabric	
2E. Terracon Report K6241068.0003, service date 2/10/2026: 7.6 cy undercut & replace w/ #57 granite	
2F. Terracon Report K6241068.0003, service date 2/10/2026: 36.5 sy geotextile fabric	
3A. Terracon Report K6241068.0004, service date 2/11/2026: 7.4 cy undercut & replace w/ #57 granite	
3B. Terracon Report K6241068.0004, service date 2/11/2026: 26.6 sy geotextile fabric	
3C. Terracon Report K6241068.0004, service date 2/11/2026: 3.7 cy undercut & replace w/ #57 granite	
3D. Terracon Report K6241068.0004, service date 2/11/2026: 17.7 sy geotextile fabric	
TOTALS:	
A. 57.7 CY UNDERCUT & EXPORT @ \$15 / CY	865.50
B. #57 GRANITE 80 TN IMPORT @ \$70 / TN	5,600.00
C. FILTER FABRIC, 1 ROLL (198.2 SY) @ \$378	378.00
D. LABOR & EQUIPMENT, 4 MAN CREW W/ EXCAVATOR 15 HRS @ \$290	4,350.00
E. BOND EXPENSE @ 2%	223.50
TOTAL	\$ 11,417.00

Notes:

Payment to be made as follows:

*Net upon receipt of invoice with a 1 1/2% monthly service charge on accounts
 over thirty (30) days past due which is an 18% annual rate*

All material is guaranteed to be as specified. All work to be completed in a workmanlike manner according to standard practices. Any alteration or deviation from above specifications involving extra costs will be executed upon written orders and will become an extra charge over and above the estimate. All agreements contingent upon strikes, accidents of delays beyond our control. Owner to carry fire, tornado and other necessary insurance. Our worker's are fully covered by Workman's Compensation Insurance.

Authorized Signature _____

Acceptance of Proposal

The above prices, specifications, and conditions are satisfactory and hereby accepted.
 You are authorized to do the work as specified. Payment will be made as outlined above.

Signature
Date of Acceptance

FOUNDATION OBSERVATIONS REPORT

Report Number: K6241068.0002
Service Date: 02/09/26
Report Date: 02/16/26
Task: Retaining Wall - soils, reinforced concrete & special inspections



2108 Capital Dr, Ste 103
Wilmington, NC 28405-6477
910-478-9915

Client

Town of Shallotte NC
Attn: Mimi Gaither
PO Box 2287
Shallotte, NC 28470

Project

Mulberry Street RT Wall
120 Mulberry Street
Shallotte, NC 28470

Project Number: K6241068

General Information

Brad Stanley requested Terracon to be on site for Foundation Observations. Work is being performed by JP Russ. The results of observation(s) for today were reported to Frankie with JP Russ and Brad Stanley. The Terracon representative arrived on site at 1245 and departed at 1430.

The construction documents referenced for this observation include: Geotechnical

Geotechnical engineering report No. 22:34128.R1 01/24/2024 prepared by ECS.

Foundation and Soil Bearing Information

The near surface bearing materials were evaluated at the foundation(s) listed below. Bearing materials observed at the time of our visit were assumed to be at design bearing elevation unless noted otherwise. The bearing materials were evaluated utilizing the following method(s): visual observation, dynamic cone penetrometer (DCP). Terracon observed the foundation(s) detailed below for the following items (as applicable): bearing pressure, bearing strata, size, and cleanliness.

Design Bearing Pressure(s) (psf) = 1500

Test No./Element/ Location	Test Results	Bearing Strata	Status	Comments
(1) Isolated Footing(s)/ North side of footing	BOF: 12,11,15+ -1: 11,15+ -2: 15+ -3: AR	Brown Silty Sand	Complies (after remediation)	Undercut: 14' Length X 6.5' Width X 1' Depth = 91cf/27 = 3.4cy
(2) Isolated Footing(s)/ South end of footing	BOF: 10,1,2 -1: 11,15+ -2: AR	Brown Silty Sand	Complies (after remediation)	None

**N/A = "Not Applicable"

Additional Comments

Water was being pumped during testing as it was running in from the side of the footing. Terracon recommends undercutting 1' of material and replacing with washed stone as water is continuing to pool due to elevation of -1.3' below the water table.

Evaluation and testing of foundation bearing materials typically consist of observation of the subgrade soils along with sampling and testing the soils to shallow depths below the assumed design bearing elevation at the location(s) indicated above. Small hand-operated equipment is typically used. As such, the results are limited by the means and methods used to obtain them. It should be noted that soil conditions not readily identified by these means may affect foundation performance.

Terracon is providing undercut quantities for information only. We cannot authorize additional cost. Any additional cost due to undercutting should be authorized by the owners prior to undercutting.

Compliance Statement

Based on our observations of the foundation excavation(s), if the near-surface bearing materials remain consistent with depth, the foundation excavation(s) at the above reference location(s) appear to be in general accordance with the project plans and specifications.

Services:

Terracon Rep.: Eli Haines
Reported To: Brad Stanley
Contractor: JP Russ
Report Distribution:

(1) Town of Shallotte NC, Mimi Gaither (1) JP Russ & Son Inc, Aaron Black
(1) JP Russ & Son Inc, Brad Stanley

Reviewed By:
rvw2: rdp

Ryan Poirier
Department Manager

The tests were performed in general accordance with applicable ASTM, AASHTO, or DOT test methods. This report is exclusively for the use of the client indicated above and shall not be reproduced except in full without the written consent of our company. Test results transmitted herein are only applicable to the actual samples tested at the location(s) referenced and are not necessarily indicative of the properties of other apparently similar or identical materials.

Photo Log

Report Number: K6241068.0002
Service Date: 02/09/26
Report Date: 02/16/26
Task: Retaining Wall - soils, reinforced concrete & special inspections



2108 Capital Dr, Ste 103
Wilmington, NC 28405-6477
910-478-9915



(P1) South end of wall



(P2) North end of wall

Photo Log

Report Number: K6241068.0002
Service Date: 02/09/26
Report Date: 02/16/26
Task: Retaining Wall - soils, reinforced concrete & special inspections



2108 Capital Dr, Ste 103
Wilmington, NC 28405-6477
910-478-9915



(P3) Footing



(P4) Footing on arrival



Exhibit	A-1
	Mulberry Street RT Wall
Foundation Observations	

Terracon
 2108 Capital Dr, Ste 103
 910-478-9915
 Wilmington, NC
 28405-6477
 terracon.com

Report Number: K6241068.0002
 Service Date: 02/09/2026
 Employee: Haines, Eli
 Scale: Refer to Drawing

Test

- Retested / Accepted
- Deviation

FOUNDATION OBSERVATIONS REPORT

Report Number: K6241068.0003
Service Date: 02/10/26
Report Date: 02/16/26
Task: Retaining Wall - soils, reinforced concrete & special inspections



2108 Capital Dr, Ste 103
 Wilmington, NC 28405-6477
 910-478-9915

Client

Town of Shallotte NC
 Attn: Mimi Gaither
 PO Box 2287
 Shallotte, NC 28470

Project

Mulberry Street RT Wall
 120 Mulberry Street
 Shallotte, NC 28470

Project Number: K6241068

General Information

Brad Stanley requested Terracon to be on site for Foundation Observations. Work is being performed by JP Russ. The results of observation(s) for today were reported to Frankie with JP RUSS. The Terracon representative arrived on site at 1045 and departed at 1315.

The construction documents referenced for this observation include: ECS project# 22:34128.R1 dated 1/24/2024.

Geotechnical engineering report No. 22:34128.R1 dated 1/24/2024 prepared by ECS.

Foundation and Soil Bearing Information

The near surface bearing materials were evaluated at the foundation(s) listed below. Bearing materials observed at the time of our visit were assumed to be at design bearing elevation unless noted otherwise. The bearing materials were evaluated utilizing the following method(s): visual observation, dynamic cone penetrometer (DCP). Terracon observed the foundation(s) detailed below for the following items (as applicable): bearing pressure, bearing strata, size, and cleanliness.

Design Bearing Pressure(s) (psf) = 1500

Test No./Element/ Location	Test Results	Bearing Strata	Status	Comments
(1) Continuous Footing(s)/ South end of Northwest retaining wall footings	BOF: 1, 1, 3 -1: 1, 2, 3 -2: 4, 4, 5 -3: 3, 3, 4	Moist Brown clay Existing Subgrade	Complies (after remediation)	Undercut: 48' Length X 5' Width x 2' Depth = 480cf/27 = 17.8cy Geotextile Fabric: 48' Length x 2' Depth = 96sf/9 = 10.7sy (sides) x2 = 21.3sy 48' Length x 5' Width = 240sf/9 = 26.7sy (bottom)
(2) Continuous Footing(s)/ South end of Northwest retaining wall footings	BOF: 2, 2, 2 -1: 2, 2, 3 -2: 2, 3, 4 -3: 7, 12, 13	Moist Brown clay Existing Subgrade	Complies (after remediation)	Undercut: 48' Length X 5' Width x 2' Depth = 480cf/27 = 17.8cy Geotextile Fabric: 48' Length x 2' Depth = 96sf/9 = 10.7sy (sides) x2 = 21.3sy 48' Length x 5' Width = 240sf/9 = 26.7sy (bottom)
(3) Continuous Footing(s)/ North end of Northwest retaining wall footings	BOF: 2, 3, 5 -1: 3, 4, 8 -2: 10, 11, 7 -3: 2, 2, 3	Wet Grey clay Existing Subgrade	Complies (after remediation)	Undercut: 41' Length X 5' Width x 1' Depth = 205cf/27 = 7.6cy Geotextile Fabric: 41' Length x 1' Depth = 41sf/9 = 4.6sy (sides) x2 = 9.1sy 41' Length x 5' Width = 205sf/9 = 22.8sy (bottom)

**N/A = "Not Applicable"

FOUNDATION OBSERVATIONS REPORT



Report Number: K6241068.0003
Service Date: 02/10/26
Report Date: 02/16/26
Task: Retaining Wall - soils, reinforced concrete & special inspections

2108 Capital Dr, Ste 103
Wilmington, NC 28405-6477
910-478-9915

Client

Town of Shallotte NC
Attn: Mimi Gaither
PO Box 2287
Shallotte, NC 28470

Project

Mulberry Street RT Wall
120 Mulberry Street
Shallotte, NC 28470

Project Number: K6241068

Additional Comments

In area(s) 1, 2, and 3, Terracon recommends a 1 undercut and replacing with washed stone with fabric on the bottom and sides of footing.

Evaluation and testing of foundation bearing materials typically consist of observation of the subgrade soils along with sampling and testing the soils to shallow depths below the assumed design bearing elevation at the location(s) indicated above. Small hand-operated equipment is typically used. As such, the results are limited by the means and methods used to obtain them. It should be noted that soil conditions not readily identified by these means may affect foundation performance.

Terracon is providing undercut quantities for information only. We cannot authorize additional cost. Any additional cost due to undercutting should be authorized by the owners prior to undercutting.

Compliance Statement

Based on our observations of the foundation excavation(s), if the near-surface bearing materials remain consistent with depth, the foundation excavation(s) at the above reference location(s) appear to be in general accordance with the project plans and specifications.

Services:

Terracon Rep.: Sekou Alexander

Reported To: Frankie with JP RUSS

Contractor: JP Russ

Report Distribution:

(1) Town of Shallotte NC, Mimi Gaither (1) JP Russ & Son Inc, Aaron Black

(1) JP Russ & Son Inc, Brad Stanley

Reviewed By:

rvw2: rdp

Ryan Poirier
Department Manager

The tests were performed in general accordance with applicable ASTM, AASHTO, or DOT test methods. This report is exclusively for the use of the client indicated above and shall not be reproduced except in full without the written consent of our company. Test results transmitted herein are only applicable to the actual samples tested at the location(s) referenced and are not necessarily indicative of the properties of other apparently similar or identical materials.

Photo Log

Report Number: K6241068.0003
Service Date: 02/10/26
Report Date: 02/16/26
Task: Retaining Wall - soils, reinforced concrete & special inspections



2108 Capital Dr, Ste 103
Wilmington, NC 28405-6477
910-478-9915



(P1) North end of Northwest retaining wall footing



(P2) South end of Northwest retaining wall



Mulberry Street RT Wall	Exhibit
	A-1
Foundation Observations	

Terracon
 2108 Capital Dr, Ste 103
 910-478-9915

Wilmington, NC
 28405-6477
 terracon.com

Report Number: K6241068.0003
 Service Date: 02/10/2026
 Employee: Alexander, Sekou
 Scale: Refer to Drawing

- Test
- Retested / Accepted
 - Deviation

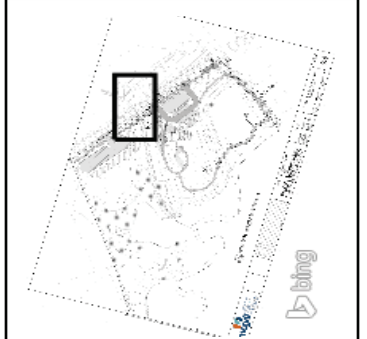

FOUNDATION OBSERVATIONS REPORT

Report Number: K6241068.0004
Service Date: 02/11/26
Report Date: 02/16/26
Task: Retaining Wall - soils, reinforced concrete & special inspections



2108 Capital Dr, Ste 103
 Wilmington, NC 28405-6477
 910-478-9915

Client

Town of Shallotte NC
 Attn: Mimi Gaither
 PO Box 2287
 Shallotte, NC 28470

Project

Mulberry Street RT Wall
 120 Mulberry Street
 Shallotte, NC 28470

Project Number: K6241068

General Information

Brad Stanley requested Terracon to be on site for Foundation Observations. Work is being performed by JP Russ. The results of observation(s) for today were reported to Brad Stanley. The Terracon representative arrived on site at 1345 and departed at 1545.

The construction documents referenced for this observation include: ECS Report# 22:34128.R1 dated 01/24/2024.

Geotechnical engineering report No. 22:34128.R1 dated 1/24/2024 prepared by ECS.

Foundation and Soil Bearing Information

The near surface bearing materials were evaluated at the foundation(s) listed below. Bearing materials observed at the time of our visit were assumed to be at design bearing elevation unless noted otherwise. The bearing materials were evaluated utilizing the following method(s): visual observation, dynamic cone penetrometer (DCP). Terracon observed the foundation(s) detailed below for the following items (as applicable): bearing pressure, bearing strata, size, and cleanliness.

Design Bearing Pressure(s) (psf) = 1500

Test No./Element/ Location	Test Results	Bearing Strata	Status	Comments
(1) Continuous Footing(s)/ North end of Northwest retaining wall	BOF: 2, 2, 3 -1: 3, 3, 4 -2: 3, 6, 12 -3: 3, 6, 12	Dark Brown Silty Clay Existing Subgrade	Complies (After Remediation)	Undercut: 40' Length X 5' Width x 1' Depth = 200cf/27 = 7.4cy Geotextile Fabric: 40' Length x 1' Depth = 40sf/9 = 4.4sy (sides) x2 = 8.9sy 40' Length x 5' Width = 200sf/9 = 22.2sy (bottom)
(2) Continuous Footing(s)/ South end of Northwest retaining wall	BOF: 1, 1, 3 -1: 3, 4, 5 -2: 3, 4, 7 -3: 2, 2, 3	Moist Gray Clay Existing Subgrade	Complies (After Remediation)	Undercut: 20' Length X 5' Width x 1' Depth = 100cf/27 = 3.7cy Geotextile Fabric: 20' Length x 1' Depth = 20sf/9 = 2.2sy (sides) x2 = 4.4sy 20' Length x 5' Width = 100sf/9 = 11.1sy (bottom)

**N/A = "Not Applicable"

Additional Comments

In area(s) 1 & 2, Terracon recommends a 1' undercut and replacing with washed stone with fabric on the bottom and sides of footing.

Evaluation and testing of foundation bearing materials typically consist of observation of the subgrade soils along with sampling and testing the soils to shallow depths below the assumed design bearing elevation at the location(s) indicated above. Small hand-operated equipment is typically used. As such, the results are limited by the means and methods used to obtain them. It should be noted that soil conditions not readily identified by these means may affect foundation performance.

Terracon is providing undercut quantities for information only. We cannot authorize additional cost. Any additional cost due to undercutting should be authorized by the owners prior to undercutting.

FOUNDATION OBSERVATIONS REPORT



Report Number: K6241068.0004
Service Date: 02/11/26
Report Date: 02/16/26
Task: Retaining Wall - soils, reinforced concrete & special inspections

2108 Capital Dr, Ste 103
Wilmington, NC 28405-6477
910-478-9915

Client

Town of Shallotte NC
Attn: Mimi Gaither
PO Box 2287
Shallotte, NC 28470

Project

Mulberry Street RT Wall
120 Mulberry Street
Shallotte, NC 28470

Project Number: K6241068

Compliance Statement

Based on our observations of the foundation excavation(s), if the near-surface bearing materials remain consistent with depth, the foundation excavation(s) at the above reference location(s) appear to be in general accordance with the project plans and specifications.

Services:

Terracon Rep.: Sekou Alexander

Reported To: Brad Stanley

Contractor: JP Russ

Report Distribution:

(1) Town of Shallotte NC, Mimi Gaither (1) JP Russ & Son Inc, Aaron Black

(1) JP Russ & Son Inc, Brad Stanley

Reviewed By:

rvw2: rdp



Ryan Poirier
Department Manager

The tests were performed in general accordance with applicable ASTM, AASHTO, or DOT test methods. This report is exclusively for the use of the client indicated above and shall not be reproduced except in full without the written consent of our company. Test results transmitted herein are only applicable to the actual samples tested at the location(s) referenced and are not necessarily indicative of the properties of other apparently similar or identical materials.

Photo Log

Report Number: K6241068.0004
Service Date: 02/11/26
Report Date: 02/16/26
Task: Retaining Wall - soils, reinforced concrete & special inspections



2108 Capital Dr, Ste 103
Wilmington, NC 28405-6477
910-478-9915



(P1) North end of Northwest retaining wall



(P2) South end of Northwest retaining wall

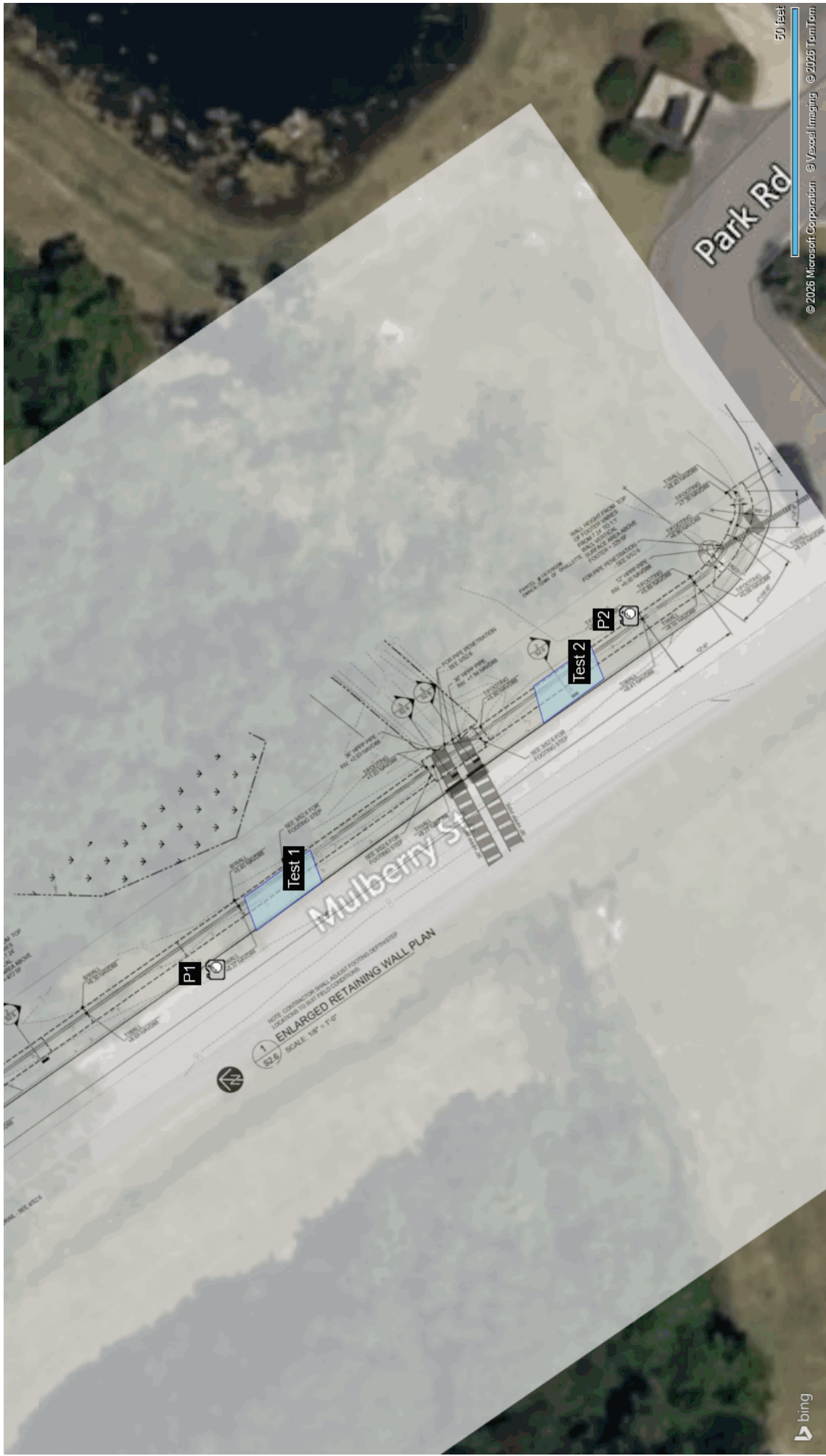

Mulberry Street RT Wall	Exhibit
	A-1
Foundation Observations	

Terracon
 2108 Capital Dr, Ste 103
 910-478-9915

Wilmington, NC
 28405-6477
 terracon.com

Report Number: K6241068.0004	Service Date: 02/11/2026	Employee: Alexander, Sekou	Scale: Refer to Drawing
---------------------------------	-----------------------------	-------------------------------	----------------------------

Test

- Test
- Retested / Accepted
- Deviation



5621 Beach Dr SW
 Ocean Isle, NC 28469
 Phone (910) 754-6023 Fax (910) 754-5860

CHANGE ORDER REQUEST

DATE April 15, 2026
CO # 3
Job Name MULBERRY ST IMPROVEMENTS

Submitted To:
 McGill Associates
 712 Village Rd SW, Ste 103
 Shallotte, NC 28470

Proposal valid until: **May 16, 2026**
Prepared by: Aaron Black

Comments or special instructions:

Description	AMOUNT
Misc Items per Town / Engineer Request:	
1. Armor slope around precast headwall & ditch bottom from headwall to new parking lot entrance w/ Class B Rip Rap (70 tn) underlain w/ filter fabric (+/- 1125 sf)	12,250.00
2. Demo & replace damaged sidewalk / driveway apron from end of CIP wall north +/- 67 lf (6" concrete @ apron, 4" otherwise) - +/- 360 sf	4,680.00
3. Add 6" w X 12" h curb along park side of sidewalk (monolithic pour with balance of sidewalk) - 250 lf	6,250.00
4. Bond expense	465.00
TOTAL	\$ 23,645.00

Notes:

Payment to be made as follows: *Net upon receipt of invoice with a 1 1/2% monthly service charge on accounts over thirty (30) days past due which is an 18% annual rate*

All material is guaranteed to be as specified. All work to be completed in a workmanlike manner according to standard practices. Any alteration or deviation from above specifications involving extra costs will be executed upon written orders and will become an extra charge over and above the estimate. All agreements contingent upon strikes, accidents of delays beyond our control. Owner to carry fire, tornado and other necessary insurance. Our worker's are fully covered by Workman's Compensation Insurance.

Authorized Signature _____

Acceptance of Proposal

The above prices, specifications, and conditions are satisfactory and hereby accepted.
 You are authorized to do the work as specified. Payment will be made as outlined above.

Signature
Date of Acceptance