

**CITY OF SHEBOYGAN  
R. O. 41-23-24**

**BY CITY CLERK.**

**SEPTEMBER 18, 2023.**

Submitting a claim from Holly L. Puchniarz for alleged damages to her vehicle.

DATE RECEIVED

9-5-23

RECEIVED BY

MKC

SEP 05 2023

CLAIM NO.

8-23

CITY OF SHEBOYGAN NOTICE OF DAMAGE OR INJURY

**INSTRUCTIONS: TYPE OR PRINT IN BLACK INK**

1. Notice of death, injury to persons or to property must be filed not later than 120 days after the occurrence.
2. Attach and sign additional supportive sheets, if necessary.
3. This notice form must be signed and filed with the Office of the City Clerk.

**4. TWO ESTIMATES MUST BE ATTACHED IF YOU ARE CLAIMING DAMAGE TO A VEHICLE.**

1. Name of Claimant: Holly L Puchniarz
2. Home address of Claimant: 1443 S 9th St Sheboygan WI 53081
3. Home phone number: 920-917-0999
4. Business address and phone number of Claimant: 535 S Taylor Dr  
Sheboygan WI 53081, 920-457-1095
5. When did damage or injury occur? (date, time of day) 8/3/2023, 6:30 pm
6. Where did damage or injury occur? (give full description) 1504 Illinois  
Ave Sheboygan WI 53081, South Side of  
Street during wind storm
7. How did damage or injury occur? (give full description) Wind storm took  
down tree that was previously cracked,  
in result totaled out my Pontiac G6
8. If the basis of liability is alleged to be an act or omission of a City officer or employee, complete the following:
  - (a) Name of such officer or employee, if known: \_\_\_\_\_
  - (b) Claimant's statement of the basis of such liability: \_\_\_\_\_
9. If the basis of liability is alleged to be a dangerous condition of public property, complete the following:
  - (a) Public property alleged to be dangerous: Tree has branches  
currently hanging by bark ready to break, city tree
  - (b) Claimant's statement of basis for such liability: \_\_\_\_\_

10. Give a description of the injury, property damage or loss, so far as is known at this time. (If there were no injuries, state "NO INJURIES").

No Injuries. Property damage - Car was  
Totaled out

11. Name and address of any other person injured: \_\_\_\_\_

12. Damage estimate: (You are not bound by the amounts provided here.)

Auto:

\$8,485.47 | total loss

Property:

\$ \_\_\_\_\_

Personal injury:

\$ \_\_\_\_\_

Other: (Specify below)

\$ \_\_\_\_\_

**TOTAL**

\$8,485.47

Damaged vehicle (if applicable)

Make: Pontiac Model: G6 Year: 2006 Mileage: 207,498

Names and addresses of witnesses, doctors and hospitals: Cheryl Foss  
1504 Monis Ave Sheboygan WI 53081

FOR ALL ACCIDENT NOTICES, COMPLETE THE FOLLOWING DIAGRAM IN DETAIL. BE SURE TO INCLUDE NAMES OF ALL STREETS, HOUSE NUMBERS, LOCATION OF VEHICLES, INDICATING WHICH IS CITY VEHICLE (IF APPLICABLE), WHICH IS CLAIMANT VEHICLE, LOCATION OF INDIVIDUALS, ETC.

NOTE: If diagrams below do not fit the situation, attach proper diagram and sign.

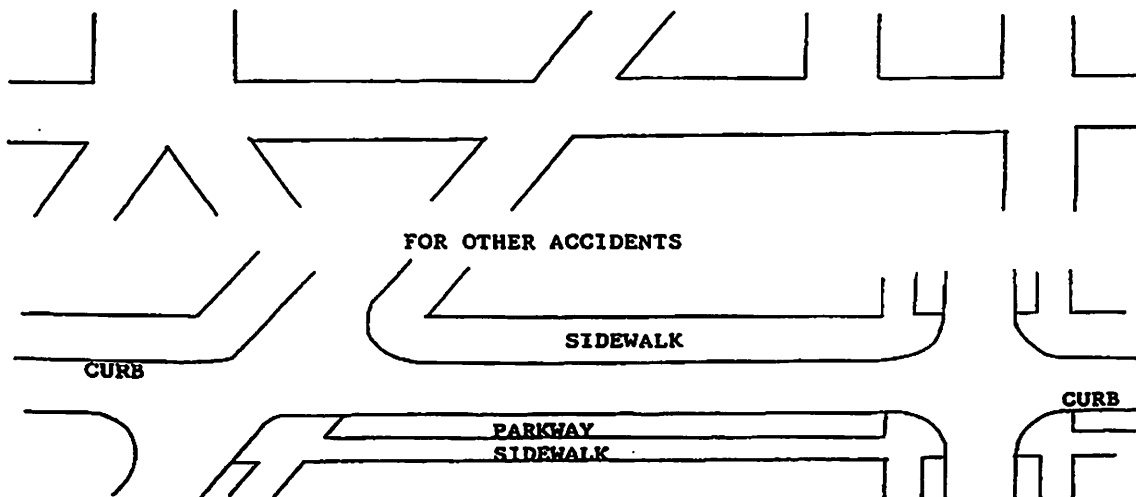

SIGNATURE OF CLAIMANT

Dee Perry

DATE

8/30/23

DATE RECEIVED \_\_\_\_\_

RECEIVED BY \_\_\_\_\_

CLAIM NO. \_\_\_\_\_

CLAIM

Claimant's Name: Holly L Puchniarz Auto \$ 8,485.47  
Claimant's Address: 1443 S 9th St Property \$ \_\_\_\_\_  
Sheboygan WI 53081 Personal Injury \$ \_\_\_\_\_  
Claimant's Phone No. 920.917.0999 Other (Specify below) \$ \_\_\_\_\_  
TOTAL \$ \_\_\_\_\_

PLEASE INCLUDE COPIES OF ALL BILLS, INVOICES, ESTIMATES, ETC.

WARNING: IT IS A CRIMINAL OFFENSE TO FILE A FALSE CLAIM.  
(WISCONSIN STATUTES 943.395)

The undersigned hereby makes a claim against the City of Sheboygan arising out of the circumstances described in the Notice of Damage or Injury. The claim is for relief in the form of money damages in the total amount of \$ 8,485.47.

SIGNED

Holly Puchniarz

DATE:

8/30/23

ADDRESS:

1443

S 9th St

Sheboygan WI

53081

MAIL TO: CLERK'S OFFICE  
828 CENTER AVE  
SHEBOYGAN WI 53081



🔍 Search or type a URL

Tabs you've open    Frequently visited

🔍 diagram of illionois ave sheboygan wi - Search    Left tab

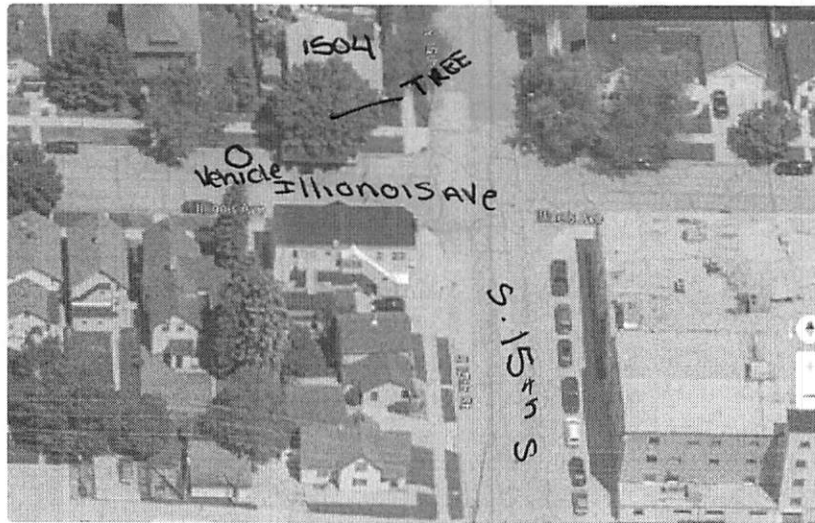

Blair  
Prest  
8/30/23

Illinois Ave, Sheboygan, WI 53081

Location: 43.7443367001791, -87.7104968999956

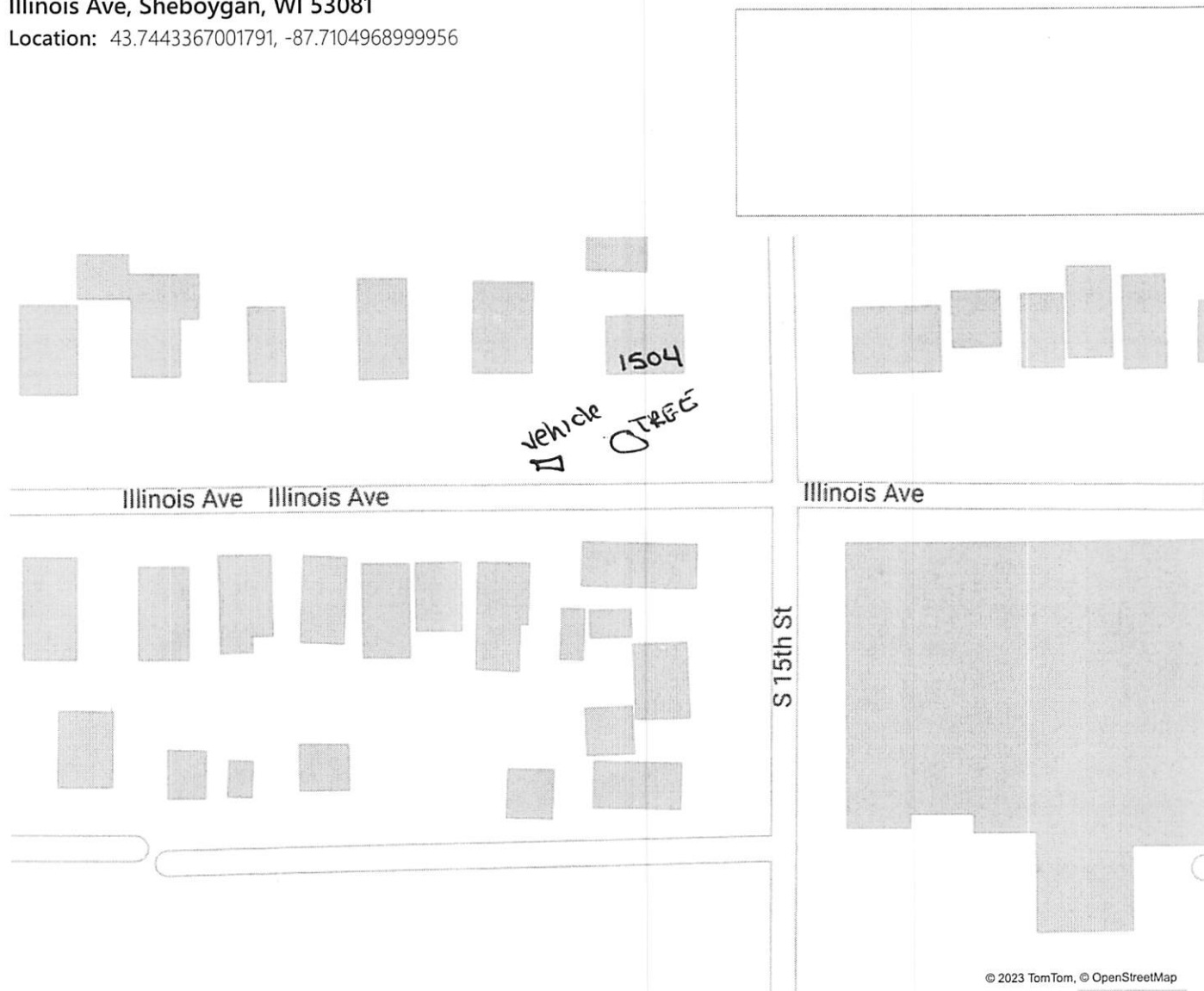

Kelly  
Perry  
8/30/23

ROBERT RUSCH, INC.  
1129 INDIANA AVENUE  
SHEBOYGAN, WI. 53081  
OFFICE:(920) 452-8681 FAX:(920) 452-8733

\*\*\* PRELIMINARY ESTIMATE \*\*\*

08/22/2023 09:07 AM

Owner

Owner: HOLLY PUCHNIAZ  
Address:

Cell: (920)917-0999

Inspection

Inspection Date: 08/22/2023 09:16 AM

Inspection Type:

Repairer

Repairer: Robert Rusch Inc.  
Address: 1129 Indiana Ave.  
City State Zip: Sheboygan, WI 53081  
Email: doldenburg@robertruschinc.com

Contact: David Oldenburg  
Work/Day: (920)452-8681  
FAX: (920)452-8733

Target Complete Date/Time:

Days To Repair: 21

Vehicle

OEM Part Price Quote ID: \*\*\*\*

2006 Pontiac G6 GTP 2 DR Coupe  
6cyl Gasoline 3.9  
4 Speed Automatic

Lic.Plates: ARD-4862  
Lic Expire:  
Veh Insp# :  
Condition:  
Ext. Color: SILVER  
Ext. Refinish: Two-Stage

Lic State: WI  
VIN: 1G2ZM171364158760  
Mileage Type: Actual  
Code: W3513D  
Int. Color:  
Int. Refinish: Two-Stage

Options

AM/FM CD Player  
Aluminum/Alloy Wheels  
Center Console  
Dual Airbags  
Keyless Entry System  
Power Door Locks  
Power Windows  
Sport Suspension  
Tachometer  
Tilt Steering Wheel  
Trip Computer

Air Conditioning  
Anti-Lock Brakes  
Climate Control For A/C  
Fog Lights  
Lighted Entry System  
Power Mirrors  
Rear Window Defroster  
Stability Cntrl Suspensn  
Telescopic Steering Whl  
Tinted Glass  
Velour/Cloth Seats

Alarm System  
Cargo/Trunk Net  
Cruise Control  
Intermittent Wipers  
Power Brakes  
Power Steering  
Rem Trunk-L/Gate Release  
Strg Wheel Radio Control  
Theft Deterrent System  
Traction Control System

Damages

Line	Op	Guide	MC	Description	MFR.Part No.	Price	ADJ%	B%	Hours	R
<b><u>Stripes And Mouldings</u></b>										
1	RI	243		Mldg,Front Door Side LT	R & I Assembly				0.4*	SM
2	RI	259		Mldg,Quarter Side LT	R & I Assembly				0.3*	SM
<b><u>Roof</u></b>										
3	I	341		Panel,Roof >> OPEN FOR REPLACEMENT	Repair				6.0*	SM
4	L	341		Panel,Roof	Refinish 2.5 Surface 0.5 Two-stage				3.0	RF
5	RI	120		Glass Panel,Roof	R & I Assembly				0.5	SM
6	RI	348		Mldg,Roof Side LT	R & I Assembly				INC	SM
7	RI	349		Mldg,Roof Side RT	R & I Assembly				0.3	SM
8	RI	883		Roof Headliner R & I	R & I Assembly				1.8	SM
<b><u>Front Doors</u></b>										
9	BR	207	13	Door Shell,Front LT	Blend Refinish 1.1 Blend 0.6 Two-stage setup 0.5 Two-stage				2.2	RF
10	RI	239		W/Strip,Belt Outer LT	R & I Assembly				0.2	SM
11	RI	229		Mirror,Outer R/C LT	R & I Assembly				0.7	SM
12	RI	227		Handle,Front Door Otr LT	R & I Assembly				0.2	SM
<b><u>Quarter And Rocker Panel</u></b>										
13	E	248	#	Panel Assy,Body Side LT # = 02, 07	25961283 GM Part	\$631.73			28.5	SM
14	L	248		Panel Assy,Body Side LT	Refinish 4.3 Surface 2.0 Edge 1.3 Two-stage				7.6	RF
15	NG	421		Glass,Quarter Tinted LT	NAGS DQ11002-GT	\$555.55			INC	SM
16	EC	410		Sealant Kit,Qtr Glass LT	Replace Economy	\$35.00*			INC	SM
<b><u>Inner Quarter &amp; Panels</u></b>										
17	TE	246	#	Panel,Bodyside Inner LT # = 02, 07	Partial Replace Price	\$630.70				SM
18	ET	427	07	Pnl,Quarter Inner LT	Partial Replace Labor				7.5	SM
19	L	427		Pnl,Quarter Inner LT	Refinish 0.6 Surface 0.1 Two-stage				0.7	RF
20	E	314	01	Pnl,Quarter Trim Uptr LT	15813316 GM Part	\$40.63			INC	SM
<b><u>Deck Lid And Back Glass</u></b>										
21	NG	369		Back Glass,Heated	NAGS DB11003-GT	\$530.48			2.2	SM
22	EC	370		Sealant Kit,Back Glass	Replace Economy	\$35.00*			INC	SM
23	EC	371		Mldg,Back Glass Upper	Replace Economy	\$35.00*			INC	SM
<b><u>Manual Entries</u></b>										
24	L			COVER CAR INTERIOR	Refinish	\$8.00*			0.3*	SM*
25	SB			HAZARD. WSTE. REM.	Sublet Repair	\$3.00				SM
26	L			CORROSION PROTECTION	Refinish				1.0*	RF
27	I			FRAME RACK/INCLUDE SET UP	Repair				3.5*	SM
				>> ROUGH PULL/PUSH BODY SIDE						
28	EC			BODY MATERIALS	Replace Economy	\$130.00*				SM*
				>> INCLUDES WELDING SUPPLIES, SEAM SEALERS ETC.						
28	Items									
				MC	Message					



01 CALL DEALER FOR EXACT PART # / PRICE  
02 PART NO. DISCONTINUED, CALL DEALER FOR EXACT PART NO.  
07 STRUCTURAL PART AS IDENTIFIED BY I-CAR  
13 INCLUDES 0.6 HOURS FIRST PANEL TWO-STAGE ALLOWANCE

### Estimate Total & Entries

OEM Parts		\$1,303.06	
Other Parts		\$1,329.03	
Paint & Materials	14.5 Hours @ \$50.00	\$725.00	
Parts & Material Total			\$3,357.09
Tax on Parts & Material	@ 5.500%		\$184.64

Labor	Rate	Replace Hrs	Repair Hrs	Total Hrs	
Sheet Metal (SM)	\$70.00	42.9	9.5	52.4	\$3,668.00
Mech/Elec (ME)	\$95.00				
Frame (FR)	\$85.00				
Refinish (RF)	\$70.00	14.5		14.5	\$1,015.00
Labor Total				66.9 Hours	\$4,683.00
Tax on Labor	@ 5.500%				\$257.57
Sublet Repairs					\$3.00
Tax on Sublet	@ 5.500%				\$0.17
Gross Total					\$8,485.47
Net Total					\$8,485.47

Alternate Parts Y/03/00/00/03/03 Cumulative 03/00/00/03/03 Zip Code: 53081 Audatex Host  
OEM Part Prices DT 08/22/2023 09:15 AM EstimateID 1123255256336048128 QuoteID \*\*\*\*  
Rate Name Default

Audatex Estimating 10.23.104 ES 08/22/2023 09:53 AM REL 10.23.104 DT 08/01/2023 DB 08/15/2023

State Disclosure: Not Selected

© 2023 Audatex North America, Inc.

3.0 HRS WERE ADDED TO THIS ESTIMATE BASED ON AUDATEX'S TWO-STAGE REFINISH FORMULA.

### Op Codes

* = User-Entered Value	^ = Labor Matches System Assigned Rates	E = Replace OEM
NG = Replace NAGS	EC = Replace Economy	OE = Replace PXN OE Srpls
UE = Replace OE Surplus	ET = Partial Replace Labor	EP = Replace PXN
EU = Replace Recycled	TE = Partial Replace Price	PM = Replace PXN Reman/Rebld
UM = Replace Reman/Rebuilt	L = Refinish	PC = Replace PXN Reconditioned
UC = Replace Reconditioned	TT = Two-Tone	SB = Sublet Repair
N = Additional Labor	BR = Blend Refinish	I = Repair
IT = Partial Repair	CG = Chipguard	RI = R & I Assembly
P = Check	AA = Appearance Allowance	RP = Related Prior Damage



This report contains proprietary information of Audatex and may not be disclosed to any third party (other than the insured, claimant and others on a need to know basis in order to effectuate the claims process) without Audatex's prior written consent.

© 2023 Audatex North America, Inc.  
AUDATEX is a trademark owned by Audatex  
North America, Inc. All rights reserved.

**SHEBOYGAN CHEVROLET BUICK  
GMC CADILLAC**

3400 S BUSINESS DR, SHEBOYGAN, WI 53081

Phone: (920) 459-6855

FAX: (920) 459-6286

Workfile ID: 8d66623f

PartsShare: 7wp2jt

Federal ID: 83-0747810

**Preliminary Estimate**

**Customer: PUCHNIARZ, HOLLY**

**Job Number:**

Written By: Scott Stolper

Insured: PUCHNIARZ, HOLLY

Policy #:

Claim #:

Type of Loss:

Date of Loss:

Days to Repair: 0

Point of Impact: 15 Total Loss

**Owner:**

PUCHNIARZ, HOLLY

1443 S 9TH ST

SHEBOYGAN, WI 53081

(920) 917-0999 Cell

**Inspection Location:**

SHEBOYGAN CHEVROLET BUICK GMC  
CADILLAC

3400 S BUSINESS DR

SHEBOYGAN, WI 53081

Repair Facility

(920) 459-6855 Business

**Insurance Company:**

**VEHICLE**

2006 PONT G6 GTP 2D CPE 6-3.9L Gasoline SFI SILVER

VIN: 1G2ZM171364158760

Interior Color:

Mileage In: 207,498

Vehicle Out:

License: ARD4862

Exterior Color: SILVER

Mileage Out:

State: WI

Production Date:

Condition:

Job #:

**TRANSMISSION**

Automatic Transmission

Overdrive

**POWER**

Power Steering

Power Brakes

Power Windows

Power Locks

Power Mirrors

Power Driver Seat

Power Adjustable Pedals

**DECOR**

Dual Mirrors

Body Side Moldings

Tinted Glass

Console/Storage

**CONVENIENCE**

Air Conditioning

Intermittent Wipers

Tilt Wheel

Cruise Control

Rear Defogger

Keyless Entry

Message Center

Telescopic Wheel

Climate Control

**RADIO**

AM Radio

FM Radio

Stereo

Search/Seek

CD Player

Premium Radio

Satellite Radio

Equalizer

**SAFETY**

Drivers Side Air Bag

Passenger Air Bag

Anti-Lock Brakes (4)

4 Wheel Disc Brakes

**SEATS**

Cloth Seats

Bucket Seats

Reclining/Lounge Seats

**WHEELS**

Aluminum/Alloy Wheels

**PAINT**

Clear Coat Paint

**OTHER**

Fog Lamps

Traction Control

Stability Control

Power Trunk/Liftgate

Get live updates at [www.carwise.com/e/4A842Z](http://www.carwise.com/e/4A842Z)

## Preliminary Estimate

**Customer: PUCHNIARZ, HOLLY**

**Job Number:**

2006 PONT G6 GTP 2D CPE 6-3.9L Gasoline SFI SILVER

Line	Oper	Description	Part Number	Qty	Extended Price \$	Labor	Paint
1	#	THIS VEHICLE IS AN OBVIOUS TOTAL LOSS		1			
SUBTOTALS					0.00	0.0	0.0

### ESTIMATE TOTALS

Category	Basis	Rate	Cost \$
Parts			0.00
Grand Total			0.00

**MyPriceLink Estimate ID / Quote ID:**

1123258612425170944 /

MOTOR VEHICLE REPAIR PRACTICES ARE REGULATED BY CHAPTER ATCP 132, WIS. ADM. CODE, ADMINISTERED BY THE BUREAU OF CONSUMER PROTECTION, WISCONSIN DEPT. OF AGRICULTURE, TRADE AND CONSUMER PROTECTION, P.O. BOX 8911, MADISON, WISCONSIN 53708-8911.

## Preliminary Estimate

**Customer: PUCHNIARZ, HOLLY**

**Job Number:**

2006 PONT G6 GTP 2D CPE 6-3.9L Gasoline SFI SILVER

Estimate based on MOTOR CRASH ESTIMATING GUIDE and potentially other third party sources of data. Unless otherwise noted, (a) all items are derived from the Guide DE1FQ05, CCC Data Date 08/17/2023, and potentially other third party sources of data; and (b) the parts presented are OEM-parts. OEM parts are manufactured by or for the vehicle's Original Equipment Manufacturer (OEM) according to OEM's specifications for U.S. distribution. OEM parts are available at OE/Vehicle dealerships or the specified supplier. OPT OEM (Optional OEM) or ALT OEM (Alternative OEM) parts are OEM parts that may be provided by or through alternate sources other than the OEM vehicle dealerships with discounted pricing. Asterisk (\*) or Double Asterisk (\*\*) indicates that the parts and/or labor data provided by third party sources of data may have been modified or may have come from an alternate data source. Tilde sign (~) items indicate MOTOR Not-Included Labor operations. The symbol (<>) indicates the refinish operation WILL NOT be performed as a separate procedure from the other panels in the estimate. Non-Original Equipment Manufacturer aftermarket parts are described as Non OEM, A/M or NAGS. Used parts are described as LKQ, RCY, or USED. Reconditioned parts are described as Recond. Recored parts are described as Recore. NAGS Part Numbers and Benchmark Prices are provided by National Auto Glass Specifications. Labor operation times listed on the line with the NAGS information are MOTOR suggested labor operation times. NAGS labor operation times are not included. Pound sign (#) items indicate manual entries.

Some 2023 vehicles contain minor changes from the previous year. For those vehicles, prior to receiving updated data from the vehicle manufacturer, labor and parts data from the previous year may be used. The CCC ONE estimator has a list of applicable vehicles. Parts numbers and prices should be confirmed with the local dealership.

The following is a list of additional abbreviations or symbols that may be used to describe work to be done or parts to be repaired or replaced:

### SYMBOLS FOLLOWING PART PRICE:

m=MOTOR Mechanical component. s=MOTOR Structural component. T=Miscellaneous Taxed charge category. X=Miscellaneous Non-Taxed charge category.

### SYMBOLS FOLLOWING LABOR:

D=Diagnostic labor category. E=Electrical labor category. F=Frame labor category. G=Glass labor category. M=Mechanical labor category. S=Structural labor category. (numbers) 1 through 4=User Defined Labor Categories.

### OTHER SYMBOLS AND ABBREVIATIONS:

Adj.=Adjacent. Algn.=Align. ALU=Aluminum. A/M=Aftermarket part. Blnd=Blend. BOR=Boron steel. CAPA=Certified Automotive Parts Association. D&R=Disconnect and Reconnect. HSS=High Strength Steel. HYD=Hydroformed Steel. Incl.=Included. LKQ=Like Kind and Quality. LT=Left. MAG=Magnesium. Non-Adj.=Non Adjacent. NSF=NSF International Certified Part. O/H=Overhaul. Qty=Quantity. Refn=Refinish. Repl=Replace. R&I=Remove and Install. R&R=Remove and Replace. Rpr=Repair. RT=Right. SAS=Sandwiched Steel. Sect=Section. Subl=Sublet. UHS=Ultra High Strength Steel. N=Note(s) associated with the estimate line.

CCC ONE Estimating - A product of CCC Intelligent Services Inc.

The following is a list of abbreviations that may be used in CCC ONE Estimating that are not part of the MOTOR CRASH ESTIMATING GUIDE:

BAR=Bureau of Automotive Repair. EPA=Environmental Protection Agency. NHTSA= National Highway Transportation and Safety Administration. PDR=Paintless Dent Repair. VIN=Vehicle Identification Number.

## Preliminary Estimate

**Customer: PUCHNIARZ, HOLLY**

**Job Number:**

2006 PONT G6 GTP 2D CPE 6-3.9L Gasoline SFI SILVER

### ALTERNATE PARTS USAGE

2006 PONT G6 GTP 2D CPE 6-3.9L Gasoline SFI SILVER

VIN: 1G2ZM171364158760 Interior Color: Mileage In: 207,498 Vehicle Out:  
License: ARD4862 Exterior Color: SILVER Mileage Out:  
State: WI Production Date: Condition: Job #:

Alternate Part Type	Selection Method	# Of Times Notified Of Available Parts	# Of Parts Selected
Aftermarket	Automatically List	0	0
Optional OEM	Manually List	0	0
Reconditioned	Manually List	0	0
Recycled	N/A	0	0