

**SUPERIOR AVENUE (66')**

PARKING SCHEDULE		
PROPOSED STALLS:	REGULAR	14 STALLS
	HANDICAP	1 STALL
	TOTAL	15 STALLS

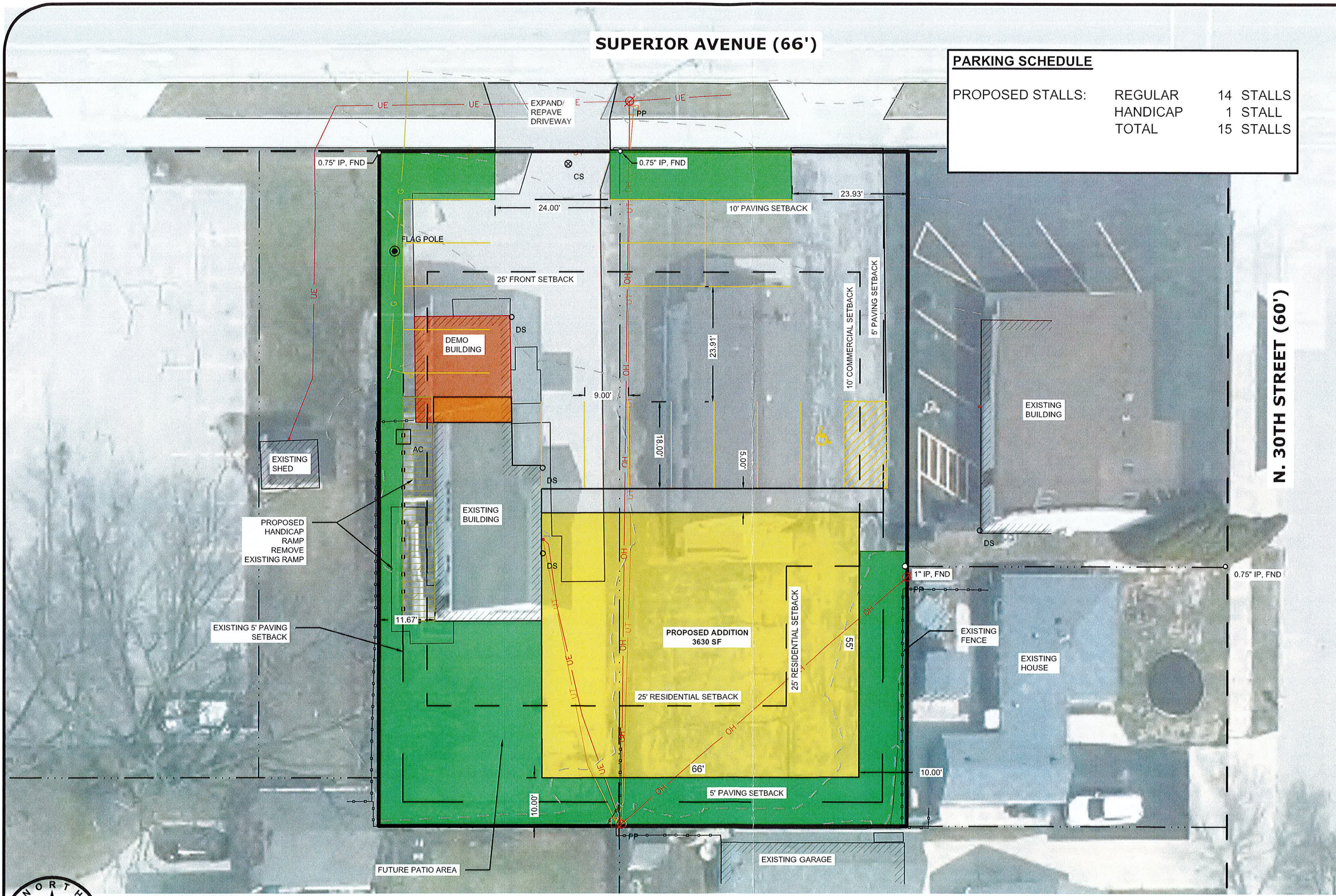

PROPOSED HANDICAP RAMP REMOVE EXISTING RAMP

EXISTING 5' PAVING SETBACK

FUTURE PATIO AREA

PROPOSED ADDITION 3630 SF

DEMO BUILDING

EXISTING BUILDING

EXISTING BUILDING

EXISTING HOUSE

EXISTING FENCE

EXISTING GARAGE

**N. 30TH STREET (60')**

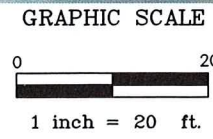

**PRELIMINARY SITE PLAN**

**Building Addition**  
Edward Jones - Greg Monson  
3019 Superior Ave.  
Sheboygan, Wisconsin

DATE  
4-17-26

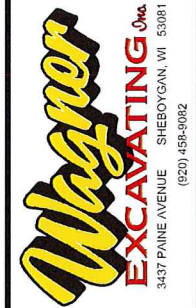

No.	Revision	Date
5		
4		
3	For Construction	
2	For Approval	
1	Preliminary Drawings	4-17-26