

# Greater Ketchikan Community Request for Fiscal Year 2023 State Funding



**Project Title: Saxman Totem Harbor, Planning**

**FY 2023 Funding Request: \$ 6,230,521.75**

## APPLICANT:

City of Saxman  
2841 S. Tongass Hwy  
Ketchikan AK 99901  
907-225-4166

Contact:  
Lori Richmond, City Administrator  
[cityclerksaxman@kpunet.net](mailto:cityclerksaxman@kpunet.net)

Federal Tax ID# 92-0041226

## PROJECT PHOTO

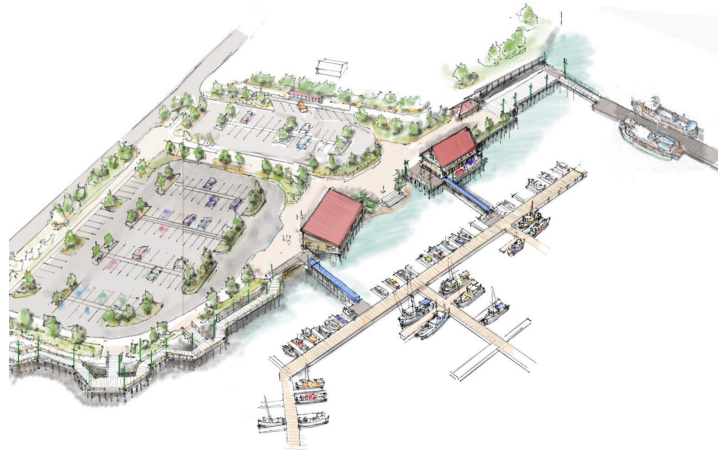

**Is the request a one-time project or is additional State funding expected to be requested in the future?** No additional funding for Phase 1

## BRIEF PROJECT DESCRIPTION:

The City of Saxman requests \$6,230,521.75 for planning and permitting funding to implement the Totem Harbor design outlined in the Master Plan completed in 2021.

## FUNDING PLAN

State the total project cost: \$6,230,521.75

- Environmental Permitting, IHA and mitigation \$350,000.00
- Topographic and Geotechnical Surveying \$250,000.00
- Design and contract documents \$4,717,845.00
- Contact Administration \$812,676.75
- Construction Surveying \$100,000.00

State funding already secured: \$ 0

State the amount of the State funding request for this fiscal year: \$6,230,521.75

## Request for Fiscal Year 2022 State Funding for

### Saxman Totem Harbor-Planning

#### Page 2

State the amount of funding available from other sources with an explanation where appropriate: \$ 1,000,000.00 in land already secured

#### **DETAILED PROJECT CRITERIA:**

**1. Projects that have already started and need to be finished:**

The Saxman Totem Harbor was first designed in 1985. It garnered the support of the Army Corp of Engineers, the Federal Representatives, and the State of Alaska. Money was allocated to this project from the State, but a sewer outfall was required to be removed before the funds could be accepted. Those earmarked funds have since been reallocated even though the outfall has been removed.

**2. Life, Safety and Health Improvements:**

The building of this Harbor will create countless jobs both locally and throughout the Southeast Alaska. It will create jobs at all entry levels from professional, cultural, and initial. It will support Southeast Alaska with job opportunities seasonally, long-term temporary and permanent.

**3. Projects that create jobs:**

There are several ways a harbor in this location will support life safety, environmental protection, and health improvement. Due to the limited room at harbors through-out the Ketchikan Gateway Borough, commercial fishing boats and yachts are anchoring in the inlet. Often they are living aboard. This creates a hazard of strong currents to the vessel and a hazard to life as it delays and makes difficult any EMS or Fire Department response. It also cuts these crew off from resources in the Ketchikan Gateway Borough. Sea life is exposed to these boats and anchors as opposed to a protected marina. Boats that are required to travel at wake speed from the south of the channel, past Saxman, are using more fuel and more personnel time. In the race to get to the south inlet during fishing season, narrow straits through the inlet make close vessels dangerous. The closest dock for rescue boats and EMS from Metlakatla is past Saxman through the busy strait. If there was a drive down dock in Saxman these patients would receive lifesaving advanced life support care sooner.

#### **PROJECT DESCRIPTION AND JUSTIFICATION:**

## **Request for Fiscal Year 2022 State Funding for**

### **Saxman Totem Harbor-Planning**

#### **Page 3**

**Transportation:** Saxman was initially founded as a subsistence village and a shore to access the tribes in the area. There is no water access appropriate for any boat at this area today. When the complete Harbor is realized, not only will these small skiffs and rafts be able to access the open waters quickly and safely, small cruise ships will be able to dock and turnaround crew through use of the float plane dock and access to the highway. Barges can dock in Saxman skipping the slow no-wake area to the Ketchikan Harbor. Commercial fishing boats will be able to re-stock directly from the drive down dock and the EMS boat from Metlakatla will be able to dock and transfer patients directly to the ambulance.

**Infrastructure:** The Harbor would provide infrastructure in the way of a drive down dock, a float plane dock, a harbor masters office, showers, laundromat, free outdoor Wi-Fi, restaurant, coffee shop, concrete stair access to the water, board walk, safe public transportation shelter, a flow of traffic through the park that will negate pedestrians and vehicles sharing the same space, playground area, physical recreation, kitchen for cultural food courses and much more. These are items that will forever be in the hands of the residents. By planning for it now, new infrastructure should not become obsolete in the continued planning and development of the Village. The Harbor will also be built with a eye toward clean fuel. A tidal generator under the upland's construction is currently being evaluated by the Department of Energy, Borough of Indian Energy. This could power electric vehicles to be used through out the park by guests.

**Public Safety:** By having a full harbor at the beginning of the no-wake zone it limits congestion of commercial fishing boats, large yachts, some barge traffic and small cruise ships. It is the closest area of transfer for EMS from boat to Advanced Life Support. It provides a well-lit, safe area for residents and visitors to utilize public transportation.

**Private Sector Tools:** Development of this harbor will give a needed resource that will encourage further commercial marine transportation growth. This includes attracting the moorage, restocking and purchase of tourism products by yachts that currently do not visit the Ketchikan Gateway Borough. Barges can utilize the harbor increasing the number of options and port calls. Commercial fishermen will be encouraged to spend money in the area and the harbor will create a location for study and development of renewable energy. The options for private sector utilization and growth are endless.

**Investment in Future:** Completing the planning phase of this project will lead to securing additional funds for construction. When the harbor is finished it will provide economic stability for the city and economic opportunities for the residents and for

## Request for Fiscal Year 2022 State Funding for

### Saxman Totem Harbor-Planning

#### Page 4

generations to come. The opportunities a harbor like this gives will provide city wide benefits like an increase in housing, small business, transient population, and entrepreneurs. It provides a hope for the current elders and a future for the children of Saxman. This is type of project that once built will be a fixture in the community forever.

**Support for Essential Services:** By increasing the capacity at the city's waterfront support for EMS and fire operations will be increased. Historically there is at least one float plane crash a season. They tend to be on the south side due to the Misty Fiords tour. A full-service harbor on this end would lend support that is not dependent on private dock owners. The need for quick, non-complicated and large capacity shore access for rescues can't be overstated. Development of the associated uplands would provide an area to access public transportation that is well lit, covered and separate from the traffic of the highway. It provides water and shore access for subsistence fishing which is a right to be protected for the Alaska Natives in Saxman. The uplands provide recreation opportunities for the children and elders of Saxman that is safe, well lit, and protected from the elements. The tidal energy project could lead to free or cheap energy for the harbor and residents.

**Culture and Recreation:** This project allows the Alaska Natives that are descendants of the original settlers the ability to continue culturally important activities such as seaweed harvesting and fishing. It would promote the passing of historically significant stories from elder to child by giving back access to the ocean that is so important to the culture of the area. It adds a park and a boardwalk that allows access to nature for differently abled individuals. This would allow elders and children to enjoy outdoor activities together. By providing free public Wi-Fi that would reach all areas of the harbor all residents of the Ketchikan Gateway Borough can come together for meetings, teachings, or just time outdoors while working remotely.

#### **PROJECT TIMELINE**

Depending on weather and availability of specialty contractors the planning phase should be completed in 12-18 months.

#### **ONGOING OPERATION AND MAINTENANCE:**

The City of Saxman will be responsible for the continued operation and maintenance of the finished project and will not need require ongoing contribution from the state.

**Request for Fiscal Year 2022 State Funding for  
Saxman Totem Harbor-Planning**

**Page 5**

The planning phase will be managed by City of Saxman employees and contractors.