

Surveyor's Certificate

I, Robbin J. Mullen, a Professional Land Surveyor holding certificate #368356 in accordance with Title 58, of the Professional Engineers and Land Surveyors Licensing act, certify that this is a true and accurate map of the tract of land to be annexed to Santiquin, Utah County, Utah.

Boundary Description

A PARCEL OF LAND LOCATED IN THE BEGINNING AT A POINT THAT IS N.89°55'22"W. ALONG THE SECTION LINE 229.91' AND SOUTH 1319.46' FROM THE NORTH ¼ CORNER OF SECTION 10, TOWNSHIP 10 SOUTH, RANGE 1 EAST; SALT LAKE BASE & MERIDIAN;

THENCE ALONG THE RAILROAD FENCE LINE THE FOLLOWING 7 COURSES: S.17°59'15"W. 225.27'; THENCE N.71°48'17"W. 29.18'; THENCE S.17°31'42"W. 717.048'; THENCE S.77°54'1"E. 29.277'; THENCE ALONG A CURVE TO THE LEFT, HAVING A RADIUS OF 4261.979 A DELTA ANGLE OF 11° 01' 21", AND WHOSE LONG CHORD BEARS S.7°44'2"W. 818.650'; THENCE S.2°55'8"W. 434.064'; THENCE S.1°36'3"W. 486.07'; THENCE ALONG THE SOUTH COUNTY II ADDITION ANNEXATION THE FOLLOWING 3 COURSES: N.89°07'30"W. 576.67'; THENCE N.0°56'08"W. 2651.14'; THENCE S.89°42'22"E. 1059.65' TO THE POINT OF BEGINNING.

SAID DESCRIBED PARCEL CONTAINS 1913558.5 SQUARE FEET (43.9 ACRES), MORE OR LESS.

BASIS OF BEARING N ¼ TO THE NW CORNER OF SAID SECTION, BEARING S.89°55'22"W. 2629.39'

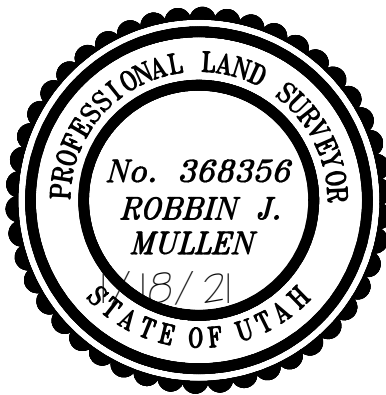

January 18, 2021

Date

Surveyor

Acceptance by Legislative Body

THIS IS TO CERTIFY THAT WE, THE UNDERSIGNED SANTIQUIN CITY COUNCIL, HAVE RECEIVED A PETITION SIGNED BY A MAJORITY OF THE OWNERS OF THE TRACT SHOWN HEREON REQUESTING THAT SAID TRACT BE ANNEXED TO SANTIQUIN CITY AND THAT A COPY OF THE ORDINANCE HAS BEEN PREPARED FOR FILING HEREWITH ALL IN ACCORDANCE WITH THE UTAH STATE CODE 10-2-403 AS REVISED AND THAT WE HAVE EXAMINED AND DO HEREBY APPROVE AND ACCEPT THE ANNEXATION OF THE TRACT AS SHOWN AS A PART OF SAID CITY AND THAT SAID TRACT OF LAND IS TO BE KNOWN AS THE TANNER ANNEXATION

DATED THIS ____ DAY OF _____ 2021

Attest: _____

FINAL LOCAL ENTITY PLAT

Plat created April, 2021

TANNER ANNEXATION

SANTIQUIN, UTAH County, Utah

Scale: 1" = 150 Feet

UTAH County Surveyor

Approved this _____ day of _____, 2020 as a Final Local Entity Plat by the Utah County Surveyor.

Utahm

County Surveyor

UTAH County Recorder

State of Utah, County of Utah, recorded and filed at the request of _____

Date _____ Time _____ Book _____ Page _____

\$ _____ Fee _____ Utah County Recorder

REGION ENGINEERING & SURVEYING
1776 NORTH STATE ST. #110
OREM, UTAH 84057
PH - 801.367-5274