

Paid 100.00  
Check # 128

# SAN JUAN COUNTY CONDITIONAL USE PERMIT APPLICATION

Type of Application (check all that apply):

- New Construction
- Addition
- Land Use Change
- Appeal

Subject Property Location or Address: 4040 Kane Creek

Parcel Identification Number: 26S 21E 328400

Parcel Area: 80AC (1,321,985 sq. ft. x 1,318,015 sq. ft.) Current Use: \_\_\_\_\_

Floor Area: \_\_\_\_\_ Zoning Classification: AG land Non FFA Unimproved

Applicant Name: Kenneth Denham

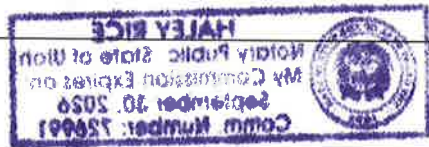

Mailing Address: 4040 Kane Creek Blvd.

City, State, ZIP: Moab Utah 84532

Daytime Phone #: 801 440 4498 Fax#: \_\_\_\_\_

Email Address: crookedbindiranch@gmail.com

Business Name (If applicable): Solace Ranch LLC DBA Crooked Bindi Ranch

Property Owner's Name (If different): \_\_\_\_\_

Property Owner's Mailing Address: \_\_\_\_\_

City, State, ZIP: \_\_\_\_\_

Daytime Phone #: \_\_\_\_\_ Fax#: \_\_\_\_\_

Describe your request in detail (use additional page(s) if necessary):

To operate a small glamping concern.

Authorized Signature: [Signature] Date: September 28th, 2023

TOWNSHIP N<sup>o</sup> 26 SOUTH RANGE N<sup>o</sup> 21 EAST OF THE SALT LAKE BASE AND MERIDIAN UTAH.

WIDTH STANDARD PARALLEL SOUTH

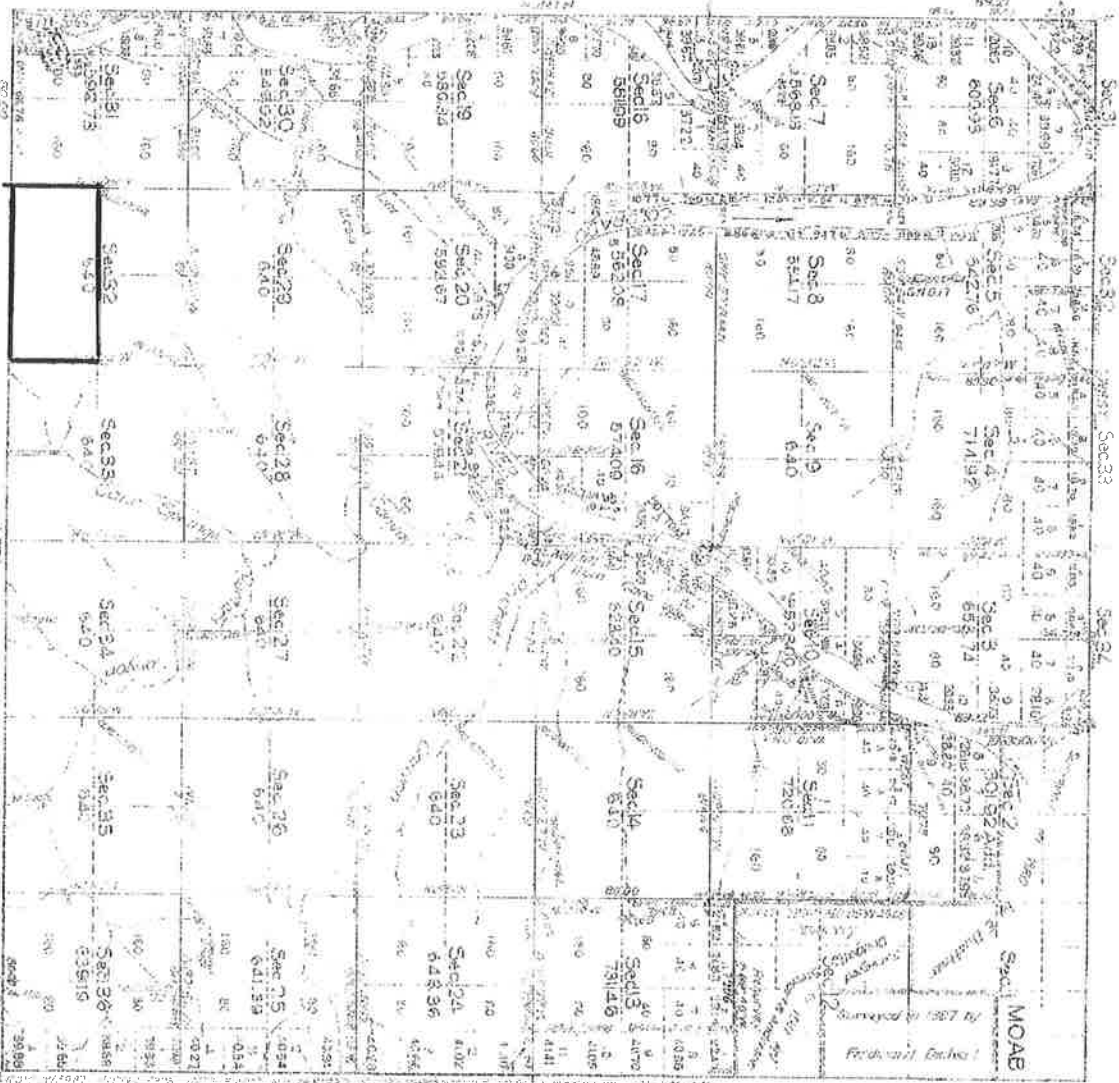

Scale of 1 inch = 40 rods  
 Scale of 1 inch = 160 rods  
 Scale of 1 inch = 320 rods

NAME OF CLAIMANT	SECTION	ACRES	DATE
...	...	...	...

DEPARTMENT OF THE INTERIOR  
 GENERAL LAND OFFICE  
 WASHINGTON, D. C. 20540

DEPARTMENT OF THE INTERIOR  
 GENERAL LAND OFFICE  
 WASHINGTON, D. C. 20540

BC 100

