

Site Plan Primitive RV/ Camp Site

Within the NW¹/₄ SW¹/₄ of Section 2, T39S, R22E, SLB&M

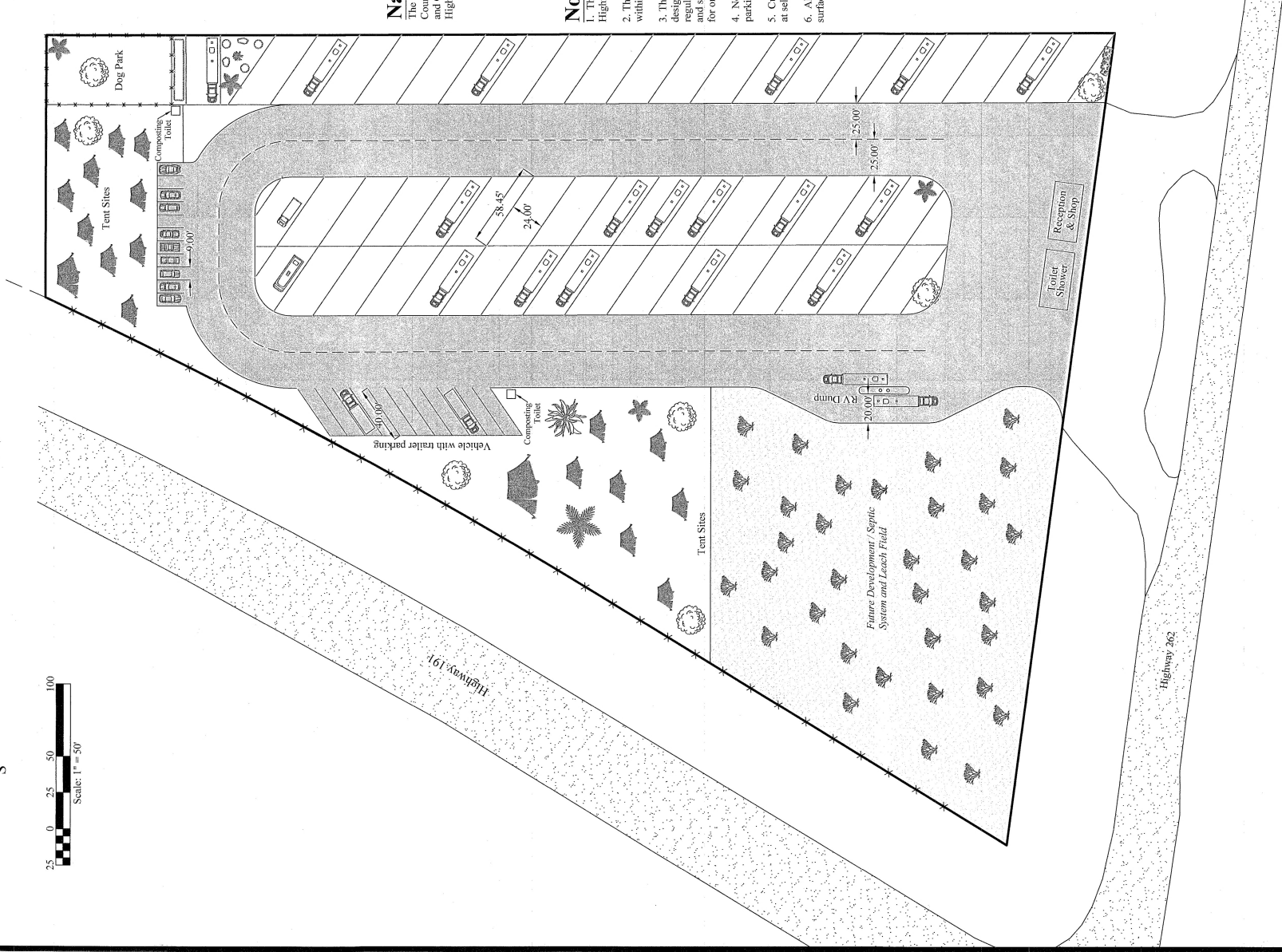
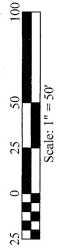

Narrative

The purpose of this site map is to gain San Juan County preliminary approval for Primitive RV and Camp Site at the junction of Highway 202 and Highway 191 in San Juan County, UT.

Notes

1. This property is zoned in a Controlled District as Highway (C-d-h)
2. There is no official flood zone designation for any area within this proposed site.
3. The site will offer an RV dump station which will be designed and installed in conformance with the rules and regulations of the Utah Division of Environmental Health and shall comply with with R317-4 administrative rules for onsite wastewater systems.
4. No utility hook-ups will be offered at the individual parking spaces and tent locations.
5. Culinary water will be hauled to the site and provided at select locations.
6. All roadways will consist of a road base / gravel surface.

Bunker Engineering, LLC

965 South Creek Road, Monticello, UT 84535

P.O. Box 432, Monticello, UT 84535 (435) 459-9152

Date: Mar. 2024

Drawn By: B.D. Bunker

Scale: 1" = 50'

Sheet: 1 of 1

Drawing Name: Drawing Reference No. BE1377