

PREPARED FOR:

1A CERTIFICATION LETTER



FOR
INFRA TOWERS, LLC
FACILITY KNOWN AS:
UT-109 Spanish Valley

ELEVATION REPORT:	LEGAL DESCRIPTION:	APPROX. SITE LOCATION:
NAVD88 - GROUND ELEVATION: 4739 sft [ELEVATION METERS]: 1444.450 m	LOCATED WITHIN SECTION 35, TOWNSHIP 26 SOUTH, RANGE 22 EAST, SALT LAKE BASE AND MERIDIAN,	SITE IS LOCATED APPROX AT: 4326 E SUNNY ACRES LN, SPANISH VALLEY, UTAH.

OVERVIEW: SCALE 1" = 150' PLAN VIEW: SCALE 1" = 60'



BASIS OF GEODETIC COORDINATES:

(1) HORIZONTAL DATUM: NORTH AMERICAN DATUM OF 1983 (NAD83) (2011) EPOCH 2010 EXPRESSED IN DEGREES (°) MINUTES (') AND SECONDS (") AND CARRIED TO THE 100TH OF A SECOND, AND ALSO EXPRESSED IN DECIMAL DEGREES.

(2) VERTICAL DATUM: NORTH AMERICAN VERTICAL DATUM OF 1988 (NAVD88) (GEOID 12B) EXPRESSED IN U.S. SURVEY FEET AND METERS (METER EQUIVALENT TO 39.37 INCHES).

(3) NAD83 GEODETIC DATA SHOWN HEREON WAS DERIVED FROM AND IS TIED TO THE NATIONAL GEODETIC SURVEY, NATIONAL C.O.R.S. VIA THE O.P.U.S. UTILITY OR VIA OTHER EQUIVALENT INDUSTRY STANDARD GEODETIC SURVEY CONTROL METHODS.

1A GEODETIC COORDINATES:

NAD 83: 38°29'53.02"N
 109°28'17.51"W

DECIMAL DEGREES: 38.498061°N
 109.471532°W

SURVEYOR'S CERTIFICATION **DATE OF SURVEY**

I HEREBY CERTIFY THAT THE GEODETIC COORDINATES REPORTED HEREON ARE ACCURATE AND MEET FAA REPORTING REQUIREMENTS OF 1A: TWENTY FEET (20') HORIZONTALLY AND THREE FEET (3') VERTICALLY.

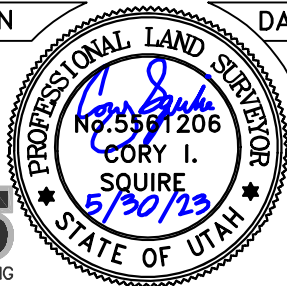

5/19/2023

THESE DRAWINGS AND SURVEYS ARE COPYRIGHT PROTECTED AND THE SOLE PROPERTY OF INFRA TOWERS, LLC AND PRODUCED FOR THE USE OF OUR CLIENT. ANY REPRODUCTION OR USE OF THE INFORMATION CONTAINED WITHIN SAID DOCUMENTS IS PROHIBITED WITHOUT THE WRITTEN CONSENT BY INFRA TOWERS, LLC.

CIS
PROFESSIONAL SURVEYING
295 N 200 E MONA, UT 84645
PH:(435)660-0816 EMAIL: CORY@CISPLS.COM
CORY IVAN SQUIRE UT P.L.S. #5561206-2203

