



State of Utah
School & Institutional
Trust Lands Administration

2031 South Industrial Park Road
Richfield, UT 84701
435-896-2559
435-896-0349 (Fax)
www.trustlands.utah.gov

Gary R. Herbert
Governor

Spencer J. Cox
Lieutenant Governor

David Ure
Director

December 28, 2020

San Juan County Commission
P.O. Box 9
Monticello, UT 84535

RE: Range Improvement Project (RIP) 859: "*Montezuma Canyon Creek Water Wells II*"
Resource Development Coordinating Committee (RDCC) Project 77403

Dear Commissioners:

This letter is to inform you that the School and Institutional Trust Lands Administration (SITLA) recently submitted the above referenced proposal for a RIP within your County, to the RDCC registry.

Enclosed for your review is a copy of the RDCC posting and a map containing general information about the RIP proposal. This information can also be found online in the RDCC Project Management System.

Please review the enclosed information at your convenience and submit any comments or concerns by January 18, 2021.

Feel free to contact me with any questions you may have at (435)893-2981.

Sincerely,

Wendy Campbell for
Slate Stewart
Resource Specialist

SS/wec

Enclosures (2 pgs.)

View Project

[View] [edit]

Project #77403

Close

Key Info:

Sponsor: **School and Institutional Trust Lands Administration**

Title of Action: **Montezuma Canyon Creek Water Wells**

Project Start Date: **01/22/2021**

Location: **T. 36 S., R. 24 E., Sec 2:SW4SW4SW4SE4 (Within) & T. 37 S., R. 24 E., Sec. 2: SW4NE4SW4SW4 (Within)**

Location/Supplemental Attachment:

Counties: **San Juan**

Has local government been contacted? **Yes**

Date Local Government was Contacted: **12/28/2020**

Acquisition: **No**

Date of Acquisition: **N/A**

Have the state representative and state senator been contacted? **No**

Project abstract:

Trust Lands Administration proposes to approve the drilling of two stock water wells, one on each of two sections. If water is found the water will be pumped via solar pumps to the surface and into nearby water troughs.

Local government's response?

A copy of this posting was sent with the notice. No response to date.

How is the local government(s) likely to be impacted?

No negative impacts anticipated.

Possible significant impacts likely to occur:

Both wells will be drilled in previously disturbed areas next to existing roads. No negative impacts anticipated.

Consistency Review

No Consistency Review Document

Record of Decision

No Record of Decision Document

State Comments

No State Comments

For further information please contact project sponsor.

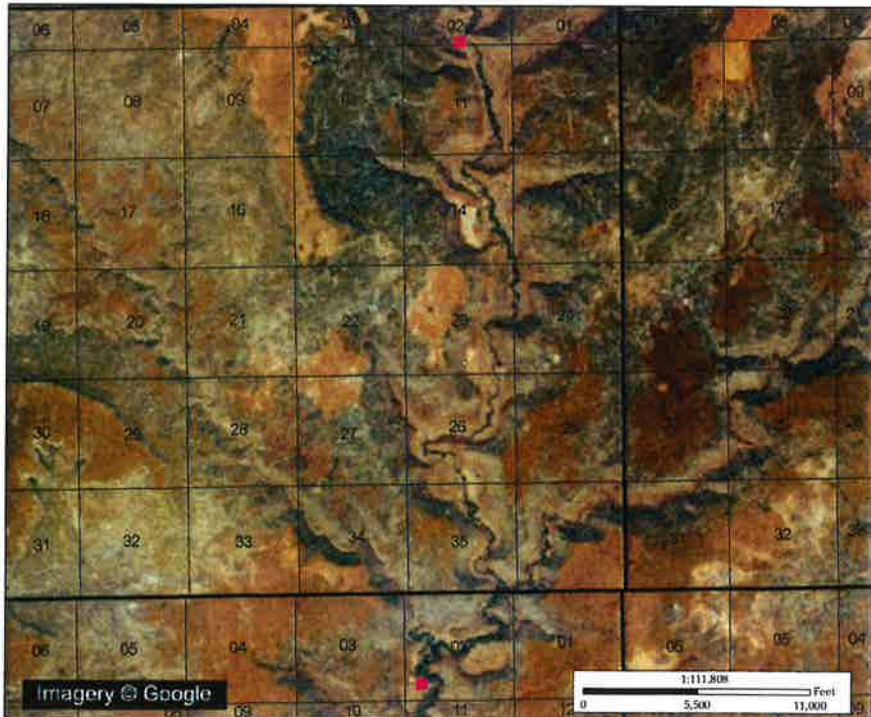
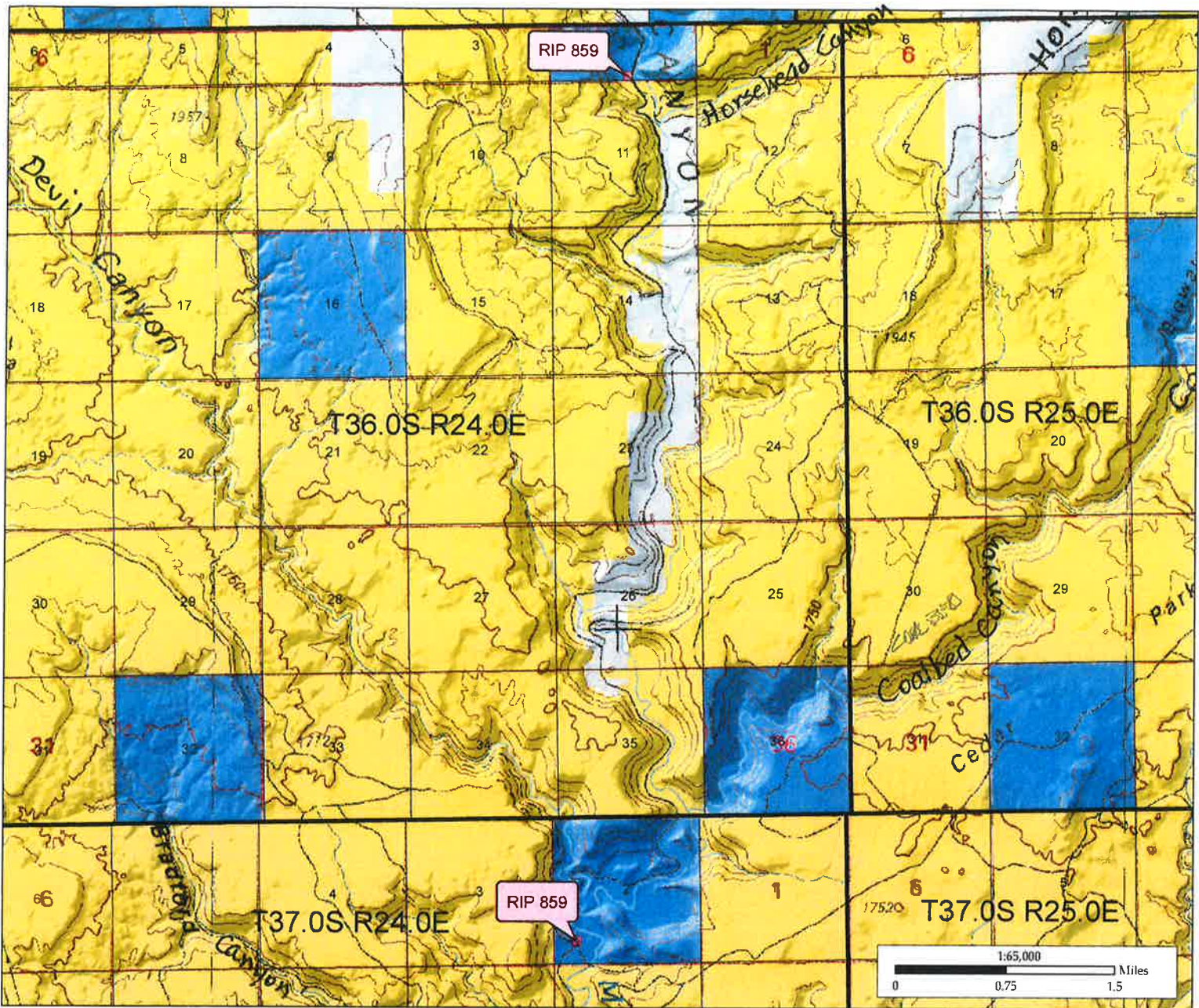

RIP 859
 Township 36 South, Range 24 East, SLB&M S2;
 Township 37 South, Range 24 East, SLB&M S2;
 San Juan County

Land Ownership and Administration

- Bureau of Land Management
- Bureau of Reclamation
- Bankhead-Jones Land Use Lands
- National Recreation Area
- National Parks, Monuments & Historic Sites
- National Forest
- National Wilderness Area
- National Wildlife Refuge
- Other Federal
- Military Reservations and Corps of Engineers
- Private
- State Trust Lands
- State Sovereign Land
- State Parks and Recreation
- State Wildlife Reserve/Management Area
- Other State
- Tribal Lands

■ Range Improvement Project

Coordinate System: NAD 1983 UTM Zone 12N
 Projection: Transverse Mercator

Data represented on this map is for REFERENCE USE ONLY and is not suitable for legal, engineering, or surveying purposes. Users of this information should review or consult the primary data and information sources to ascertain the usability of the information. SITLA provides this data in good faith and shall in no event be liable for any incorrect results, or any special, indirect, or consequential damages to any party, arising out of or in connection with the use or the inability to use the data hereon.

Land parcels, lease boundaries and associated SITLA data layers may have been adjusted to allow for visual "best fit". The Surface Ownership Land Status data (if present) are maintained by SITLA to reflect current trust land status and surface ownership. Lakes, rivers, streams, highways, roads, county and state boundaries are distributed by the Utah Automated Geographic Reference Center and/or other sources as specified. Contour lines (if present) were generated from USGS 10 meter DEM.

Please Note: While SITLA seeks to verify data for accuracy and content, discrepancies may exist within the data. Acquiring the most updated SITLA ownership GIS data may require contacting the GIS staff directly 801-538-5100 or TLA-GIS@utah.gov. The SITLA GIS department welcomes your comments and concerns regarding the data and will attempt to resolve issues as they are brought to our attention. Color Aerial Photo (Google Imagery) - 6 Inch High Resolution.