



# United States Department of the Interior

BUREAU OF LAND MANAGEMENT  
Moab Field Office  
82 E Dogwood Avenue  
Moab, UT 84532



*Rec'd 2-26-24  
SJC*

IN REPLY REFER TO:  
3809 (UTY-012)

February 14, 2024

County Planner Nick Sandberg  
San Juan County, Utah  
P.O. Box 9  
Monticello, Utah 84535

Dear County Planner Nick Sandberg:

The Bureau of Land Management (BLM) Moab Field Office (MFO) received an application from Lisbon Valley Mining Company LLC to modify their Plan of Operations to expand copper mining operations in San Juan County, Utah. The BLM would like to formally invite San Juan County to participate as a cooperating agency in the preparation of an Environmental Impact Statement for the Lisbon Valley Mining Company LLC Plan of Operations Modification.

The BLM is the lead Federal agency for the planning effort. This planning effort will be supported by an Environmental Impact Statement (EIS), pursuant to the National Environmental Policy Act (NEPA) and the associated regulations (40 CFR §1500-1508). The BLM anticipates that it will publish a Notice of Intent in the Federal Register in May 2024 to initiate a public scoping period to engage the public to help identify issues for this planning effort.

The regulations at 40 CFR § 1501.8 describe the general roles of a cooperating agency. State, tribal, or local entities with jurisdiction by law or special expertise may, by agreement with the lead agency, become a cooperating agency. Please note that establishment of cooperating agency status does not waive your rights to protest or appeal the Record of Decision.

If you would like to be a cooperating agency, please fill out the enclosed response letter and return via email or post, to Jill Stephenson ([jstephenson@blm.gov](mailto:jstephenson@blm.gov)), Planning and Environmental Coordinator, at 82 E Dogwood Avenue, Moab, UT 84532. Upon receipt of your letter, we will provide a draft memorandum of understanding (MOU) for your review that describes respective roles, responsibilities, and timelines. In your response letter, please note if the point of contact for finalizing the MOU is different from the point of contact for the planning process. Should you elect to not be a cooperating agency, you will still have opportunities to participate in the NEPA process, such as during public scoping or public comment periods.

If you have any questions regarding cooperating agency status, or if you require any additional information, please contact Jill Stephenson, at 435-259-2141, or send an email to [jstephenson@blm.gov](mailto:jstephenson@blm.gov). Thank you for your interest in the NEPA process and in the management of your public lands. We look forward to working with you as we proceed through the planning process.

Sincerely,

**DAVID PALS** Digitally signed by DAVID PALS  
Date: 2024.02.14 16:42:53  
-07'00'

Dave Pals  
Moab Field Office Manager

Enclosures

- 1 – Cooperating Agency Return Form
- 2 – Planning Area map

## COOPERATING AGENCY RETURN FORM

Cooperating Agency Representative:

This form is provided for your convenience in responding to the Bureau of Land Management's invitation to become a cooperating agency with BLM in the planning process for the Lisbon Valley Mining Company LLC Plan of Operations Modification.

Please complete and return this form. BLM will follow up with you in accordance with your response.

- Our agency has jurisdiction by law or special expertise and would like to become a cooperating agency with BLM.
- The information that you have provided is sufficient, and we do not desire to become a cooperating agency at this time. We do, however, request updates on the draft and final Environmental Impact Statement.
- Thank you for your correspondence. Our agency has no further interest in this planning process and request you remove us from your mailing list.

**Name of Point of Contact for Memorandum of Understanding (please print):**

\_\_\_\_\_

Title: \_\_\_\_\_

Phone: \_\_\_\_\_

Email: \_\_\_\_\_

Signature: \_\_\_\_\_ Date: \_\_\_\_\_

**Name of Point of Contact for Planning Process, if different from above (print):**

\_\_\_\_\_

Title: \_\_\_\_\_

Phone: \_\_\_\_\_

Email: \_\_\_\_\_

Signature: \_\_\_\_\_ Date: \_\_\_\_\_

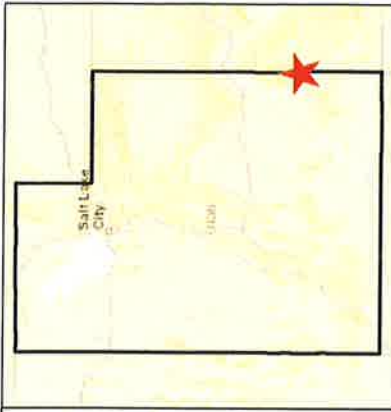
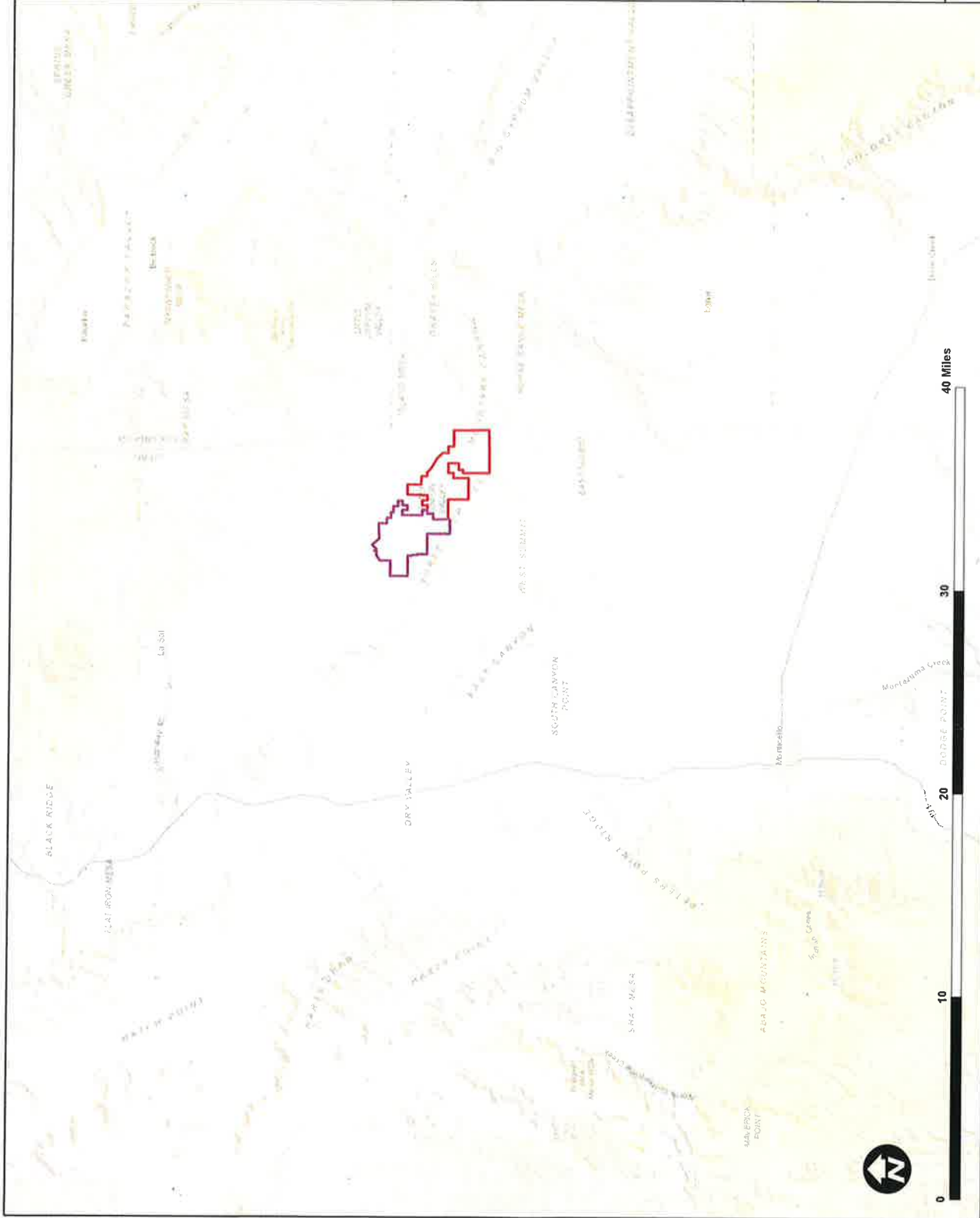

**Legend**

- LVMC\_Active\_Project\_Boundary
- LVM\_Plan\_Boundary

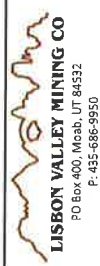

**LISBON VALLEY MINING CO**  
 PO Box 400, Moab, UT 84532  
 P: 435-686-9950

Modification of the  
 Lisbon Valley Mining Company Plan of Operations  
 UTU-72499

**FIGURE 1-1  
 General Location Map**

DATE: 28 December 2022  
 Drafted By: LVM Engineering, ADT

REVISION  
 0

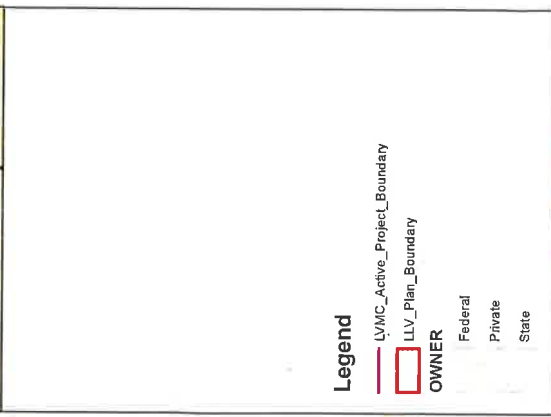
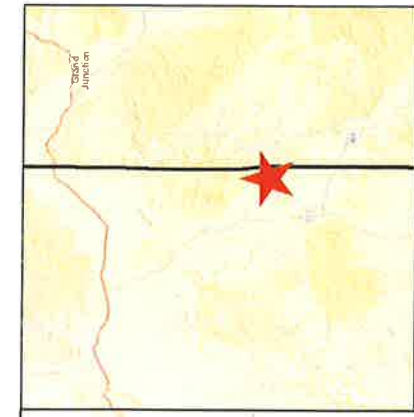

**Legend**

- LVMC\_Active\_Project\_Boundary
- LLV\_Plan\_Boundary

**OWNER**

- Federal
- Private
- State

**LISBON VALLEY MINING CO**  
 PO Box 400, Moab, UT 84532  
 P: 435-686-9950

Modification of the  
 Lisbon Valley Mining Company Plan of Operations  
 UTU-72499

**FIGURE 1-3**  
**Active & LLV Plan Boundary**

DATE: 28 December 2022	REVISION
Drafted By: LVM Engineering, ADT	0

