

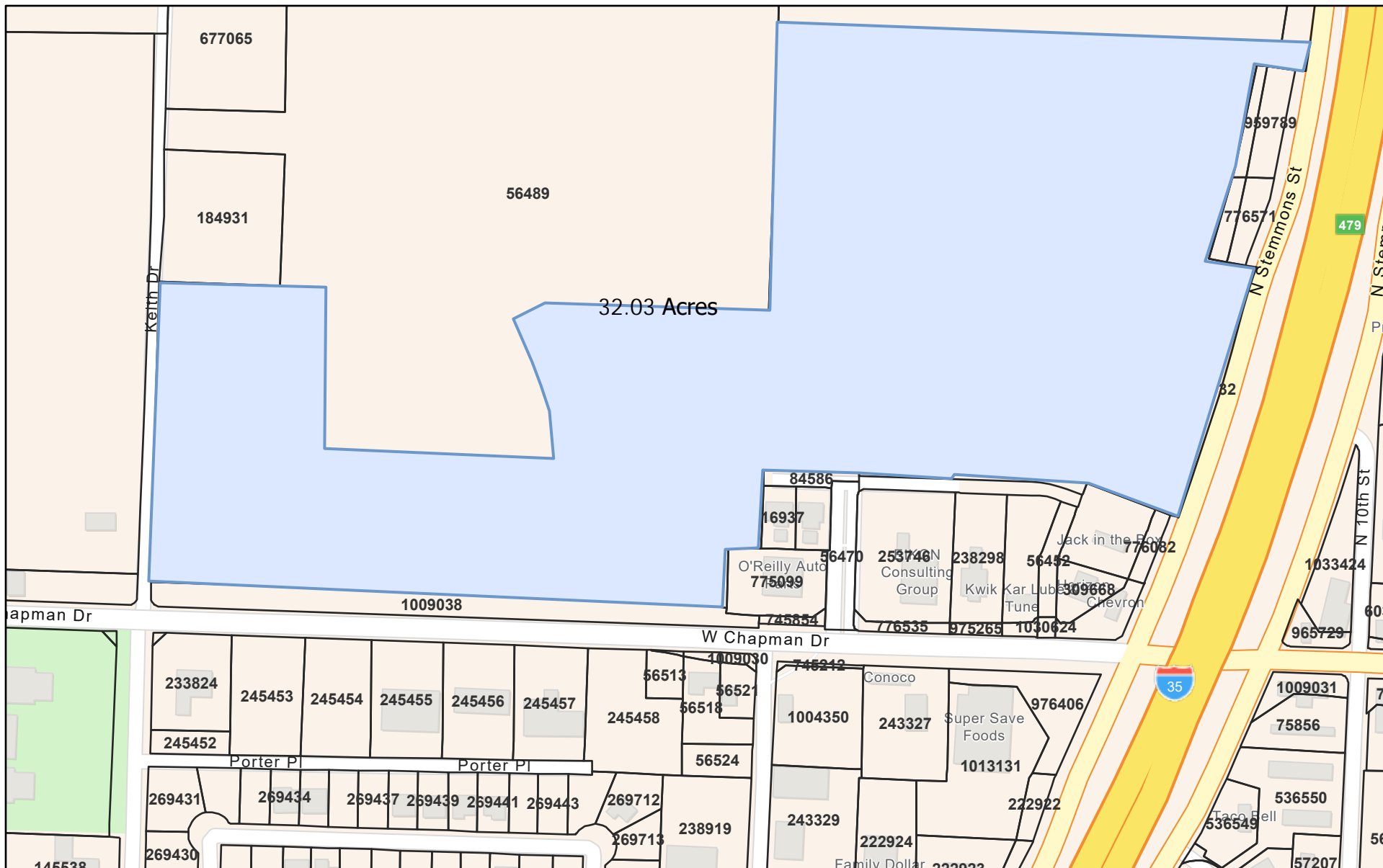

Denton CAD Web Map



10/11/2024, 8:29:53 AM

Belz Road Retail Addition - Phase 1 - Commercial
Final Plat
24SANZON-0010

-  Parcels
-  County

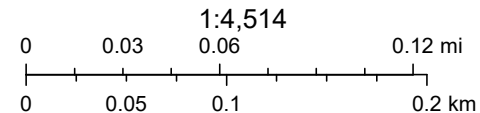

Texas Department of Transportation, Esri Community Maps Contributors, Texas Parks & Wildlife, © OpenStreetMap, Microsoft, Esri, TomTom, Garmin,

Denton County Appraisal District, BIS Consulting - www.bisconsulting.com

Disclaimer: This product is for informational purposes only and has not been prepared for or be suitable for legal, engineering, or surveying purposes. It does not represent an on-the-ground survey and represents only the approximate relative location of boundaries.