



EXTERIOR SIGN PACKAGE

DATE: 04.07.23

REQUISITE CHECKLIST

ALL REQUIREMENTS MUST BE MET BEFORE BEING RELEASED TO PRODUCTION

☐☒

SURVEY

☐☒

ALL VECTOR AND / OR HIGH RESOLUTION ART

\*DATE CHECKED (Designer name): Joe Example 9/17/21

ART CONFIRMED BY

TJG 9/17/21

☐☒

ALL PAINT / VINYL / PRINT COLORS (CMYK or PMS) /  
ALL STONE, BRICK, VENEER, AND FINISHES

DESIGNER NOTES

- NOTES
- NOTES
- NOTES
- NOTES
- NOTES
- NOTES

RED LINE OVER TITLE BLOCK ON DRAWING PAGES INDICATES DRAWING IS NOT READY FOR PRODUCTION - ALL TBD ITEMS MUST BE RESOLVED.

D/F INTERNALLY ILLUMINATED PYLON SIGN (QTY. 1)

SQUARE FOOTAGE: 100

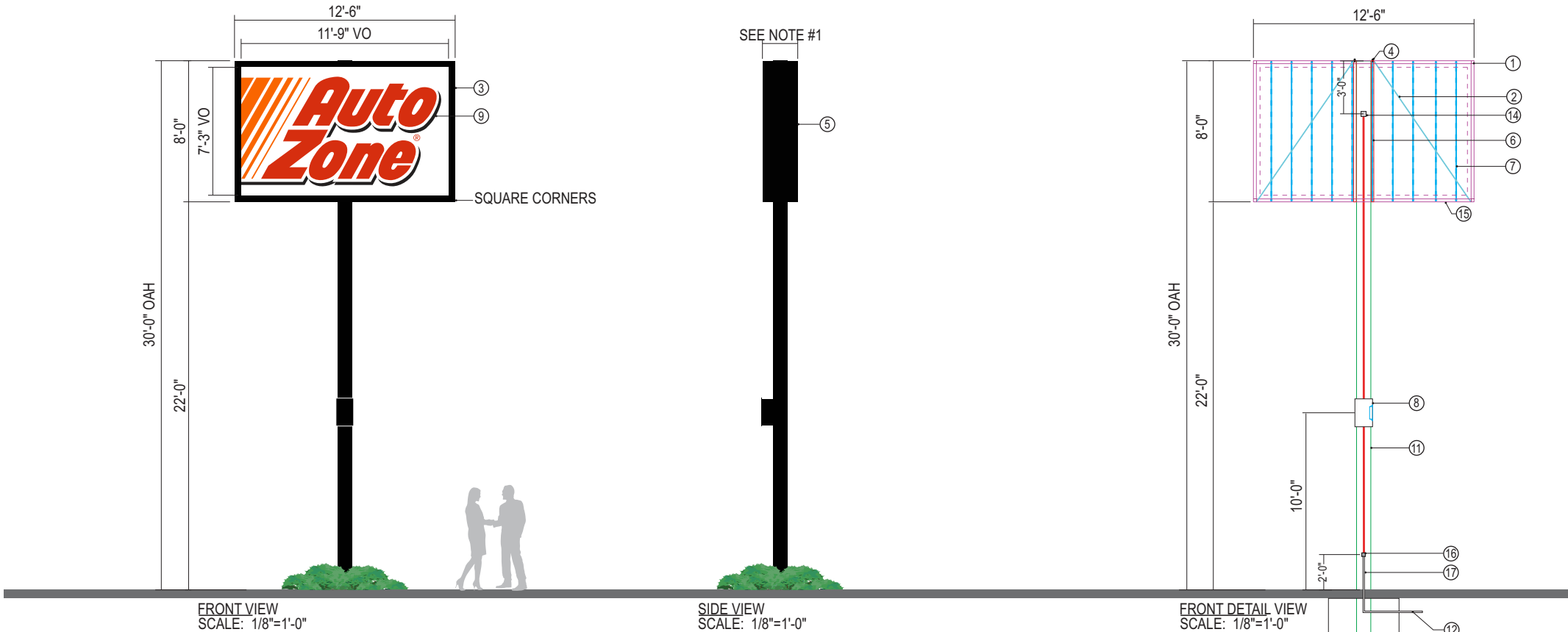

SPECIFICATIONS:

- 1. 2" x 2" x .250" INVERTED STEEL ANGLE FRAME SYSTEM **P-1** w/ ANGLE PUNCHED TO ACCEPT SIGNTECH CLIPS / ACCESS DOOR ON BOTH SIDES OF CABINET
- 2. 5/32" DIA. AIRCRAFT CABLE w/ TURNBUCKLE / 1" OFF CENTER TO PREVENT INTERFERENCE w/ LEDs
- 3. 4 1/2" FORMED .063" PRE-FINISHED BLACK/WHITE ALUMINUM RETAINER / FASTENED TO CABINET w/ #8 x 1/2" LG HEX WASHER HEAD TEK SCREWS
- 4. (2) 1/2" LIFTING EYES
- 5. .063" PRE-FINISHED BLACK/WHITE ALUMINUM RETURNS / FASTENED TO CABINET w/ 1/8" POP RIVETS
- 6. 1 3/4" x 1 3/4" x 1/8" STEEL ANGLE ADJUSTABLE SADDLE MOUNT SYSTEM
- 7. INTERNALLY ILLUMINATED w/ GE LED STICKS
- 8. POWER SUPPLY LOCATED INSIDE .063" PRE-FINISHED BLACK/WHITE ALUMINUM WATERPROOF ENCLOSURE
- 9. 0606 WHITE COOLEY BRIE FACES / FIRST SURFACE APPLIED ARLON TRANSLUCENT VINYL GRAPHICS **V-1, V-2, V-3**
- 10. SIGN TECH CLIP ASSEMBLIES
- 11. REFER TO ENGINEERING FOR STEEL SUPPORT REQUIREMENTS / PORTION OF POLE INSIDE CABINET TO BE PAINTED **P-1** / PORTION OF POLE OUTSIDE CABINET TO BE PAINTED **P-8**
- 12. 3/4" PVC CONDUIT w/ PRIMARY ELECTRICAL WIRING BELOW GRADE PER LOCAL CODE / N.I.C. BY OTHERS
- 13. CONCRETE FOOTING / REFER TO ENGINEERING FOR POLE EMBEDMENT SPECIFICATION AND FOOTING REQUIREMENTS
- 14. ELECTRICAL HAND HOLE
- 15. DRAIN HOLES / MINIMUM 4 REQUIRED
- 16. MULTI-TAP FIXTURES TO ACCOMMODATE ELECTRICAL EXISTING ON SITE
- 17. CONDUIT EXPOSED / NO HOLE REQUIRED BELOW GRADE

NOTES:

- STANDARD CABINET DEPTH IS 24" / TO BE ADJUSTED AS NEEDED PER ENGINEERING
- MAXIMUM DISTANCE ALLOWED BETWEEN CENTER OF CABINET AND CENTER OF POWER SUPPLY BOX IS 32'-0"

COLORS/FINISHES:

- P-1** RUSTOLEUM 20-9109 WHITE PRIMER
- P-8** GLOSS BLACK
- V-1** ARLON 44 ORANGE HI PERF. TRANSLUCENT VINYL
- V-2** ARLON 22 BLACK HI PERF. TRANSLUCENT VINYL
- V-3** ARLON 143 POPPY RED HI PERF. TRANSLUCENT VINYL

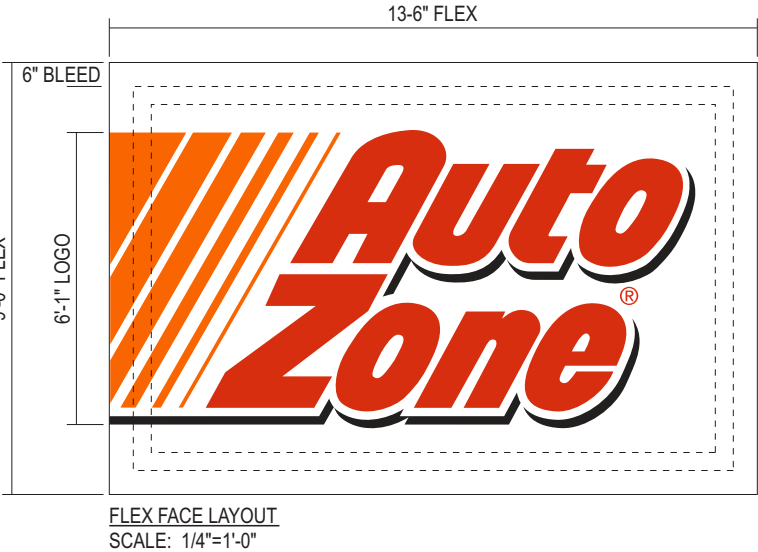

VARIABLES

SIZE	FINISHED SIZE	V.O.	CORNERS	AMPS	CIRCUITS	ILLUMINATION	POWER SUPPLIES
100 SQ FT	8'-0" x 12'-6"	7'-3" x 11'-9"	SQUARE	2.70	120V (1) 20 AMP CIRCUIT	(10) GE LED TETRA STICKS	(1) GE 24V-300W POWER SUPPLY

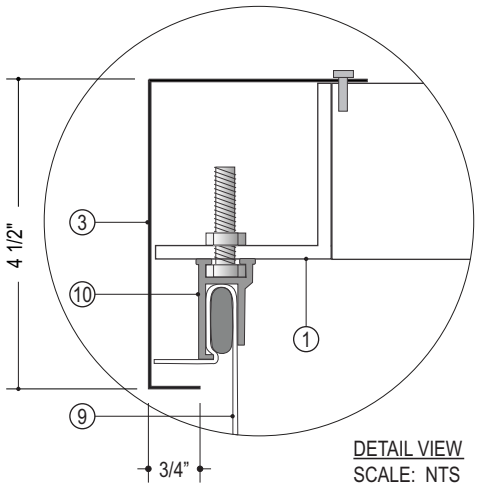

<b>JONES SIGN</b> Your Vision. Accomplished. WWW.JONESSIGN.COM	JOB #: <b>281641-R0</b> DATE: 04.07.2023 DESIGNER: ZT SALES REP: N/A PROJ MGR: N/A	REV.	DATE	BY	DESCRIPTION	CLIENT APPROVAL	DATE		Site # N/A SANGER, TX	SHEET NUMBER <b>1.0</b>
		1	00.00.00	XX	XXXX					
		2	00.00.00	XX	XXXX					
		3	00.00.00	XX	XXXX	LANDLORD APPROVAL	DATE			
		4	00.00.00	XX	XXXX					
		5	00.00.00	XX	XXXX					
		6	00.00.00	XX	XXXX	QC				
		7	00.00.00	XX	XXXX					
		8	00.00.00	XX	XXXX					
		9	00.00.00	XX	XXXX					
		10	00.00.00	XX	XXXX					

This is an original, unpublished drawing by Jones Sign Co., Inc. It is for your personal use in conjunction with a project being planned for you by JONES SIGN. It is not to be shown to anyone outside of your organization, nor is it to be used, reproduced, copied or exhibited in any fashion. Use of this design or the salient elements of this design in any sign done by any other company, without the express written permission of JONES SIGN, is forbidden by law and carries a civil forfeiture of up to 25% of the purchase price of the sign. JONES SIGN will endeavor to closely match colors, including PMS, where specified. We cannot guarantee exact matches due to varying compatibility of surface materials and paints used. All sizes and dimensions are illustrated for client's conception of project and are not to be understood as being exact size or exact scale.