

Work Authorization # 07
Water CIP Bond Program – Packages 1 - 4
KFA PROJECT # 0764
City of Rollingwood General Engineering Services

This work authorization is made pursuant to the terms and conditions of the original Professional Service Agreement dated **November 16, 2020**, by and between K Friese & Associates, Inc. and the City of Rollingwood

SERVICES PROVIDED BY K FRIESE & ASSOCIATES, INC.:

Refer to Attachment A for details.

DELIVERABLES: Refer to Attachment A for details.

DURATION:

This Agreement shall remain in effect until **November 30, 2024**, unless terminated as provided herein, or extended by mutual agreement in writing. This Agreement is subject in all respects to the Terms and Conditions attached hereto and incorporated herein by reference.

BUDGET: Lump Sum not to exceed **\$448,475.05**: Refer to Attachment B for details.

CLIENT:

CITY OF ROLLINGWOOD

K FRIESE & ASSOCIATES, INC.

SIGNED: _____

SIGNED: _____

TYPED NAME: Ashley Wayman

TYPED NAME: Thomas M. Owens, P.E.

TITLE: City Administrator

TITLE: Executive Vice President

DATE: _____

DATE: _____

Attachments:

Attachment A – Scope

Attachment B – Fees

Attachment C - Schedule

ATTACHMENT A – SCOPE OF SERVICES
CITY OF ROLLINGWOOD WATER CIP BOND PROGRAM
DESIGN SERVICES – PACKAGES 1-4

PROJECT DESCRIPTION

The City of Rollingwood (City) approved a Water Capital Improvements Plan (CIP) in 2022 that was prepared by K Friese + Associates (KFA). This CIP identified a total of 20 water system improvements projects needed to remedy system deficiencies. These 20 projects were the basis for a \$5.3 bond program that was approved by voters in November 2022. KFA developed a total of five bond packages for these 20 projects, and these packages were approved by the City in January 2023. The City has requested a proposal from KFA for the design services of Packages 1-4, and it is assumed that these four packages will be bid and constructed as a single construction package. These packages are described below:

- Package 1:
 - Approximately 1,350 LF of 8-inch PVC waterlines to increase fire flow availability within Jeffrey Cove, Southcrest Drive, Westgate Circle, Ewing Circle, and Michele Circle.
 - The survey and design of this package was previously completed in 2016. No additional survey is included in this scope; however, design effort is included for KFA to update the design and develop construction documents.
- Package 2:
 - Approximately 5,050 LF of 8-inch PVC waterlines to replace waterlines with repeated main break, increase low pressures, and increase fire flow availability. These waterlines are along Vale Street, Vance Lane, Bettis Boulevard, Pickwick Lane, and Inwood Road.
 - This package also includes the replacement of a pressure reducing valve (PRV) at the intersection of Hatley Drive and Almarion Drive
 - This package requires field survey and three geotechnical borings.
- Package 3:
 - Approximately 1,900 LF of 8-inch PVC waterlines to increase fire flow availability within Gentry Drive, Inwood Cove, Pleasant Cove, Timberline Ridge, and within an easement off of Timberline Drive.
 - This package also includes the installation of a new PRV along Bee Caves Road to serve the southeast portion of the City that is shown to have high pressures.
 - This package requires field survey.
- Package 4:
 - Approximately 2,550 LF of 8-inch PVC waterlines to increase fire flow availability within Park Hills Drive, Laura Lane, and Brett Cove.
 - This package requires field survey and one geotechnical boring.

This proposal also includes necessary environmental & cultural resources reviews covering all four (4) packages.

ATTACHMENT A – SCOPE OF SERVICES
CITY OF ROLLINGWOOD WATER CIP BOND PROGRAM
DESIGN SERVICES – PACKAGES 1-4

SCOPE OF SERVICES

KFA will provide engineering services in accordance with the terms and conditions of the Contract, including:

- Preliminary Engineering Services, including:
 - Field Surveying
 - Geotechnical Investigation
 - Environmental & Archaeological Investigation
- Design Phase Services

The scope of services to be provided is detailed in the following task descriptions. An additional contract will be required for bid phase and construction phase services for Bond Packages 1-4, and also for the design, bid, and construction of Bond Package 5.

1. Preliminary Engineering Services

- 1.1. Project Management - This task includes routine communication with the City, preparation of monthly project status reports; managing subconsultants, manpower, budgets, and schedules; invoicing; implementing and monitoring QA/QC efforts; and other activities associated with managing the project. A Project Kickoff Meeting with key subconsultants is included to review the scope, schedule, and requirements of the project.
- 1.2. Data Collection and Field Visits - KFA will collect available data from various sources including: existing utilities, GIS data, and as-built drawings of roadway/utility improvements. KFA will also perform site visits to identify and locate utility surface features and other potential conflicts to aid in setting the final pipeline alignments.
- 1.3. Environmental and Cultural Resources – Blanton & Associates will provide environmental support for the project as described in their attached Scope of Services. These services include desktop reviews for federally listed species, wetlands and waters of the U.S., hazardous materials, and historical and cultural resources. Blanton will prepare a report detailing the findings of the desktop reviews and recommendations.
- 1.4. Design Survey- Landmark Surveying (Landmark) will perform a design survey consisting of trees, surface features, property lines and 1-foot topographic lines. See attached Scope from Landmark for additional information.
- 1.5. Geotechnical Investigation - Raba Kistner Consultants, Inc. will perform 4 geotechnical borings, each 15-feet deep, along the project route; conduct appropriate laboratory testing; and summarize the field investigation results and bedding, earthwork, and pipe design recommendations in a Geotechnical Report.

ATTACHMENT A – SCOPE OF SERVICES
CITY OF ROLLINGWOOD WATER CIP BOND PROGRAM
DESIGN SERVICES – PACKAGES 1-4

2. Design Phase Services

- 2.1. Project Management - This task includes routine communication with the City, including attendance at four (4) Progress Meetings with City Staff, and preparation of monthly project status reports; managing manpower, budgets, and schedules; invoicing; implementing and monitoring QA/QC efforts; and other activities associated with managing the project.
- 2.2. QA/QC and Constructability Reviews - KFA will conduct both Project Design Team (PDT) and Independent Technical Review Team (ITRT) QA/QC reviews.
- 2.3. Plan Preparation - KFA will prepare construction plans (11"x17" sheets) suitable for public bidding to include cover, notes, quantities, project layout, plan sheets, traffic control plans, and details. Plan sheets for pipelines shall be at 1"=40' horizontal scale. For budgeting purposes, it is estimated that the plans will consist of 50 total sheets.
- 2.4. Contract Documents & Technical Specifications - KFA will develop a Project Manual consisting of Standard Construction Contract Bid Documents and Technical Specifications. Special Provisions to the Standard Technical Specifications and Special Specifications will be developed, if required for the project.
- 2.5. Engineer's Opinion of Probable Construction Cost - Cost estimates will be prepared/updated and will include a tabulated summary of quantities broken down by plan sheets.
- 2.6. Permitting – KFA will prepare the necessary documents for permitting the projects, including:
 - 2.6.1. TCEQ – KFA will prepare and submit the TCEQ Chapter 290 notification letter for the water projects. If TCEQ comments are received, KFA will address the comments for a resubmittal, as needed.
 - 2.6.2. TxDOT – KFA will prepare information and exhibits/plans for obtaining a TxDOT permit for the installation of the pressure reducing valve along Bee Caves Road. If TxDOT comments are received, KFA will address the comments for a resubmittal, as needed.
- 2.7. Design Submittal – It is assumed that a single 100% submittal will be included for this project, and will consist of the following:
 - One original set of plans
 - One original Project Manual
 - Electronic copy of plans and Project Manual
 - Engineer's Opinion of Probable Construction Cost
 - Updated project schedule

ATTACHMENT A – SCOPE OF SERVICES
CITY OF ROLLINGWOOD WATER CIP BOND PROGRAM
DESIGN SERVICES – PACKAGES 1-4

- Electronic files (AutoCAD) of the survey, basemap, and proposed pipeline alignments, including geotechnical bore hole locations.

GENERAL ASSUMPTIONS

1. No bid phase or construction phase services are included in this scope.
2. It is assumed that Bond Packages 1-4 will be bid as a single construction package.
3. The repaving for the projects will be limited to the pipeline trench width.
4. The Environmental and Cultural Resources scope of work is limited to desktop reviews only. If it is determined that field inspections, Geological Assessments, Karst surveys, or other efforts not included in Blanton's scope of work are required, additional services will be needed.
5. Traffic control will largely be limited to single lane closures and the use of City of Austin details. Traffic control plans will only be developed for road closures and detours, and construction within TxDOT right-of-way.
6. No proposed easements or work on private property outside of existing easements are expected for the project.
7. Utility relocations for water and wastewater utilities will be limited or not required. No relocations of dry utilities are included.
8. Subsurface utility engineering (SUE) is not included in this scope.
9. Impacts to regulated floodplains are not anticipated.
10. All review, inspection, and permit fees will be paid for directly by the Owner.
11. Owner will provide to KFA all data in Owner's possession relating to KFA's services on the Project. KFA will reasonably rely upon the accuracy, timeliness, and completeness of the information provided by the Owner.
12. Owner will give prompt notice to KFA whenever Owner observes or becomes aware of any development that affects the scope or timing of KFA's services.
13. The Owner shall examine information submitted by KFA and render in writing or otherwise provide comments and decisions in a timely manner.
14. The Project will proceed in a continuous manner with no significant delays.

Attachment B - KFA MANPOWER/BUDGET ESTIMATE
CITY OF ROLLINGWOOD WATER CIP BOND PROGRAM
DESIGN SERVICES – PACKAGES 1-4

2/13/2023

Hourly Bill Rate		\$ 275.00	\$ 185.00	\$ 180.00	\$ 110.00	\$ 120.00	\$ 90.00	Subconsultants					
Task	Quality Manager Hours	Project Manager Hours	Project Engineer Hours	EIT Hours	Senior CADD Operator Hours	Administration Hours	Total Labor Hours	Total Labor Cost	Landmark Cost	Raba Kistner Cost	Blanton Cost	Total Cost	
A PRELIMINARY ENGINEERING SERVICES													
1	Project Management		24	16	8		4	52	\$8,560.00			\$8,560.00	
2	Data Collection and Site Visits		8	16	16	8		48	\$7,080.00			\$7,080.00	
3	Environmental and Cultural Resources		2	2	2			6	\$950.00		\$18,695	\$19,645.00	
4	Design Survey		8	16	24	24		72	\$9,880.00	\$221,385.05		\$231,265.05	
5	Geotechnical Investigation		2	2	2	2		8	\$1,190.00		\$10,500	\$11,690.00	
	Task A Subtotal	0	44	52	52	34	4	186	\$27,660.00	\$221,385.05	\$10,500.00	\$18,695.00	\$278,240.05
B DESIGN PHASE SERVICES													
1	Project Management		24	16	12		4	56	\$9,000.00			\$9,000.00	
2	QA/QC and Constructability Reviews	64						64	\$17,600.00			\$17,600.00	
3	Plan Preparation		96	172	260	260		788	\$108,520.00			\$108,520.00	
	<i>Package 1</i>		8	12	20	20		60	\$8,240.00			\$8,240.00	
	<i>Package 2</i>		40	80	120	120		360	\$49,400.00			\$49,400.00	
	<i>Package 3</i>		24	40	60	60		184	\$25,440.00			\$25,440.00	
	<i>Package 4</i>		24	40	60	60		184	\$25,440.00			\$25,440.00	
4	Contract Documents and Technical Specifications		24	32	40			96	\$14,600.00			\$14,600.00	
5	Engineer's Opinion of Probable Construction Cost		16	24	40			80	\$11,680.00			\$11,680.00	
6	Permitting		9	14	20			43	\$6,385.00			\$6,385.00	
	<i>TCEQ</i>		1	2	4			7	\$985.00			\$985.00	
	<i>TxDOT</i>		8	12	16			36	\$5,400.00			\$5,400.00	
7	Design Submittals		2	4	8	4		18	\$2,450.00			\$2,450.00	
	Task B Subtotal	64	276	448	660	524	4	1976	\$170,235.00	\$0.00	\$0.00	\$0.00	\$170,235.00
	Project Totals	64	320	500	712	558	8	2162	\$197,895.00	\$221,385.05	\$10,500.00	\$18,695.00	\$448,475.05

CITY OF ROLLINGWOOD
WATER CIP BOND PROGRAM SCHEDULE - PACKAGES 1-4

ID	Task Mode	Task Name	Duration	Start	Finish	2023												2024											
						Feb	Mar	Apr	May	Jun	Jul	Aug	Sep	Oct	Nov	Dec	Jan	Feb	Mar	Apr	May	Jun	Jul	Aug	Sep	Oct	Nov		
1		City of Rollingwood Water Bond Packages 1-4	455 days	Mon 2/20/23	Fri 11/15/24	[Gantt bar spanning from Feb 2023 to Nov 2024]																							
2		Design	130 days	Mon 2/20/23	Fri 8/18/23	[Gantt bar spanning from Feb 2023 to Aug 2023]																							
3		Contracting & NTP	4 wks	Mon 2/20/23	Fri 3/17/23	[Gantt bar spanning from Feb 2023 to Mar 2023]																							
4		Package 1 - Cul De Sac Projects I, K, L, R, & S	25 days	Mon 3/20/23	Fri 4/21/23	[Gantt bar spanning from Mar 2023 to Apr 2023]																							
5		100% Design	4 wks	Mon 3/20/23	Fri 4/14/23	[Gantt bar spanning from Mar 2023 to Apr 2023]																							
6		QA/QC & Reproduction	1 wk	Mon 4/17/23	Fri 4/21/23	[Gantt bar spanning from Apr 2023 to Apr 2023]																							
7		Packages 2-4: Design, Survey, Environmental, Geotech	110 days	Mon 3/20/23	Fri 8/18/23	[Gantt bar spanning from Mar 2023 to Aug 2023]																							
8		Design Survey	100 days	Mon 3/20/23	Fri 8/4/23	[Gantt bar spanning from Mar 2023 to Aug 2023]																							
9		Draft Survey	12 wks	Mon 3/20/23	Fri 6/9/23	[Gantt bar spanning from Mar 2023 to Jun 2023]																							
10		Survey QA/QC and Final Survey Deliverable	8 wks	Mon 6/12/23	Fri 8/4/23	[Gantt bar spanning from Jun 2023 to Aug 2023]																							
11		Environmental & Cultural Resources Desktop Reviews	4 wks	Mon 3/20/23	Fri 4/14/23	[Gantt bar spanning from Mar 2023 to Apr 2023]																							
12		Geotechnical Borings and Reporting	6 wks	Mon 3/20/23	Fri 4/28/23	[Gantt bar spanning from Mar 2023 to Apr 2023]																							
13		Design	90 days	Mon 4/17/23	Fri 8/18/23	[Gantt bar spanning from Apr 2023 to Aug 2023]																							
14		Package 2 - Projects A - E	70 days	Mon 4/17/23	Fri 7/21/23	[Gantt bar spanning from Apr 2023 to Jul 2023]																							
15		100% Design	12 wks	Mon 4/17/23	Fri 7/7/23	[Gantt bar spanning from Apr 2023 to Jul 2023]																							
16		QA/QC & Reproduction	2 wks	Mon 7/10/23	Fri 7/21/23	[Gantt bar spanning from Jul 2023 to Jul 2023]																							
17		Package 3 - Projects G, H, J, M, N, & P	50 days	Mon 5/15/23	Fri 7/21/23	[Gantt bar spanning from May 2023 to Jul 2023]																							
18		100% Design	8 wks	Mon 5/15/23	Fri 7/7/23	[Gantt bar spanning from May 2023 to Jul 2023]																							
19		QA/QC & Reproduction	2 wks	Mon 7/10/23	Fri 7/21/23	[Gantt bar spanning from Jul 2023 to Jul 2023]																							
20		Package 4 - Projects F, Q, & T	50 days	Mon 6/12/23	Fri 8/18/23	[Gantt bar spanning from Jun 2023 to Aug 2023]																							
21		100% Design	8 wks	Mon 6/12/23	Fri 8/4/23	[Gantt bar spanning from Jun 2023 to Aug 2023]																							
22		QA/QC & Reproduction	2 wks	Mon 8/7/23	Fri 8/18/23	[Gantt bar spanning from Aug 2023 to Aug 2023]																							
23		Bid/Construction	325 days	Mon 8/21/23	Fri 11/15/24	[Gantt bar spanning from Aug 2023 to Nov 2024]																							
24		Bid	45 days	Mon 8/21/23	Fri 10/20/23	[Gantt bar spanning from Aug 2023 to Oct 2023]																							
25		Advertise & bid	4 wks	Mon 8/21/23	Fri 9/15/23	[Gantt bar spanning from Aug 2023 to Sep 2023]																							
26		Review Bids / Recommendation	1 wk	Mon 9/18/23	Fri 9/22/23	[Gantt bar spanning from Sep 2023 to Sep 2023]																							
27		Contract Execution	4 wks	Mon 9/25/23	Fri 10/20/23	[Gantt bar spanning from Sep 2023 to Oct 2023]																							
28		Construction	280 days	Fri 10/20/23	Fri 11/15/24	[Gantt bar spanning from Oct 2023 to Nov 2024]																							
29		Notice to Proceed	0 wks	Fri 10/20/23	Fri 10/20/23	[Milestone diamond at Oct 2023]																							
30		Construction	52 wks	Mon 10/23/23	Fri 10/18/24	[Gantt bar spanning from Oct 2023 to Oct 2024]																							
31		As-Builts	4 wks	Mon 10/21/24	Fri 11/15/24	[Gantt bar spanning from Oct 2024 to Nov 2024]																							

Project: Project Schedules_Initial Date: Tue 2/7/23	Task		Project Summary		Manual Task		Start-only		Deadline	
	Split		Inactive Task		Duration-only		Finish-only		Progress	
	Milestone		Inactive Milestone		Manual Summary Rollup		External Tasks		Manual Progress	
	Summary		Inactive Summary		Manual Summary		External Milestone			



January 27, 2023

Greg Blackburn, PE

Associate

K. Friese + Associates

1120 S. Capital of Texas Highway, CityView 2, Suite 100

Austin, Texas 78746

Phone: 512.338.1704, Fax: 512.338.1784

E-mail: gblackburn@kfriese.com

Re: **City of Rollingwood
Water CIP Bond Program
8" waterline replacements
Travis County, Texas**

Dear Mr. Blackburn:

Landmark Surveying, LP appreciates the opportunity to submit a cost proposal for professional land surveying services for the abovementioned project. The centerline survey limits for each site are described below and shown on the attached sketch labeled **Exhibit "A."** The design topographic survey will be within the City of Rollingwood right-of-way, except where noted, and the corridor widths will be right-of-way to right-of-way. There are fourteen (14) separate sites.

Project Locations/Project Descriptions:

1. **Park Hills/Brett Cove** – the centerline of Park Hills and Brett Cove, ending at Hatley Drive with three (3) additional segments, (see **Exhibit "A"**) for a total of 1,180 centerline linear feet for this project.
2. **Laura Lane/Michelle Circle/Chris Cove** – the centerline of Laura Lane, ending at Hatley Drive with four (4) additional segments, (see **Exhibit "A"**) for a total of 1,331 centerline linear feet for this project.
3. **Kristi Drive** - the centerline of Kristi Drive, ending at Ashworth Drive with two (2) additional segments, (see **Exhibit "A"**) for a total of 415 centerline linear feet for this project.
4. **Almarion Drive/Hatley Drive/Inwood Circle** - the centerline of Almarion Drive, with two (2) additional segments, (see **Exhibit "A"**) for a total of 357 centerline linear feet for this project.
5. **Vance Lane/Vale Street** – the centerline of Vance Lane and Vale Street, beginning at Riley Road/Paige Drive and ending at Rollingwood Drive with eight (8) additional segments, (see **Exhibit "A"**) for a total of 3,280 centerline linear feet for this project.
6. **Pleasant Cove** – the centerline of Pleasant Cove, ending at Hatley Drive with two (2) additional segments, (see **Exhibit "A"**) for a total of 738 centerline linear feet for this project.
7. **Pickwick Lane** – the centerline of Pickwick Lane, beginning 150 feet west of the intersection of Hubbard Circle and said Pickwick Lane, and ending at Riley Road with seven (7) additional segments, (see **Exhibit "A"**) for a total of 2,230 centerline linear feet for this project.

2205 East 5th Street
Austin, Texas 78702-4633
Phone: 512-328-7411, Fax: 512-328-7413
Texas Firm Registration No. 100727-00
WBE/HUB



8. **Bettis Boulevard** - the centerline of Bettis Boulevard, beginning at Inwood Road, and ending at Riley Road with five (5) additional segments, (see **Exhibit "A"**) for a total of 830 centerline linear feet for this project.
9. **Gentry Drive** - the centerline of Gentry Drive, beginning 138 feet east of the intersection of Sugar Creek Drive and said Gentry Drive, and ending at Ridgewood Road with four (4) additional segments, (see **Exhibit "A"**) for a total of 720 centerline linear feet for this project.
10. **Inwood Road/Rollingwood Road** - the centerline of Inwood Road, with four (4) additional segments, (see **Exhibit "A"**) for a total of 376 centerline linear feet for this project.
11. **Inwood Cove** - the centerline of Inwood Cove, ending at Timberline Drive with five (5) additional segments (see **Exhibit "A"**) for a total of 707 centerline linear feet for this project.
12. **4910/4914 Timberline Drive** –(see **Exhibit "A"**) for a total of 331 centerline linear feet for this project.
13. **Timberline Ridge** - the centerline of Timberline Ridge, ending at Timberline Drive with two (2) additional segments, (see **Exhibit "A"**) for a total of 424 centerline linear feet for this project.
14. **Chevron/Bee Cave Road** - 190 centerline linear feet, more or less, along Bee Cave Road on the east traffic lane (see **Exhibit "A"**) for this project.

Please note that the total centerline linear feet for all fourteen (14) project locations is estimated to be **13,109 feet** based on Google graphics with support of AutoCAD.

The following surveying tasks **ARE INCLUDED** for all **fourteen (14) locations**, as follows:

Task 1 Establish Horizontal and Vertical Control

In order to accomplish the tasks listed below, Landmark Surveying, LP will establish horizontal and vertical controls based on RTK GPS redundancy. The horizontal control network will be based on the Texas Coordinate System of 1983 having NAVD '88 elevations. Any additional control points established will be on the same horizontal and vertical datum. Differential leveling will be used to confirm or establish elevations. Temporary benchmarks will be set within the project limits for each site.

Task 2 Topographic Survey

Landmark Surveying, LP will provide a field survey and related office computations and CAD drafting for the project site as described in detail below:

Contours

Landmark Surveying, LP will provide a field survey and related office computations and CAD drafting for the areas listed above and described in detail below. Our field survey shall include a topographic and tree survey with sufficient ground shots to generate one-foot contours with additional cross-sections and spot elevations.

Tree Survey

Landmark Surveying, LP will identify, locate and tag trees 4-inch in diameter or wider within the street right-of-way, within the project limits. A tree list containing tag number, tree diameter and common name will be provided. The trees will be plotted according to City of Rollingwood Standards. In areas where the tree trunks are on private property, Landmark Surveying, LP will roughly outline the crown of trees that overhang the right-of-ways.



Utilities

Landmark Surveying, LP will provide the location and elevation of visible above-ground utilities within the survey limits such as, but not limited to, storm sewer inlets and outfalls, wastewater structures, utility manholes, water line vaults, culverts, pipe crossings, concrete pipe encasements, power poles, transformers, water valves, sprinkler control valves, water meters, telephone pedestals and cable TV pedestals.

Please note that the scope of this proposal **does not** include locating underground utility lines (Sub-surface Utility Engineering) or the horizontal and vertical data on existing or proposed bore holes. Lastly, Landmark Surveying, LP will notify and obtain tickets from “TEXAS 811” in order to locate visible painted marks of existing underground utilities, but **will not** plot record location of underground utilities from city utility maps. Existing landscaping and pavement markings shall be located. Landmark Surveying, LP will locate visible **water meters** that are within the limits of the project site only but **will not** locate wastewater cleanouts located on private property.

Manholes

Landmark Surveying, LP will open storm sewer and wastewater manholes that are visible and accessible at the time of our survey. Flow lines for said manholes and inlets, where visible and accessible, shall be obtained. Pipe size and material, based on crew observation, for storm sewer and wastewater systems within the survey limits will be provided. This task will be considered an additional service if manholes cannot be located visually at the time of the initial field survey because they are buried, paved over or beneath landscaping. If items are buried, paved over or beneath landscaping, than the surveyor may need the City of Rollingwood or other entities to provide special services to help uncover them. Associated costs are not included as a part of this proposal, and none are expected. Any time spent coordinating such efforts and time spent returning to the project site to locate such utilities will be considered an additional service. In addition, the surveyor **will not** be responsible for resurfacing, grading, or landscaping areas that have been disturbed.

Improvements

Landmark Surveying, LP will provide the location and elevations of visible surface improvements within the above-described survey limits such as, but not limited to, fences, concrete rip-rap, concrete slabs, areas of asphalt, traffic signs, retaining walls, driveways, signs, tree wells and curb and gutter.

Street and Right-of-Way Cross-Sections

Landmark Surveying, LP will obtain street cross-section elevations at 50 to 75-foot intervals including street centerline, edge of pavement, grade breaks and natural ground at the approximate right-of-ways, more or less.

Task 3 Approximate Property Lines and Right-of-Ways

Landmark Surveying, LP will locate sufficient monumentation to establish a graphic depiction of the approximate location of the record property lines and right-of-way lines within and abutting the project areas. However, please note that this is not a boundary survey. It is assumed for the purpose of this proposal that right-of-entry into private properties, if necessary, will be obtained by the City of Rollingwood. Ownership, based on tax records and recorded subdivision/deed information will be shown if available and known to the surveyor. Easements per record subdivision plats will be shown as they affect the right-of-way lines. Encumbrances, based on title commitments, affecting private unplatted property will not be provided and not part of this proposal.



Task 4 Correspondence, Traffic Control, Permitting, Clerical/Administrative and Quality Control Correspondence

Landmark Surveying, LP will maintain communications with the prime project manager and address any issues relating to safety, project schedule or other issues affecting the office and field support. Landmark may have several meetings and correspondence with the prime project engineer during the length of this project. Areas along Bee Caves Road or other areas may require traffic control by others at a cost of \$2,500.00 per day.

Traffic Control and Permitting

Traffic control, if required, will be billed as a separate item which runs about \$2,500.00 per day. This proposal is based on receiving traffic control permitting (ROWMAN), if required, prior to project start. Costs for this process beyond what is standard will be considered an additional service.

Quality Control Plan

Checks are in place at all levels, beginning with safety and field practice. Crew chiefs check in daily with project technicians, project managers and the project principal. Technicians work in liaison with the field crews and research staff so that questions which may arise are handled swiftly. The project manager oversees technical work daily and is subject to review and quality check by the drafting supervisor. A field check is made by the technician and or the Project Manager upon completion of the survey drawing. Upon final review and approval by the Project Manager (R.P.L.S.) and the Project Principal, the project drawings and other supporting data listed below (under "Deliverables") are submitted to the prime project engineer. Once this proposal is accepted, Landmark Surveying, LP can provide a Quality Control Plan (QCP), if requested.

Deliverables

Landmark Surveying, LP will provide an AutoCAD Civil 3D drawing and ASCII file of the surveyed points on grid format. Our CAD drawing will show existing improvements, approximate right of way lines, approximate record lot lines, visible utilities, 1-foot contours and spot elevations. In addition, Landmark Surveying, LP will provide information concerning our survey control, if requested. Upon request, copies of our field notes can be provided. A certified hard copy can be provided, if requested.

Projected Schedule and Fees

As of this date, Landmark Surveying, LP has estimated the **office work** to take twenty two (22) weeks and the **field work** to take eleven (11) weeks, more or less, upon receiving written or e-mail Notice to Proceed, weather permitting, excluding holidays. Landmark Surveying, LP estimates the not-to-exceed fee for all fourteen (14) site locations, including traffic control and permitting costs, if required, not to exceed **\$ 221,385.05**. Landmark requires a signed and executed subcontract agreement, between client and surveyor, and acceptable to the City of Rollingwood, prior to proceeding with the survey.

Additional Services, Budget, and Invoicing

Our work is performed on an hourly basis. You will be billed only for the hours worked. If we exceed the budget for the tasks herein described, you will not be billed for the amount over the not-to-exceed limit indicated above. However, a percentage will not be deducted from the final billing for unrequired work. Additional services beyond the scope of this estimate will be billed at our standard hourly rates and may



exceed the cost estimate provided. Changes to the existing project will constitute additional services and will be billed at our standard hourly rate. Billing will be according to City of Rollingwood requirements. Please find an itemized breakdown of the surveying tasks for this project site location on the following pages. Landmark Surveying, LP values your business and looks forward to working with you, K. Kriese and the City of Rollingwood on this and future projects.

Landmark Surveying, LP
Texas Firm Registration No. 100727-00
Respectfully,

Juan M. Canales, Jr.

Juan M. Canales, Jr., R.P.L.S.
Vice President of the General Partner
2205 East 5th Street
Austin, Texas 78702-4633
Phone: (512)-328-7411, ext. 111, Fax: (512)-328-7413
E-mail: juan@landmarksurveying.com



Professional Land Surveying Services
 Fee Schedule
City of Rollingwood
Water CIP Bond Program
8” waterline replacements
Travis County, Texas

1. Park Hills/Brett Cove

Task 1 Establish Horizontal and Vertical Control

Staff	Max. Hrs.	Labor Rate	Total Cost
Supervisory Land Surveyor (PP) Dana Markus-Wolf	2	\$211.28/hr.	\$ 422.56
Supervisory Land Surveyor (PM) Juan Canales, Jr.	2	\$203.60/hr.	\$ 407.20
Administrative Specialist IV	1	\$115.24/hr.	\$ 115.24
2-Person Field Crew	8	\$175.00/hr.	\$ 1,400.00
Surveyor Technician V	4	\$134.45/hr.	\$ 537.80
Surveyor Technician IV	2	\$122.93/hr.	\$ 245.86
		Subtotal	\$ 3,128.66

Task 2 Topographic Survey

Staff	Max. Hrs.	Labor Rate	Total Cost
Supervisory Land Surveyor (PP) Dana Markus-Wolf	2	\$211.28/hr.	\$ 422.56
Supervisory Land Surveyor (PM) Juan Canales, Jr.	2	\$203.60/hr.	\$ 407.20
Administrative Specialist IV	2	\$115.24/hr.	\$ 230.48
2-Person Field Crew	12	\$175.00/hr.	\$ 2,100.00
Surveyor Technician V	8	\$134.45/hr.	\$ 1,075.60
Surveyor Technician IV	36	\$122.93/hr.	\$ 4,425.48
		Subtotal	\$ 8,661.32

Task 3 Property Lines and Right-of-Ways

Staff	Max. Hrs.	Labor Rate	Total Cost
Supervisory Land Surveyor (PP) Dana Markus-Wolf	2	\$211.28/hr.	\$ 422.56
Supervisory Land Surveyor (PM) Juan Canales, Jr.	2	\$203.60/hr.	\$ 407.20
Administrative Specialist IV	2	\$115.24/hr.	\$ 230.48
2-Person Field Crew	8	\$175.00/hr.	\$ 1,400.00
Surveyor Technician V	8	\$134.45/hr.	\$ 1,075.60
Surveyor Technician IV	4	\$122.93/hr.	\$ 491.72
		Subtotal	\$ 4,027.56



Task 4 Correspondence, Traffic Control and Permitting, Clerical/Administrative and Quality Control

Staff	Max. Hrs.	Labor Rate	Total Cost
Supervisory Land Surveyor (PP) Dana Markus-Wolf	2	\$211.28/hr.	\$ 422.56
Supervisory Land Surveyor (PM) Juan Canales, Jr.	2	\$203.60/hr.	\$ 407.20
Administrative Specialist IV	1	\$115.24/hr.	\$ 115.24
Surveyor Technician V	4	\$134.45/hr.	\$ 537.80
Surveyor Technician IV	8	\$122.93/hr.	\$ 983.44
		Subtotal	\$ 2,466.24
Total (Tasks 1 through 4) for Park Hills/Brett Cove			\$ 18,283.78

2. Laura Lane/Michelle Circle/Chris Cove

Task 1 Establish Horizontal and Vertical Control

Staff	Max. Hrs.	Labor Rate	Total Cost
Supervisory Land Surveyor (PP) Dana Markus-Wolf	2	\$211.28/hr.	\$ 422.56
Supervisory Land Surveyor (PM) Juan Canales, Jr.	2	\$203.60/hr.	\$ 407.20
Administrative Specialist IV	1	\$115.24/hr.	\$ 115.24
2-Person Field Crew	8	\$175.00/hr.	\$ 1,400.00
Surveyor Technician V	4	\$134.45/hr.	\$ 537.80
Surveyor Technician IV	2	\$122.93/hr.	\$ 245.86
		Subtotal	\$ 3,128.66

Task 2 Topographic Survey

Staff	Max. Hrs.	Labor Rate	Total Cost
Supervisory Land Surveyor (PP) Dana Markus-Wolf	2	\$211.28/hr.	\$ 422.56
Supervisory Land Surveyor (PM) Juan Canales, Jr.	4	\$203.60/hr.	\$ 814.40
Administrative Specialist IV	2	\$115.24/hr.	\$ 230.48
2-Person Field Crew	16	\$175.00/hr.	\$ 2,800.00
Surveyor Technician V	10	\$134.45/hr.	\$ 1,344.50
Surveyor Technician IV	40	\$122.93/hr.	\$ 4,917.20
		Subtotal	\$ 10,529.14

Task 3 Property Lines and Right-of-Ways

Staff	Max. Hrs.	Labor Rate	Total Cost
Supervisory Land Surveyor (PP) Dana Markus-Wolf	2	\$211.28/hr.	\$ 422.56
Supervisory Land Surveyor (PM) Juan Canales, Jr.	2	\$203.60/hr.	\$ 407.20
Administrative Specialist IV	2	\$115.24/hr.	\$ 230.48
2-Person Field Crew	8	\$175.00/hr.	\$ 1,400.00



Surveyor Technician V	8	\$134.45/hr.	\$ 1,075.60
Surveyor Technician IV	4	\$122.93/hr.	\$ 491.72
		Subtotal	\$ 4,027.56

Task 4 Correspondence, Traffic Control and Permitting, Clerical/Administrative and Quality Control

Staff	Max. Hrs.	Labor Rate	Total Cost
Supervisory Land Surveyor (PP) Dana Markus-Wolf	2	\$211.28/hr.	\$ 422.56
Supervisory Land Surveyor (PM) Juan Canales, Jr.	2	\$203.60/hr.	\$ 407.20
Administrative Specialist IV	1	\$115.24/hr.	\$ 115.24
Surveyor Technician V	4	\$134.45/hr.	\$ 537.80
Surveyor Technician IV	8	\$122.93/hr.	\$ 983.44
		Subtotal	\$ 2,466.24

Total (Tasks 1 through 4) for **Laura Lane/Michelle Circle/Chris Cove** **\$ 20,151.60**

3. Kristy Drive

Task 1 Establish Horizontal and Vertical Control

Staff	Max. Hrs.	Labor Rate	Total Cost
Supervisory Land Surveyor (PP) Dana Markus-Wolf	.5	\$211.28/hr.	\$ 105.64
Supervisory Land Surveyor (PM) Juan Canales, Jr.	1	\$203.60/hr.	\$ 203.60
Administrative Specialist IV	.5	\$115.24/hr.	\$ 57.62
2-Person Field Crew	2	\$175.00/hr.	\$ 350.00
Surveyor Technician V	2	\$134.45/hr.	\$ 268.90
Surveyor Technician IV	2	\$122.93/hr.	\$ 245.86
		Subtotal	\$ 1,231.62

Task 2 Topographic Survey

Staff	Max. Hrs.	Labor Rate	Total Cost
Supervisory Land Surveyor (PP) Dana Markus-Wolf	.5	\$211.28/hr.	\$ 105.64
Supervisory Land Surveyor (PM) Juan Canales, Jr.	1	\$203.60/hr.	\$ 203.60
Administrative Specialist IV	.5	\$115.24/hr.	\$ 57.62
2-Person Field Crew	8	\$175.00/hr.	\$ 1,400.00
Surveyor Technician V	2	\$134.45/hr.	\$ 268.90
Surveyor Technician IV	8	\$122.93/hr.	\$ 983.44
		Subtotal	\$ 3,019.20



Task 3 Property Lines and Right-of-Ways

Staff	Max. Hrs.	Labor Rate	Total Cost
Supervisory Land Surveyor (PP) Dana Markus-Wolf	.5	\$211.28/hr.	\$ 105.64
Supervisory Land Surveyor (PM) Juan Canales, Jr.	1	\$203.60/hr.	\$ 203.60
Administrative Specialist IV	.5	\$115.24/hr.	\$ 57.62
2-Person Field Crew	2	\$175.00/hr.	\$ 350.00
Surveyor Technician V	2	\$134.45/hr.	\$ 268.90
Surveyor Technician IV	2	\$122.93/hr.	\$ 245.86
		Subtotal	\$ 1,231.62

Task 4 Correspondence, Traffic Control and Permitting, Clerical/Administrative and Quality Control

Staff	Max. Hrs.	Labor Rate	Total Cost
Supervisory Land Surveyor (PP) Dana Markus-Wolf	.5	\$211.28/hr.	\$ 105.64
Supervisory Land Surveyor (PM) Juan Canales, Jr.	1	\$203.60/hr.	\$ 203.60
Administrative Specialist IV	.5	\$115.24/hr.	\$ 57.62
Surveyor Technician V	2	\$134.45/hr.	\$ 268.90
Surveyor Technician IV	2	\$122.93/hr.	\$ 245.86
		Subtotal	\$ 881.62

Total (Tasks 1 through 4) for **Kristy Drive** \$ **6,364.06**

4. Almarion Drive/Hatley Drive/Inwood Circle

Task 1 Establish Horizontal and Vertical Control

Staff	Max. Hrs.	Labor Rate	Total Cost
Supervisory Land Surveyor (PP) Dana Markus-Wolf	.5	\$211.28/hr.	\$ 105.64
Supervisory Land Surveyor (PM) Juan Canales, Jr.	.5	\$203.60/hr.	\$ 101.80
Administrative Specialist IV	.5	\$115.24/hr.	\$ 57.62
2-Person Field Crew	2	\$175.00/hr.	\$ 350.00
Surveyor Technician V	1	\$134.45/hr.	\$ 134.45
Surveyor Technician IV	2	\$122.93/hr.	\$ 245.86
		Subtotal	\$ 995.37

Task 2 Topographic Survey

Staff	Max. Hrs.	Labor Rate	Total Cost
Supervisory Land Surveyor (PP) Dana Markus-Wolf	0.5	\$211.28/hr.	\$ 105.64
Supervisory Land Surveyor (PM) Juan Canales, Jr.	0.5	\$203.60/hr.	\$ 101.80
Administrative Specialist IV	0.5	\$115.24/hr.	\$ 57.62
2-Person Field Crew	8	\$175.00/hr.	\$ 1,400.00



Surveyor Technician V	2	\$134.45/hr.	\$ 268.90
Surveyor Technician IV	8	\$122.93/hr.	\$ 983.44
		Subtotal	\$ 2,917.40

Task 3 Property Lines and Right-of-Ways

Staff	Max. Hrs.	Labor Rate	Total Cost
Supervisory Land Surveyor (PP) Dana Markus-Wolf	.5	\$211.28/hr.	\$ 105.64
Supervisory Land Surveyor (PM) Juan Canales, Jr.	.5	\$203.60/hr.	\$ 101.80
Administrative Specialist IV	.5	\$115.24/hr.	\$ 57.62
2-Person Field Crew	2	\$175.00/hr.	\$ 350.00
Surveyor Technician V	2	\$134.45/hr.	\$ 268.90
Surveyor Technician IV	2	\$122.93/hr.	\$ 245.86
		Subtotal	\$ 1,129.82

Task 4 Correspondence, Traffic Control and Permitting, Clerical/Administrative and Quality Control

Staff	Max. Hrs.	Labor Rate	Total Cost
Supervisory Land Surveyor (PP) Dana Markus-Wolf	.5	\$211.28/hr.	\$ 105.64
Supervisory Land Surveyor (PM) Juan Canales, Jr.	.5	\$203.60/hr.	\$ 101.80
Administrative Specialist IV	.5	\$115.24/hr.	\$ 57.62
Surveyor Technician V	1	\$134.45/hr.	\$ 134.45
Surveyor Technician IV	2	\$122.93/hr.	\$ 245.86
		Subtotal	\$ 645.37

Total (Tasks 1 through 4) for **Almarion Way/Hatley Drive/Inwood Circle** \$ 5,687.96

5. Vance Lane/Vale Street

Task 1 Establish Horizontal and Vertical Control

Staff	Max. Hrs.	Labor Rate	Total Cost
Supervisory Land Surveyor (PP) Dana Markus-Wolf	2	\$211.28/hr.	\$ 422.56
Supervisory Land Surveyor (PM) Juan Canales, Jr.	2	\$203.60/hr.	\$ 407.20
Administrative Specialist IV	8	\$115.24/hr.	\$ 921.92
2-Person Field Crew	16	\$175.00/hr.	\$ 2,800.00
Surveyor Technician V	10	\$134.45/hr.	\$ 1,344.50
Surveyor Technician IV	10	\$122.93/hr.	\$ 1,229.30
		Subtotal	\$ 7,125.48



Task 2 Topographic Survey

Staff	Max. Hrs.	Labor Rate	Total Cost
Supervisory Land Surveyor (PP) Dana Markus-Wolf	2	\$211.28/hr.	\$ 422.56
Supervisory Land Surveyor (PM) Juan Canales, Jr.	12	\$203.60/hr.	\$ 2,443.20
Administrative Specialist IV	8	\$115.24/hr.	\$ 921.92
2-Person Field Crew	50	\$175.00/hr.	\$ 8,750.00
Surveyor Technician V	12	\$134.45/hr.	\$ 1,613.40
Surveyor Technician IV	60	\$122.93/hr.	\$ 7,375.80
		Subtotal	\$ 21,526.88

Task 3 Property Lines and Right-of-Ways

Staff	Max. Hrs.	Labor Rate	Total Cost
Supervisory Land Surveyor (PP) Dana Markus-Wolf	2	\$211.28/hr.	\$ 422.56
Supervisory Land Surveyor (PM) Juan Canales, Jr.	8	\$203.60/hr.	\$ 1,628.80
Administrative Specialist IV	8	\$115.24/hr.	\$ 921.92
2-Person Field Crew	40	\$175.00/hr.	\$ 7,000.00
Surveyor Technician V	12	\$134.45/hr.	\$ 1,613.40
Surveyor Technician IV	40	\$122.93/hr.	\$ 4,917.20
		Subtotal	\$ 16,503.88

Task 4 Correspondence, Traffic Control and Permitting, Clerical/Administrative and Quality Control

Staff	Max. Hrs.	Labor Rate	Total Cost
Supervisory Land Surveyor (PP) Dana Markus-Wolf	2	\$211.28/hr.	\$ 422.56
Supervisory Land Surveyor (PM) Juan Canales, Jr.	2	\$203.60/hr.	\$ 407.20
Administrative Specialist IV	2	\$115.24/hr.	\$ 230.48
Surveyor Technician V	10	\$134.45/hr.	\$ 1,344.50
Surveyor Technician IV	16	\$122.93/hr.	\$ 1,966.88
		Subtotal	\$ 4,371.62

Total (Tasks 1 through 4) for **Vance Lane/Vale Street** **\$ 49,527.86**

6. Pleasant Cove

Task 1 Establish Horizontal and Vertical Control

Staff	Max. Hrs.	Labor Rate	Total Cost
Supervisory Land Surveyor (PP) Dana Markus-Wolf	.5	\$211.28/hr.	\$ 105.64
Supervisory Land Surveyor (PM) Juan Canales, Jr.	.5	\$203.60/hr.	\$ 101.80
Administrative Specialist IV	.5	\$115.24/hr.	\$ 57.62
2-Person Field Crew	4	\$175.00/hr.	\$ 700.00



Surveyor Technician V	1	\$134.45/hr.	\$ 134.45
Surveyor Technician IV	1	\$122.93/hr.	\$ 122.93
		Subtotal	\$ 1,222.44

Task 2 Topographic Survey

Staff	Max. Hrs.	Labor Rate	Total Cost
Supervisory Land Surveyor (PP) Dana Markus-Wolf	.5	\$211.28/hr.	\$ 105.64
Supervisory Land Surveyor (PM) Juan Canales, Jr.	.5	\$203.60/hr.	\$ 101.80
Administrative Specialist IV	.5	\$115.24/hr.	\$ 57.62
2-Person Field Crew	10	\$175.00/hr.	\$ 1,750.00
Surveyor Technician V	4	\$134.45/hr.	\$ 537.80
Surveyor Technician IV	30	\$122.93/hr.	\$ 3,687.90
		Subtotal	\$ 6,240.76

Task 3 Property Lines and Right-of-Ways

Staff	Max. Hrs.	Labor Rate	Total Cost
Supervisory Land Surveyor (PP) Dana Markus-Wolf	.5	\$211.28/hr.	\$ 105.64
Supervisory Land Surveyor (PM) Juan Canales, Jr.	.5	\$203.60/hr.	\$ 101.80
Administrative Specialist IV	.5	\$115.24/hr.	\$ 57.62
2-Person Field Crew	8	\$175.00/hr.	\$ 1,400.00
Surveyor Technician V	2	\$134.45/hr.	\$ 268.90
Surveyor Technician IV	10	\$122.93/hr.	\$ 1,229.93
		Subtotal	\$ 3,163.26

Task 4 Correspondence, Traffic Control and Permitting, Clerical/Administrative and Quality Control

Staff	Max. Hrs.	Labor Rate	Total Cost
Supervisory Land Surveyor (PP) Dana Markus-Wolf	.5	\$211.28/hr.	\$ 105.64
Supervisory Land Surveyor (PM) Juan Canales, Jr.	.5	\$203.60/hr.	\$ 101.80
Administrative Specialist IV	.5	\$115.24/hr.	\$ 57.62
Surveyor Technician V	1	\$134.45/hr.	\$ 134.45
Surveyor Technician IV	6	\$122.93/hr.	\$ 737.58
		Subtotal	\$ 1,137.09

Total (Tasks 1 through 4) for **Pleasant Cove** **\$ 11,763.55**



7. Pickwick Lane

Task 1 Establish Horizontal and Vertical Control

Staff	Max. Hrs.	Labor Rate	Total Cost
Supervisory Land Surveyor (PP) Dana Markus-Wolf	1	\$211.28/hr.	\$ 211.28
Supervisory Land Surveyor (PM) Juan Canales, Jr.	2	\$203.60/hr.	\$ 407.20
Administrative Specialist IV	2	\$115.24/hr.	\$ 230.48
2-Person Field Crew	16	\$175.00/hr.	\$ 2,800.00
Surveyor Technician V	2	\$134.45/hr.	\$ 268.90
Surveyor Technician IV	2	\$122.93/hr.	\$ 245.86
		Subtotal	\$ 4,163.72

Task 2 Topographic Survey

Staff	Max. Hrs.	Labor Rate	Total Cost
Supervisory Land Surveyor (PP) Dana Markus-Wolf	1	\$211.28/hr.	\$ 211.28
Supervisory Land Surveyor (PM) Juan Canales, Jr.	2	\$203.60/hr.	\$ 407.20
Administrative Specialist IV	2	\$115.24/hr.	\$ 230.48
2-Person Field Crew	40	\$175.00/hr.	\$ 7,000.00
Surveyor Technician V	8	\$134.45/hr.	\$ 1,075.60
Surveyor Technician IV	80	\$122.93/hr.	\$ 9,834.40
		Subtotal	\$ 18,758.96

Task 3 Property Lines and Right-of-Ways

Staff	Max. Hrs.	Labor Rate	Total Cost
Supervisory Land Surveyor (PP) Dana Markus-Wolf	1	\$211.28/hr.	\$ 211.28
Supervisory Land Surveyor (PM) Juan Canales, Jr.	2	\$203.60/hr.	\$ 407.20
Administrative Specialist IV	2	\$115.24/hr.	\$ 230.48
2-Person Field Crew	20	\$175.00/hr.	\$ 3,500.00
Surveyor Technician V	2	\$134.45/hr.	\$ 268.90
Surveyor Technician IV	40	\$122.93/hr.	\$ 4,917.20
		Subtotal	\$ 9,535.06

Task 4 Correspondence, Traffic Control and Permitting, Clerical/Administrative and Quality Control

Staff	Max. Hrs.	Labor Rate	Total Cost
Supervisory Land Surveyor (PP) Dana Markus-Wolf	1	\$211.28/hr.	\$ 211.28
Supervisory Land Surveyor (PM) Juan Canales, Jr.	1	\$203.60/hr.	\$ 203.60
Administrative Specialist IV	2	\$115.24/hr.	\$ 230.48
Surveyor Technician V	2	\$134.45/hr.	\$ 268.90



Surveyor Technician IV	8	\$122.93/hr.	\$ 983.44
		Subtotal	\$ 1,897.70
Total (Tasks 1 through 4) for Pickwick Lane			\$ 34,355.44

8. Bettis Boulevard

Task 1 Establish Horizontal and Vertical Control

Staff	Max. Hrs.	Labor Rate	Total Cost
Supervisory Land Surveyor (PP) Dana Markus-Wolf	.5	\$211.28/hr.	\$ 105.64
Supervisory Land Surveyor (PM) Juan Canales, Jr.	.5	\$203.60/hr.	\$ 101.80
Administrative Specialist IV	.5	\$115.24/hr.	\$ 57.62
2-Person Field Crew	4	\$175.00/hr.	\$ 700.00
Surveyor Technician V	1	\$134.45/hr.	\$ 134.45
Surveyor Technician IV	1	\$122.93/hr.	\$ 122.93
		Subtotal	\$ 1,222.44

Task 2 Topographic Survey

Staff	Max. Hrs.	Labor Rate	Total Cost
Supervisory Land Surveyor (PP) Dana Markus-Wolf	.5	\$211.28/hr.	\$ 105.64
Supervisory Land Surveyor (PM) Juan Canales, Jr.	.5	\$203.60/hr.	\$ 101.80
Administrative Specialist IV	.5	\$115.24/hr.	\$ 57.62
2-Person Field Crew	12	\$175.00/hr.	\$ 2,100.00
Surveyor Technician V	4	\$134.45/hr.	\$ 537.80
Surveyor Technician IV	30	\$122.93/hr.	\$ 3,687.90
		Subtotal	\$ 6,590.76

Task 3 Property Lines and Right-of-Ways

Staff	Max. Hrs.	Labor Rate	Total Cost
Supervisory Land Surveyor (PP) Dana Markus-Wolf	.5	\$211.28/hr.	\$ 105.64
Supervisory Land Surveyor (PM) Juan Canales, Jr.	.5	\$203.60/hr.	\$ 101.80
Administrative Specialist IV	.5	\$115.24/hr.	\$ 57.62
2-Person Field Crew	12	\$175.00/hr.	\$ 2,100.00
Surveyor Technician V	2	\$134.45/hr.	\$ 268.90
Surveyor Technician IV	10	\$122.93/hr.	\$ 1,229.30
		Subtotal	\$ 3,863.26



Task 4 Correspondence, Traffic Control and Permitting, Clerical/Administrative and Quality Control

Staff	Max. Hrs.	Labor Rate	Total Cost
Supervisory Land Surveyor (PP) Dana Markus-Wolf	.5	\$211.28/hr.	\$ 105.64
Supervisory Land Surveyor (PM) Juan Canales, Jr.	.5	\$203.60/hr.	\$ 101.80
Administrative Specialist IV	.5	\$115.24/hr.	\$ 57.62
Surveyor Technician V	1	\$134.45/hr.	\$ 134.45
Surveyor Technician IV	6	\$122.93/hr.	\$ 737.58
		Subtotal	\$ 1,137.09
Total (Tasks 1 through 4) for Bettis Boulevard			\$ 12,813.55

9. Gentry Drive

Task 1 Establish Horizontal and Vertical Control

Staff	Max. Hrs.	Labor Rate	Total Cost
Supervisory Land Surveyor (PP) Dana Markus-Wolf	.5	\$211.28/hr.	\$ 105.64
Supervisory Land Surveyor (PM) Juan Canales, Jr.	.5	\$203.60/hr.	\$ 101.80
Administrative Specialist IV	.5	\$115.24/hr.	\$ 57.62
2-Person Field Crew	2	\$175.00/hr.	\$ 350.00
Surveyor Technician V	1	\$134.45/hr.	\$ 134.45
Surveyor Technician IV	1	\$122.93/hr.	\$ 122.93
		Subtotal	\$ 872.44

Task 2 Topographic Survey

Staff	Max. Hrs.	Labor Rate	Total Cost
Supervisory Land Surveyor (PP) Dana Markus-Wolf	.5	\$211.28/hr.	\$ 105.64
Supervisory Land Surveyor (PM) Juan Canales, Jr.	.5	\$203.60/hr.	\$ 101.80
Administrative Specialist IV	2	\$115.24/hr.	\$ 57.62
2-Person Field Crew	10	\$175.00/hr.	\$ 1,750.00
Surveyor Technician V	4	\$134.45/hr.	\$ 537.80
Surveyor Technician IV	30	\$122.93/hr.	\$ 3,687.90
		Subtotal	\$ 6,240.76

Task 3 Property Lines and Right-of-Ways

Staff	Max. Hrs.	Labor Rate	Total Cost
Supervisory Land Surveyor (PP) Dana Markus-Wolf	.5	\$211.28/hr.	\$ 105.64
Supervisory Land Surveyor (PM) Juan Canales, Jr.	.5	\$203.60/hr.	\$ 101.80
Administrative Specialist IV	.5	\$115.24/hr.	\$ 57.62
2-Person Field Crew	6	\$175.00/hr.	\$ 1,050.00



Surveyor Technician V	1	\$134.45/hr.	\$ 134.45
Surveyor Technician IV	10	\$122.93/hr.	\$ 1,229.30
		Subtotal	\$ 2,678.81

Task 4 Correspondence, Traffic Control and Permitting, Clerical/Administrative and Quality Control

Staff	Max. Hrs.	Labor Rate	Total Cost
Supervisory Land Surveyor (PP) Dana Markus-Wolf	.5	\$211.28/hr.	\$ 105.64
Supervisory Land Surveyor (PM) Juan Canales, Jr.	.5	\$203.60/hr.	\$ 101.80
Administrative Specialist IV	.5	\$115.24/hr.	\$ 57.62
Surveyor Technician V	1	\$134.45/hr.	\$ 134.45
Surveyor Technician IV	6	\$122.93/hr.	\$ 737.58
		Subtotal	\$ 1,137.09

Total (Tasks 1 through 4) for **Gentry Drive** **\$ 10,929.10**

10. Inwood Cove/Rollingwood Road

Task 1 Establish Horizontal and Vertical Control

Staff	Max. Hrs.	Labor Rate	Total Cost
Supervisory Land Surveyor (PP) Dana Markus-Wolf	.5	\$211.28/hr.	\$ 105.64
Supervisory Land Surveyor (PM) Juan Canales, Jr.	.5	\$203.60/hr.	\$ 101.80
Administrative Specialist IV	.5	\$115.24/hr.	\$ 57.62
2-Person Field Crew	2	\$175.00/hr.	\$ 350.00
Surveyor Technician V	1	\$134.45/hr.	\$ 134.45
Surveyor Technician IV	2	\$122.93/hr.	\$ 245.86
		Subtotal	\$ 995.37

Task 2 Topographic Survey

Staff	Max. Hrs.	Labor Rate	Total Cost
Supervisory Land Surveyor (PP) Dana Markus-Wolf	.5	\$211.28/hr.	\$ 105.64
Supervisory Land Surveyor (PM) Juan Canales, Jr.	.5	\$203.60/hr.	\$ 101.80
Administrative Specialist IV	.5	\$115.24/hr.	\$ 57.62
2-Person Field Crew	8	\$175.00/hr.	\$ 1,400.00
Surveyor Technician V	1	\$134.45/hr.	\$ 134.45
Surveyor Technician IV	10	\$122.93/hr.	\$ 1,229.30
		Subtotal	\$ 3,028.81



Task 3 Property Lines and Right-of-Ways

Staff	Max. Hrs.	Labor Rate	Total Cost
Supervisory Land Surveyor (PP) Dana Markus-Wolf	.5	\$211.28/hr.	\$ 105.64
Supervisory Land Surveyor (PM) Juan Canales, Jr.	.5	\$203.60/hr.	\$ 101.80
Administrative Specialist IV	.5	\$115.24/hr.	\$ 57.62
2-Person Field Crew	4	\$175.00/hr.	\$ 700.00
Surveyor Technician V	1	\$134.45/hr.	\$ 134.45
Surveyor Technician IV	8	\$122.93/hr.	\$ 983.44
		Subtotal	\$ 2,082.95

Task 4 Correspondence, Traffic Control and Permitting, Clerical/Administrative and Quality Control

Staff	Max. Hrs.	Labor Rate	Total Cost
Supervisory Land Surveyor (PP) Dana Markus-Wolf	.5	\$211.28/hr.	\$ 105.64
Supervisory Land Surveyor (PM) Juan Canales, Jr.	.5	\$203.60/hr.	\$ 101.80
Administrative Specialist IV	.5	\$115.24/hr.	\$ 57.62
Surveyor Technician V	1	\$134.45/hr.	\$ 134.45
Surveyor Technician IV	2	\$122.93/hr.	\$ 245.86
		Subtotal	\$ 645.37

Total (Tasks 1 through 4) for **Inwood Cove/Rollingwood Road** \$ **6,752.50**

11. Inwood Cove

Task 1 Establish Horizontal and Vertical Control

Staff	Max. Hrs.	Labor Rate	Total Cost
Supervisory Land Surveyor (PP) Dana Markus-Wolf	.5	\$211.28/hr.	\$ 105.64
Supervisory Land Surveyor (PM) Juan Canales, Jr.	.5	\$203.60/hr.	\$ 101.80
Administrative Specialist IV	.5	\$115.24/hr.	\$ 57.62
2-Person Field Crew	4	\$175.00/hr.	\$ 700.00
Surveyor Technician V	2	\$134.45/hr.	\$ 268.90
Surveyor Technician IV	1	\$122.93/hr.	\$ 122.93
		Subtotal	\$ 1,356.89

Task 2 Topographic Survey

Staff	Max. Hrs.	Labor Rate	Total Cost
Supervisory Land Surveyor (PP) Dana Markus-Wolf	.5	\$211.28/hr.	\$ 105.64
Supervisory Land Surveyor (PM) Juan Canales, Jr.	.5	\$203.60/hr.	\$ 101.80
Administrative Specialist IV	.5	\$115.24/hr.	\$ 57.62
2-Person Field Crew	12	\$175.00/hr.	\$ 2,100.00



Surveyor Technician V	2	\$134.45/hr.	\$ 268.90
Surveyor Technician IV	15	\$122.93/hr.	\$ 1,843.95
		Subtotal	\$ 4,477.91

Task 3 Property Lines and Right-of-Ways

Staff	Max. Hrs.	Labor Rate	Total Cost
Supervisory Land Surveyor (PP) Dana Markus-Wolf	.5	\$211.28/hr.	\$ 105.64
Supervisory Land Surveyor (PM) Juan Canales, Jr.	.5	\$203.60/hr.	\$ 101.80
Administrative Specialist IV	.5	\$115.24/hr.	\$ 57.62
2-Person Field Crew	12	\$175.00/hr.	\$ 2,100.00
Surveyor Technician V	2	\$134.45/hr.	\$ 268.90
Surveyor Technician IV	15	\$122.93/hr.	\$ 1,843.95
		Subtotal	\$ 4,477.91

Task 4 Correspondence, Traffic Control and Permitting, Clerical/Administrative and Quality Control

Staff	Max. Hrs.	Labor Rate	Total Cost
Supervisory Land Surveyor (PP) Dana Markus-Wolf	.5	\$211.28/hr.	\$ 105.64
Supervisory Land Surveyor (PM) Juan Canales, Jr.	.5	\$203.60/hr.	\$ 101.80
Administrative Specialist IV	.5	\$115.24/hr.	\$ 57.62
Surveyor Technician V	2	\$134.45/hr.	\$ 268.90
Surveyor Technician IV	2	\$122.93/hr.	\$ 245.86
		Subtotal	\$ 779.82

Total (Tasks 1 through 4) for **Inwood Cove** **\$ 11,092.53**

12. 4910/4914 Timberline Driven

Task 1 Establish Horizontal and Vertical Control

Staff	Max. Hrs.	Labor Rate	Total Cost
Supervisory Land Surveyor (PP) Dana Markus-Wolf	.5	\$211.28/hr.	\$ 105.64
Supervisory Land Surveyor (PM) Juan Canales, Jr.	.5	\$203.60/hr.	\$ 101.80
Administrative Specialist IV	.5	\$115.24/hr.	\$ 57.62
2-Person Field Crew	1	\$175.00/hr.	\$ 175.00
Surveyor Technician V	1	\$134.45/hr.	\$ 134.45
Surveyor Technician IV	2	\$122.93/hr.	\$ 245.86
		Subtotal	\$ 820.37



Task 2 Topographic Survey

Staff	Max. Hrs.	Labor Rate	Total Cost
Supervisory Land Surveyor (PP) Dana Markus-Wolf	.5	\$211.28/hr.	\$ 105.64
Supervisory Land Surveyor (PM) Juan Canales, Jr.	.5	\$203.60/hr.	\$ 101.80
Administrative Specialist IV	.5	\$115.24/hr.	\$ 57.62
2-Person Field Crew	10	\$175.00/hr.	\$ 1,750.00
Surveyor Technician V	1	\$134.45/hr.	\$ 134.45
Surveyor Technician IV	20	\$122.93/hr.	\$ 2,458.60
		Subtotal	\$ 4,608.11

Task 3 Property Lines and Right-of-Ways

Staff	Max. Hrs.	Labor Rate	Total Cost
Supervisory Land Surveyor (PP) Dana Markus-Wolf	.5	\$211.28/hr.	\$ 105.64
Supervisory Land Surveyor (PM) Juan Canales, Jr.	.5	\$203.60/hr.	\$ 101.80
Administrative Specialist IV	.5	\$115.24/hr.	\$ 57.62
2-Person Field Crew	8	\$175.00/hr.	\$ 1,400.00
Surveyor Technician V	1	\$134.45/hr.	\$ 134.45
Surveyor Technician IV	6	\$122.93/hr.	\$ 737.58
		Subtotal	\$ 2,537.09

Task 4 Correspondence, Traffic Control and Permitting, Clerical/Administrative and Quality Control

Staff	Max. Hrs.	Labor Rate	Total Cost
Supervisory Land Surveyor (PP) Dana Markus-Wolf	.5	\$211.28/hr.	\$ 105.64
Supervisory Land Surveyor (PM) Juan Canales, Jr.	.5	\$203.60/hr.	\$ 101.80
Administrative Specialist IV	.5	\$115.24/hr.	\$ 57.62
Surveyor Technician V	1	\$134.45/hr.	\$ 134.45
Surveyor Technician IV	2	\$122.93/hr.	\$ 245.86
		Subtotal	\$ 645.37

Total (Tasks 1 through 4) for **4910/4914 Timberline Drive** \$ **8,610.94**

13. Timberline Ridge

Task 1 Establish Horizontal and Vertical Control

Staff	Max. Hrs.	Labor Rate	Total Cost
Supervisory Land Surveyor (PP) Dana Markus-Wolf	.5	\$211.28/hr.	\$ 105.64
Supervisory Land Surveyor (PM) Juan Canales, Jr.	.5	\$203.60/hr.	\$ 101.80
Administrative Specialist IV	.5	\$115.24/hr.	\$ 57.62
2-Person Field Crew	2	\$175.00/hr.	\$ 350.00



Surveyor Technician V	1	\$134.45/hr.	\$ 134.45
Surveyor Technician IV	2	\$122.93/hr.	\$ 245.86
		Subtotal	\$ 995.37

Task 2 Topographic Survey

Staff	Max. Hrs.	Labor Rate	Total Cost
Supervisory Land Surveyor (PP) Dana Markus-Wolf	.5	\$211.28/hr.	\$ 105.64
Supervisory Land Surveyor (PM) Juan Canales, Jr.	.5	\$203.60/hr.	\$ 101.80
Administrative Specialist IV	.5	\$115.24/hr.	\$ 57.62
2-Person Field Crew	10	\$175.00/hr.	\$ 1,750.00
Surveyor Technician V	1	\$134.45/hr.	\$ 134.45
Surveyor Technician IV	20	\$122.93/hr.	\$ 2,458.60
		Subtotal	\$ 4,608.11

Task 3 Property Lines and Right-of-Ways

Staff	Max. Hrs.	Labor Rate	Total Cost
Supervisory Land Surveyor (PP) Dana Markus-Wolf	.5	\$211.28/hr.	\$ 105.64
Supervisory Land Surveyor (PM) Juan Canales, Jr.	.5	\$203.60/hr.	\$ 101.80
Administrative Specialist IV	.5	\$115.24/hr.	\$ 57.62
2-Person Field Crew	8	\$175.00/hr.	\$ 1,400.00
Surveyor Technician V	1	\$134.45/hr.	\$ 134.45
Surveyor Technician IV	8	\$122.93/hr.	\$ 983.44
		Subtotal	\$ 2,782.95

Task 4 Correspondence, Traffic Control and Permitting, Clerical/Administrative and Quality Control

Staff	Max. Hrs.	Labor Rate	Total Cost
Supervisory Land Surveyor (PP) Dana Markus-Wolf	.5	\$211.28/hr.	\$ 105.64
Supervisory Land Surveyor (PM) Juan Canales, Jr.	.5	\$203.60/hr.	\$ 101.80
Administrative Specialist IV	.5	\$115.24/hr.	\$ 57.62
Surveyor Technician V	1	\$134.45/hr.	\$ 134.45
Surveyor Technician IV	2	\$122.93/hr.	\$ 245.86
		Subtotal	\$ 645.37

Total (Tasks 1 through 4) for **Timberline Ridge** \$ **9,031.80**



14. Chevron/Bee Caves Road

Task 1 Establish Horizontal and Vertical Control

Staff	Max. Hrs.	Labor Rate	Total Cost
Supervisory Land Surveyor (PP) Dana Markus-Wolf	1	\$211.28/hr.	\$ 211.28
Supervisory Land Surveyor (PM) Juan Canales, Jr.	1	\$203.60/hr.	\$ 203.60
Administrative Specialist IV	.5	\$115.24/hr.	\$ 57.62
2-Person Field Crew	4	\$175.00/hr.	\$ 700.00
Surveyor Technician V	2	\$134.45/hr.	\$ 268.90
Surveyor Technician IV	2	\$122.93/hr.	\$ 245.86
		Subtotal	\$ 1,687.26

Task 2 Topographic Survey

Staff	Max. Hrs.	Labor Rate	Total Cost
Supervisory Land Surveyor (PP) Dana Markus-Wolf	1	\$211.28/hr.	\$ 211.28
Supervisory Land Surveyor (PM) Juan Canales, Jr.	1	\$203.60/hr.	\$ 203.60
Administrative Specialist IV	.5	\$115.24/hr.	\$ 57.62
2-Person Field Crew	12	\$175.00/hr.	\$ 2,100.00
Surveyor Technician V	2	\$134.45/hr.	\$ 268.90
Surveyor Technician IV	30	\$122.93/hr.	\$ 3,687.90
		Subtotal	\$ 6,529.30

Task 3 Property Lines and Right-of-Ways

Staff	Max. Hrs.	Labor Rate	Total Cost
Supervisory Land Surveyor (PP) Dana Markus-Wolf	1	\$211.28/hr.	\$ 211.28
Supervisory Land Surveyor (PM) Juan Canales, Jr.	1	\$203.60/hr.	\$ 203.60
Administrative Specialist IV	.5	\$115.24/hr.	\$ 57.62
2-Person Field Crew	12	\$175.00/hr.	\$ 2,100.00
Surveyor Technician V	2	\$134.45/hr.	\$ 268.90
Surveyor Technician IV	10	\$122.93/hr.	\$ 1,229.30
		Subtotal	\$ 4,070.70

Task 4 Correspondence, Traffic Control and Permitting, Clerical/Administrative and Quality Control

Staff	Max. Hrs.	Labor Rate	Total Cost
Supervisory Land Surveyor (PP) Dana Markus-Wolf	1	\$211.28/hr.	\$ 211.28
Supervisory Land Surveyor (PM) Juan Canales, Jr.	1	\$203.60/hr.	\$ 203.60
Administrative Specialist IV	.5	\$115.24/hr.	\$ 57.62
Surveyor Technician V	2	\$134.45/hr.	\$ 268.90



Surveyor Technician IV	4	\$122.93/hr.	\$ 491.72
		Subtotal	\$ 1,233.12
ROWMAN Permit/Traffic Control(Estimated Pass-Through Expense)			\$ 2,500.00
Total (Tasks 1 through 4) for Chevron/Bee Caves Road			\$ 16,020.38

Total Cost for project sites 1 through 14 = **\$221,385.05**

Note: Basis of Landmark Surveying, LP hourly rates

The above-mentioned rates are based on the City of Austin approved Category 1 loaded rate sheet in that certain letter dated March 14, 2022, from David Walch, Procurement Specialist IV, Capital Contracting Office. CCO approved Rate Period: 3/9/2022 – 3/7/2024.



EXHIBIT "A"

CITY OF ROLLINGWOOD WATER CIP BOND PROGRAM SURVEY LIMITS LINEAR FOOTAGE

- ① PARK HILLS DRIVE & BRETT COVE - APPROX. 1,108 LINEAR FEET
- ② LAURA LANE & MICHELLE CIRCLE - APPROX. 1,331 LINEAR FEET
- ③ KRISTI DRIVE - APPROX. 415 LINEAR FEET
- ④ ALMARION DRIVE, HATLEY DRIVE & INWOOD CIRCLE - APPROX. 357 LINEAR FEET
- ⑤ VANCE LANE & VALE STREET - APPROX. 3,280 LINEAR FEET
- ⑥ PLEASANT COVE - APPROX. 738 LINEAR FEET
- ⑦ PICKWICK LANE - APPROX. 2,230 LINEAR FEET
- ⑧ BETTIS BOULEVARD - APPROX. 830 LINEAR FEET
- ⑨ GENTRY DRIVE - APPROX. 720 LINEAR FEET
- ⑩ INWOOD ROAD & ROLLINGWOOD DRIVE - APPROX. 376 LINEAR FEET
- ⑪ INWOOD COVE & TIMBERLINE DRIVE - APPROX. 707 LINEAR FEET
- ⑫ 4910 & 4914 TIMBERLINE DRIVE - APPROX. 331 LINEAR FEET
- ⑬ TIMBERLINE RIDGE - APPROX. 424 LINEAR FEET
- ⑭ CHEVRON/BEE CAVE ROAD - APPROX. 190 LINEAR FEET



NOT TO SCALE

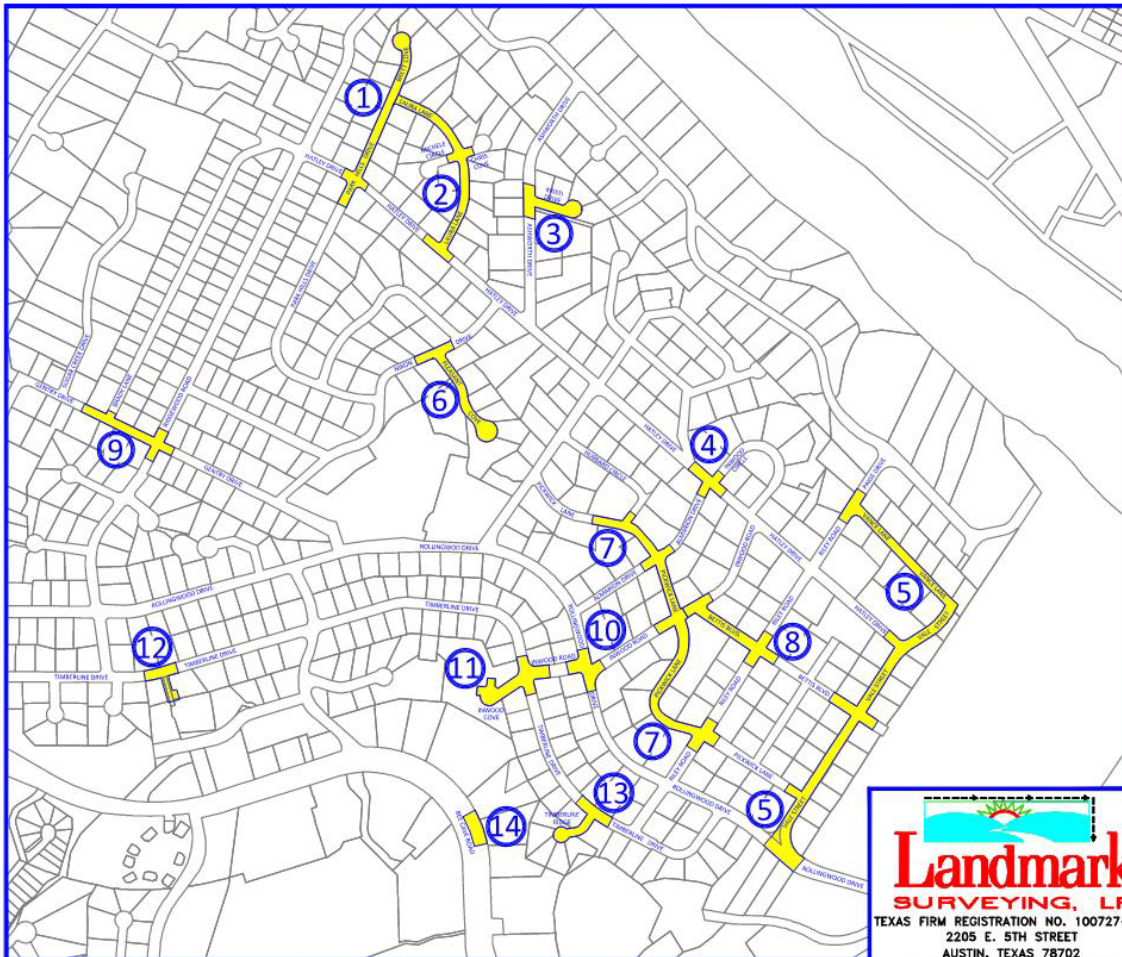

2205 East 5th Street
Austin, Texas 78702-4633
Phone: 512-328-7411, Fax: 512-328-7413
Texas Firm Registration No. 100727-00
WBE/HUB

February 13, 2023

Greg Blackburn, PE
K. Friese + Associates, Inc.
1120 S. Capital of Texas Highway
CityView 2, Suite 100
Austin, Texas 78746
Via email gblackburn@kfriese.com

Re: Environmental and Cultural Resources Scope of Work and Fee Estimate: City of Rollingwood Water Capital Improvement Plan Bond Program

Dear Mr. Blackburn,

Please accept this correspondence as Blanton & Associates, Inc.'s (B&A), a wholly owned subsidiary of ICF Jones & Stokes, Inc., proposal to conduct environmental and cultural resources desktop services related to the City of Rollingwood Water Capital Improvement Plan (CIP) Bond Program Project in Travis County, Texas. B&A's scope of work is based upon our understanding of the information identified below.

PROPOSED PROJECT DESCRIPTION

The City of Rollingwood has asked K. Friese + Associates, Inc. (K. Friese) to develop a proposal to design several packages from their Water CIP Bond Program. In total, the packages are approximately 10,500 linear feet (LF) of new eight-inch diameter waterlines within existing roadways. The project sites are dispersed through the city, as depicted in the keyhole markup layer (kml) provided to B&A by K. Friese via email transmittal on January 19, 2023. K. Friese has requested B&A to develop a proposal for desktop constraints review for environmental and cultural resources, as well as a field karst survey at one location.

B&A's proposed scope of work consists of the following tasks to provide the environmental and cultural services necessary for constraints analysis at this time.

ENVIRONMENTAL AND CULTURAL RESOURCES REVIEW

Federally Listed Species

B&A will conduct a desktop literature and database review to determine whether federally listed threatened, endangered, or other protected species are of potential occurrence in or adjacent to the project area and, if so, whether they could be affected by the proposed project. This analysis will include a review of current lists and records of threatened, endangered, and species of concern and designated critical habitat provided by the U.S. Fish and Wildlife Service (USFWS) and Texas Parks and Wildlife Department (TPWD). The Texas Natural Diversity Database will be reviewed to determine if threatened and endangered species and/or other sensitive natural resources have been documented in or near the project area. Examination of the mapped karst zones and karst invertebrate critical habitat will be included in the desktop review. Existing habitats within the project area will be remotely evaluated based on review of historical and contemporary aerial imagery and publicly available databases. Based on desktop review, B&A will provide recommendations for additional activities to address federally listed species, if needed.

5 Lakeway Centre Court, Suite 200, Austin, Texas 78734

Phone +1.512.264.1095 | Fax +1.512.264.1531

For project area locations entirely within paved roadways, it is assumed by B&A that USFWS would not require completion of a karst habitat assessment, but would elsewhere. One project area location provided by K. Friese—sited on the east side of Bee Caves Road north of Rollingwood Town Centre Road—will include the installation of a valve vault within an approximately 0.25-acre area that is unpaved. For this location, B&A will complete a karst survey in conformance with the “United States Fish and Wildlife Service, Section 10(a)(1)(A) Scientific Permit Requirements for Conducting Presence/Absence Surveys for Endangered Karst Invertebrates in Central Texas” (revised April 27, 2022). The assessment will be completed through Step 2, “Conduct an initial karst feature survey.” The karst survey will consist of desktop evaluations and walking 50-foot transects across the site. While B&A makes every effort to locate and identify karst features, at times site conditions prevent this due to seasonal vegetation, fill piles, etc. This does not include excavation beyond 10 minutes of hand excavation or biological surveys for endangered karst invertebrates (EKI).

Water Resources

B&A will review maps and aerial photography to identify potential wetlands and other waters of the U.S. within the project boundaries. Sources evaluated in the desktop review will include Federal Emergency Management Agency (FEMA) National Flood Insurance Program flood hazard digital data and maps, USFWS National Wetlands Inventory (NWI) digital data and maps, U.S. Geological Survey (USGS) topographic maps, USGS soil maps and Soil Survey Geographic Database (SSURGO) data, georeferenced natural color and color-infrared aerial imagery, and other pertinent data. Upon completion of the desktop review, B&A will recommend which of the locations require completion of an on-site delineation of waters of the U.S., including wetlands, in order to identify and map wetlands, streams, and other potential waters of the U.S.

Hazardous Materials

To identify potential hazardous materials in proximity to the project area, B&A will conduct a desktop review of publicly available databases and resources. B&A will review the history of the site, including examination of current and past aerial photographs, historical maps, and other readily available historical documents to identify potential hazardous materials in or adjacent to the project area.

Historical and Cultural Resources

Based on information available at this time, B&A assumes that the proposed project would be sponsored by a political subdivision of the state (City of Rollingwood) and will be constructed within state or city-controlled and/or state- or city-owned land; therefore, compliance with the Antiquities Code of Texas (9 TNRC §191) and associated state regulations (13 TAC§ 26) regarding cultural resources for the project would be required. The Antiquities Code of Texas requires any political subdivision of the State of Texas, defined as a “local governmental entity created and operating under the laws of this state, including a city, county, school district, or special district created under the Texas Constitution, Article III, §52(b)(1) or (2), or Article XVI, §59” in 13 TAC §26.5 of the code, to identify potential State Antiquities Landmarks (SALs) through survey of public lands prior to actions that could potentially damage those SALs. Public lands are further defined in 13 TAC §26.3 as lands owned or controlled by the State of Texas or any of its political

subdivisions. B&A assumes that the proposed project would not have a federal nexus and that compliance with Section 106 of the National Historic Preservation Act would not be required.

Upon notice to proceed, B&A would conduct a desktop review to determine if previously recorded cultural resources or surveys occur in the project area and vicinity and if a cultural resources survey is warranted. The review would include the project area and a 0.25-mile study area buffer around the proposed project area. A B&A archeologist will review the Texas Historical Commission's (THC's) online restricted-access *Archeological Sites Atlas*, and a B&A historian would review the THC's online *Historic Sites of Texas Atlas*. The reviews would include the following types of information from the two atlases: previously recorded archeological sites, National Register of Historic Places-listed properties and districts, National Historic Landmarks, SALs, Official Texas Historical Markers (OTHMs), Recorded Texas Historical Landmarks, Historic Texas Cemeteries, and cemeteries. B&A will submit the findings of the desktop review, together with recommendations about the need for additional work (or no further work) in a letter to the THC requesting comments and concurrence with B&A's recommendations. If the findings of the desktop review indicate that a cultural resources survey is warranted and the THC concurs with B&A's recommendations for further work, B&A will prepare a separate scope and fee for the recommended work.

REPORT

The product of this effort will be a report that describes the methods, results, and recommendations for desktop and limited field review involved with federally listed species, water resources, hazardous materials, and historical and archeological resources tasks. The report will include accompanying tables, attachments, maps and documentation on coordination with THC for cultural resources.

FEE

B&A's total fee to provide the scope of work detailed in this proposal for environmental and cultural desktop review is **\$18,695** on a time and materials basis in accordance with our standard rate schedule (**Attachment A**). A detailed estimate is provided in the attached excel table (**Attachment B**).

ASSUMPTIONS AND EXCLUSIONS

- Scope of work does not include on-site field inspection and verification of site conditions, except for karst feature survey at one 0.25-acre site, as described above. If desktop review finds that such activities are needed, a supplemental scope of work and fee estimate can be provided by B&A.
- B&A assumes that the proposed project is not categorized as a federal undertaking.
- This scope of work does not include permitting or agency coordination other than specified herein. Should such permitting or agency coordination be required, B&A would submit a separate scope and fee to K. Friese for consideration.
- The project is located within the Edwards Aquifer recharge zone, but includes regulated activities (i.e., the installation of water lines) exempt from the Edwards Aquifer protection plan application

requirements, per 30 TAC 213.5(h). Therefore, it is assumed that a Texas Commission of Environmental Quality (TCEQ) Geologic Assessment (TCEQ 0585) will not be required and is not included in this proposal. Should it be determined that a Geological Assessment is necessary, B&A can provide a separate scope and fee for these services.

- The project is located primarily in Karst Zone 1, areas known to contain federally endangered cave fauna. It is assumed that a USFWS Karst Survey will likely be required for project areas that include areas that are natural ground and currently unpaved. Based on correspondence with the K. Friese, services included in this proposal are limited to desktop review except for karst field survey at one location. Should desktop review find that a USFWS Karst Survey is required elsewhere in addition to as proposed herein, B&A will provide a separate scope and fee for these services.
- Presence/absence surveys or coordination with USFWS or TPWD for protected species is not included in this proposal. Should it be determined that such services are required, B&A will submit a separate scope and fee to your office for review.
- Texas Department of Transportation (TxDOT) environmental review is not included.
- Client understands that revisions to the project after providing notice to proceed requires additional time and materials and will be billed at an additional cost outside of this current scope of work.
- B&A assumes that one report and one cultural resources coordination letter will be composed in fulfillment of the proposed scope of work.
- This scope of work does not include preparation of a Waters of the U.S. Preliminary Jurisdictional Determination, Pre-Construction Notification (PCN), Section 404 Individual Permit application, mitigation plan, or coordination with the U.S. Army Corps of Engineers (USACE). In the unlikely event that any of these tasks are required, B&A would submit a separate scope and cost estimate to your office for review.
- Preparation of a Biological Assessment, Section 7 Consultation assistance, mussel surveys, and coordination with the USFWS or TPWD are not included. If needed, a supplemental cost would be required.
- A Phase I Environmental Site Assessment (ESA) is not included in this proposal. If desktop review indicates that such services are needed, a supplemental scope and fee would be required.
- Client understands that no warranties or guarantees are expressed or implied by B&A regarding the actions of any government agency, including local, state, or federal agencies, in connection with the project for which the services are performed.
- B&A assumes the proposed project would be sponsored by a political subdivision of the state (City of Rollingwood) and is subject to compliance with the Antiquities Code of Texas (9 TNRC §191) and associated state regulations (13 TAC§ 26) regarding cultural resources.

- The project is not anticipated to be classified as a federal undertaking in that it does not include any federal involvement (e.g., ownership permit, funding, or license), and this project will not require compliance with Section 106 of the National Historic Preservation Act.
- Archeological testing or mitigation of archeological sites is not included in this scope of work. If it is determined that archeological testing or mitigation is required, these activities would be conducted under a separate scope and fee.
- It is assumed that one Cultural Resources letter will suffice for submission to the THC and one round of comments will be completed with the THC.
- Human burial excavation/disinterment is not included in this scope of work. If it is determined that burial excavation is required, these activities would be conducted under a separate scope and fee.
- Additional documentation services requested as a result of a change in environmental regulations or documentation standards from those in practice and acceptable at the time of approval of this agreement are not included.
- This proposal has been prepared for the Client to whom it is addressed and shall not be conveyed to third parties without prior written authorization from B&A.
- This proposal and cost estimate are valid for 90 days.

Thank you for the opportunity to provide this proposal and please call me at 210-598-0165 (mobile), or email at velma.danielson@icf.com if you have any questions. If this proposal is acceptable, please forward an agreement or execute the attached Authorization to Proceed in **Attachment C** to initiate this work. We look forward to working with you all.

Sincerely,



Janis Childers
Program Operations
Blanton & Associates, Inc.



Velma. R. Danielson
Project Manager
Blanton & Associates, Inc.

*Attachment A B&A Standard Rate Schedule
Attachment B Detailed Fee Estimate Table
Attachment C Authorization to Proceed*

Attachment A

B&A Standard Rate Schedule

STANDARD RATE SCHEDULE
Effective January 1, 2023 through December 31, 2023

PERSONNEL

Blanton & Associates, Inc., provides services on an hourly professional fee basis according to the rates scheduled below:

Technical Director	\$255.00
Sr. Technical Analyst.....	\$240.00
Sr. Project Manager	\$225.00
Project Manager	\$190.00
Senior Environmental Professional.....	\$175.00
Environmental Professional	\$165.00
Staff Scientist II	\$150.00
Staff Scientist I.....	\$135.00
Environmental Technician II	\$120.00
Environmental Technician I.....	\$100.00
GIS Analyst/Cartography.....	\$120.00
GIS Technician	\$100.00
Technical Editor.....	\$100.00
Clerical/Administrative.....	\$ 75.00

TRAVEL, MEALS & INCIDENTAL EXPENSES

All travel expenses, including lodging, are invoiced at actual cost. Per diem for meals will be billed at a flat rate of \$59 per day. Cost of mileage for company-owned vehicles is computed at a rate of \$0.655 per mile. Rental automobiles and fuel costs for same will reflect actual costs to the firm. Company boats are billed at a rate of \$500.00 per day plus fuel. GPS units are billed at a rate of \$100.00 per day. Rented or leased equipment including drones and ATVs are invoiced at actual cost. Copies will be billed at the rate of \$.05 per page.

PURCHASED SERVICES

All purchased services are invoiced at actual cost. These include, but are not limited to, reproduction, technology, consultants, subcontract services, delivery, postage, and expendable supplies.

TERMS

Invoices are submitted monthly for all services rendered during the previous month and are payable "Net 30 days." Past Due invoices will be subject to a 1.5% fee per month not to exceed 18% per annum.

Attachment B

Detailed Fee Estimate Table

**Attachment B - Detailed Fee Estimate Table
City of Rollingwood Water CIP Bond Program**

Item No.	FEE ESTIMATE FOR CITY OF ROLLINGWOOD CIP BOND PROGRAM 1-31-2023	No. Sheets		Project Manager	Senior Env. Professional	Environmental Tech II	Environmental Tech I	GIS Analyst / Cartography	GIS Technician	Administrative Support Staff	Total Task Hours	Other Direct Costs	Cost
TASK		HOURS										TOTAL	TOTAL
Environmental and Cultural Review													
1	Project Management			8						2	10		\$1,540.00
2	Water Resources				4	8	16	2	8	2	40		\$4,140.00
3	Federally Listed T&E Species				5	16	20	2	10	2	55		\$5,805.00
4	Hazardous Materials				4	8	8	2	4	2	28		\$3,060.00
5	Historical and Archeological Resources				4	24	0	1	4	2	35		\$4,150.00
	Environmental and Cultural Desktop Review Hours Subtotal			8	17	56	44	7	26	10	168		
	Environmental and Cultural Desktop Review Cost Subtotal			\$1,400.00	\$2,805.00	\$6,720.00	\$3,960.00	\$770.00	\$2,340.00	\$700.00		\$0.00	\$18,695.00
TOTAL													
	Env & Cultural Hours Total			8	17	56	44	7	26	10	168		
	Env & Cultural Cost Total			\$1,400.00	\$2,805.00	\$6,720.00	\$3,960.00	\$770.00	\$2,340.00	\$700.00	\$0.00	\$0.00	\$18,695.00

Attachment C

Authorization to Proceed

Authorization to Proceed

This Authorization to Proceed (“ATP”), is to confirm K. Friese + Associates, Inc.’s (K. Friese’s) decision to proceed with the project as outlined in B&A’s proposal submitted on February 13, 2023. The ATP is an interim authorization provided to begin work. The formation of a final written contract is subject to successful contract negotiations and both parties agree to work together in good faith to conclude these negotiations in a timely manner.

K. Friese has requested B&A to begin to provide services related to the City of Rollingwood Water CIP Bond Program (“Services”) on or about **February 14, 2023**, and such Services authorized herein shall continue until **May 14, 2023** (ATP end date). B&A’s Services authorized by K. Friese shall not exceed a total fee of **\$18,695** under this ATP. B&A will notify K. Friese before the total cumulative fees reach the ATP limit. It is assumed that a final written contract will be fully executed and in place prior to the ATP end date.

In consideration of the Services provided, B&A is authorized to submit applicable invoices to K. Friese and K. Friese agrees to pay B&A on a time and materials basis. Invoices are payable within thirty days of receipt. Should B&A reach the total dollar ceiling amount of the Services before the ATP end date in the absence of a fully executed contract, Services will be on hold until K. Friese issues an amendment to this ATP. B&A may also pause Services for nonpayment. Neither party will be liable to the other for any form of indirect or consequential damages and each party’s liability to the other will not exceed the total fees and costs specified in this ATP.

In order for B&A to begin to provide the Services, please provide your approval of the ATP terms written above and provide K. Friese’s billing information. By providing this ATP, I represent that I have the authority to do so on behalf of K. Friese.

K. Friese + Associates, Inc.

Name:

Signature:

Date:

[Delivery by Email: gblackburn@kfriese.com]

Proposal No. PAA23-022-00
January 27, 2023

Mr. Greg Blackburn, P.E.
Associate
K Friese + Associates
1120 S. Capital of Texas Highway, City View 2, Suite 100
Austin, Texas 78746

8100 Cameron Road, Suite B-150
Austin, TX 78754

P 512.339.1745
F 512.339.6174
TBPE Firm F-3257

WWW.RKCI.COM

**RE: Proposal for Geotechnical Engineering Study
City of Rollingwood Water CIP Bond Program (Package 1-4)
Travis County, Texas**

Dear Mr. Blackburn:

RABA KISTNER Consultants, Inc. (RKCI) is pleased to submit this proposal for Geotechnical Engineering Services for the above referenced project. The broad objectives of our study will be to determine soil conditions at the site and to develop recommendations and construction guidelines for the installation of waterlines within the City of Rollingwood. Described in this proposal are:

- our understanding of pertinent project characteristics;
- our proposed scope for field and laboratory study;
- our proposed scope for engineering evaluation and reporting;
- our tentative project schedule; and
- our lump sum study cost.

Project Scope

Under consideration in this study is the installation of approximately 10,500 lineal feet of new 8-inch diameter waterlines within existing roadways within the City of Rollingwood. The streets being consider in this study include: Park Hills Drive, Brent Cove, Laura Lane, Kristy Drive, Ashworth Drive, Pleasant Cove, Pickwick Lane, Almarion Drive, Betts Boulevard, Riley Road and Inwood Cove.

Field Study

Per the request of the Client, RKCI will drill 4 soil borings within the existing roadway to approximate depths of 15 ft below the existing ground surface in order to assess subsurface conditions at the subject site.

The borings will be advanced to their targeted completion depths utilizing a truck mounted drilling rig. Samples will be taken using conventional Shelby-tube, split-spoon, and NX Rock core sampling techniques. Representative portions of the samples will be sealed, packaged and transported to our laboratory for subsequent testing and classification.

The borings will be backfilled utilizing auger cuttings and bentonite. The boreholes will then patched with a similar asphalt covering.

Samples collected will be retained in our laboratory for 30 days after submittal of the final geotechnical report.

Proposal No. PAA23-022-00
January 27, 2023

Laboratory Testing

Upon completion of the subsurface exploration, a testing program will be designed to define the strength and classification characteristics of the subgrade soils. The laboratory testing program is anticipated to include moisture content tests, Atterberg Limits (plasticity) tests, unconfined compression tests, and grain size analyses. However, the actual type and number of laboratory tests will be based on the subsurface conditions encountered in the borings. The laboratory testing will be performed in general accordance with applicable ASTM standards.

Engineering Report

The results of the field and laboratory phases of the study will be reviewed by our staff of engineers and geologists. The results of our review, together with the supporting field and laboratory data, will be presented in written, engineering report. The Geotechnical Engineering Report will include the following information and recommendations, if applicable:

- A boring location map and boring logs;
- A summary of the field and laboratory sampling and testing program,
- A summary of the laboratory test results;
- A review of general site conditions including descriptions of the site, the subsurface stratigraphy, groundwater conditions, and the presence and condition of fill materials, if encountered.
- Pipeline installation and construction considerations, including:
 - open cut trench excavation;
 - excavation support;
 - backfill material and compaction.
- Flexible component thickness to match existing pavement section.

The final reports will be produced in a digital PDF and delivered via email. All reports will be issued separately.

Tentative Project Schedule

Based on our present workload and weather permitting, we anticipate that we could begin the field exploration phase of this study within 5 to 7 working days of receiving your written authorization. The field exploration and laboratory testing phase of the study is expected to take approximately 8 to 10 working days to complete. Engineering reporting is expected to take an additional two weeks to complete.

Project Cost

The total lump sum cost for the study scope outlined herein is **\$10,500**.

Should unusual soil conditions be encountered in the field that indicates the desirability of significantly broadening the scope of the study, we will contact you to receive authorization before proceeding with any additional work. Additional services will be billed on a unit basis in accordance with our standard fees as indicated on the attached Schedule of Fees for Professional Services.

Proposal No. PAA23-022-00
January 27, 2023

It is our understanding that the Client will provide access to all boring locations for a conventional, truck-mounted drilling rig. RKCI will assist in locating underground utilities and will engage a private utility locator to clear the boring locations. RKCI will take all precautions to prevent damage to property.

It should be noted that our study scope and project cost does not include professional time and travel expenses for participation in design team meetings. Furthermore, our estimate does not include professional time for plan review to determine whether the drawings comply with the intent of the geotechnical recommendations.

Acceptance

We appreciate the opportunity of submitting this contract and look forward to working with you in the development of this project, which will be carried out in accordance with this letter and the following attachments:

<u>Attachment</u>	<u>Description</u>
I	Standard Terms and Conditions
II	Schedule of Fees

Please return one signed copy of this letter proposal to provide written authorization for our firm to complete work on the services outlined herein. Our invoices are due and payable upon receipt at P.O. Box 971037, Dallas, Texas 75397-1037.

RKCI considers the data and information contained in this proposal to be proprietary. This statement of qualifications and any information contained herein shall not be disclosed and shall not be duplicated or used in whole or in part of any purpose other than to evaluate this proposal.

Very truly yours,

RABA KISTNER CONSULTANTS, INC.

Accepted
By:

Yvonne Garcia Thomas, P.E.
Vice President

Signature

Typed or Printed Name

YGT: jm
Attachments I & II
Copies Submitted: Above (1)

Title

Date



SCHEDULE OF FEES FOR PROFESSIONAL SERVICES

PERSONNEL:

Principal.....	\$135 to \$250/hour
Professional.....	\$70 to \$200/hour
Auto Cad Operator.....	\$65 to \$110/hour
Technical/Clerical/Administrative	\$40 to \$80/hour

The specific hourly rate within each classification listed above depends on the experience, special training, and qualifications of the personnel needed for the project. For projects requiring work at any hazardous waste site, there will be a \$10 per hour surcharge added to the normal billing rate for all personnel. Consultants to Raba Kistner (RK) will be charged according to their professional classification.

EXPENSES: Use of company automobiles will be charged at \$1.00 per mile. Automobiles and light trucks assigned to field sites will be charged at \$70.00 per day, plus \$1.00 per mile over 50 miles per day. Copies will be charged at \$0.25 per page.

Other project specific charges for use of RK equipment or for RK testing will be in accordance with established fee schedules. All other project specific, third-party costs will be charged at cost plus 15 percent.

Invoices will be submitted monthly for work in progress in our standard format. They are due and payable upon receipt and become past due 30 days after the billing date. Past due invoices may be subject to late charges at the rate of 1-1/2 percent per month (18 percent per annum). In the event that the State of Texas legislates a sales tax on Professional Services, the amount of the tax will be PAYMENT added to the appropriate service rate charged. Our invoices are due and payable upon receipt at P.O. Box 971037, Dallas, Texas 75397-1037.

Preparation of non-standard invoice will be charged on a time and materials basis in accordance with the rates in this fee schedule.

CONDITIONS: Services will be performed in accordance with our Standard Terms and Conditions.

The proposal to which this schedule is an attachment is valid for 90 days from the date of the proposal.