

THE CITY OF ROLLINGWOOD SEWER MANHOLE REFERENCE NETWORK SURVEY

REFERENCE POINTS LOCATION MAP

ATS Job #231011016s

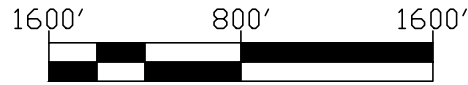

Graphic Scale: 1" = 800'

LEGEND

●	1/2" IRON ROD FOUND CAPPED
Ⓢ	SANITARY SEWER MANHOLE
Ⓣ	STORM DRAIN MANHOLE
- · - · -	APPROXIMATE CITY LIMIT LINE

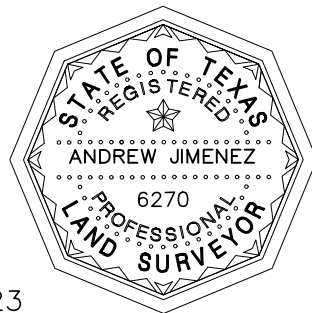

Andrew Jimenez
ANDREW JIMENEZ

11/14/2023

Date

Registered Professional Land Surveyor

No. 6270 - State of Texas

Client: City of Rollingwood

Date of Field Work: 10/26/23, 10/27/23, 10/30/23, & 10/31/23

Field: ECarlson

Tech: AJimenez, SThomson, & CCarter

Date Drawn: 11/10/23, 11/11/23, 11/12/23 & 11/14/23

Path: S:\Projects___ BULK\City_of_Rollingwood\Network_Survey\Production\Dwgs\RW-MH-NetworkSurvey.dwg

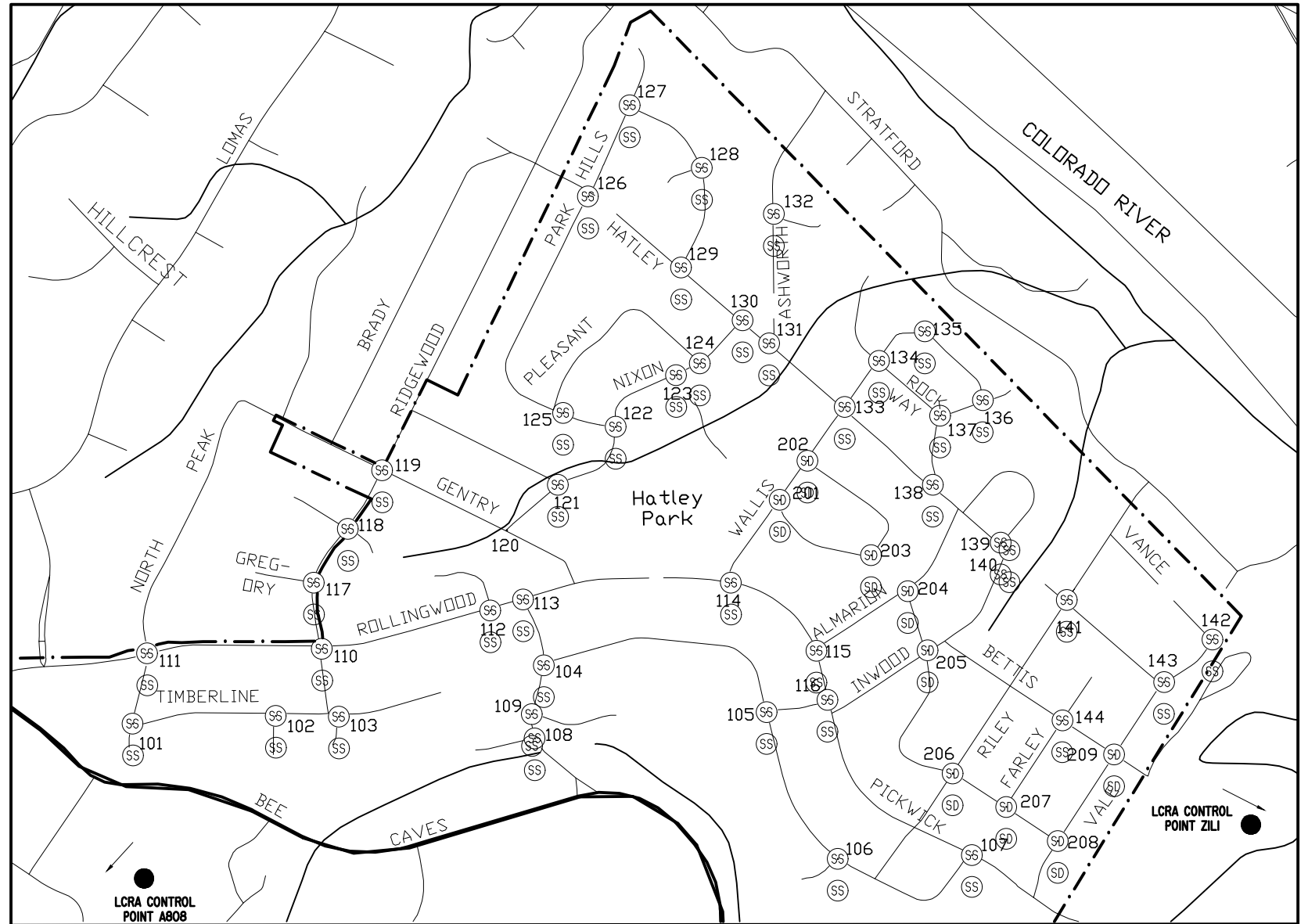

Note:

- 1) THE LCRA POINTS SHOWN ON THIS MAP ARE NOT ACCURATELY DEPICTED. THEY HAVE BEEN ADJUSTED TO FIT THIS MAP. FOR THE PRECISE LOCATION USE THE COORDINATES SHOWN HEREON.
- 2) COORDINATES SHOWN ARE BASED ON THE TEXAS STATE PLANE COORDINATE SYSTEM, NAD 83, CENTRAL ZONE (4203), GEOID 2012A. ELEVATIONS ARE BASED OFF OF (NAVD 88).
- 3) CONTROL FOR REFERENCE NETWORK IS BASED ON LCRA MONUMENTS "A808" AND ZIL1. SEE TABLE FOR HORIZONTAL AND VERTICAL INFORMATION.
- 4) ALL SURVEY NETWORK POINTS ARE PUNCH HOLE MARKS IN THE CENTER OF EXISTING MANHOLES AS SHOWN IN THE MAP.

ATS Engineers Inspectors & Surveyors
www.ats-engineers.com
 TBPLS FIRM REG. #10128000
 4910 West Hwy 290
 AUSTIN, TEXAS 78735
 (512) 328-6995
 FAX: (512) 328-6996