

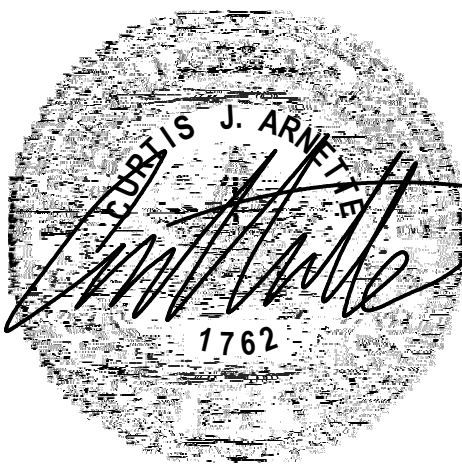

curt arnette, asa
landscape architect
6114 ginita lane
austin, texas 78739

512.415.2097
mail@sitiodesign.com
sitiodesign.com



Landscape Development Plan for the
Rollingwood Park
Rollingwood, TX 78746
Rollingwood Drive

ProgressSet
Not For Construction

Date: 1/07/2026

Revised:

L1
Sheet 1 of 2

General Notes

Site Plan Survey: The landscape plan is based on existing site contours provided by Holt Carson, Inc. Surveying. The civil engineers have indicated the roadways and curb elevations on the civil set of drawings. Final grades may be modified in the field by the Landscape Architect, as required to adequately drain the site. The contractor shall be responsible to notify the Landscape Architect where field conditions are encountered that deviate from the plans and do not allow for positive drainage. The topsoiling and sodding or planting operations to maintain the positive drainage.

Excavation with Utilities: Landscape contractors should thoroughly familiarize themselves with the working area as it relates to the Construction Documents prior to the commencement of any construction activity and notify the Landscape Architect where discrepancies are encountered. Contractor to verify the location of underground utilities prior to any excavation.

Protection of Existing Vegetation: Existing trees scheduled to remain should be protected from injury or damage to roots, trunks, or branches by placing tree protection fencing around existing trees to remain. Damaged trees or vegetation to be replaced immediately in a manner acceptable to the Landscape Architect. Irregularly damaged trees or shrubs must be replaced with ones of similar size and shape at the expense of the Contractor. A value to be determined in accordance with the tree evaluation formula as described in "A Guide to the Professional Evaluation of Landscape Trees, Specimen Shrubs and Evergreens", published by the International Society of Arboriculture.

Treatment of Existing Weeds: Existing stands of bermudagrass, johnsongrass, nutgrass, and noxious weeds to be treated with herbicide before construction begins. Nutgrass to be treated with "Imagi" or "Manage". Other weeds to be treated with "Finale", "Roundup", or equal herbicide. Use care not to overapply onto existing vegetation to remain. Treatment shall be in strict accordance with manufacturer's specifications and shall be accomplished to allow sufficient time for a complete kill prior to starting any soil preparation.

Grubbing, Grubbing and Trimming: Remove plants, undergrowth, other vegetation and debris from the site except items indicated to remain. Strip weeds and grass. Retain to a depth of 4'-6" in areas where soil has been compacted during construction. Use hand methods for grubbing inside the dripline of trees to remain. Strip grass materials to a maximum depth of 1' under tree canopies. Remove stumps to a depth of 15' below existing grade. Interfering branches of trees scheduled to remain may be removed as approved by Landscape Architect.

Grading and Earthwork: Contractor to ensure positive drainage. Planting mix to be added to fill any depression that may hold excess moisture. Planting mix to be added to any planting area that has less than 6" of existing soil in order to achieve a 6" minimum soil profile after soil settlement. Minimize the addition of planting mix under dripline of existing trees. Final grading to be approved by Landscape Architect.

Concrete: Structural concrete shall be 3,000 psi minimum. All structural concrete to be reinforced as indicated on cross-sectional details.

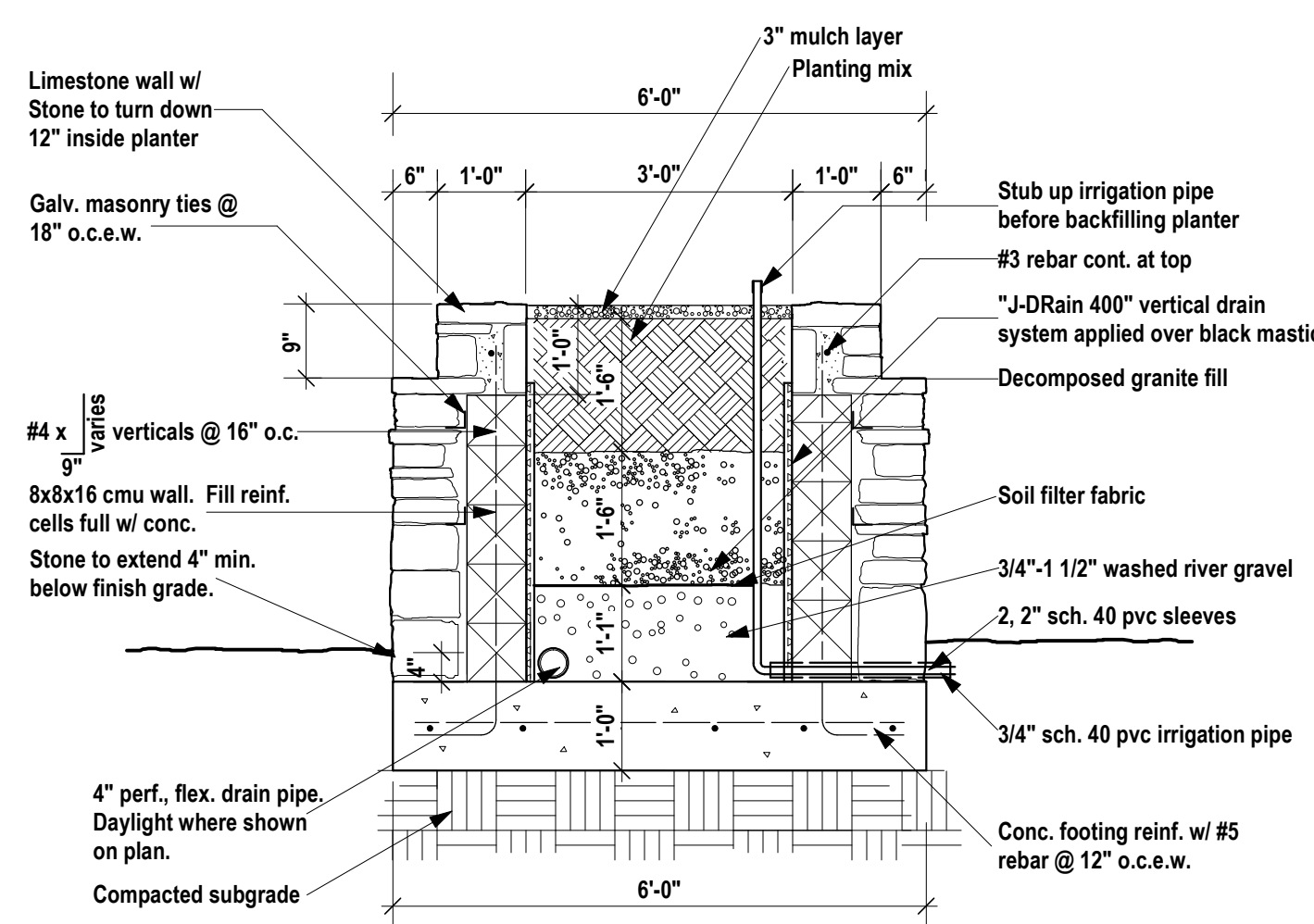

E Section - Stone Planter

Scale 1/2" = 1' - 0"

A Section - Concrete Curb and Gutter

Scale 3" = 1' - 0"

B Section - Concrete Curb and Gutter with Stem Wall

Scale 3" = 1' - 0"

C Section - Concrete Paving

Scale 1" = 1' - 0"

D Elevation - Stone Columns and Steel Access Gate

Scale 1/2" = 1' - 0"

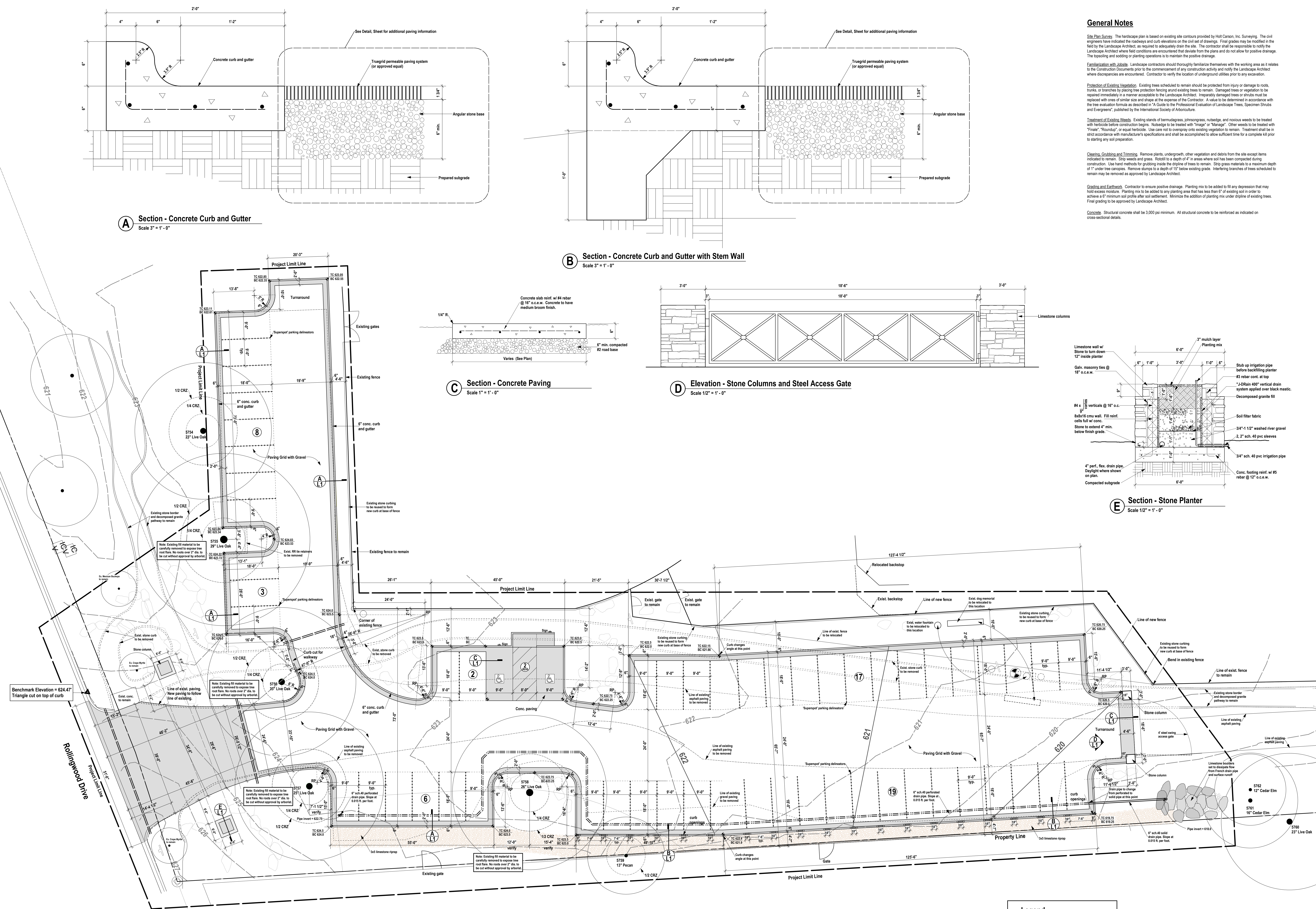

Legend

- + 624.0 Proposed Finish Grade Elevation
- BC Bottom of Curb Elevation
- TC Top of Curb Elevation
- TW Top of Wall Elevation
- (A) Detail
- (L2) Sheet No.
- 627 - Existing Contour Elevation
- 622 Proposed Contour Elevation
- 2, 4" Sch. 40 PVC Sleeves

Hardscape Plan

Scale 1" = 10'-0"

