

PROJECT INFORMATION

Project Name Ridgeway Park

County Iowa

Project Location Ridgeway, WI

Project Size

< 1 acres / _____ hectares

Township(s) Ridgeway

Town/Range T6N, R4E

Sections 14

USGS Quad Barneveld and Hollandale, WI 7.5' Quadrangles

Project Type EXL – Excess Land Sales

LA – Land Acquisitions

GDA – (General) Ground Disturbing Activities PD – Park Development WET – Wetland Development

HB – Historic Buildings

TS – Timber Sales

WHE – Wildlife Habitat Enhancements

LITERATURE SEARCH

Archaeology and Records Literature Search

X Attached

Previously reported sites in area

No

Cemetery in area

No

FIELDWORK

Dates of fieldwork 11/11/2022

Crew size 1

Area surveyed < 1 acres/ ___ hectares

SURVEY TECHNIQUES (attach project plans showing survey coverage)

Shovel testing

Surface collection

Other (please describe):

< 1 acres/ ___ hectares

___ acres/ ___ hectares

Visual inspection of sloped area

15-meter interval

meter interval

Describe visibility: The project area around the baseball field and near the paths featured no visibility. The dog park featured no visibility adjacent to the dog park fence, but on the slope of the historic fill to the south of the dog park there was excellent visibility.

LAND USE **Area not surveyed?** (Show on project plans)

Area extensively impacted?

Explain: The area adjacent to the dog park was not surveyed as it was on slope or was fill.

Explain: To the south of the dog park there is a large amount of fill placed to level out the parking area near the baseball fields. Utilities were also located near the easternmost path.

Comments: The proposed project includes improvements to two paths south and west of the baseball field, the replacement of lights surrounding the baseball field and building a retaining wall to the south of the dog park next to the slope (Figures 1 and 2). Two shovel tests were excavated at the locations of the two paths; shovel tests were also excavated around the western baseball field from dugout to dugout and was in line with the current light poles (Figures 3-6). All of the shovel tests encountered disturbed soils, several of which contained small pieces of historic debris. The location of the proposed retaining wall was visually inspected, but not shovel tested (Figures 7 and 8). The dog park is located in an area of slope and to the southeast of the dog park there is a mound of fill that contained historic debris as well. The slope of the historic fill was visually inspected. No cultural materials were recovered.

ISOLATED FINDS (Attach map showing locations) N/A

Describe:

N/A

RECOMMENDATIONS:

No further work is recommended.

I certify that the literature search and all fieldwork conducted for this report was done according to Wisconsin Archeological Survey Guidelines. No archaeological sites were identified in the project area.

Erik Anderson

Principal Investigator



Signature

12/01/2022

Date

Note: A USGS topographic map with the project area delineated thereon MUST accompany this form, as well as updated ASI (when indicated) and BAR forms. Additional documentation should be provided as needed. Human burial-related issues should be discussed with the WHS (contact the DNR archaeologist as well if project occurs on DNR property; phone: 608.266.3462).

Rev.: 09.2012



Figure 1. Map of surveyed areas on 2020 aerial.

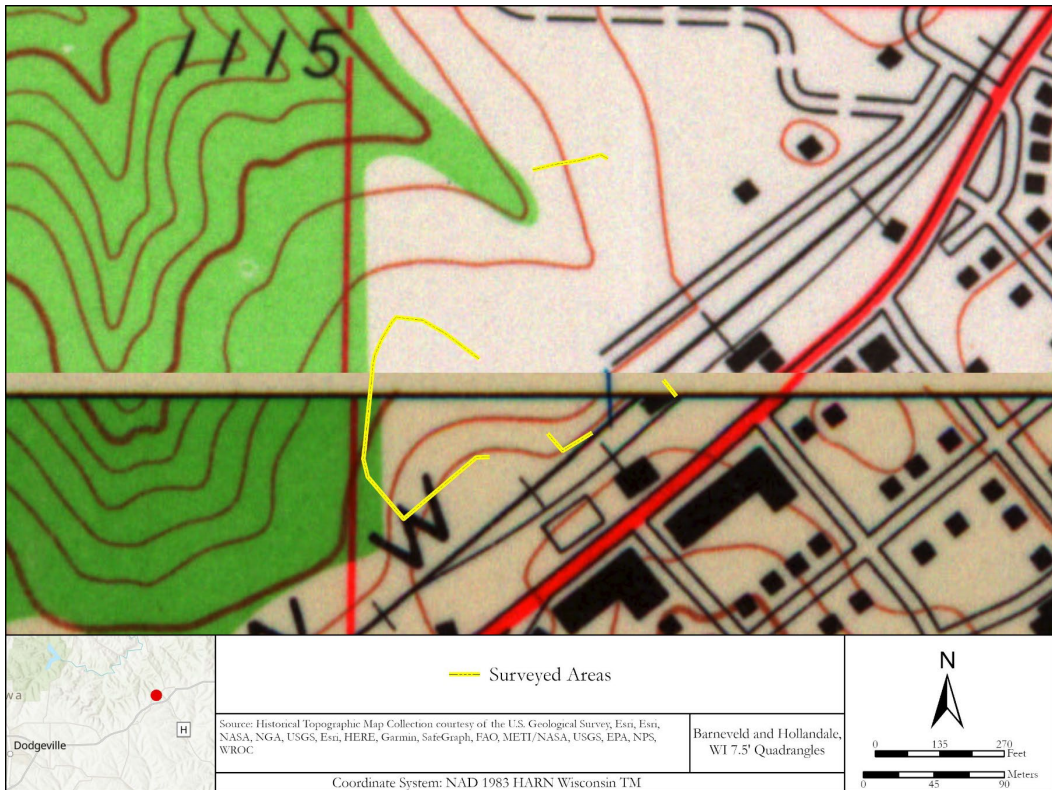

Figure 2. Map of surveyed areas shown on topographic maps.



Figure 3. Location of one of the two path improvements, view north. Photo taken 11/11/22.



Figure 4. Southern side of the baseball field showing shaped area, view southwest. Photo taken 11/11/22.



Figure 5. Southwestern corner of the baseball field showing area of shovel tests, view northwest. Shovel tests were excavated on the inside of the field due to the drop off to the north of the scoreboard. Photo taken 11/11/22.



Figure 6. Northern corner of the baseball field, near the foul ball pole along the first baseline, view west. Note the drop off almost immediately adjacent to the fence in the background. Photo taken 11/11/22.



Figure 7. Area of the retaining wall adjacent to the dog park, view southwest. Note the slope and large historic fill pile. Photo taken 11/11/22.



Figure 8. Photo taken from the top of the fill area located to the south of the dog park, view north. In the background the dog park is barely visible. Photo taken 11/11/22.

ARCHAEOLOGICAL LITERATURE AND RECORDS REVIEW

Project: Ridgeway Park

Township: Ridgeway

Township: 6N Range: 4E Section: 14

SITES IN PROEJCT AREA

Total Number of Sites: 0 Prehistoric: 0 Historic: 0 Cemeteries/Burials: 0

SITES WITHIN ONE MILE OF THE PROJECT AREA

Total Number of Sites: 12 Prehistoric: 7 Historic: 5 Cemeteries/Burials: 2

Site Number	Burial Site Number	Type	Affiliation
IA218	-	Cave/rockshelter; Campsite/village	Woodland
IA318	-	Cave/rockshelter	Unknown Prehistoric
IA321	-	Cave/rockshelter	Woodland
IA322	-	Cave/rockshelter	Woodland
IA418	-	Farmstead	Historic Euro-American
IA431	-	Rock art	Unknown Prehistoric
IA489	-	Lithic scatter	Unknown Prehistoric
IA490	-	Isolated finds	Unknown Prehistoric
IA508	-	HCM concentration; Isolated finds	Historic Euro-American
IA509	-	Farmstead	Historic Euro-American
-	BIA-0039	Cemetery/burial	Historic Euro-American
-	BIA-0057	Cemetery/burial	Historic Euro-American

WISCONSIN PUBLIC LANDS FIELD ARCHAEOLOGICAL PERMIT 2022
REQUIRED TO CONDUCT ARCHAEOLOGY ON ALL NON-FEDERAL PUBLIC LAND UNDER WIS. STAT. § 44.47
Wisconsin Historical Society

Name/Organization/Contact Vicki Twinde-Javner/MVAC Telephone 608-386-8967

Address 1725 State Street City La Crosse State WI Zip 54601

E-mail vtwinde-javner@uwlax.edu

Institutional Affiliation Mississippi Valley Archaeology Center - UW-La Crosse

Location: County Iowa Civil Town Ridgeway

Town 6N Range 4E Section 14 Quarter Sections _____

Hwy/Rd Hwy/Rd: _____ Other Type of Project: Park upgrades

Project Description: Potential park upgrades including utility work

Type of fieldwork: Phase I/Survey Phase II/Testing Phase III/Excavation Monitoring

Purpose of the fieldwork: Federal Compliance State Compliance Education Other

Site # _____ Burial Site # _____ Burial Permit Secured? Y N WHS #: _____

Dates of field work: Begin date: 10/12/2022 End date: 12/31/2022

What institution will curate recovered artifacts, notes, and records? MVAC
(A curation agreement must be on file with WHS; all materials must be curated in an appropriate, staffed facility.)

Print name Vicki Twinde-Javner see attachments

Signature of Archaeologist Vicki Twinde-Javner Digitally signed by Vicki Twinde-Javner
Date: 2022.10.12 13:13:33 -05'00' Date 10/12/2022

Maps and/or Letters of explanation can accompany this application

Landowner or custodian name Hailey Roessler Phone 608-924-5881

Affiliation: Clerk/Treasurer - Village of Ridgeway

Signature of Landowner Hailey Roessler Date 10/12/2022

Administrative use only below this line.

Permit Approved Jim M. Skibo Date 10/18/22

PLP # 22- 1770

Dr. James Skibo
State Archaeologist
Wisconsin Historical Society
816 State Street, Madison, WI 53706
608-264-6496
statearchaeologist@wisconsinhistory.org



**WISCONSIN
HISTORICAL
SOCIETY**

One paper copy and one PDF copy of the final report must be submitted to the State Historic Preservation Office.

Additional authorization or permitting is necessary to conduct work within the boundaries of uncataloged and cataloged human burial sites under Wis. Stat. § 157.70. For more information, wihist.org/Request-to-Disturb

ARCHAEOLOGICAL REPORTS INVENTORY FORM

WHS PROJECT # _____

COUNTY Iowa

AUTHORS: Erik Anderson

REPORT TITLE: DNR ASFR for a Phase I Survey in the Village of Ridgeway for Improvements to Ridgeway Ballpark, Iowa County, Wisconsin.

DATE OF REPORT (MONTH AND YEAR): December 2022

SERIES/NUMBER: SR-2022-201

PLACE OF PUBLICATION: Mississippi Valley Archaeology Center at UW-La Crosse

LOCATIONAL INFORMATION [LEGAL DESCRIPTION OF SURVEY AREA (T-R-S)]

T6N R4E Section 14

U.S.G.S. QUAD MAP(S): Barneveld and Hollandale, WI 7.5' Quads

SITE(S) INVESTIGATED: N/A

ACRES INVESTIGATED: <1

AGENCY # _____

INVESTIGATION TECHNIQUES COMPLETED (Check all that apply.)

- | | | |
|--|---|--|
| <input type="checkbox"/> Historical Research | <input type="checkbox"/> Surface Survey | <input type="checkbox"/> Geomorphology |
| <input type="checkbox"/> Interview/Informant | <input type="checkbox"/> Soil Core | <input type="checkbox"/> Underwater |
| <input type="checkbox"/> Records/Background | <input checked="" type="checkbox"/> Walk Over/Visual Inspection | <input type="checkbox"/> Avocational Survey |
| <input type="checkbox"/> Literature Background Research | <input type="checkbox"/> Mechanical Stripping | <input type="checkbox"/> Chance Encounter |
| <input type="checkbox"/> Traditional Knowledge | <input type="checkbox"/> Test Excavation/Phase II | <input type="checkbox"/> Osteological Analysis |
| <input type="checkbox"/> Monitoring | <input type="checkbox"/> Major Excavation/Phase III | <input type="checkbox"/> Faunal Analysis |
| <input checked="" type="checkbox"/> Shovel Testing/Probing | <input type="checkbox"/> Remote Sensing | <input type="checkbox"/> Floral Analysis |

ABSTRACT: Included in report Written in space below

In November 2022, MVAC personnel conducted a Phase I survey within the Village of Ridgeway for proposed upgrades to the Ridgeway Ballpark and dog park. Shovel tests were excavated where the locations of two path upgrades and around the western baseball field for the installation of new lights. All shovel tests encountered disturbed soils. The location for the new retaining wall at the dog park was located on slope and adjacent to a large mound of fill. The slope of historic fill was visually inspected. No cultural materials were recovered and no further work is recommended.