

THE VILLAGE OF

EST. 1881



# RIDGEWAY

208 Jarvis Street | Suite A | Ridgeway, WI 53582

RECEIVED  
MAY 16 2022

## CSM, Conditional Use, Change Of Use, Zoning District Change, Or Variance Application

Property Address: Lots 16 + 17 Keane St. Parcel #: 177-0173

Owner's Name: Maynard Peterson Phone: Best Way Realty

Email: N/A \* Tracy Peterson - 608-347-7780

### Check Items Applicable for Type of Action Requested:

**Conceptual Land Division CSM: (Certified Survey Map) Request: \$100.00 + \$10 per lot**  
Include CSM

**Conditional Use Permit: \$400.00**  
Describe what Conditional Use will be: \*Personal Use\*  
Personal use Garage will have water + sewer hook up for Full bath + Natural GAS for water heater for winter heat

**Zoning District Change: \$400.00**-Reason for Change: \_\_\_\_\_

**Variance Request: \$400.00**-Include site plan with dimensions and reasons for hardship: \_\_\_\_\_

### Request made by:

Applicant (if different than owner): Ryan Peck - Rpeck\_1989@hotmail.com

Phone: 608-341-9773 4033 Twin Court

Signature of Owner/Applicant: [Signature] Date: 5/15/22

### FOR OFFICE USE ONLY:

|                                     |   |  |
|-------------------------------------|---|--|
| Application: <u>Approved</u> Denied | <u>ck 1709</u><br><u>\$400</u><br><u>HR</u> | Next Plan Commission Meeting: <u>TBD</u> |
| Fee Paid: <u>5/16/22</u>            |   | Approved Denied                          |

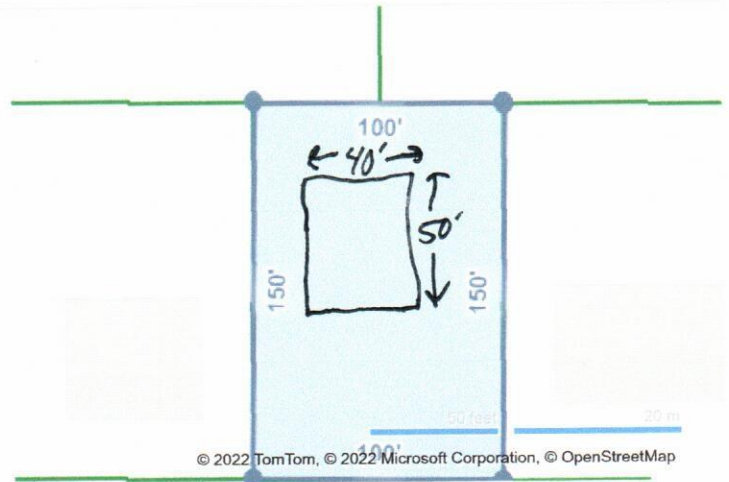

**LOCATION**

|                           |                               |
|---------------------------|-------------------------------|
| <b>Property Address</b>   | No Address Available<br>WI    |
| <b>CTV Municipality</b>   | Village Of Ridgeway           |
| <b>Legal/Subdivision</b>  | Lots 16 & 17 Keane's Addition |
| <b>County</b>             | Iowa County, WI               |
| <b>Latitude/Longitude</b> | 42.997437°/-89.989420°        |

**CURRENT OWNER**

|                        |                                       |
|------------------------|---------------------------------------|
| <b>Name</b>            | Peterson Maynard                      |
| <b>Mailing Address</b> | 101 Edl Ln<br>Ridgeway, WI 53582-9797 |

**GENERAL PARCEL INFORMATION**

|                         |            |                             |          |
|-------------------------|------------|-----------------------------|----------|
| <b>Parcel ID/Tax ID</b> | 177-0173   | <b>Total Acres</b>          | 0.34     |
| <b>Township</b>         |            | <b>Lot Sq Feet</b>          | 14,985   |
| <b>Range</b>            |            | <b>Total Assessment</b>     | \$17,700 |
| <b>Section</b>          |            | <b>NET Taxes</b>            | \$516.32 |
| <b>School District</b>  | Dodgeville | <b>2010 Census Trct/Blk</b> | 9505/2   |

**TAXES**

| Tax Year | Total Specials | Other Taxes | Lottery Credit | Other Credits | NET Taxes |
|----------|----------------|-------------|----------------|---------------|-----------|
| 2021     |                |             |                |               | \$516.32  |
| 2020     |                |             |                |               | \$519.02  |
| 2019     |                |             |                |               | \$479.21  |
| 2018     |                |             |                |               | \$443.42  |
| 2017     |                |             |                |               | \$447.45  |

**TAX ASSESSMENT**

| Tax Assessment               | 2021        | Change (%) | 2020                 | Change (%) | 2019                         |
|------------------------------|-------------|------------|----------------------|------------|------------------------------|
| <b>Assessed Land</b>         | \$17,700.00 |            | \$17,700.00          |            | \$17,700.00                  |
| <b>Assessed Improvements</b> |             |            |                      |            |                              |
| <b>Total Assessment</b>      | \$17,700.00 |            | \$17,700.00          |            | \$17,700.00                  |
| <b>Est Market Value</b>      | \$20,200.00 |            | \$19,700.00          |            | \$18,400.00                  |
| <b>Land Percentage</b>       | 100.00%     |            | 100.00%              |            | 100.00%                      |
| <b>Assessment Ratio</b>      | 0.8762      |            | 0.8985               |            | 0.9620                       |
| <b>Mill Rate</b>             | 0.029172    |            |                      |            |                              |
| <b>Land Use</b>              | <b>Size</b> |            | <b>Assessed Land</b> |            | <b>Assessed Improvements</b> |
| RESIDENTIAL                  | 0.344 Ac    |            | \$17,700             |            |                              |

**SCHOOL INFORMATION**

These are the closest schools to the property

| Elementary | Distance | Middle | Distance | High | Distance |
|------------|----------|--------|----------|------|----------|
|------------|----------|--------|----------|------|----------|

