

DIGIRIDER HORSE

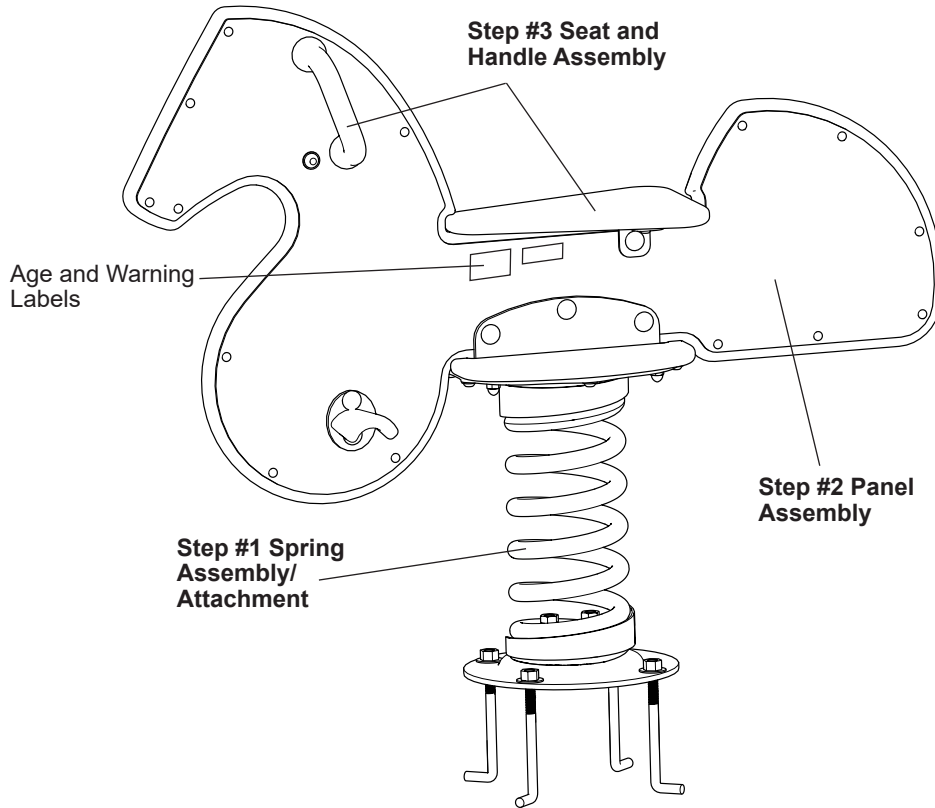

SECTION/ SURFACE MOUNTING

NOTE: Sufficient protective surfacing must cover hardware to satisfy fall height requirements.

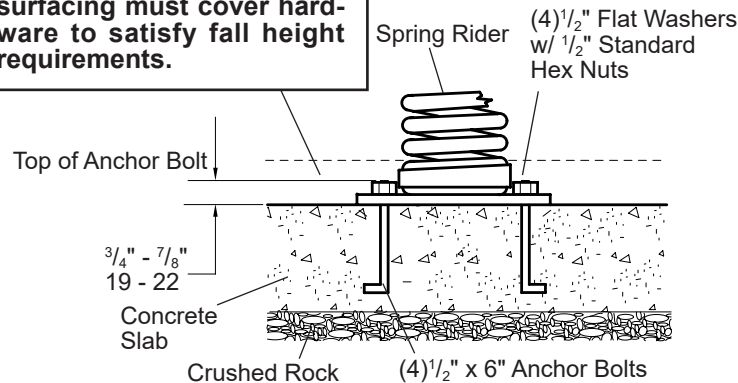

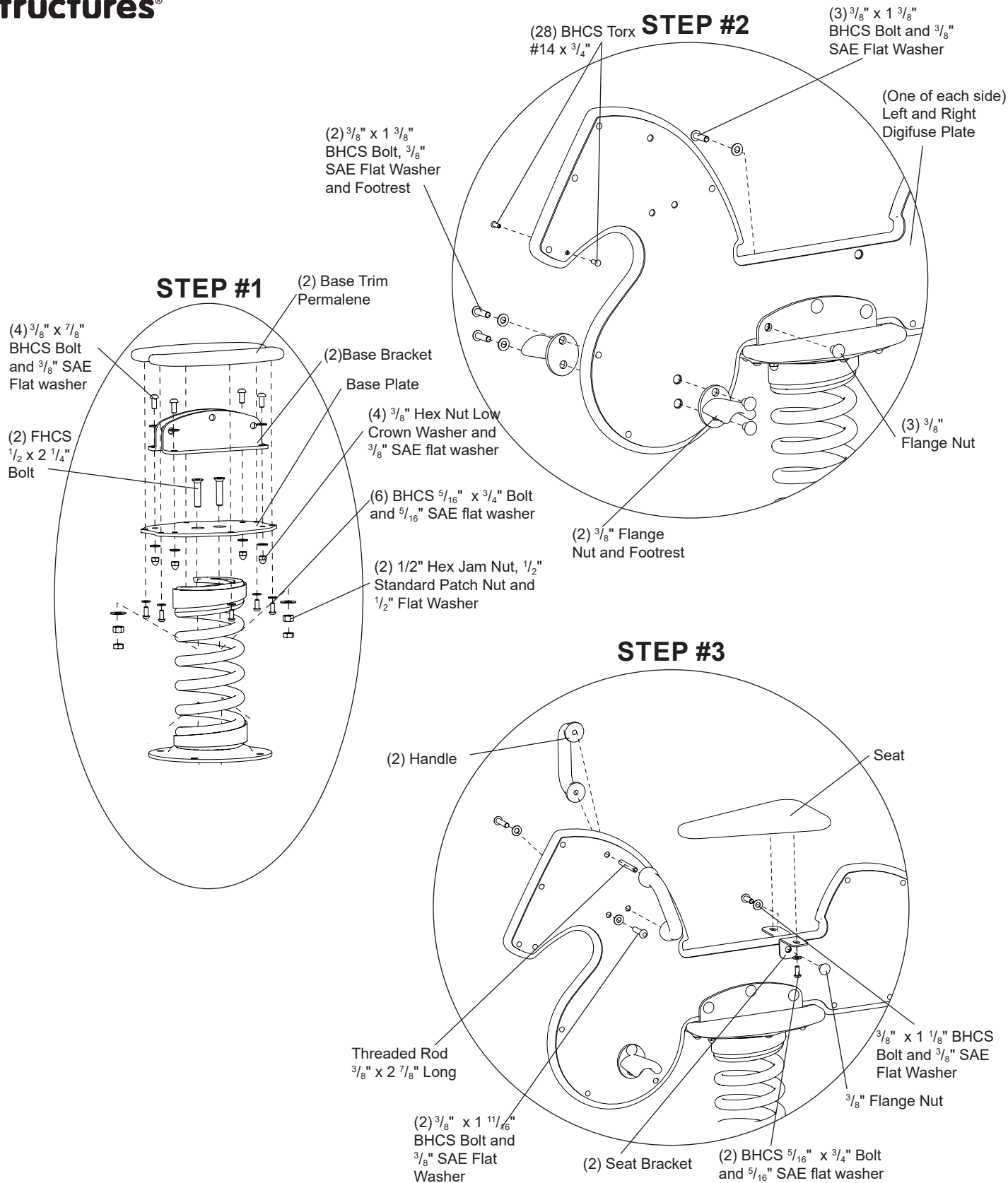

233060 DigiRider™ Horse, w/Coil Spring

Permalene Panels: Permalene Main Panel and Trim Panels. Black in Color, Seat Panel, Gray in Color.

Brackets: Fabricated from 7Ga (.179") HRS. Finish: ProShield, Black in Color.

Base Plate: Fabricated from 1/4" x 10" HRPO formed plate. Finish: ProShield, Black in Color.

Footrest: Cast from 356-T6 aluminum alloy. Finish: ProShield, Black in Color.

Handles: Cast from 356 aluminum alloy. Finish: ProShield, Black in Color.

Fasteners: Primary fasteners shall be socketed and pinned Tamperproof in design, stainless steel (SST) per ASTM F 879 unless otherwise indicated (see specific product installation/specifications).

Installation Time: Approx. 3 man hours

Concrete Req.: Approx. 10 cu. ft. DB= 3 Cubic FT.

Area Req.: 13'-0" x 15'-0" (3,96 m x 4,57 m) minimum use zone

Weight: 92 lbs. Direct Bury

76 lbs. Surface Mount

Seat Height: 18 3/4" (520 mm)

Fall Height: 20" (510 mm)

Installation Instructions

Surface Mounting On Concrete Slab

- Using the spring base plate as a pattern, make a plywood template for anchor bolt placement.
- Attach 1/2" x 6" anchor bolts with 1/2" flat washers and 1/2" standard hex nuts to holes in template. Allow 3/4" to 7/8" of thread to protrude from concrete.
- Pour concrete slab and lay template on surface in level position. Push anchor bolts into concrete, allowing 72 hours before template removal.
- Attach spring assembly to anchor bolts in concrete with 1/2" standard hex nuts and 1/2" flat washers. Assembly spring to attachments. **Refer to Step 1.**
- Attach DigiFuse to Permalene Panels, then attach spring and foot pedals. **Refer to Step 2.**
- Attach steering wheel and seat to panels. **Refer to Step 3.**
- Final tighten all fasteners.
- Apply labels as shown.
- Install protective surfacing before users are allowed to play on the component. A minimum of 2" of protective surfacing should cover base plate and anchor bolts.

Direct Bury Mounting

- Dig footing hole as shown.
- Attach leg to spring assembly of spring rider using 3/8" x 1 1/8" BHCS w/pin with 3/8" SAE flat washers and 3/8" standard hex nuts with 3/8" SAE flat washers.
- With leg plumb and spring rider propped up, pour concrete footing and let cure for a minimum of 72 hours before using.
- Install protective surfacing before users are allowed to play on the component.

Part#	Description	Qty.
136479	Foot Rest, Black	2
228361	Tuffriders DigiFuse Seat Brkt, Black	2
132276	Spring Assembly, Black.....	1
229817	Tuffriders DigiFuse Base Plate Pnt, Black	1
229818	Tuffriders DigiFuse Base Bracket Pnt, Black.....	2
105752	Handle, Black	2
115154	(Direct Bury) Leg Spring, Black	1

237178	Boxed DigiRider Horse Plastic.....	1
230338	Tuffriders Horse Main Perm, Black	1
230341	Tuffriders Horse DigiFuse Left	1
230344	Tuffriders Horse DigiFuse Right	1
230047	Tuffriders Base Trim Perm, Black.....	2
230808	Tuffriders Seat w/ Inserts, Gray.....	1

293801	Hdw Pkg DigiFuse Horse.....	1
100196	BHCS 6LP 3/8 x 7/8" SST.....	4
100363	Washer Flat 1/2" SST	2
100198	BHCS 6LP 3/8 x 1 1/8" SST.....	1
100349	Nut L/C CAP 3/8", SST	4
100353	3/8" Flange Nut w/Pin, SST.....	6
100365	3/8" SAE Flat Washer, SST.....	16
113027	BHCS 6LP 3/8 x 1 3/8", SST.....	5
127463	Bit Hex TPP T-27 (TORX).....	1
130824	FHCS 1/2 x 2 1/4", SST.....	2
200332	Label Play Safe 2-12 Years.....	1
129692	1/2" Standard Patch Nut, SST	2
129693	1/2" Hex Jam Nut, SST	2
216760	BHCS Torx #14 x 3/4" SST Thread Type A.....	28
223807	BHCS 6LP 5/16" - 18 x 3/4", SST.....	8
223956	Washer Flat SAE 5/16" SST.....	8
183064	Warning Label	1
100643	Threaded Rod 3/8" x 2 7/8", SST	1
123224	BHCS 6LP 3/8 x 1 11/16", SST	2

120202	Spring Animal Anchor (SM) Hardware Package ...	1
100262	1/2" x 6" Anchor Bolt.....	4
100322	1/2" Standard Hex Nut, SST	4
100363	1/2" Flat Washer, SST	4

115326	Spring Rider (DB) Hardware Package	1
100198	3/8" x 1 1/8" BHCS w/Pin, SST	4
100327	3/8" Standard Hex Nut, SST	4
100365	3/8" SAE Flat Washer, SST.....	8

DB= Direct Bury

SM= Surface Mount

Specifications

Spring: Weldment comprised of 5 5/8" (142,88 mm) diameter 13/16" (20,64 mm) tempered alloy steel coil. Finish: ProShield®, black in color.

DigiFuse Panels: Made from 1/8" (3,17 mm) thick aluminum sheet. Dye sublimation printed digital artwork is fused onto the powdercoated substrate.

Spring Wedge: Casting made from A-356T-6 aluminum. Finish: ProShield, color specified.

Leg: Weldment comprised of 3 1/2" O.D. RS-20 (.120" - .130") galvanized steel tubing and 1/4" x 10" diameter HRPO zinc plated steel mounting plates. Finish: ProShield, Black in Color.

