

SITE UTILITIES PLAN

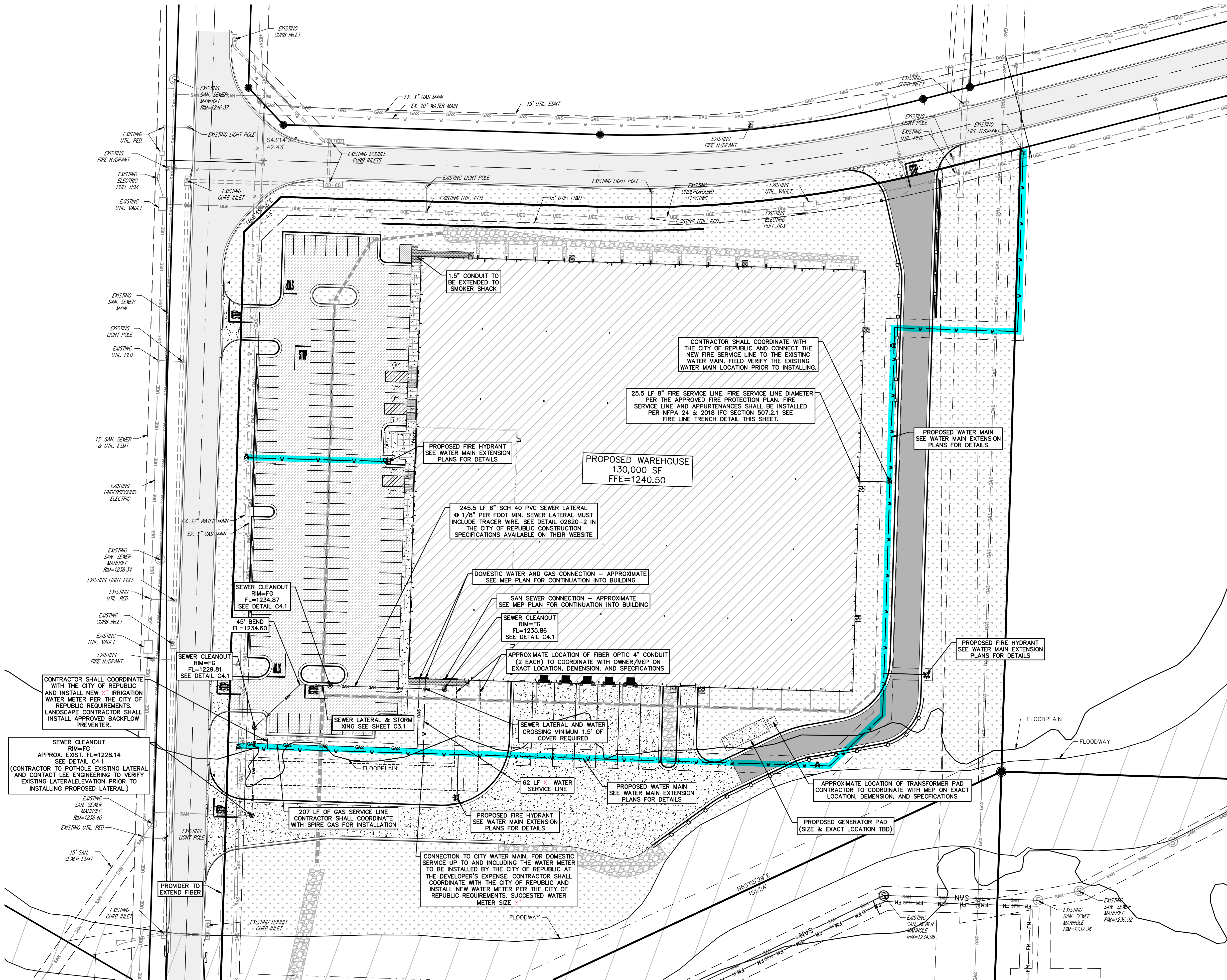
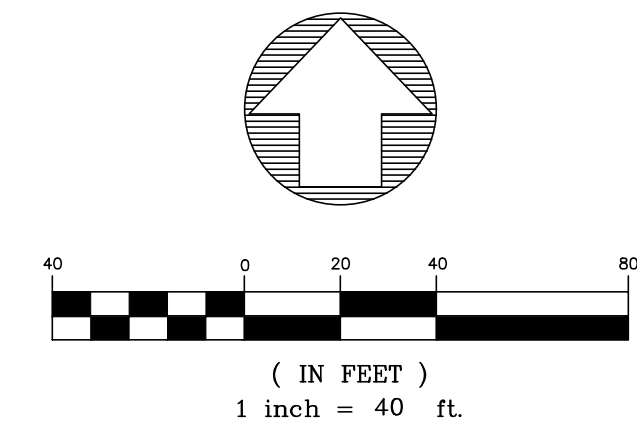

DATE:	
REVISIONS:	
SCALE: 1" = 40'	
FIELD BY: JS, AL	
DRAWN BY: RS	
CHECKED BY: RS	

SITE UTILITIES PLAN
PROPOSED WAREHOUSE
LOT 7 - HANKINS FARM

3176 NORTH DRURY LANE, REPUBLIC, GREENE COUNTY, MISSOURI

Missouri State Certificate of Authority
 Engineering #2005015504
 Land Surveying #2009028050

LEE Engineering & Associates, L.L.C.
 1200 E. Woodhurst Dr., Suite D200
 Springfield, Missouri 65804
 417-886-9100 (phone)
 417-886-9336 (fax)
 lee@leeengineering.biz

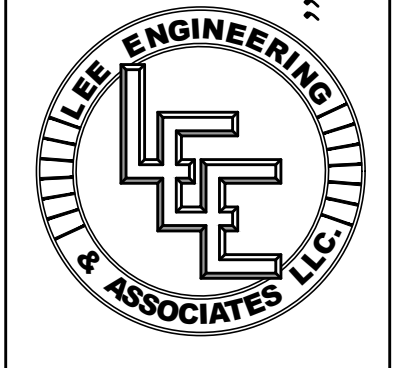

Richard & Stalder

05/16/2024

DATE: 2024-05-16

SHEET: C6.0

PROJECT: 2017

FILE: 2017 - Hankins Farm Lot 7 Site.dwg