

BENCHMARK:

BM H-5
N: 148624.482m
E: 418638.815m
ELEV: 390.859m

GENERAL NOTES

- 1) IT IS THE CONTRACTOR'S RESPONSIBILITY TO DETERMINE THE EXACT HORIZONTAL AND VERTICAL LOCATION OF EXISTING UNDERGROUND FACILITIES PRIOR TO BEGINNING INSTALLATION OF NEW FACILITIES. CONTACT THE ENGINEER FOR INSTRUCTIONS WHEREVER ANY CONFLICTS ARE DISCOVERED.
- 2) IT IS THE CONTRACTOR'S RESPONSIBILITY TO CORRECT ANY DAMAGE TO UNDERGROUND UTILITIES OR OTHER OBSTRUCTIONS WHICH IS DUE TO HIS OPERATIONS.
- 3) THE CONTRACTOR AND/OR BUILDER WILL KEEP THE PROJECT AREA NEAT AND ORDERLY AT ALL TIMES WHILE BUILDING IS TAKING PLACE. ACCESS STREETS TO THE PROJECT SHALL BE KEPT CLEAN OF MUD, DEBRIS, PAPER AND WASTE MATERIAL AT ALL TIMES. CONTRACTOR SHALL PROVIDE GRAVEL CONSTRUCTION ENTRANCES AT EACH ACCESS POINT.
- 4) THE CONTRACTOR SHALL STRICTLY COMPLY WITH ALL OSHA SAFETY RULES AND REGULATIONS AND USE ONLY APPROVED EQUIPMENT REQUIRED FOR THE PERFORMANCE OF THE WORK. THE CONTRACTOR SHALL ALSO STRICTLY COMPLY WITH ALL OSHA SAFETY RULES AND REGULATIONS AND USE ONLY APPROVED METHODS OF EXCAVATION TRENCHING AND SHORING METHODS AS DESCRIBED IN OSHA 29 CFR 1926.650. THE CONTRACTOR SHALL MAINTAIN AND CLOSELY SUPERVISE ALL SAFETY PRACTICES AND CODES.
- 5) ALL COMPACTED OR BACKFILLED AREAS SHALL MEET 95% STANDARD PROCTOR DENSITY. ANY SOILS IN EXCAVATED SOFT OR WET AREAS THAT DO NOT MEET 95% STANDARD PROCTOR DENSITY SHALL BE REMOVED, RECOMPACTED, AND RETESTED.
- 6) THE CONTRACTOR SHALL MINIMIZE DISTURBANCE OF AREA AND PHASE CONSTRUCTION SUCH THAT NO DISCHARGE OF SEDIMENT OR SEDIMENT-LADEN WATER OCCURS ON OFF-SITE PROPERTY. ANY ACCUMULATED SEDIMENT IN STORM DRAINS OR OFF-SITE PROPERTY SHALL BE REMOVED PRIOR TO FINAL ACCEPTANCE.
- 7) THE CONTRACTOR SHALL CLEAN STREETS, BOTH INTERIOR AND ADJACENT TO THE SITE, AS NEEDED, AFTER EACH RAINFALL AND AT THE END OF CONSTRUCTION.
- 8) THE CONTRACTOR SHALL VISIT THE SITE AND BECOME FULLY FAMILIAR WITH ALL OF THE CONDITIONS THAT PERTAIN TO THE WORK DESCRIBED HEREIN. THE FAILURE TO UNDERSTAND OR TO HAVE KNOWLEDGE OF ISSUES THAT COULD HAVE BEEN DETERMINED PRIOR TO BIDDING WILL NOT CONSTITUTE GROUNDS FOR ASKING FOR WORK CHANGE ORDERS OR EXTRA WORK.
- 9) THE CONTRACTOR IS RESPONSIBLE FOR REPAIRING ANY DAMAGE TO CURB AND PAVEMENT BACK TO CITY OF REPUBLIC SPECIFICATIONS.
- 10) THE CONTRACTOR IS REQUIRED TO RETAIN FLOATABLE WINDBLOWN MATERIALS ON SITE BY STORING ALL TRASH AND BUILDING MATERIAL WASTE IN ENCLOSURES UNTIL PROPER DISPOSAL AT OFF-SITE FACILITIES. CONTRACTOR IS REQUIRED TO CHECK ADJACENT AREAS DAILY AND PICK UP CONSTRUCTION WASTE MATERIALS AND DEBRIS THAT HAVE BLOWN OR WASHED OFF-SITE.
- 11) CONTRACTOR IS REQUIRED TO TAKE CARE NOT TO DAMAGE ANY EXISTING STREET, CURB & GUTTER, SIDEWALK AND DRIVEWAY DURING CONSTRUCTION.
- 12) CONTRACTOR IS REQUIRED TO KEEP THE ROCK, MUD AND DIRT OFF OF ALL ROADWAYS DURING CONSTRUCTION.

NOTES:

WATER AND SEWER UTILITIES TO BE PROVIDED BY:
CITY OF REPUBLIC
213 NORTH MAIN STREET
REPUBLIC, MO 65738
(417) 732-3100

GAS TO BE PROVIDED BY:
SPIRE ENERGY
3541 E SAWYER RD.
BROOKLINE, MO. 65802
417-682-1681

ELECTRIC UTILITIES TO BE PROVIDED BY:
CITY UTILITIES OF SPRINGFIELD
301 E. CENTRAL
SPRINGFIELD, MO 65802
(417)863-9000



LEGEND

- | | |
|-----------------------------------|--|
| ● FOUND IRON PIN | ☎ PHONE/COMMUNICATION MANHOLE |
| ○ SET IRON PIN OR MARKER AS NOTED | ☎ PHONE PEDESTAL |
| △ R/W MARKER | — TV CABLE TV RISER |
| — BOUNDARY LINE | — U UNDERGROUND PHONE |
| --- R/W LINE | — O OVERHEAD PHONE |
| --- EASEMENT LINE | — F O FIBER OPTIC LINE |
| --- SETBACK LINE | |
| (M) MEASURED | — V WATER VALVE |
| (P) PLAT | — M WATER METER |
| (D) DEED | — W WATER LINE |
| (R) RECORD | — F FIRE HYDRANT |
| ☆ LIGHT POLE | — G GAS VALVE |
| ☉ SANITARY SEWER MANHOLE | — M GAS METER |
| ⊙ SANITARY SEWER CLEANOUT | — GAS GAS LINE |
| — SAN SANITARY SEWER LINE | — X FENCE LINE (AS NOTED) |
| | — R ROAD SIGN (STOP, SPEED LIMIT, ETC) |
- ABBREVIATIONS:**
- | | |
|------|--------------------------|
| XFMR | TRANSFORMER |
| ICV | IRRIGATION CONTROL VALVE |
| CI | STORMWATER CURB INLET |

ROADWAY AND STORMWATER IMPROVEMENTS IRON GRAIN LANE, REPUBLIC, MO

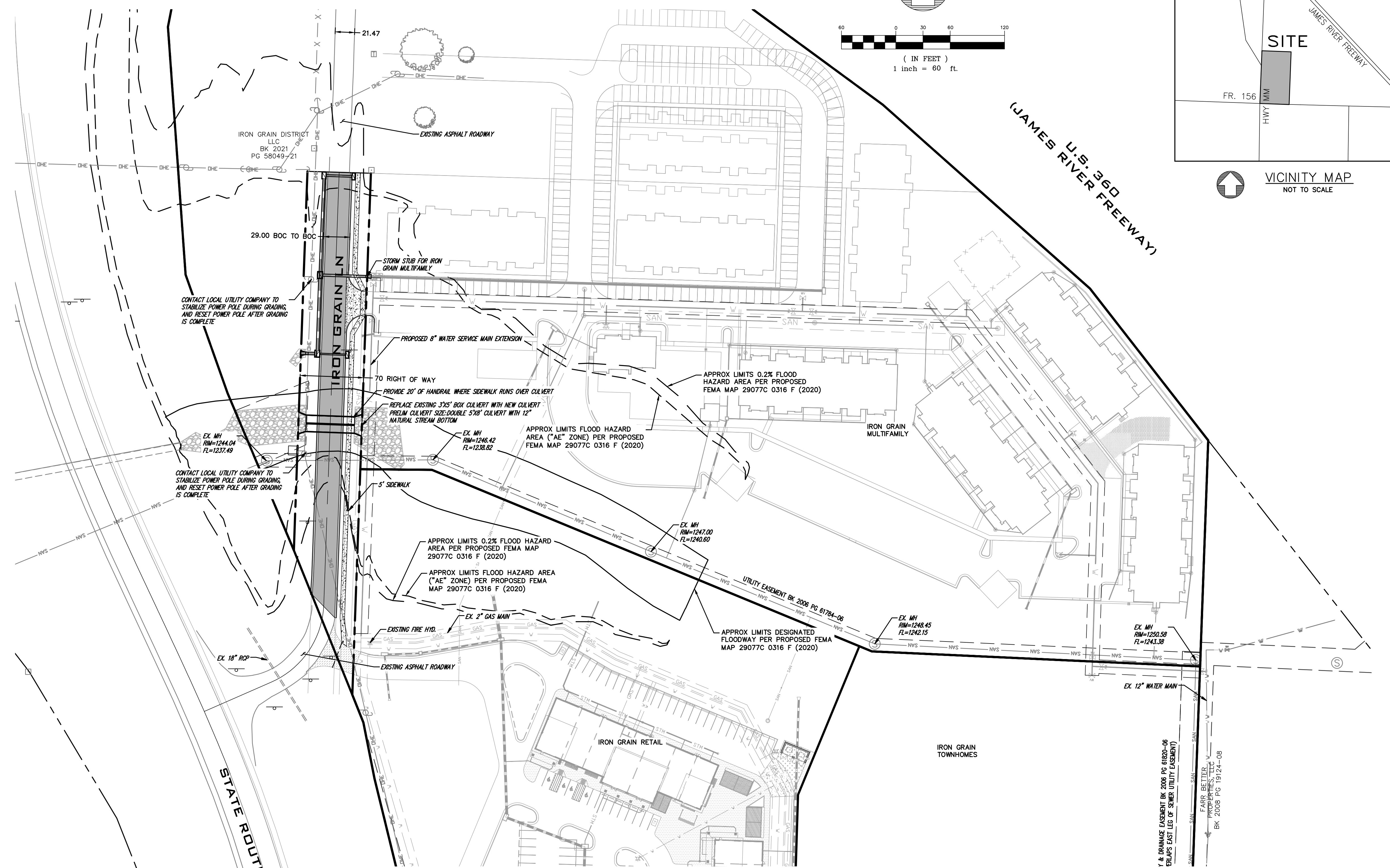
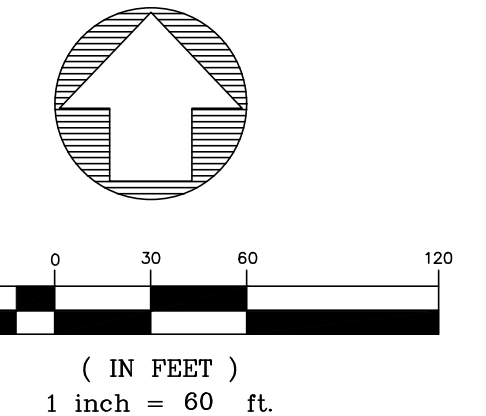

FLOOD NOTE:
THIS PROPERTY LIES IN FLOOD ZONE "X" (AREAS DETERMINED TO BE OUTSIDE OF THE 0.2% ANNUAL CHANCE FLOODPLAIN) ACCORDING TO FIRM COMMUNITY PANEL 29077C 0316 E, EFFECTIVE DECEMBER 17, 2010.

HOWEVER, THE PROPOSED "F" SERIES MAPS, NOT YET ADOPTED OR EFFECTIVE, SHOW A PORTION OF THE PROPERTY LYING WITHIN THE FLOOD HAZARD AREA ALONG WITH A DESIGNATED FLOODWAY. THE APPROXIMATE LIMITS OF THE HAZARD AREA SHOWN ON THE PROPOSED MAPS ARE REFLECTED ON THIS DRAWING.

DATE:	
REVISIONS:	
SCALE: 1" = 60'	
FIELD BY: TS, JS	
DRAWN BY: DCR	
CHECKED BY:	

COVER SHEET
IRON GRAIN LANE IMPROVEMENTS

2510 STATE HWY MM
REPUBLIC, MO

Missouri State Certificate of Authority
Engineering #2035015504
Land Surveying #2009028050

LEE Engineering & Associates, L.L.C.
1200 E. Woodhurst Dr., Suite D200
Springfield, Missouri 65804
417-886-9100 (phone)
417-886-9336 (fax)
dl@leeengineering.biz

"Engineering with Integrity"

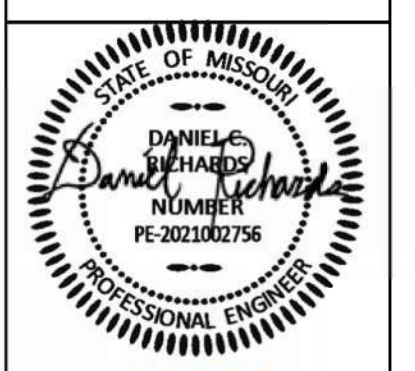
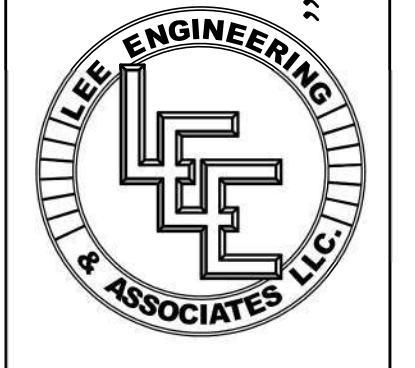

DATE: 2024-03-14

SHEET: T1

PROJECT: 2123

FILE: Iron_Grain_Lane_Public_Improvements.dwg

APPROVED FOR CONSTRUCTION BY THE CITY OF REPUBLIC, MISSOURI
DATE: 04/05/2024
FORM: SUBSCRIBER 21-001