

**CITY REQUIREMENTS:**

- 405.570.A.6 - 3 SPACES PLUS 1 PER EMPLOYEE. 1 LOADING SPACE PER 10,000 SF FRONT, REAR, SIDE SB 15', MAX LOT 90%, 60' BUILDING HEIGHT
- 405.770 - 10% LANDSCAPE (14.04 AC SITE)
- 405.600 - 9X19' SPACES. 12' ONE-WAY (30' SPINE TO SPINE), 23' TWO-WAY (91' SPINE TO SPINE)
- 405.810 - SCREEN-6' OPAQUE SCREEN W/TREES 12' O/C, OR SMALL TREES 30' O/C W/ 6' SHRUBS 4' O/C

**PROVIDED:**

- 7 SPACES (INCLUDING 1 ADA) AND 2 SINGLE LOADING SPACES, 1 MULTI SETBACK REQUIREMENTS MET

**IMPERVIOUS AREA:**

- 14.01 AC TOTAL
- 10.74 AC IMPERVIOUS (76.71%)
- 3.27 AC GREEN SPACE (23.29%)

**STORAGE UNITS:**

- 10'X30' UNITS - 559
- 12'X40' RV/BOAT STORAGE - 42
- 10'X10' CC UNITS - 43
- 10'X20' CC UNITS - 9
- 11'X10' CC UNITS - 2

**BUILDING AREA:**

- 10'X30' UNITS - 167,700 SF
- 12'X40' RV/BOAT STORAGE - 20,160 SF
- CLIMATE CONTROLLED BUILDING - 11,305 SF
- OFFICE - 400 SF
- TOTAL - 199,565 SF

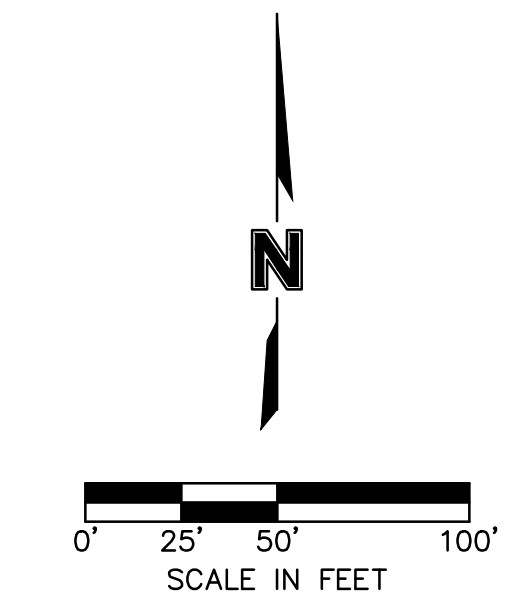
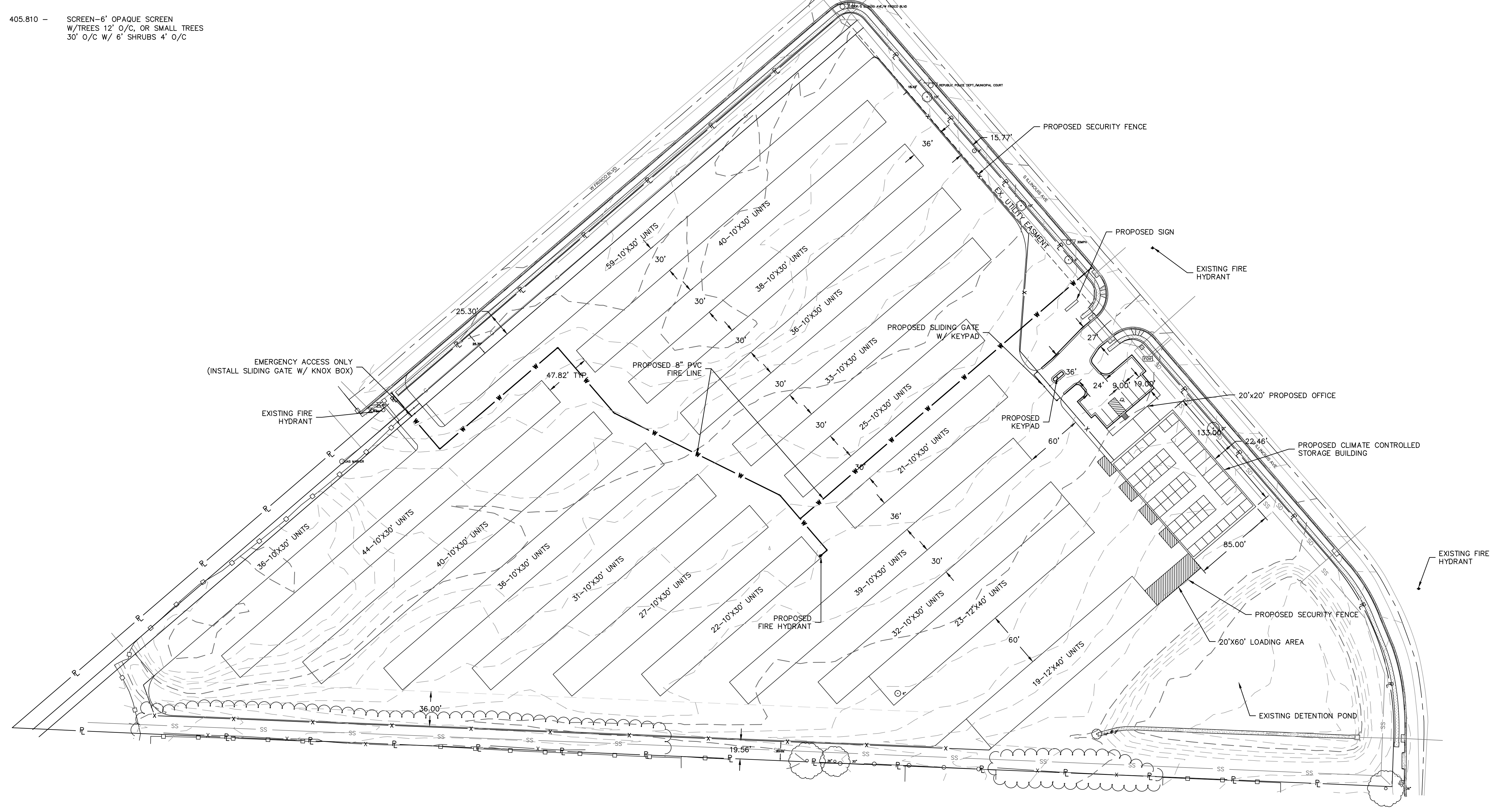

REV. NO.	DATE	REVISIONS DESCRIPTION	BY

SITE PLAN  
 DIRTWORK SELF STORAGE  
 REPUBLIC, MO  
 2022

drawn by: \_\_\_\_\_  
 checked by: \_\_\_\_\_  
 approved by: \_\_\_\_\_  
 QA/QC by: \_\_\_\_\_  
 project no.: \_\_\_\_\_  
 drawing no.: \_\_\_\_\_  
 date: \_\_\_\_\_

**SHEET**  
C1.0

DWG: F:\2021\08001-08500\021-08170-Design\AutoCAD\Final Plans\Sheets\GNVA\C\_SIT01\_02108170.dwg  
 DATE: Mar 09, 2022 9:28am  
 USER: jholt  
 C:\XENDY\_02108170 C:\XTOPD\_02108170