

**REPLAT
OF
LOT 1, OLD STONE DEVELOPMENT**
SECTION 10, TOWNSHIP 28 NORTH, RANGE 23 WEST
CITY OF REPUBLIC, GREENE COUNTY, MISSOURI

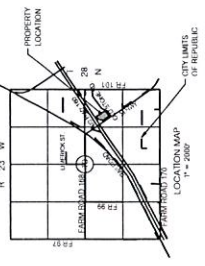

GENERAL NOTES:
 1- TOTAL AREA: 14,493.51 (1.14 AC)
 2- TOTAL NUMBER OF LOTS: 1
 3- SOURCE OF TITLE: BOOK 2019 PAGE 298 1-18
 4- THE SURVEY SHOWN HEREON WAS PERFORMED TO MEET OR EXCEED THE REQUIREMENTS FOR SUBMITTING A PLEA TO DISBURSE WITH THE MISSOURI STATUTE BOOKS FOR PROPERTY.
 5- BOUNDARY SURVEYS, UNLESS OTHERWISE SPECIFIED, SHALL BE CONSIDERED TO BE CONDUCTED IN ACCORDANCE WITH THE MISSOURI STATUTE BOOKS FOR PROPERTY.
 6- GREENE COUNTY RECORDERS OFFICE
 7- ALL RIGHTS RESERVED TO MISSOURI LAND SURVEYING, INC. (MLS)
 8- ALL RIGHTS RESERVED TO MISSOURI LAND SURVEYING, INC. (MLS)
 9- ALL RIGHTS RESERVED TO MISSOURI LAND SURVEYING, INC. (MLS)
 10- ALL RIGHTS RESERVED TO MISSOURI LAND SURVEYING, INC. (MLS)
 11- ALL RIGHTS RESERVED TO MISSOURI LAND SURVEYING, INC. (MLS)
 12- ACCORDING TO FEMA COMMUNITY PANEL NUMBER 20000076E DATED DECEMBER 11, 2010, THE SURVEYED PROPERTY IS NOT IN A 100 YEAR FLOOD HAZARD.

CERTIFICATE OF TAXES PAID:
 I HAVE SEARCHED THE TAX AND PARCEL AT THE TIME OF MY PERSONAL AND UPWARD OFFICIAL ASSESSMENTS, AND I HEREBY CERTIFY THAT THE REPEAT OF LOT 1, OLD STONE DEVELOPMENT IS CORRECTLY SHOWN ON THE CITY BOOKS AND PARCEL AT THE TIME OF PLAT APPROVAL, ON ANY OF THE LANDS INCLUDED THEREIN, AND ALL OUTSTANDING TAXES AND SPECIAL ASSESSMENTS HAVE BEEN PAID IN FULL. PROPERTY RECALCULATED TO THESE USES.



DEDICATION:
 SAID LAND HAS BEEN SUBMITTED AS SHOWN HEREON, ALL STREETS, EASEMENTS, AND ACCESS LIMITATIONS ARE REINDEED AND DEDICATED TO THE PUBLIC.
 IN WITNESS WHEREOF, LESTER E. COX, MEDICAL CENTERS, SOLE OWNERS OF THE PROPERTY UNDERSIGNED, HAS CAUSED THIS PLAT TO BE SIGNED THIS _____ DAY OF _____ 2020.

BY _____
 PRINT NAME AND TITLE _____
 DATE _____
 APPROVAL BY THE CITY COUNCIL _____
 CITY CLERK _____
 DATE _____

ACKNOWLEDGEMENT OF A CORPORATE OFFICIAL:
 I, _____ of _____ STATE OF MISSOURI, COUNTY OF _____, on the _____ day of _____ 20____ before me, a Notary Public, in and for said state, personally appeared _____, known to me to be the person whose name is set forth in the foregoing document, and acknowledged that they executed the same for the purposes and to the effect therein expressed.
 MY OFFICE IS: _____ COUNTY, MISSOURI.

NOTARY PUBLIC:
 I HAVE HERETOFORE SET MY HAND AND AFFIXED MY OFFICIAL SEAL IN WITNESS WHEREOF, I HAVE HERETOFORE SET MY HAND AND AFFIXED MY OFFICIAL SEAL IN _____ COUNTY, MISSOURI, THIS _____ DAY OF _____ 20____.

CONFORMANCE TO THE LAND USE REGULATIONS ADOPTED BY THE CITY OF REPUBLIC:
 I HEREBY CERTIFY ON THIS _____ DAY OF _____ 20____, THAT THE REPEAT OF LOT 1, OLD STONE DEVELOPMENT IS IN CONFORMANCE WITH THE CITY OF REPUBLIC LAND USE REGULATIONS IN ACCORDANCE WITH TITLE 9 OF THE REPUBLIC CODE OF ORDINANCES.
 CITY CLERK _____
 DATE _____

PROPERTY INFORMATION:
 CITY OF REPUBLIC, MISSOURI
 COMMUNITY DEVELOPMENT
 400 W. CHERRY STREET
 REPUBLIC, MISSOURI 64454
 PHONE: 417.688.2400
 FAX: 417.688.2401
 WWW.COC219.COM

LEGEND

●	REINFORCED CONCRETE	○	TELEPHONE FEDERAL
○	2" CONCRETE	○	IRREGULAR
○	EXISTING BRONZE FIN	○	WHITE VALE
○	EXISTING BRONZE FIN	○	GAS METER
○	PAINTED	○	ELECTRIC METER
○	METAL	○	POWER POLE
○	WATER LINE	○	3" PIPING
○	CASE LIFE	○	6" PIPING
○	GAS LIFE	○	ELECTRIC METER
○	SANITARY SEWER	○	2" PIPING
○	UNDERGROUND ELECTRICAL	○	4" PIPING
○	UNDERGROUND ELECTRICAL	○	6" PIPING
○	UNDERGROUND COMMUNICATION	○	8" PIPING
○	UNDERGROUND COMMUNICATION	○	12" PIPING
○	FIBER OPTIC CABLE	○	18" PIPING
○	CHAIN LINK FENCE	○	24" PIPING
○	WYLO PRANZY FENCE	○	30" PIPING
○	SHED/WAREHOUSE	○	36" PIPING
○	ELECTRIC WIRE EASEMENT	○	42" PIPING
○	ELECTRIC WIRE EASEMENT	○	48" PIPING
○	STORM SEWER MANHOLE	○	54" PIPING
○	WATER MANHOLE	○	60" PIPING

UTILITY RECORDS:
 MISSOURI LAND SURVEYING, INC. (MLS)
 1115 S. MAIN STREET
 WARRIEN, MISSOURI 64479
 PHONE: 417.688.2400
 FAX: 417.688.2401
 WWW.MLSURV.COM

UTILITY RECORDS:
 MISSOURI LAND SURVEYING, INC. (MLS)
 1115 S. MAIN STREET
 WARRIEN, MISSOURI 64479
 PHONE: 417.688.2400
 FAX: 417.688.2401
 WWW.MLSURV.COM

MISSOURI LAND SURVEYING, INC. (MLS)
 1115 S. MAIN STREET
 WARRIEN, MISSOURI 64479
 PHONE: 417.688.2400
 FAX: 417.688.2401
 WWW.MLSURV.COM

**PLAT OF SURVEY FOR
 LESTER E. COX MEDICAL CENTERS**
 W. OLD STONE AVENUE
 REPUBLIC, MISSOURI

CJWA
 CITY OF REPUBLIC, MISSOURI
 COMMUNITY DEVELOPMENT
 400 W. CHERRY STREET
 REPUBLIC, MISSOURI 64454
 PHONE: 417.688.2400
 FAX: 417.688.2401
 WWW.COC219.COM

DATE: 03/27/2020
 SHEET NO.: 1
 OF 1 SHEETS
 SCALE: 1" = 30' (PLAN)
 SCALE: 1" = 100' (ELEV.)
 DRAWN BY: [Signature]
 CHECKED BY: [Signature]
 APPR. BY: [Signature]