

PRELIMINARY PLAT OF TIGER CREEK SUBDIVISION

A SUBDIVISION IN THE CITY OF REPUBLIC, GREENE COUNTY, MISSOURI

OWNER / DEVELOPER
S6 TIGER CREEK, LLC
5051 S. NATIONAL AVE, BLD 5-100
SPRINGFIELD, MO 65810

WHITE
 LAND SURVEYING, LLC
 222 OLD TOWN RD.
 BILLINGS, MISSOURI
 PHONE: 417.732.0005
 email: info@whitelandsurvey.com
 www.whitelandsurvey.com

SURVEY DATE: 12.14.2021
 DWG DATE: 06.14.2022
 DRAWN BY: MW
 S/T/R: 14/28/23
 PROJECT No.: 2021-248

PRELIMINARY PLAT
 PREPARED FOR
S6 TIGER CREEK, LLC
 PROJECT LOCATION: FARM ROAD 178 & HIGHWAY "ZZ"
 REPUBLIC, GREENE COUNTY, MISSOURI

PREPARED BY:
 MICHAEL WHITE - MISSOURI
 PROFESSIONAL LAND
 SURVEYOR #2488

WHITE LAND SURVEYING, LLC -
 MISSOURI PROFESSIONAL
 LAND SURVEYOR
 CORPORATION #2003000370

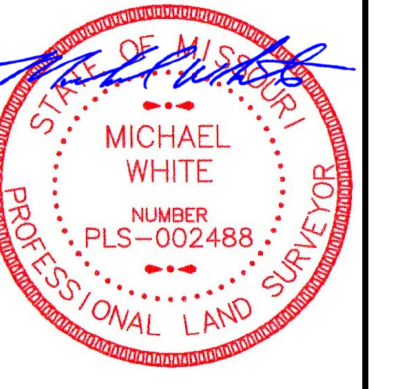

06/14/2022

EASEMENT DETAILS



LINE	BEARING	DISTANCE
L1	S46°39'44"W	42.04'
L2	S43°20'08"E	14.09'
L3	S46°39'52"W	14.20'
L4	S46°31'38"W	14.14'
L5	N43°28'22"W	14.14'
L6	S19°08'19"E	5.00'
L7	N13°36'13"E	12.27'
L8	N79°57'21"W	86.57'
L9	S86°36'55"E	24.35'
L10	N79°57'21"W	101.01'
L11	N01°31'38"E	21.36'
L12	S01°31'38"W	28.50'
L13	S46°31'38"W	14.14'
L14	N65°11'29"W	18.94'
L15	S76°18'14"W	13.38'
L16	N69°12'01"W	9.41'
L17	N88°28'22"W	10.00'
L18	N43°17'39"W	14.10'
L19	N46°42'21"E	14.19'
L20	N88°28'22"W	86.81'
L21	N88°28'22"W	70.00'
L22	S88°28'22"E	30.00'
L23	N75°34'44"W	41.03'
L24	N75°34'44"W	44.11'
L25	N88°28'22"W	27.00'
L26	N88°28'22"W	53.00'
L27	S85°06'31"W	6.30'
L28	S85°06'31"W	63.40'
L29	N88°28'22"W	7.00'
L30	N88°28'22"W	70.00'
L31	N88°28'22"W	70.00'
L32	N88°28'22"W	17.00'
L33	N71°58'36"W	83.43'
L34	S88°28'22"E	30.83'
L35	N76°18'14"E	13.38'
L36	S69°12'01"E	9.41'
L37	S46°42'21"W	14.19'
L38	N75°46'54"W	115.75'
L39	N75°46'54"W	82.00'
L40	N75°46'54"W	7.40'
L41	N84°33'16"W	72.95'
L42	N84°33'16"W	69.89'
L43	S82°47'06"W	10.60'
L44	S82°47'06"W	70.82'
L45	S82°47'06"W	71.28'
L46	N55°40'39"W	82.73'
L47	N55°40'39"W	83.27'
L48	N55°40'39"W	42.92'
L49	N85°31'13"W	68.48'
L50	N85°31'13"W	70.09'
L51	N85°31'13"W	26.35'
L52	S82°19'31"W	73.15'
L53	S82°19'31"W	47.22'
L54	S04°37'01"W	101.70'
L55	N82°19'31"E	77.20'
L56	N82°19'31"E	70.99'
L57	N82°19'31"E	26.49'
L58	S85°31'13"E	47.22'
L59	S85°31'13"E	80.01'
L60	N01°53'04"E	103.72'
L61	N88°11'45"W	14.59'
L62	S36°48'15"W	26.41'
L63	S01°53'04"W	80.65'
L64	S85°31'13"E	82.91'
L65	S55°40'39"E	70.84'
L66	S55°40'39"E	82.94'
L67	S55°40'39"E	29.72'
L68	N82°47'06"E	45.49'
L69	N82°47'06"E	70.89'
L70	N82°47'06"E	25.59'
L71	S84°33'16"E	44.82'
L72	S84°33'16"E	70.14'
L73	S84°33'16"E	35.19'
L74	S75°46'54"E	35.70'
L75	S75°46'54"E	71.65'
L76	S75°46'54"E	92.13'
L77	N01°53'04"E	40.95'
L78	N88°06'56"W	11.88'
L79	N42°53'45"W	14.20'
L80	S56°55'19"W	10.63'
L81	N88°15'13"W	18.34'
L82	N47°06'15"E	14.63'
L83	S43°09'21"E	14.15'
L84	S46°37'05"W	14.21'
L85	N43°20'16"W	14.08'
L86	S56°55'19"W	10.63'
L87	N46°50'39"E	14.13'
L88	S88°06'56"E	6.26'
L89	S62°39'26"E	9.01'
L90	S88°11'45"E	32.39'
L91	N62°08'26"W	17.29'
L92	S43°11'45"E	14.14'
L93	S46°48'15"W	14.14'
L94	N88°11'45"W	3.66'
L95	S74°37'45"W	24.06'
L96	S74°37'45"W	19.06'
L97	S88°11'45"E	10.00'
L98	S01°48'15"W	10.00'
L99	N43°22'45"W	14.10'
L100	N27°27'33"E	11.09'
L101	N27°27'33"E	12.00'
L102	N74°37'45"E	28.67'
L103	N74°37'45"E	15.06'
L104	S88°11'45"E	37.59'
L105	S43°11'45"E	14.14'
L106	S01°26'25"W	5.00'
L107	S46°37'20"W	42.56'
L108	N88°33'35"W	71.66'
L109	N09°15'39"W	106.92'
L110	S09°15'39"E	131.04'
L111	N43°35'35"W	41.81'
L112	N46°39'38"E	14.20'
L113	N46°48'15"E	14.14'
L114	S86°49'30"W	45.55'
L115	S86°49'30"W	70.94'
L116	S89°52'23"W	38.97'
L117	N43°22'40"W	42.29'
L118	S01°48'15"W	21.28'

CURVE NUMBER	RADIUS	ARC DISTANCE	CENTRAL ANGLE	CHORD BEARING	CHORD DISTANCE
C1	15.00'	13.62'	52°01'12"	N24°07'32"W	13.16'
C2	50.00'	5.37'	6°08'57"	N47°03'40"W	5.36'
C3	50.00'	67.55'	77°24'11"	N05°17'06"W	62.53'
C4	50.00'	62.60'	71°44'22"	N69°17'10"E	58.59'
C5	50.00'	33.50'	38°23'30"	N55°38'54"E	32.88'
C6	15.00'	13.62'	52°01'12"	S22°27'45"E	13.16'
C7	200.00'	32.61'	9°20'35"	S83°48'04"E	32.58'
C8	200.00'	71.44'	20°28'02"	S88°53'46"E	71.07'
C9	200.00'	71.76'	20°33'30"	S48°23'00"E	71.38'
C10	200.00'	66.20'	18°57'56"	S28°37'17"E	65.90'
C11	200.00'	20.63'	5°54'40"	S16°10'59"E	20.62'
C12	200.00'	51.50'	14°48'18"	S05°51'00"E	51.36'
C13	15.00'	13.62'	52°01'12"	S24°28'58"E	13.16'
C14	50.00'	43.35'	49°40'15"	S25°39'26"E	42.00'
C15	50.00'	22.37'	25°38'23"	S11°59'53"W	22.19'
C16	50.00'	39.68'	45°28'00"	S47°33'04"W	38.64'
C17	50.00'	63.93'	73°15'47"	N73°05'03"W	59.67'
C18	15.00'	13.62'	52°01'12"	N62°27'45"W	13.16'
C19	125.00'	50.79'	23°16'53"	N76°49'56"W	50.44'
C20	175.00'	4.80'	1°34'14"	N65°58'37"W	4.80'
C21	175.00'	71.58'	23°26'04"	N78°26'46"W	71.08'
C22	175.00'	41.23'	13°29'58"	S83°03'13"W	41.14'
C23	475.00'	16.92'	2°02'28"	S77°19'28"W	16.92'
C24	475.00'	70.92'	8°33'16"	S82°37'20"W	70.85'
C25	475.00'	70.07'	8°27'05"	N88°52'29"W	70.00'
C26	475.00'	70.77'	8°32'11"	N80°22'51"W	70.70'
C27	475.00'	57.31'	6°54'45"	N72°39'23"W	57.27'
C28	200.00'	6.34'	1°48'54"	N70°06'27"W	6.33'
C29	200.00'	60.94'	17°27'27"	N74°43'58"W	60.70'
C30	150.00'	14.66'	5°35'56"	S85°40'24"E	14.65'
C31	150.00'	35.80'	13°40'25"	S76°02'13"E	35.71'
C32	525.00'	37.95'	4°08'28"	S71°16'15"E	37.94'
C33	525.00'	81.49'	8°53'37"	S77°47'18"E	81.41'
C34	525.00'	80.12'	8°44'38"	S86°36'26"E	80.04'
C35	525.00'	70.49'	7°41'33"	N85°10'29"E	70.43'
C36	525.00'	46.04'	5°01'28"	N78°48'59"E	46.03'
C37	125.00'	12.49'	5°43'26"	N79°09'57"E	12.48'
C38	125.00'	71.48'	32°45'47"	S81°35'26"E	70.51'
C39	175.00'	31.61'	10°20'53"	S70°21'56"E	31.56'
C40	175.00'	70.92'	12°56'59"	S82°00'22"E	70.82'
C41	150.00'	84.59'	32°18'41"	S75°17'20"W	83.47'
C42	200.00'	63.07'	18°04'04"	S65°57'22"W	62.81'
C43	150.00'	5.79'	2°12'39"	S12°01'39"E	5.79'
C44	200.00'	58.97'	16°53'40"	S83°26'14"W	58.76'
C45	200.00'	5.78'	1°30'12"	N87°17'18"W	5.78'
C46	200.00'	71.94'	20°36'34"	N76°09'23"W	71.55'
C47	200.00'	12.90'	3°41'40"	N64°00'16"W	12.89'
C48	150.00'	39.47'	15°04'31"	N69°41'41"W	39.35'
C49	150.00'	27.29'	10°25'28"	N82°26'41"W	27.25'
C50	15.00'	13.62'	52°01'12"	S20°12'12"E	13.16'
C51	50.00'	47.14'	54°00'49"	S66°47'27"W	45.41'
C52	50.00'	19.64'	22°30'02"	N74°57'07"W	19.51'
C53	50.00'	43.48'	49°49'16"	N38°47'28"W	42.12'
C54	50.00'	59.08'	67°42'18"	N19°58'19"E	55.71'
C55	15.00'	9.83'	37°32'05"	N35°03'25"E	9.65'
C56	15.00'	3.79'	14°29'08"	S09°20'49"W	3.78'
C57	200.00'	113.03'	32°22'50"	N75°15'15"E	111.53'
C58	200.00'	7.48'	2°08'30"	N57°59'35"E	7.48'
C59	150.00'	91.53'	34°57'44"	S74°24'12"W	90.12'
C60	200.00'	11.19'	3°12'16"	S63°45'34"E	11.18'
C61	200.00'	41.87'	11°59'59"	S71°21'51"E	41.79'
C62	200.00'	37.84'	10°50'24"	S82°46'33"E	37.78'
C63	300.00'	72.86'	13°54'54"	S84°50'48"W	72.88'
C64	300.00'	17.07'	3°15'35"	S76°15'33"W	17.07'
C65	225.00'	66.07'	16°48'29"	N83°02'00"E	65.77'
C66	275.00'	33.55'	6°53'22"	N87°56'33"E	33.53'
C67	275.00'	42.13'	9°49'07"	N79°32'19"E	42.07'
C68	250.00'	30.08'	6°53'37"	N78°04'34"E	30.06'
C69	250.00'	44.86'	10°16'53"	N86°39'49"E	44.80'
C70	15.00'	11.16'	42°38'08"	N66°52'41"W	10.91'
C71	15.00'	2.45'	8°23'06"	S43°32'05"E	2.45'
C72	50.00'	64.81'	74°41'40"	S73°18'22"E	60.36'
C73	50.00'	61.65'	70°38'41"	N34°14'27"E	57.82'
C74	50.00'	42.88'	49°08'04"	N25°38'56"W	41.58'
C75	15.00'	13.62'	52°01'12"	N24°12'21"W	13.16'
C76	175.00'	211.77'	69°20'03"	S53°48'20"E	199.08'
C77	175.00'	63.12'	20°39'07"	S08°48'05"E	62.78'
C78	150.00'	60.95'	23°16'52"	N76°49'56"W	60.53'
C79	150.00'	100.80'	38°30'16"	N84°26'38"W	98.92'
C80	500.00'	301.03'	34°29'45"	N86°26'53"W	296.51'
C81	175.00'	58.86'	19°18'21"	N78°50'11"W	58.59'
C82	175.00'	103.44'	34°31'21"	N41°10'52"E	103.86'
C83	175.00'	106.79'	34°57'44"	N74°24'12"E	105.14'
C84	175.00'	79.29'	25°57'30"	N75°08'11"W	78.61'
C85	175.00'	79.53'	26°02'19"	S75°10'36"E	78.85'
C86	275.00'	82.43'	17°10'30"	S83°31'00"W	82.13'
C87	250.00'	73.34'	16°48'29"	S83°02'00"W	73.08'
C88	150.00'	67.96'	25°57'30"	S75°31'30"E	67.38'
C89	150.00'	49.08'	18°44'52"	S79°05'55"E	48.86'
C90	150.00'	132.43'	50°35'10"	S44°25'54"E	128.17'
C91	150.00'	54.10'	20°39'57"	S08°48'20"E	53.81'