

NOTE: All proposed parks, trails, etc within EHS to stabilize creek bank

Total Site Area: 2,176,682 sqft
 Required 10% Open Space: 217,668 sqft
 Provided Open Space: 458,000 sqft

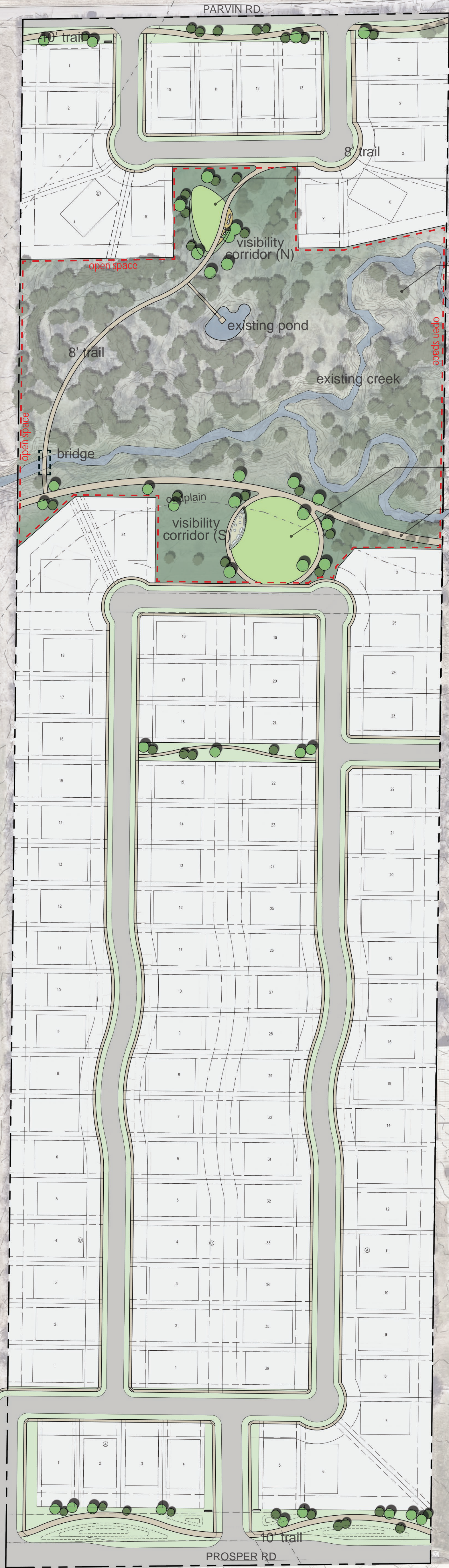

Pocket park with seating area and lawn

Existing trees, subject to change pending on final design and grading

Larger park with shade structure, seating area and lawn

town of Prosper regional trail (12' width)