



Mr. Warren Corwin, P.E.
Corwin Engineering, Inc.
200 West Belmont Drive
Allen, Texas 75013

RE: Wandering Creek Residential Development - Approximately 74 acres located along the south side of East 1st Street, east of Walnut Grove High School in the Town of Prosper, Collin County, Texas

Trees 144 and 145

Dear Mr. Corwin,

IES conducted a tree survey on 06 December 2022 that identified trees 144 and 145 as pecan (*Carya illinoensis*) and measured 48.6- and 32.6-inches diameter breast height (DBH), respectively. During this initial tree survey, these trees were identified as healthy with no major defects. Due to the position of stature and location of these trees between the proposed street and residential lot, the landscape architect and civil engineer attempted to design to save the trees.

IES inspected these trees on 26 July 2024 to evaluate the current condition of these trees. IES identified the following (see attached photographs):

1. The street south of the trees had been graded and the grade immediately adjacent to the trees has been cut approximately 4 feet;
2. Numerous small and large roots have been severed;
3. A temporary access road has been used in the critical root zone on the north side of these trees; and
4. The canopy of these trees has lost approximately 50 percent of their foliage.

In IES' professional opinion, the ongoing construction activities around these trees has significantly impacted the trees' health. Approximately 50 percent of the roots have been removed, both the structural anchoring roots and the smaller absorptive roots. Additionally, soil covering the remaining roots has been compacted from construction vehicles which is limiting the tree's oxygen exchange. These direct impacts are readily visible in the stress exhibited in the canopy of the tree. It is difficult to indicate how long these trees will live, but all indications point to mortality soon.

IES does not have any recommended mitigation measures that could be employed to have a meaningful chance for improving the survival of these trees. The damage has been too significant, and the trees are already in significant decline.

Regardless of when these trees will die, it is IES' opinion that these trees are at risk of falling due to the significant amount of root removal. With prevailing winds from the south and these trees large canopy, there is a higher probability of whole tree failure during high winds.

IES appreciates the opportunity to work with you and Toll Brothers on this project, and we hope we may be of assistance to you in the future. If you have any comments, questions, or concerns, please do not hesitate to contact me at 972-562-7672 (rreinecke@intenvsol.com).

Sincerely,

Integrated Environmental Solutions, LLC.

A handwritten signature in dark ink, appearing to read 'Rudi Reinecke', with a long horizontal flourish extending to the right.

Mr. Rudi Reinecke
Vice President

ISA Certified Arborist #TX-3922A

Attachments

File ref: 04.248.033

Tree Number	Diameter at Breast Height (Inches)	Common Name	Scientific Name
144	48.6	Pecan	<i>Carya illinoensis</i>

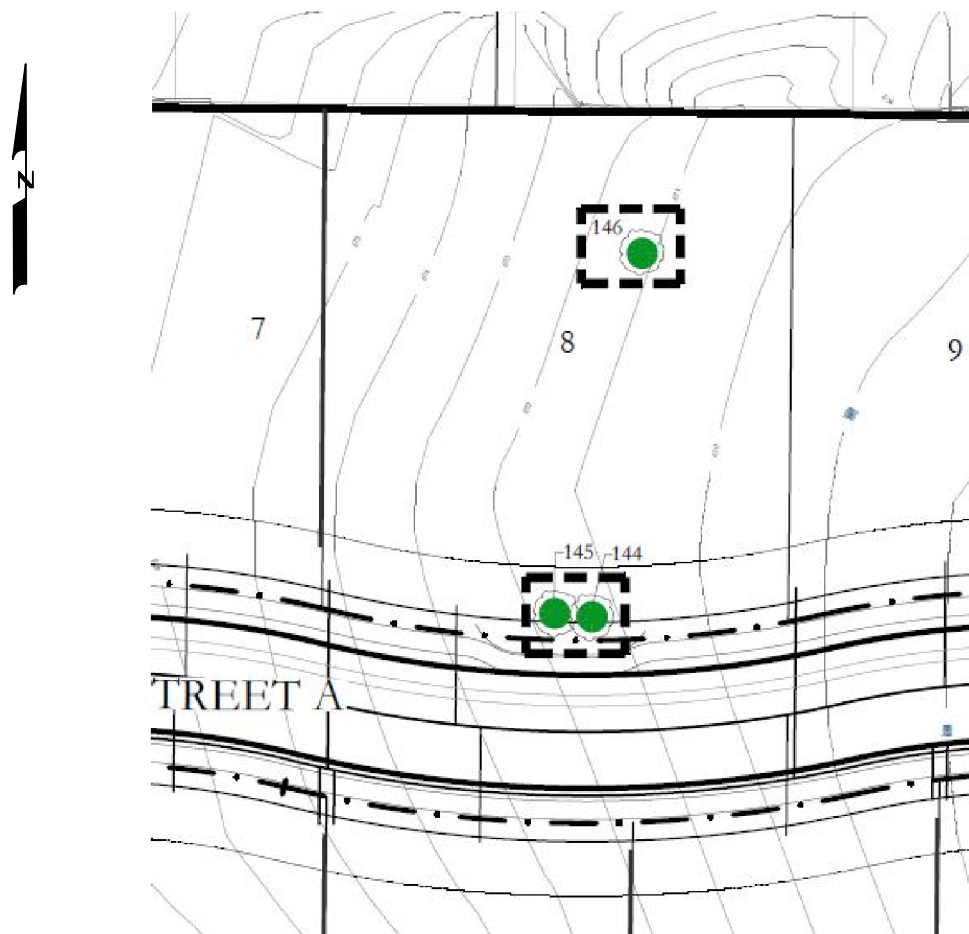

CORWIN ENGINEERING, INC.

200 W. Belmont, Suite E Allen, Texas 75013 (972) 396-1200
TBEPLS • F-5951

EXHIBIT 'A' - TREE SURVEY

WANDERING CREEK PHASE I
S. JEREMIAH HORN SUR., ABST. NO. 411
TOWN OF PROSPER
COLLIN COUNTY, TEXAS



Facing east looking at Trees 144 and 145. Canopy significantly defoliated compared to adjacent pecans



Tree 144 – significant root damage from road grade cut. Tree 146 (another pecan tree) in background demonstrates dense foliage in canopy by comparison.



Tree 145 – significant root damage from road grade cut.



Facing west, Tree 144 in foreground and 145 in background.



Facing west looking at temporary access road on north side of trees. Not stockpile of material as well.



Facing east looking at temporary access road on north side of trees.



Facing west with tree 144 in center. Tree 146 (another pecan tree) on right side of photograph demonstrates dense foliage in canopy by comparison.