

LANDSCAPE CALCULATIONS

OVERALL SITE:
 ZONING: PD-116
 LAND USE: RETAIL / RESTAURANT
 REQUIRED LANDSCAPE AREA: 26,261 SF (10%)
 PROVIDED LANDSCAPE AREA: 113,740 SF (43%)
 REQUIRED OPEN SPACE AREA: 18,339 SF (7%)
 PROVIDED OPEN SPACE AREA: 79,181 SF (27%)
 *REFER TO OPEN SPACE PLAN

LANDSCAPE AREA REQUIREMENTS: OVERALL SITE

PERIMETER REQUIREMENTS:
 N PRESTON RD (SH 289): 642 LF
 MAJOR THOROUGHFARE: PROVIDED
 30' WIDE LANDSCAPE AREA REQUIRED: 22 TREES
 TREES PROVIDED: 22 TREES
 SHRUBS REQUIRED (15 SHRUBS / 30 LF): 321 SHRUBS
 SHRUBS PROVIDED: 321 SHRUBS
 LANDSCAPE BERMS REQUIRED*: 141.1 SLOPE, MAX. 3:1 SLOPE

INTERIOR PARKING REQUIREMENTS:
 PROPOSED PARKING SPACES: 264 SPACES
 3,960 SF
 REQUIRED INTERIOR LANDSCAPE AREA (15 SF / SPACE): 11,233 SF
 INTERIOR LANDSCAPE AREA PROVIDED: 11,233 SF
 1 TREE WITHIN 150' EACH SPACE:
 1 TREE AT THE TERMINUS OF EACH PARKING BAY:

BUILDING LANDSCAPING:
 N/A (< 100,000 SF)

MEDIAN PLANTING REQUIREMENTS:
 N/A (PREVIOUSLY PLANTED)

TREE MITIGATION REQUIREMENTS:
 MITIGATION REQUIRED (INCHES): 0"
 MITIGATION PROVIDED (INCHES): 194"
 MITIGATION TO BE PAID VIA FEE:

NOTE:
 FEE TO BE SET BY DIRECTOR.
 REFER TO TD-1 FOR TREE INVENTORY TABLE AND CALCULATIONS.
 REFER TO LP-3 FOR PLANT & ENLARGEMENTS FOR MITIGATION TREE LOCATIONS.
 REFER TO LP-3 FOR PLANT OVERALL PLANT SCHEDULE.

LOT 1:
 ZONING: PD-116
 LAND USE: RETAIL / RESTAURANT
 PROVIDED LANDSCAPE AREA: 6,957 SF (10%)
 REQUIRED OPEN SPACE AREA: 4,755 SF (7%)
 PROVIDED OPEN SPACE AREA: 5,015 SF (7.2%)
 *REFER TO OPEN SPACE PLAN

LOT 2:
 ZONING: PD-116
 LAND USE: RETAIL / RESTAURANT
 PROVIDED LANDSCAPE AREA: 19,304 SF (10%)
 REQUIRED LANDSCAPE AREA: 98,515 SF (35%)
 *INCLUDES FLOODPLAIN
 PROVIDED OPEN SPACE AREA: 13,545 SF (7%)
 REQUIRED OPEN SPACE AREA: 65,177 SF (34%)
 *REFER TO OPEN SPACE PLAN

LANDSCAPE AREA REQUIREMENTS: LOT 1

ADJACENT NON-RESIDENTIAL REQUIREMENTS:
 NORTH NORTHWEST PROPERTY LINE: 488 LF
 PROVIDED: 33 ORNAMENTAL TREES
 5' WIDE LANDSCAPE AREA REQUIRED (1 TREE / 15 LF): 33 ORNAMENTAL TREES
 ORNAMENTAL TREES PROVIDED: 33 SHRUBS
 SHRUBS REQUIRED (1 SHRUB / 15 LF): 33 SHRUBS
 SHRUBS PROVIDED:

SOUTH SOUTHWEST PROPERTY LINE:
 562 LF
 PROVIDED: 38 ORNAMENTAL TREES
 5' WIDE LANDSCAPE AREA REQUIRED: 38 ORNAMENTAL TREES
 ORNAMENTAL TREES PROVIDED: 38 SHRUBS
 SHRUBS REQUIRED (1 SHRUB / 15 LF): 38 SHRUBS
 SHRUBS PROVIDED:

INTERIOR PARKING REQUIREMENTS:
 PROPOSED PARKING SPACES: 92 SPACES
 1,380 SF
 REQUIRED INTERIOR LANDSCAPE AREA (15 SF / SPACE): 3,629 SF
 INTERIOR LANDSCAPE AREA PROVIDED: 3,629 SF
 1 TREE WITHIN 150' EACH SPACE:
 1 TREE AT THE TERMINUS OF EACH PARKING BAY:

LANDSCAPE AREA REQUIREMENTS: LOT 2

ADJACENT NON-RESIDENTIAL REQUIREMENTS:
 NORTH NORTHWEST PROPERTY LINE: 562 LF
 PROVIDED: 38 ORNAMENTAL TREES
 5' WIDE LANDSCAPE AREA REQUIRED: 38 ORNAMENTAL TREES
 ORNAMENTAL TREES PROVIDED: 38 SHRUBS
 SHRUBS REQUIRED (1 SHRUB / 15 LF): 38 SHRUBS
 SHRUBS PROVIDED:

ADJACENT RESIDENTIAL REQUIREMENTS:
 SOUTH PROPERTY LINE: 894 LF
 PROVIDED: 30 TREES
 30 TREES

INTERIOR PARKING REQUIREMENTS:
 PROPOSED PARKING SPACES: 172 SPACES
 2,580 SF
 REQUIRED INTERIOR LANDSCAPE AREA (15 SF / SPACE): 7,604 SF
 INTERIOR LANDSCAPE AREA PROVIDED: 7,604 SF
 1 TREE WITHIN 150' EACH SPACE:
 1 TREE AT THE TERMINUS OF EACH PARKING BAY:

ALTERNATIVE LOCATION COMPLIANCE NOTE:
 DEFICIENCY OF ORNAMENTAL TREES TO BE REPLACED AT A 3:1 RATIO.
 1 LARGE TREE = 3 ORNAMENTAL TREES.
 SHOWN AROUND SITE WHERE ABLE AND IN FLOODPLAIN OF LOT 2 ALONG FRONTAGE.

TOWN OF PROSPER GENERAL LANDSCAPE NOTES

- TOWN OF PROSPER LANDSCAPE GENERAL NOTES. STANDARD LANGUAGE AND/OR NOTATIONS, AS FOLLOWS (PER LANDSCAPE PLANS CHECKLIST):
- PLANT MATERIAL SHALL BE MEASURED AND SIZED ACCORDING TO THE LATEST EDITION OF THE AMERICAN STANDARD FOR NURSERY STOCK (ANSI Z60.1).
- ALL PLANT SUBSTITUTIONS ARE SUBJECT TO TOWN APPROVAL AND MUST BE SPECIFIED ON THE APPROVED LANDSCAPE PLAN.
- GROUND COVERS USED IN LIEU OF TURF GRASS MUST PROVIDE COMPLETE COVERAGE WITHIN ONE (1) YEAR OF PLANTING AND MAINTAIN ADEQUATE COVERAGE AS APPROVED BY THE TOWN.
- TREES MUST BE PLANTED FOUR (4) FEET OR GREATER FROM CURBS, SIDEWALKS, UTILITY LINES, SCREENING WALLS, AND ALL STRUCTURES. SINGLE TRUNK TREES SHALL HAVE A SINGLE, STRAIGHT LEADER, AND ALL TREES SHALL BE FULL WITH BALANCED CANOPY. MAJOR DAMAGE TO TRUNKS, OR BRANCHES, WILL BE CAUSE FOR DENIAL.
- ALL ROOT FLARES SHALL BE SET AT THREE (3) TO FOUR (4) INCHES ABOVE SURROUNDING GRADE.
- THE TREE PIT SHALL BE BACKFILLED WITH NATIVE TOPSOIL, FREE OF ROCK AND OTHER DEBRIS.
- BURLAP, TWINE, AND WIRE BASKETS SHALL BE SEVERED AND REMOVED FROM THE TOP OF THE ROOT BALL.
- A 3" LAYER OF MULCH SHALL BE PROVIDED AROUND THE BASE OF THE PLANTED TREE. THE MULCH SHALL BE PULLED BACK 1/2" FROM THE TRUNK OF THE TREE.
- NO PERSON(S) OR ENTITY MAY USE IMPROPER OR MALICIOUS MAINTENANCE OR PRUNING TECHNIQUES INCLUDING, BUT NOT LIMITED TO: TOPPING OR OTHER NON SYMMETRICAL TRIMMING OF TREES, DAMAGE FROM A BACKHOE, OR USE OF FIRE OR POISON FOLLOW THE AMERICAN STANDARD FOR NURSERY STOCK (ANSI Z60.1) GUIDELINES ON PRUNING AND MAINTENANCE.
- TOPSOIL SHALL BE A MINIMUM OF EIGHT (8) INCHES IN DEPTH IN PLANTING AREAS. SOIL SHALL BE FREE OF STONES, ROOTS, AND CLODS AND ANY OTHER FOREIGN MATERIAL THAT IS NOT BENEFICIAL FOR PLANT GROWTH.
- ALL PLANT BEDS SHALL BE TOP-DRESSED WITH A MINIMUM OF THREE (3) INCHES OF MULCH.
- TREES OVERHANGING WALKS AND PARKING SHALL HAVE A MINIMUM CLEAR BRANCH HEIGHT OF SEVEN (7) FEET. TREES OVERHANGING PUBLIC STREET PAVEMENT DRIVE AISLES AND FIRE LINES SHALL HAVE A MINIMUM CLEAR BRANCH HEIGHT OF FOURTEEN (14) FEET.
- A VISIBILITY TRIANGLE MUST BE PROVIDED AT ALL INTERSECTIONS, WHERE SHRUBS ARE NOT TO EXCEED THIRTY (30) INCHES IN HEIGHT, AND TREES SHALL HAVE A MINIMUM CLEAR TRUNK HEIGHT OF NINE (9) FEET.
- TREES PLANTED ON A SLOPE SHALL HAVE THE TREE WELL AT THE AVERAGE GRADE OF THE UPHILL SLOPE.
- ALL AREAS OF LESS THAN THREE (3) FEET IN WIDTH SHALL BE GRASS, GROUND COVER, OR SOME TYPE OF DECORATIVE RIVER ROCK, PAVERS, OR CONCRETE.
- THE OWNER, TENANT, AND/OR THEIR AGENTS, IF ANY, SHALL BE JOINTLY AND SEVERALLY RESPONSIBLE FOR THE MAINTENANCE, ESTABLISHMENT, AND PERMANENCE OF PLANT MATERIAL. ALL LANDSCAPING SHALL BE MAINTAINED IN A NEAT AND ORDERLY MANNER AT ALL TIMES INCLUDING, BUT NOT LIMITED TO, MOULDING, EDGING, PRUNING, FERTILIZING, WATERING, DEWEEDING, AND TRASH REMOVAL.
- PLANT MATERIAL THAT IS DAMAGED, DESTROYED, OR REMOVED SHALL BE REPLACED WITH PLANTS MEETING MINIMUM SPECIFICATIONS PER LANDSCAPE PLAN. ALL TURF/GROUND COVER AREAS ARE TO BE ESTABLISHED PRIOR TO RECEIPT OF CERTIFICATE OF OCCUPANCY, UNLESS OTHERWISE APPROVED BY THE TOWN.
- AN AUTOMATIC IRRIGATION SYSTEM SHALL BE PROVIDED TO IRRIGATE ALL LANDSCAPE AREAS INTO STREETS, SIDEWALKS, OR ALLEYS.
- NO PLANTING AREAS SHALL EXCEED 3:1 SLOPE (3 FT HORIZONTAL TO 1 FT VERTICAL).
- EARTHEN BERMS SHALL NOT INCLUDE CONSTRUCTION DEBRIS.
- ALL WALKWAYS SHALL MEET ADA AND T&S REQUIREMENTS.
- LANDSCAPE INSTALLATION MUST COMPLY WITH APPROVED LANDSCAPE PLANS, AND AS-BUILT PLANS SUBMITTED TO PARKS AND RECREATION, PRIOR TO FINAL ACCEPTANCE BY THE TOWN AND/OR OBTAINING A CERTIFICATE OF OCCUPANCY.
- FINAL INSPECTION AND APPROVAL OF SCREENING WALLS, IRRIGATION, AND LANDSCAPE IS SUBJECT TO ALL PUBLIC UTILITIES, INCLUDING BUT NOT LIMITED TO MANHOLES, VALVES, WATER METERS, CLEANOUTS, AND OTHER APPURTENANCES BEING ACCESSIBLE, ADJUSTED TO GRADE, AND TO THE TOWN OF PROSPER PUBLIC WORKS DEPARTMENT STANDARDS.
- IMPORTANT: MINIMUM STANDARDS FOR PLANTS, AS SET FORTH IN THE ZONING ORDINANCE AND APPROVED LANDSCAPE PLANS ARE TAKEN SERIOUSLY BY THE TOWN AND PARKS AND RECREATION. INSTALLING INFERIOR PLANTS WITHOUT WRITTEN APPROVAL FROM A PARKS REPRESENTATIVE MAY RESULT IN REJECTION OF SOME OR ALL PLANTS, THEREBY DELAYING RECEIPT OF A CERTIFICATE OF OCCUPANCY. ARCHITECTS AND LANDSCAPE CONTRACTORS ARE STRONGLY ENCOURAGED TO NOTIFY THE PARKS DEPARTMENT TO DISCUSS POSSIBLE DEFICIENCIES PRIOR TO INSTALLATION.
- CALL PARKS AND RECREATION AT (972) 569-1160 AT LEAST FORTY-EIGHT (48) HOURS PRIOR TO THE FOLLOWING INSPECTIONS:
 - BERM CONSTRUCTION & GRADING
 - ESCROW RELEASE
 - FINAL INSPECTION

TOWN OF PROSPER MAINTENANCE STANDARDS

- THE OWNER, TENANT AND/OR THEIR AGENT, IF ANY, SHALL BE JOINTLY AND SEVERALLY RESPONSIBLE FOR THE MAINTENANCE OF ALL LANDSCAPING REQUIRED BY THIS ORDINANCE. ALL PLANT MATERIAL SHALL BE PERPETUALLY MAINTAINED IN A HEALTHY AND GROWING CONDITION AS IS APPROPRIATE FOR THE SEASON OF THE YEAR. PLANT MATERIALS THAT DIE SHALL BE REPLACED BY PROPERTY OWNER, TENANT OR AGENT WITH PLANT MATERIAL OF SIMILAR VARIETY AND SIZE, WITHIN THIRTY (30) DAYS OF NOTIFICATION BY THE TOWN OR A DATE APPROVED BY THE TOWN.
- ALL TREES LOCATED ON TOWN PROPERTY SHALL BE CARED FOR BY THE TOWN UNLESS THAT RESPONSIBILITY IS TRANSFERRED TO ANOTHER ENTITY THROUGH A COUNCIL-APPROVED AGREEMENT. THE DIRECTOR OF THE PARKS AND RECREATION DEPARTMENT SHALL ENSURE THAT THE TOWN, OR ITS CONTRACTOR, MONITORS AND CARES FOR TREES IN A WAY THAT PROMOTES A HEALTHY AND GROWING URBAN FOREST. IS PERFORMED ACCORDING TO ANSI A300, "STANDARDS FOR TREE CARE OPERATIONS," AND TREE CARE BEST MANAGEMENT PRACTICES PUBLISHED BY THE INTERNATIONAL SOCIETY OF ARBORICULTURE. IT SHALL BE UNLAWFUL TO REMOVE, PRUNE, DAMAGE OR OTHERWISE HARM TREES ON TOWN PROPERTY WITHOUT PERMISSION FROM THE DIRECTOR OF THE PARKS AND RECREATION DEPARTMENT. THE PARKS AND RECREATION DEPARTMENT SHALL BE RESPONSIBLE FOR DEVELOPING AND UPDATING AN ANNUAL WORK PLAN. THIS WORK PLAN SHALL DOCUMENT WHAT MAINTENANCE ACTIVITIES ARE BEING PERFORMED AND SCHEDULED EACH YEAR. THE PARKS AND RECREATION BOARD MAY APPOINT AN ADVISORY COMMITTEE TO FOCUS ON ISSUES AND INITIATIVES THAT PERTAIN TO ANY URBAN FOREST THAT IS LOCATED ON PUBLIC LANDS.

LEGEND

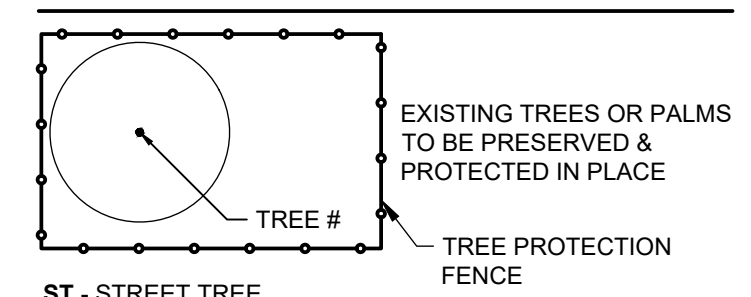

ST - STREET TREE
MT - MITIGATION TREE
RT - SOUTH PERIMETER TREE (RESIDENTIAL)
NT - NORTH PERIMETER TREE (NON-RESIDENTIAL)
 REFER TO LP-0 FOR PLANT SCHEDULE, LANDSCAPE CALCULATIONS, AND NOTES

THE DEVELOPER SHALL ERECT AN ORANGE PLASTIC MESH FENCE, OR OTHER APPROVED FENCING MATERIAL, A MINIMUM OF FOUR FEET IN HEIGHT AROUND EACH TREE OR GROUP OF TREES TO PREVENT THE PLACEMENT OF DEBRIS, EQUIPMENT, OR FILL WITHIN THE DRIPING OR CRITICAL ROOT ZONE. THE FENCE SHALL BE INSTALLED PRIOR TO THE RELEASE OF ANY PERMIT. IF THE PROTECTION FENCE IS FOUND REMOVED, DAMAGED, OR ALTERED AT ANY TIME DURING CONSTRUCTION PRIOR TO FINAL INSPECTION OR LANDSCAPE INSTALLATION, A STOP WORK ORDER MAY BE ISSUED BY THE BUILDING OFFICIAL.

ROOT BARRIERS

THE CONTRACTOR SHALL INSTALL ROOT BARRIERS NEAR ALL NEWLY-PLANTED TREES THAT ARE LOCATED WITHIN FIVE (5) FEET OF PAVING, CURBS, WATER, STORM, OR SANITARY SEWER UTILITIES. ROOT BARRIERS SHALL BE "CENTURY" OR "DEEP-ROOT" 24" DEEP PANELS (OR EQUAL). BARRIERS SHALL BE LOCATED IMMEDIATELY ADJACENT TO HARDCAPE. INSTALL PANELS PER MANUFACTURER'S RECOMMENDATIONS. UNDER NO CIRCUMSTANCES SHALL THE CONTRACTOR USE ROOT BARRIERS OF A TYPE THAT COMPLETELY ENCLOSE THE ROOTBALL.

MULCHES

AFTER ALL PLANTING IS COMPLETE, CONTRACTOR SHALL INSTALL A 3" LAYER OF 1-1/2" SHREDDED WOOD MULCH OVER LANDSCAPE FABRIC OR 3" THICK LAYER OF DECOMPOSED GRANITE OVER LANDSCAPE FABRIC IN ALL PLANTING AREAS (EXCEPT FOR TURF AND SEEDED AREAS). SEE PLAN FOR MULCH OR AGGREGATE LOCATIONS. CONTRACTOR SHALL SUBMIT SAMPLES OF ALL MULCHES TO LANDSCAPE ARCHITECT AND OWNER FOR APPROVAL PRIOR TO CONSTRUCTION. ABSOLUTELY NO EXPOSED GROUND SHALL BE LEFT SHOWING ANYWHERE ON THE PROJECT AFTER MULCH HAS BEEN INSTALLED (SUBJECT TO THE CONDITIONS AND REQUIREMENTS OF THE "GENERAL GRADING AND PLANTING NOTES" AND SPECIFICATIONS).

PLANTING & IRRIGATION GUARANTEE

THE LANDSCAPE CONTRACTOR SHALL GUARANTEE THAT ALL NEWLY INSTALLED AND EXISTING PLANTS SHALL SURVIVE FOR ONE YEAR AFTER FINAL OWNER ACCEPTANCE OF THE INSTALLATION WORK. THE CONTRACTOR SHALL ALSO BE RESPONSIBLE FOR APPROPRIATE WATERING OF THE LANDSCAPE THROUGH INSTALLATION OF A PROPERLY DESIGNED IRRIGATION SYSTEM. THE OWNER SHALL APPROVE THE SYSTEM DESIGN BEFORE INSTALLATION OF PLANTS OR IRRIGATION.

IRRIGATION CONCEPT

- AN AUTOMATIC IRRIGATION SYSTEM SHALL BE INSTALLED AND OPERATIONAL BY THE TIME OF FINAL INSPECTION. THE ENTIRE IRRIGATION SYSTEM SHALL BE INSTALLED BY A LICENSED AND QUALIFIED IRRIGATION CONTRACTOR.
- THE IRRIGATION SYSTEM WILL OPERATE ON POTABLE WATER, AND THE SYSTEM WILL HAVE APPROPRIATE BACKFLOW PREVENTION DEVICES INSTALLED TO PREVENT CONTAMINATION OF THE POTABLE SOURCE.
- ALL NON-TURF PLANTED AREAS SHALL BE DRIP IRRIGATED. SODDED AND SEEDED AREAS SHALL BE IRRIGATED WITH SPRAY OR ROTOR HEADS AT 100% HEAD-TO-HEAD COVERAGE.
- ALL PLANTS SHARING SIMILAR HYDROZONE CHARACTERISTICS SHALL BE PLACED ON A VALVE DEDICATED TO PROVIDE THE NECESSARY WATER REQUIREMENTS SPECIFIC TO THAT HYDROZONE.
- THE IRRIGATION SYSTEM SHALL BE DESIGNED AND INSTALLED, TO THE MAXIMUM EXTENT POSSIBLE, TO CONSERVE WATER BY USING THE FOLLOWING DEVICES AND SYSTEMS: MATCHED PRECIPITATION RATE TECHNOLOGY ON ROTOR AND SPRAY HEADS (WHenever POSSIBLE), RAIN SENSORS, AND MULTI-PROGRAM COMPUTERIZED IRRIGATION CONTROLLERS FEATURING SENSORY INPUT CAPABILITIES.

NOTE TO LANDSCAPE CONTRACTOR:

- NEW INSPECTIONS WILL BE MADE FOR THE FOLLOWING:
- TREE HEIGHT, WIDTH & CALIPER AT DELIVERY;
 - SHRUB HEIGHT, WIDTH & CONTAINER SIZE (AT DELIVERY) (ANY UNDERSIZED PLANT NOT FULLY ROOTED MAY BE DENIED BY PARKS AT INSPECTION);
 - INSPECTION OF TREE PIT SIDE WALLS & DEPTH;
 - INSPECT AT LEAST ONE (1) PERCOLATION TESTED PIT.

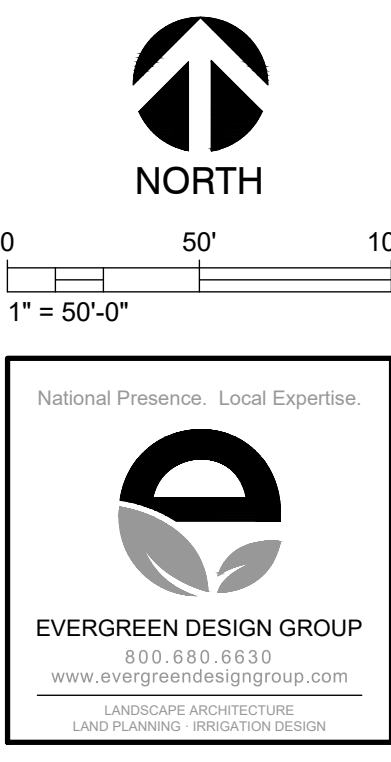

EVERGREEN DESIGN GROUP
 800.680.6630
 www.evergreendesigngroup.com
 LANDSCAPE ARCHITECTURE
 LAND PLANNING, IRRIGATION DESIGN

SITE PLAN
VICTORY AT FRONTIER SOUTH
BLOCK A, LOTS 1 AND 2
DEVAPP-25-0107

OWNER:
 VICTORY AT FRONTIER SOUTH, LP
 2911 TURTLE CREEK BLVD., SUITE 700
 DALLAS, TX 75219
 PH: 469.707.9555
 CONTACT NAME: TONY RAMJI

APPLICANT:
 CLAYMOORE ENGINEERING, INC.
 3231 HARWOOD ROAD
 BEDFORD, TX 76021
 PH: 817.281.0572
 CONTACT NAME: DREW DONOSKY

SURVEYOR:
 EAGLE SURVEYING, LLC
 210 SOUTH ELM STREET, SUITE #104
 DENTON, TX 76201
 PH: 940.222.3009
 CONTACT NAME: MATTHEW RAABE

LEGAL DESCRIPTION:
 TRACT SITUATED IN THE SPENCER RICE SURVEY, ABSTRACT NO. 787, TOWN OF PROSPER, COLLIN COUNTY, TEXAS
 ZONING: PLANNED DEVELOPMENT - PD-116 (O)

CITY: PROSPER
STATE: TEXAS

COUNTY: COLLIN
SURVEY: SPENCER RICE
ABSTRACT NO.: 787

DESIGN: JC
DRAWN: SS
CHECKED: JC
DATE: 03/16/2026

SHEET
LP-0
 File No. 2025-071

TEXAS REGISTRATION #14199

CLAYMOORE ENGINEERING
 3231 HARWOOD ROAD
 BEDFORD, TX 76021
 PHONE: 817.281.0572
 WWW.CLAYMOOREENG.COM

REGISTERED LANDSCAPE ARCHITECT
 STATE OF TEXAS
 3470

03/16/2026

FRONTIER SOUTH
N. PRESTON ROAD,
TOWN OF PROSPER, TX

OVERALL LANDSCAPE PLAN

NO.	DATE	REVISION	BY

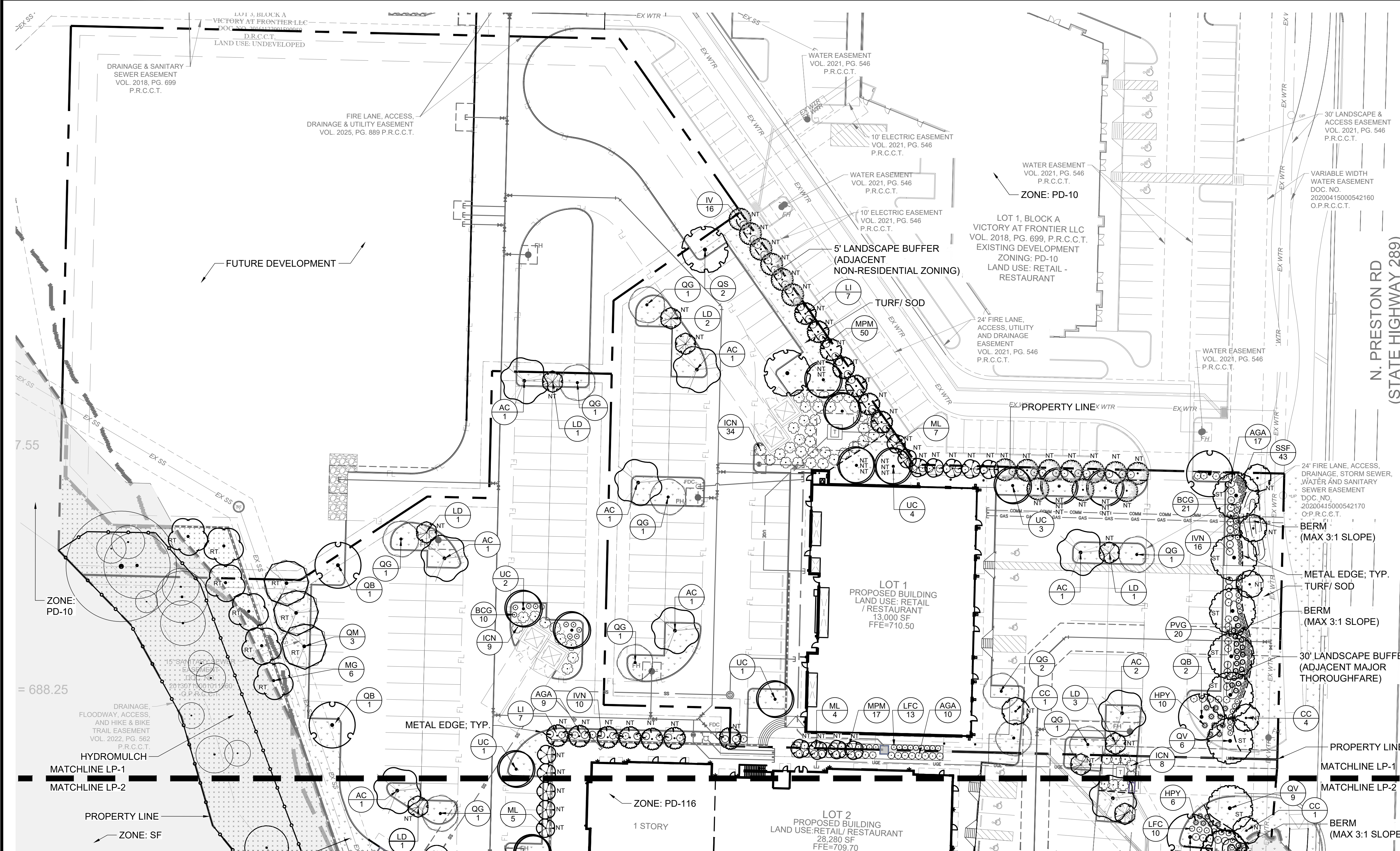

LEGEND

EXISTING TREES OR PALMS TO BE PRESERVED & PROTECTED IN PLACE

TREE #

TREE PROTECTION FENCE

ST - STREET TREE
 MT - MITIGATION TREE
 RT - SOUTH PERIMETER TREE (RESIDENTIAL)
 NT - NORTH PERIMETER TREE (NON-RESIDENTIAL)
 REFER TO LP-0 FOR PLANT SCHEDULE, LANDSCAPE CALCULATIONS, AND NOTES

THE DEVELOPER SHALL ERECT AN ORANGE PLASTIC MESH FENCE, OR OTHER APPROVED FENCING MATERIAL, A MINIMUM OF FOUR FEET IN HEIGHT AROUND EACH TREE OR GROUP OF TREES TO PREVENT THE PLACEMENT OF DEBRIS, EQUIPMENT, OR FILL WITHIN THE DRIPLINE OR CRITICAL ROOT ZONE. THE FENCE SHALL BE INSTALLED PRIOR TO THE RELEASE OF ANY PERMIT. IF THE PROTECTION FENCE IS FOUND REMOVED, DAMAGED, OR ALTERED AT ANY TIME DURING CONSTRUCTION PRIOR TO FINAL INSPECTION OR LANDSCAPE INSTALLATION, A STOP WORK ORDER MAY BE ISSUED BY THE BUILDING OFFICIAL.

TEXAS REGISTRATION #14199

CLAYMOORE ENGINEERING

3231 HARWOOD ROAD
 BEDFORD, TX 76021
 PHONE: 817.281.0272
 WWW.CLAYMOOREENGINEERING.COM

REGISTERED LANDSCAPE ARCHITECT

STEPHEN W. SALES

STATE OF TEXAS

3470

03/16/2026

FRONTIER SOUTH
 N. PRESTON ROAD,
 TOWN OF PROSPER, TX

NO.	DATE	REVISION	BY

EVERGREEN DESIGN GROUP

800.680.6630
 www.evergreendesigngroup.com

LANDSCAPE ARCHITECTURE
 LAND PLANNING · IRRIGATION DESIGN

National Presence. Local Expertise.

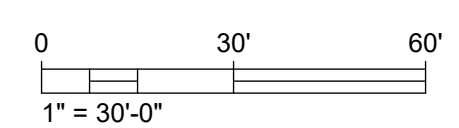

SITE PLAN VICTORY AT FRONTIER SOUTH BLOCK A, LOTS 1 AND 2 DEVAPP-25-0107		
OWNER: VICTORY AT FRONTIER SOUTH, LP 2911 TURTLE CREEK BLVD., SUITE 700 DALLAS, TX 75219 PH: 469.707.9555 CONTACT NAME: TONY RAMJI		
APPLICANT: CLAYMOORE ENGINEERING, INC. 3231 HARWOOD ROAD BEDFORD, TX 76021 PH: 817.281.0572 CONTACT NAME: DREW DONOSKY		
SURVEYOR: EAGLE SURVEYING, LLC 210 SOUTH ELM STREET, SUITE #104 DENTON, TX 76201 PH: 940.222.3009 CONTACT NAME: MATTHEW RAABE		
LEGAL DESCRIPTION: TRACT SITUATED IN THE SPENCER RICE SURVEY, ABSTRACT NO. 787, TOWN OF PROSPER, COLLIN COUNTY, TEXAS ZONING: PLANNED DEVELOPMENT - PD-116 (O)		
CITY: PROSPER	STATE: TEXAS	
COUNTY: COLLIN	SURVEY: SPENCER RICE	ABSTRACT NO. 787

LANDSCAPE ENLARGEMENT

SHEET
LP-1

File No. 2025-071



LEGEND

EXISTING TREES OR PALMS TO BE PRESERVED & PROTECTED IN PLACE

TREE #

TREE PROTECTION FENCE

ST - STREET TREE
 MT - MITIGATION TREE
 RT - SOUTH PERIMETER TREE (RESIDENTIAL)
 NT - NORTH PERIMETER TREE (NON-RESIDENTIAL)
 REFER TO LP-0 FOR PLANT SCHEDULE, LANDSCAPE CALCULATIONS, AND NOTES

THE DEVELOPER SHALL ERECT AN ORANGE PLASTIC MESH FENCE, OR OTHER APPROVED FENCING MATERIAL, A MINIMUM OF FOUR FEET IN HEIGHT AROUND EACH TREE OR GROUP OF TREES TO PREVENT THE PLACEMENT OF DEBRIS, EQUIPMENT, OR FILL WITHIN THE DRIPLINE OR CRITICAL ROOT ZONE. THE FENCE SHALL BE INSTALLED PRIOR TO THE RELEASE OF ANY PERMIT. IF THE PROTECTION FENCE IS FOUND REMOVED, DAMAGED, OR ALTERED AT ANY TIME DURING CONSTRUCTION PRIOR TO FINAL INSPECTION OR LANDSCAPE INSTALLATION, A STOP WORK ORDER MAY BE ISSUED BY THE BUILDING OFFICIAL.

TEXAS REGISTRATION #14199

CLAYMOORE ENGINEERING

3231 HARWOOD ROAD
 BEDFORD, TX 76021
 PHONE: 817.281.0272
 WWW.CLAYMOOREENG.COM

REGISTERED LANDSCAPE ARCHITECT

STEPHEN W. SALES

3470

STATE OF TEXAS

03/16/2026

FRONTIER SOUTH
N. PRESTON ROAD,
TOWN OF PROSPER, TX

No.	DATE	REVISION	BY

EVERGREEN DESIGN GROUP

800.890.6630
 www.evergreendesigngroup.com

LANDSCAPE ARCHITECTURE
 LAND PLANNING, IRRIGATION DESIGN

National Presence. Local Expertise.

SITE PLAN
VICTORY AT FRONTIER SOUTH
BLOCK A, LOTS 1 AND 2
DEVAPP-25-0107

OWNER:
 VICTORY AT FRONTIER SOUTH, LP
 2911 TURTLE CREEK BLVD., SUITE 700
 DALLAS, TX 75219
 PH: 469.707.9555 CONTACT NAME: TONY RAMJI

APPLICANT:
 CLAYMOORE ENGINEERING, INC.
 3231 HARWOOD ROAD
 BEDFORD, TX 76021
 PH: 817.281.0572 CONTACT NAME: DREW DONOSKY

SURVEYOR:
 EAGLE SURVEYING, LLC
 210 SOUTH ELM STREET, SUITE #104
 DENTON, TX 76201
 PH: 940.222.3009 CONTACT NAME: MATTHEW RAABE

LEGAL DESCRIPTION:
 TRACT SITUATED IN THE SPENCER RICE SURVEY, ABSTRACT NO. 787, TOWN OF PROSPER, COLLIN COUNTY, TEXAS ZONING: PLANNED DEVELOPMENT - PD-116 (O)

CITY: PROSPER STATE: TEXAS

COUNTY: COLLIN SURVEY: SPENCER RICE ABSTRACT NO.: 787

LANDSCAPE ENLARGEMENT

DESIGN: JC
 DRAWN: SS
 CHECKED: SS
 DATE: 03/16/2026

SHEET
LP-2

File No. 2025-071

PLANT SCHEDULE

SYMBOL	CODE	BOTANICAL NAME	COMMON NAME	SIZE	QTY	REMARKS
LARGE TREES						
	AC	<i>Acer saccharum</i> 'Caddo'	Caddo Sugar Maple	3" Cal.	10	7 HT. MIN.
	CA	<i>Cupressus arizonica</i>	Arizona Cypress	3" Cal.	8	7 HT. MIN., EVERGREEN
	MG	<i>Magnolia grandiflora</i>	Southern Magnolia	3" Cal.	12	7 HT. MIN., EVERGREEN
	QB	<i>Quercus buckleyi</i>	Buckley Oak	3" Cal.	6	7 MIN. HT.
	QG	<i>Quercus glaucooides</i>	Lacey Oak	3" Cal.	13	7 HT. MIN.
	QM	<i>Quercus macrocarpa</i>	Burr Oak	3" Cal.	8	7 HT. MIN.
	QC	<i>Quercus muhlenbergii</i>	Chinkapin Oak	3" Cal.	7	7 HT. MIN.
	QS	<i>Quercus shumardii</i>	Shumard Oak	3" Cal.	10	7 MIN. HT.
	QV	<i>Quercus virginiana</i>	Southern Live Oak	3" Cal.	22	7 HT. MIN., EVERGREEN
	UC	<i>Ulmus crassifolia</i>	Cedar Elm	3" Cal.	15	7 HT. MIN.
SMALL/ ORNAMENTAL TREES						
	CC	<i>Cercis canadensis texensis</i>	Texas Redbud	3" Cal.	9	7 HT. MIN.
	IV	<i>Ilex vomitoria</i>	Yaupon Holly	3" Cal.	16	7 HT. MIN., EVERGREEN
	LD	<i>Lagerstroemia indica</i> Dallas Red	Dallas Red Grape Myrtle	3" Cal.	12	7 HT. MIN.
	LI	<i>Lagerstroemia indica</i> White II	Grape Myrtle Dynamite	3" Cal.	14	7 HT. MIN.
	ML	<i>Magnolia grandiflora</i> Little Gem	Little Gem Dwarf Southern Magnolia	3" Cal.	16	7 HT. MIN., EVERGREEN
SHRUBS						
	AGA	<i>Abelia x grandiflora</i>	Glossy Abelia	5 gal.	50	24" MIN. HT., SEMI-EVERGREEN
	HPY	<i>Hesperaloe parviflora</i>	Red Yucca	5 gal.	16	24" MIN. HT., EVERGREEN
	ICN	<i>Ilex cornuta</i> Burfordii Nana	Dwarf Burford Holly	4" Ht.	69	EVERGREEN
	IVN	<i>Ilex vomitoria</i> Nana	Dwarf Yaupon Holly	5 gal.	43	24" MIN. HT., EVERGREEN
	LFC	<i>Leucophyllum frutescens</i> Compacta	Compact Texas Sage	5 gal.	27	24" MIN. HT., EVERGREEN
	MPM	<i>Myrica pusilla</i>	Dwarf Wax Myrtle	5 gal.	67	24" MIN. HT., EVERGREEN
	SSF	<i>Salvia greggii</i> Furmans Red	Furman's Red Autumn Sage	5 gal.	112	24" MIN. HT.
ORNAMENTAL GRASSES						
	BCG	<i>Bouteloua curtipendula</i>	Side Oats Grama	5 gal.	59	24" MIN. HT.
	MCG	<i>Muhlenbergia capillaris</i>	Pink Muhly Grass	5 gal.	30	24" MIN. HT.
	PVG	<i>Panicum virgatum</i>	Switch Grass	5 gal.	40	24" MIN. HT.
SOD/SEED						
	CD	<i>Cynodon dactylon</i> - Hydromulch	Bermuda Grass - Hydromulch	hydromulch	73,978 sf	
	TRF	<i>Cynodon dactylon x transvaalensis</i> 'DT-1'	TiFu™ Bermudagrass	sod	45,752 sf	



SITE PLAN VICTORY AT FRONTIER SOUTH BLOCK A, LOTS 1 AND 2 DEVAPP-25-0107		
OWNER: VICTORY AT FRONTIER SOUTH, LP 2911 TURTLE CREEK BLVD., SUITE 700 DALLAS, TX 75219 PH: 469.707.9555 CONTACT NAME: TONY RAMJI		
APPLICANT: CLAYMOORE ENGINEERING, INC. 3231 HARWOOD ROAD BEDFORD, TX 76021 PH: 817.281.0572 CONTACT NAME: DREW DONOSKY		
SURVEYOR: EAGLE SURVEYING, LLC 210 SOUTH ELM STREET, SUITE #104 DENTON, TX 76201 PH: 940.222.3009 CONTACT NAME: MATTHEW RAABE		
LEGAL DESCRIPTION: TRACT SITUATED IN THE SPENCER RICE SURVEY, ABSTRACT NO. 787, TOWN OF PROSPER, COLLIN COUNTY, TEXAS ZONING: PLANNED DEVELOPMENT - PD-116 (O)		
CITY: PROSPER	STATE: TEXAS	
COUNTY: COLLIN	SURVEY: SPENCER RICE	ABSTRACT NO. 787

TEXAS REGISTRATION #14199

CLAYMOORE ENGINEERING, INC.
3231 HARWOOD ROAD
BEDFORD, TX 76021
PHONE: 817.281.0572
WWW.CLAYMOOREENG.COM

03/16/2026

FRONTIER SOUTH
N. PRESTON ROAD,
TOWN OF PROSPER, TX

No.	DATE	REVISION	BY

PLANT SCHEDULE

SHEET
LP-3

File No. 2025-071

PLANTING SPECIFICATIONS

GENERAL

- A. QUALIFICATIONS OF LANDSCAPE CONTRACTOR
1. ALL LANDSCAPE WORK SHOWN ON THESE PLANS SHALL BE PERFORMED BY A SINGLE FIRM SPECIALIZING IN LANDSCAPE PLANTING.
 2. A LIST OF SUCCESSFULLY COMPLETED PROJECTS OF THIS TYPE, SIZE AND NATURE MAY BE REQUESTED BY THE OWNER FOR FURTHER QUALIFICATION MEASURES.
 3. THE LANDSCAPE CONTRACTOR SHALL HOLD A VALID NURSERY AND FLORAL CERTIFICATE ISSUED BY THE TEXAS DEPARTMENT OF AGRICULTURE, AS WELL AS OPERATE UNDER A COMMERCIAL PESTICIDE APPLICATOR LICENSE ISSUED BY EITHER THE TEXAS DEPARTMENT OF AGRICULTURE OR THE TEXAS STRUCTURAL PEST CONTROL BOARD.
- B. SCOPE OF WORK
- COVERED BY THESE SECTIONS INCLUDES THE FURNISHING AND PAYMENT OF ALL MATERIALS, LABOR, SERVICES, EQUIPMENT, LICENSES, TAXES AND ANY OTHER ITEMS THAT ARE NECESSARY FOR THE EXECUTION, INSTALLATION AND COMPLETION OF ALL WORK, SPECIFIED HEREIN AND / OR SHOWN ON THE LANDSCAPE PLANS, NOTES AND DETAILS.
1. ALL WORK SHALL BE PERFORMED IN ACCORDANCE WITH ALL APPLICABLE LAWS, CODES AND REGULATIONS REQUIRED BY AUTHORITIES HAVING JURISDICTION OVER SUCH WORK, INCLUDING ALL INSPECTIONS AND PERMITS REQUIRED BY FEDERAL, STATE AND LOCAL AUTHORITIES IN SUPPLY, TRANSPORTATION AND INSTALLATION OF MATERIALS.
 3. THE LANDSCAPE CONTRACTOR SHALL VERIFY THE LOCATION OF ALL UNDERGROUND UTILITY LINES (WATER, SEWER, ELECTRICAL, TELEPHONE, GAS, CABLE, TELEVISION, ETC.) PRIOR TO THE START OF ANY WORK.

PRODUCTS

- A. ALL MANUFACTURED PRODUCTS SHALL BE NEW.
- B. CONTAINER AND BALLED-AND-BURLAPPED PLANTS:
1. FURNISH NURSERY-GROWN PLANTS COMPLYING WITH ANSI Z60.1-2014. PROVIDE WELL-SHAPED, FULLY BRANCHED, HEALTHY, VIGOROUS STOCK FREE OF DISEASE, INSECTS, EGGS, LARVAE, AND DEFECTS SUCH AS KNOTS, SUN SCALD, INJURIES, ABRASIONS, AND DISFIGUREMENT. ALL PLANTS WITHIN A SPECIES SHALL HAVE SIMILAR SIZE, AND SHALL BE OF A FORM TYPICAL FOR THE SPECIES. ALL TREES SHALL BE OBTAINED FROM SOURCES WITHIN 200 MILES OF THE PROJECT SITE, AND WITH SIMILAR CLIMATIC CONDITIONS.
 2. ROOT SYSTEMS SHALL BE HEALTHY, DENSELY BRANCHED ROOT SYSTEMS, NON-POT-BOUND, FREE FROM ENCIRCLING AND/OR GIRDLING ROOTS, AND FREE FROM ANY OTHER ROOT DEFECTS (SUCH AS J-SHAPED ROOTS).
 3. ANY PLANT DEEMED UNACCEPTABLE BY THE LANDSCAPE ARCHITECT OR OWNER SHALL BE IMMEDIATELY REMOVED FROM THE SITE AND SHALL BE REPLACED WITH AN ACCEPTABLE PLANT OF LIKE TYPE AND SIZE AT THE CONTRACTOR'S OWN EXPENSE. ANY PLANTS APPEARING TO BE UNHEALTHY, EVEN IF DETERMINED TO STILL BE ALIVE, SHALL NOT BE ACCEPTED. THE LANDSCAPE ARCHITECT AND OWNER SHALL BE THE SOLE JUDGES AS TO THE ACCEPTABILITY OF PLANT MATERIAL.
 4. ALL TREES SHALL BE STANDARD IN FORM, UNLESS OTHERWISE SPECIFIED. TREES WITH CENTRAL LEADERS WILL NOT BE ACCEPTED IF LEADER IS DAMAGED OR REMOVED. PRUNE ALL DAMAGED TWIGS AFTER PLANTING.
 5. CALIPER MEASUREMENTS FOR STANDARD (SINGLE TRUNK) TREES SHALL BE AS FOLLOWS: SIX INCHES ABOVE THE ROOT FLARE FOR TREES UP TO AND INCLUDING FOUR INCHES IN CALIPER, AND TWELVE INCHES ABOVE THE ROOT FLARE FOR TREES EXCEEDING FOUR INCHES IN CALIPER.
 6. MULTI-TRUNK TREES SHALL BE MEASURED BY THEIR OVERALL HEIGHT, MEASURED FROM THE TOP OF THE ROOT BALL.
 7. ANY TREE OR SHRUB SHOWN TO HAVE EXCESS SOIL PLACED ON TOP OF THE ROOT BALL, SO THAT THE ROOT FLARE HAS BEEN COMPLETELY COVERED, SHALL BE REJECTED.
- C. SOD: PROVIDE WELL-ROOTED SOD OF THE VARIETY NOTED ON THE PLANS. SOD SHALL BE CUT FROM HEALTHY, MATURE TURF WITH SOIL THICKNESS OF 3/4" TO 1" EACH PALT OF SOD SHALL BE ACCOMPANIED BY A CERTIFICATE FROM SUPPLIER STATING THE COMPOSITION OF THE SOD.
- D. SEED: PROVIDE BLEND OF SPECIES AND VARIETIES AS NOTED ON THE PLANS, WITH MAXIMUM PERCENTAGES OF PURITY, GERMINATION, AND MINIMUM PERCENTAGE OF WEED SEED AS INDICATED ON PLANS. EACH BAG OF SEED SHALL BE ACCOMPANIED BY A TAG FROM THE SUPPLIER INDICATING THE COMPOSITION OF THE SEED.
- E. TOPSOIL: SANDY TO CLAY LOAM TOPSOIL, FREE OF STONES LARGER THAN 1/2" INCH, FOREIGN MATTER, PLANTS, ROOTS, AND SEEDS.
- F. COMPOST: WELL-COMPOSTED, STABLE, AND WEED-FREE ORGANIC MATTER, pH RANGE OF 5.5 TO 8; MOISTURE CONTENT 35 TO 55 PERCENT BY WEIGHT; 100 PERCENT PASSING THROUGH #10MESH SIEVE; SOLUBLE SALT CONTENT OF 5 TO 10 DECIGRAMS/L; NOT EXCEEDING 0.5 PERCENT INERT CONTAMINANTS AND FREE OF SUBSTANCES TOXIC TO PLANTINGS. NO MANURE OR ANIMAL-BASED PRODUCTS SHALL BE USED.
- G. FERTILIZER: GRANULAR FERTILIZER CONSISTING OF NITROGEN, PHOSPHORUS, POTASSIUM, AND OTHER NUTRIENTS IN PROPORTIONS, AMOUNTS, AND RELEASE RATES RECOMMENDED IN A SOIL REPORT FROM A QUALIFIED SOIL-TESTING AGENCY (SEE BELOW).
- H. MULCH: SIZE AND TYPE AS INDICATED ON PLANS, FREE FROM DELETERIOUS MATERIALS AND SUITABLE AS A TOP DRESSING OF TREES AND SHRUBS.
- I. WEED FABRIC: 5 OUNCE, WOVEN, NEEDLE-PUNCHED FABRIC, SUCH AS DEWITT PROS LANDSCAPE FABRIC (OR APPROVED EQUAL).
- J. TREE STAKING AND GUYING
1. STAKES: 6' LONG GREEN METAL T-POSTS.
 2. GUY AND TIE WIRE: ASTM A 641, CLASS 1, GALVANIZED-STEEL WIRE, 2-STRAND, TWISTED, 0.106 INCH DIAMETER.
 3. STRAP CHAFING GUARD: REINFORCED NYLON OR CANVAS AT LEAST 1-1/2 INCH WIDE, WITH GROMMETS TO PROTECT TREE TRUNKS FROM DAMAGE.
- M. STEEL EDGING: PROFESSIONAL STEEL EDGING, 10 GAUGE THICK X 4 INCHES WIDE, FACTORY PAINTED DARK GREEN, ACCEPTABLE MANUFACTURERS INCLUDE COL-MET OR APPROVED EQUAL.
- N. PRE-EMERGENT HERBICIDES: ANY GRANULAR, NON-STAINING PRE-EMERGENT HERBICIDE THAT IS LABELED FOR THE SPECIFIC ORNAMENTALS OR TURF ON WHICH IT WILL BE UTILIZED. PRE-EMERGENT HERBICIDES SHALL BE APPLIED PER THE MANUFACTURER'S LABELED RATES.

METHODS

- A. SOIL PREPARATION
1. BEFORE STARTING WORK, THE LANDSCAPE CONTRACTOR SHALL VERIFY THAT THE GRADE OF ALL LANDSCAPE AREAS ARE WITHIN +0.1' OF FINISH GRADE. THE CONTRACTOR SHALL NOTIFY THE OWNER IMMEDIATELY SHOULD ANY DISCREPANCIES EXIST.
 2. SOIL TESTING.
 - a. AFTER FINISH GRADES HAVE BEEN ESTABLISHED, CONTRACTOR SHALL HAVE SOIL SAMPLES TESTED BY AN ESTABLISHED SOIL TESTING LABORATORY FOR THE FOLLOWING: SOIL TEXTURAL CLASS, GENERAL SOIL FERTILITY, pH, ORGANIC MATTER CONTENT, SALT (EC), LIME, SODIUM ADSORPTION RATIO (SAR) AND BORON CONTENT. EACH SAMPLE SUBMITTED SHALL CONTAIN NO LESS THAN ONE QUART OF SOIL.
 - b. CONTRACTOR SHALL ALSO SUBMIT THE PROJECT'S PLANT LIST TO THE LABORATORY ALONG WITH THE SOIL SAMPLES.
 - c. THE SOIL REPORT PRODUCED BY THE LABORATORY SHALL CONTAIN RECOMMENDATIONS FOR THE FOLLOWING (AS APPROPRIATE): GENERAL SOIL PREPARATION AND BACKFILL MIXES, PRE-PLANT FERTILIZER APPLICATIONS, AND ANY OTHER SOIL RELATED ISSUES. THE REPORT SHALL ALSO PROVIDE A FERTILIZER PROGRAM FOR THE ESTABLISHMENT PERIOD AND FOR LONG-TERM MAINTENANCE.
 3. THE CONTRACTOR SHALL INSTALL SOIL AMENDMENTS AND FERTILIZERS PER THE SOILS REPORT RECOMMENDATIONS. ANY CHANGE IN SOIL REPORT DUE TO THE SOIL REPORT RECOMMENDATIONS, EITHER INCREASE OR DECREASE, SHALL BE SUBMITTED TO THE OWNER WITH THE REPORT.
 4. FOR BIDDING PURPOSES ONLY, THE SOIL PREPARATION SHALL CONSIST OF THE FOLLOWING:
 - a. TURF: INCORPORATE THE FOLLOWING AMENDMENTS INTO THE TOP 8" OF SOIL BY MEANS OF ROTOTILLING AFTER CROSS-RIPPING:
 - i. NITROGEN STABILIZED ORGANIC AMENDMENT - 4 CU. YDS. PER 1,000 S.F.
 - ii. PREPLANT TURF FERTILIZER (10-20-10 OR SIMILAR, SLOW RELEASE, ORGANIC) - 15 LBS PER 1,000 S.F.
 - iii. "CLAY BUSTER" OR EQUAL - USE MANUFACTURER'S RECOMMENDED RATE
 - b. SOILS, SHRUBS, AND PERENNIALS: INCORPORATE THE FOLLOWING AMENDMENTS INTO THE TOP 8" OF SOIL BY MEANS OF ROTOTILLING AFTER CROSS-RIPPING:
 - i. NITROGEN STABILIZED ORGANIC AMENDMENT - 4 CU. YDS. PER 1,000 S.F.
 - ii. 12-12-12 FERTILIZER (OR SIMILAR, ORGANIC, SLOW RELEASE) - 10 LBS. PER CU. YD.
 - iii. "CLAY BUSTER" OR EQUAL - USE MANUFACTURER'S RECOMMENDED RATE
 - iv. IRON SULPHATE - 2 LBS. PER CU. YD.

GENERAL GRADING & PLANTING NOTES

1. BY SUBMITTING A PROPOSAL FOR THE LANDSCAPE PLANTING SCOPE OF WORK, THE CONTRACTOR CONFIRMS THAT HE HAS READ, AND WILL COMPLY WITH, THE ASSOCIATED NOTES, SPECIFICATIONS, AND DETAILS WITH THIS PROJECT.
2. THE GENERAL CONTRACTOR IS RESPONSIBLE FOR REMOVING ALL EXISTING VEGETATION (EXCEPT WHERE NOTED TO REMAIN).
3. IN THE CONTEXT OF THESE NOTES AND SPECIFICATIONS, "FINISH GRADE" REFERS TO THE FINAL ELEVATION OF THE SOIL SURFACE (NOT TOP OF MULCH) AS INDICATED ON THE GRADING PLANS.
 - a. BEFORE STARTING WORK, THE LANDSCAPE CONTRACTOR SHALL VERIFY THAT THE ROUGH GRADES OF ALL LANDSCAPE AREAS ARE WITHIN +0.1' OF FINISH GRADE. SEE SPECIFICATIONS FOR MORE DETAILED INSTRUCTION ON TURF AREA AND PLANTING BED PREPARATION.
 - b. CONSTRUCT AND MAINTAIN FINISH GRADES AS SHOWN ON GRADING PLANS, AND CONSTRUCT AND MAINTAIN SLOPES AS RECOMMENDED BY THE GEOTECHNICAL REPORT. ALL LANDSCAPE AREAS SHALL HAVE POSITIVE DRAINAGE AWAY FROM STRUCTURES AT THE MINIMUM SLOPE SPECIFIED IN THE REPORT AND ON THE GRADING PLANS, AND AREAS OF POTENTIAL PONDING SHALL BE REGRADED TO BLEND IN WITH THE SURROUNDING GRADES AND ELIMINATE PONDING POTENTIAL.
 - c. THE LANDSCAPE CONTRACTOR SHALL DETERMINE WHETHER OR NOT THE EXPORT OF ANY SOIL WILL BE NEEDED, TAKING INTO ACCOUNT THE ROUGH GRADE PROVIDED, THE AMOUNT OF SOIL AMENDMENTS TO BE ADDED (BASED ON A SOIL TEST, PER SPECIFICATIONS), AND THE FINISH GRADES TO BE ESTABLISHED.
 - d. ENSURE THAT THE FINISH GRADE IN SHRUB AREAS IMMEDIATELY ADJACENT TO WALKS AND OTHER WALKING SURFACES, AFTER INSTALLING SOIL AMENDMENTS, IS 3" BELOW THE ADJACENT FINISH GRADE, IN ORDER TO ALLOW FOR PROPER MULCH DEPTH. TAPER THE SOIL SURFACE TO MEET FINISH GRADE AT APPROXIMATELY 18" AWAY FROM THE WALKS.
 - e. ENSURE THAT THE FINISH GRADE IN TURF AREAS IMMEDIATELY ADJACENT TO WALKS AND OTHER WALKING SURFACES, AFTER INSTALLING SOIL AMENDMENTS, IS 1" BELOW THE FINISH GRADE OF THE WALKS. TAPER THE SOIL SURFACE TO MEET FINISH GRADE, AS SPECIFIED ON THE GRADING PLANS, AT APPROXIMATELY 18" AWAY FROM THE WALKS.
 - f. SHOULD ANY CONFLICTS AND/OR DISCREPANCIES ARISE BETWEEN THE GRADING PLANS, GEOTECHNICAL REPORT, THESE NOTES AND PLANS, AND ACTUAL CONDITIONS, THE CONTRACTOR SHALL IMMEDIATELY BRING SUCH ITEMS TO THE ATTENTION OF THE LANDSCAPE ARCHITECT, GENERAL CONTRACTOR, AND OWNER.
4. ALL PLANT LOCATIONS ARE DIAGRAMMATIC. ACTUAL LOCATIONS SHALL BE VERIFIED WITH THE LANDSCAPE ARCHITECT OR DESIGNER PRIOR TO PLANTING. THE LANDSCAPE CONTRACTOR SHALL ENSURE THAT ALL REQUIREMENTS OF THE PERMITTING AUTHORITY ARE MET (I.E., MINIMUM PLANT QUANTITIES, PLANTING METHODS, TREE PROTECTION METHODS, ETC.).
 - a. THE LANDSCAPE CONTRACTOR IS RESPONSIBLE FOR DETERMINING PLANT QUANTITIES; PLANT QUANTITIES SHOWN ON LEGENDS AND CALLOUTS ARE FOR GENERAL INFORMATION ONLY. IN THE EVENT OF A DISCREPANCY BETWEEN THE PLAN AND THE PLANT LEGEND, THE PLANT QUANTITY AS SHOWN ON THE PLAN (FOR INDIVIDUAL SYMBOLS) OR CALLOUT (FOR GROUNDCOVER PATTERNS) SHALL TAKE PRECEDENCE.
 - b. NO SUBSTITUTIONS OF PLANT MATERIALS SHALL BE ALLOWED WITHOUT THE WRITTEN PERMISSION OF THE LANDSCAPE ARCHITECT. IF SOME OF THE PLANTS ARE NOT AVAILABLE, THE LANDSCAPE CONTRACTOR SHALL NOTIFY THE LANDSCAPE ARCHITECT IN WRITING (VIA PROPER CHANNELS).
 - c. THE CONTRACTOR SHALL, AT A MINIMUM, PROVIDE REPRESENTATIVE PHOTOS OF ALL PLANTS PROPOSED FOR THE PROJECT. THE CONTRACTOR SHALL ALLOW THE LANDSCAPE ARCHITECT AND THE OWNER/OWNER'S REPRESENTATIVE TO INSPECT, AND APPROVE OR REJECT, ALL PLANTS DELIVERED TO THE JOBSITE. REFER TO SPECIFICATIONS FOR ADDITIONAL REQUIREMENTS FOR SUBMITTALS.
5. CONTRACTOR SHALL PREPARE AND INSTALL SOLID SOD IN ALL RIGHT-OF-WAYS AND PARKWAYS (UNLESS NOT ALLOWED BY THE LOCAL JURISDICTION) AND SHALL PROVIDE WATERING AND MAINTENANCE UNTIL THE TURF IS ESTABLISHED AND HAS BEEN ACCEPTED BY OWNER.
6. THE CONTRACTOR SHALL MAINTAIN THE LANDSCAPE IN A HEALTHY CONDITION FOR 90 DAYS AFTER ACCEPTANCE BY THE OWNER. REFER TO SPECIFICATIONS FOR CONDITIONS OF ACCEPTANCE FOR THE START OF THE MAINTENANCE PERIOD, AND FOR FINAL ACCEPTANCE AT THE END OF THE MAINTENANCE PERIOD.
7. SEE SPECIFICATIONS AND DETAILS FOR FURTHER REQUIREMENTS.

5. CONTRACTOR SHALL ENSURE THAT THE GRADE IN SOD AREAS SHALL BE 1" BELOW FINISH GRADE BEFORE INSTALLING SOIL AMENDMENTS, AND 2" BELOW FINISH GRADE IN SHRUB AREAS BEFORE INSTALLING SOIL AMENDMENTS. MULCH COVER THE WALKS AND CURBS SHALL NOT PROTRUDE ABOVE THE FINISH SURFACE OF THE WALKS AND CURBS. MULCH COVER WITHIN 12" OF WALLS SHALL BE AT LEAST 3" LOWER THAN THE TOP OF WALL.
 6. ONCE SOIL PREPARATION IS COMPLETE, THE LANDSCAPE CONTRACTOR SHALL ENSURE THAT THERE ARE NO DEBRIS, TRASH, OR STONES LARGER THAN 1" REMAINING IN THE TOP 6" OF SOIL.
- B. GENERAL PLANTING
1. REMOVE ALL NURSERY TAGS AND STAKES FROM PLANTS.
 2. EXCEPT IN AREAS TO BE PLANTED WITH ORNAMENTAL GRASSES, APPLY PRE-EMERGENT HERBICIDES AT THE MANUFACTURER'S RECOMMENDED RATE.
 3. TRENCING NEAR EXISTING TREES:
 - a. CONTRACTOR SHALL NOT DISTURB ROOTS 1-1/2" AND LARGER IN DIAMETER WITHIN THE CRITICAL ROOT ZONE (CRZ) OF EXISTING TREES, AND SHALL EXERCISE ALL POSSIBLE CARE AND PRECAUTIONS TO AVOID INJURY TO TREE ROOTS, TRUNKS, AND BRANCHES. THE CRZ IS DEFINED AS A CIRCULAR AREA EXTENDING OUTWARD FROM THE TREE TRUNK WITH A RADIUS EQUAL TO 1' FOR EVERY 1" OF TRUNK DIAMETER-AT-BREAST-HEIGHT (4.5' ABOVE THE AVERAGE GRADE AT THE TRUNK).
 - b. ALL EXCAVATION WITHIN THE CRZ SHALL BE PERFORMED USING HAND TOOLS. NO MACHINE EXCAVATION OR TRENCING OF ANY KIND SHALL BE ALLOWED WITHIN THE CRZ.
 - c. ALTER ALIGNMENT OF PIPE TO AVOID TREE ROOTS 1-1/2" AND LARGER IN DIAMETER. WHERE TREE ROOTS 1-1/2" AND LARGER IN DIAMETER ARE ENCOUNTERED IN THE FIELD, TUNNEL UNDER SUCH ROOTS. WRAP EXPOSED ROOTS WITH SEVERAL LAYERS OF BURLAP AND KEEP MOIST. CLOSE ALL TRENCHES WITHIN THE CANOPY DRIP LINES WITHIN 24 HOURS.
 - d. ALL SEVERED ROOTS SHALL BE HAND PRUNED WITH SHARP TOOLS AND ALLOWED TO AIR-DRY. DO NOT USE ANY SORT OF SEALERS OR WOUND PAINTS.
- C. TREE PLANTING
1. TREE PLANTING HOLES SHALL BE EXCAVATED TO MINIMUM WIDTH OF TWO TIMES THE WIDTH OF THE ROOTBALL, AND TO A DEPTH EQUAL TO THE DEPTH OF THE ROOTBALL LESS TWO TO FOUR INCHES.
 2. SCARIFY THE SOLE PRIOR TO THE PLACEMENT OF THE TREE. REMOVE ANY GLAZING THAT MAY HAVE BEEN CAUSED DURING THE EXCAVATION OF THE HOLE.
 3. FOR CONTAINER AND BOX TREES, TO REMOVE ANY POTENTIALLY GIRDLING ROOTS AND OTHER ROOT DEFECTS, THE CONTRACTOR SHALL SHAVE A 1" LAYER OFF OF THE SIDES AND BOTTOM OF THE ROOTBALL OF ALL TREES JUST BEFORE PLACING INTO THE PLANTING PIT. DO NOT "TEASE" ROOTS OUT FROM THE ROOTBALL.
 4. INSTALL THE TREE ON UNDISTURBED SUBGRADE SO THAT THE TOP OF THE ROOTBALL IS TWO TO FOUR INCHES ABOVE THE SURROUNDING GRADE.
 5. BACKFILL THE TREE HOLE UTILIZING THE EXISTING TOPSOIL FROM ON-SITE. ROCKS LARGER THAN 1" DIA. AND ALL OTHER DEBRIS SHALL BE REMOVED FROM THE SOIL PRIOR TO THE BACKFILL. SHOULD ADDITIONAL SOIL BE REQUIRED TO ACCOMPLISH THIS TASK, USE STORED TOPSOIL FROM ON-SITE OR IMPORT ADDITIONAL TOPSOIL FROM OFF-SITE AT NO ADDITIONAL COST TO THE OWNER. IMPORTED TOPSOIL SHALL BE OF SIMILAR TEXTURAL CLASS AND COMPOSITION IN THE ON-SITE SOIL.
 6. THE TOTAL NUMBER OF TREE STAKES (BEYOND THE MINIMUMS LISTED BELOW) WILL BE LEFT TO THE LANDSCAPE CONTRACTOR'S DISCRETION. SHOULD ANY TREES FALL OR LEAN, THE LANDSCAPE CONTRACTOR SHALL STRAIGHTEN THE TREE, OR REPLACE IT SHOULD IT BECOME DAMAGED. TREE STAKING SHALL ADHERE TO THE FOLLOWING GUIDELINES:
 - a. 1-2" TREES: TWO STAKES PER TREE
 - b. 2-1/2" - 4" TREES: THREE STAKES PER TREE
 - c. TREES OVER 4" CALIPER: GUY AS NEEDED
 - d. MULTI-TRUNK TREES: THREE STAKES PER TREE MINIMUM, QUANTITY AND POSITIONS AS NEEDED TO STABILIZE THE TREE
 7. UPON COMPLETION OF PLANTING, CONSTRUCT AN EARTH WATERING BASIN AROUND THE TREE. COVER THE INTERIOR OF THE TREE RING WITH THE WEED BARRIER CLOTH AND TOPDRESS WITH MULCH (TYPE AND DEPTH PER PLANS).
- D. SHRUB, PERENNIAL, AND GROUNDCOVER PLANTING
1. DIG THE PLANTING HOLES TWICE AS WIDE AND 2" LESS DEEP THAN EACH PLANT'S ROOTBALL. INSTALL THE PLANT IN THE HOLE. BACKFILL AROUND THE PLANT WITH SOIL AMENDED PER SOIL TEST RECOMMENDATIONS.
 2. INSTALL THE WEED BARRIER CLOTH, OVERLAPPING IT AT THE ENDS. UTILIZE STEEL STAPLES TO KEEP THE WEED BARRIER CLOTH IN PLACE.
 3. WHEN PLANTING IS COMPLETE, INSTALL MULCH (TYPE AND DEPTH PER PLANS) OVER ALL PLANTING BEDS, COVERING THE ENTIRE PLANTING AREA.
- E. SODDING
1. SOD VARIETY TO BE AS SPECIFIED ON THE LANDSCAPE PLAN.
 2. LAY SOD WITHIN 24 HOURS FROM THE TIME OF STRIPPING. DO NOT LAY IF THE GROUND IS FROZEN.
 3. LAY THE SOD TO FORM A SOLID MASS WITH TIGHTLY FITTED JOINTS. BUTT ENDS AND SIDES OF SOD STRIPS - DO NOT OVERLAP. STAGGER STRIPS TO OFFSET JOINTS IN ADJACENT COURSES.
 4. ROLL THE SOD TO ENSURE GOOD CONTACT OF THE SOD'S ROOT SYSTEM WITH THE SOIL UNDERNEATH.
 5. WATER THE SOD THOROUGHLY WITH A FINE SPRAY IMMEDIATELY AFTER PLANTING TO OBTAIN AT LEAST SIX INCHES OF PENETRATION INTO THE SOIL BELOW THE SOD.
- G. CLEAN UP
1. DURING LANDSCAPE PREPARATION AND PLANTING, KEEP ALL PAVEMENT CLEAN AND ALL GUYING AREAS IN A NEAT, ORDERLY CONDITION.
 2. DISPOSED LEGALLY OF ALL EXCAVATED MATERIALS OFF THE PROJECT SITE.
- H. INSPECTION AND ACCEPTANCE
1. UPON COMPLETION OF THE WORK, THE LANDSCAPE CONTRACTOR SHALL PROVIDE THE SITE CLEAN, FREE OF DEBRIS AND TRASH, AND SUITABLE FOR USE AS INTENDED. THE LANDSCAPE CONTRACTOR SHALL THEN REQUEST AN INSPECTION BY THE OWNER TO DETERMINE FINAL ACCEPTABILITY.
 2. WHEN THE INSPECTED PLANTING WORK DOES NOT COMPLY WITH THE CONTRACT DOCUMENTS, THE LANDSCAPE CONTRACTOR SHALL REPLACE AND/OR REPAIR THE REJECTED WORK TO THE OWNER'S SATISFACTION WITHIN 24 HOURS.
 3. THE LANDSCAPE MAINTENANCE PERIOD WILL NOT COMMENCE UNTIL THE LANDSCAPE WORK HAS BEEN RE-INSPECTED BY THE OWNER AND FOUND TO BE ACCEPTABLE. AT THAT TIME, A WRITTEN NOTICE OF FINAL ACCEPTANCE WILL BE ISSUED BY THE OWNER, AND THE MAINTENANCE AND GUARANTEE PERIODS WILL COMMENCE.
- I. LANDSCAPE MAINTENANCE
1. THE LANDSCAPE CONTRACTOR SHALL BE RESPONSIBLE FOR THE MAINTENANCE OF ALL WORK SHOWN ON THESE PLANS FOR 90 DAYS BEYOND FINAL ACCEPTANCE OF ALL LANDSCAPE WORK BY THE OWNER. LANDSCAPE MAINTENANCE SHALL INCLUDE WEEKLY SITE VISITS FOR THE FOLLOWING ACTIONS (AS APPROPRIATE): PROPER PRUNING, RESTAKING OF TREES, RESETTING OF PLANTS THAT HAVE SETTLED, MOIVING AND AERATION OF LAWNS, WEEDING, RESEEDING AREAS WHICH HAVE NOT GERMINATED WELL, TREATING FOR INSECTS AND DISEASES, REMOVAL OF MULCH, REMOVAL OF LITTER, REPAIRS TO THE IRRIGATION SYSTEM DUE TO FAULTY PARTS AND/OR WORKMANSHIP, AND THE APPROPRIATE WATERING OF ALL PLANTINGS. THE LANDSCAPE CONTRACTOR SHALL MAINTAIN THE IRRIGATION SYSTEM IN PROPER WORKING ORDER, WITH SCHEDULING ADJUSTMENTS BY SEASON TO MAXIMIZE WATER CONSERVATION. SHOULD AN AUTOMATIC IRRIGATION SYSTEM BE INSTALLED, THE CONTRACTOR SHALL BE RESPONSIBLE FOR WATERING THESE AREAS AND OBTAINING A FULL, HEALTHY STAND OF GRASS AT NO ADDITIONAL COST TO THE OWNER.
 2. TO ACHIEVE FINAL ACCEPTANCE AT THE END OF THE MAINTENANCE PERIOD, ALL OF THE FOLLOWING CONDITIONS MUST OCCUR:
 - a. THE LANDSCAPE SHALL SHOW ACTIVE, HEALTHY GROWTH (WITH EXCEPTIONS MADE FOR SEASONAL DORMANCY). ALL PLANTS NOT MEETING THIS CONDITION SHALL BE REJECTED AND REPLACED BY HEALTHY PLANT MATERIAL PRIOR TO FINAL ACCEPTANCE.
 - b. ALL HARDSCAPE SHALL BE CLEANED PRIOR TO FINAL ACCEPTANCE.
 - c. SODDED AREAS MUST BE ACTIVELY GROWING AND MUST REACH A MINIMUM HEIGHT OF 1 1/2 INCHES BEFORE FIRST MOWING. HYDROMULCHED AREAS SHALL SHOW ACTIVE, HEALTHY GROWTH. BARE AREAS LARGER THAN TWELVE SQUARE INCHES MUST BE RESEDED OR RESEEDED (AS APPROPRIATE) PRIOR TO FINAL ACCEPTANCE. ALL SODDED TURF SHALL BE NEATLY MOWED.
- J. WARRANTY AND GUARANTEE AND REPAIRS
1. THE LANDSCAPE CONTRACTOR SHALL GUARANTEE ALL TREES, SHRUBS, PERENNIALS, SOD, SEEDED/HYDROMULCHED AREAS, AND IRRIGATION SYSTEMS FOR A PERIOD OF ONE YEAR FROM THE DATE OF THE OWNER'S FINAL ACCEPTANCE (90 DAYS FOR ANNUAL PLANTS). THE CONTRACTOR SHALL REPLACE, AT HIS OWN EXPENSE AND TO THE SATISFACTION OF THE OWNER, ANY PLANTS WHICH DIE IN THAT TIME, OR REPAIR ANY PORTIONS OF THE IRRIGATION SYSTEM WHICH OPERATE IMPROPERLY.
 2. AFTER THE INITIAL MAINTENANCE PERIOD AND DURING THE GUARANTEE PERIOD, THE LANDSCAPE CONTRACTOR SHALL ONLY BE RESPONSIBLE FOR REPLACEMENT OF PLANTS WHEN PLANT DEATH CANNOT BE ATTRIBUTED DIRECTLY TO OVERWATERING OR OTHER DAMAGE BY HUMAN ACTIONS.
- K. PROVIDE A MINIMUM OF (2) COPIES OF RECORD DRAWINGS TO THE OWNER UPON COMPLETION OF WORK. A RECORD DRAWING IS A RECORD OF ALL CHANGES THAT OCCURRED IN THE FIELD AND THAT ARE DOCUMENTED THROUGH CHANGE ORDERS, ADDENDA, OR CONTRACTOR/CONSULTANT DRAWING MARKUPS.

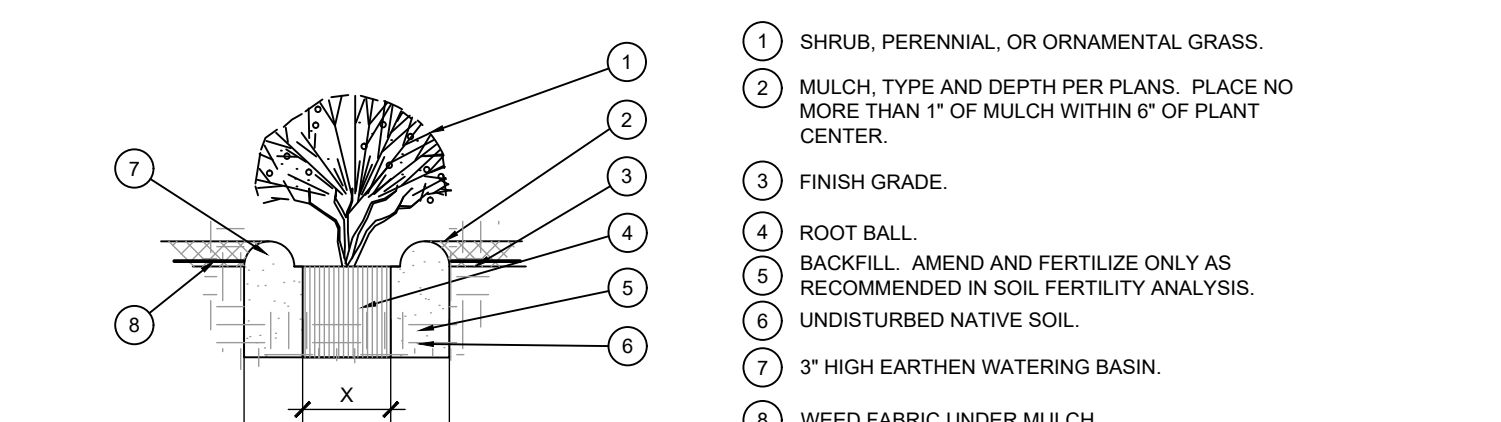
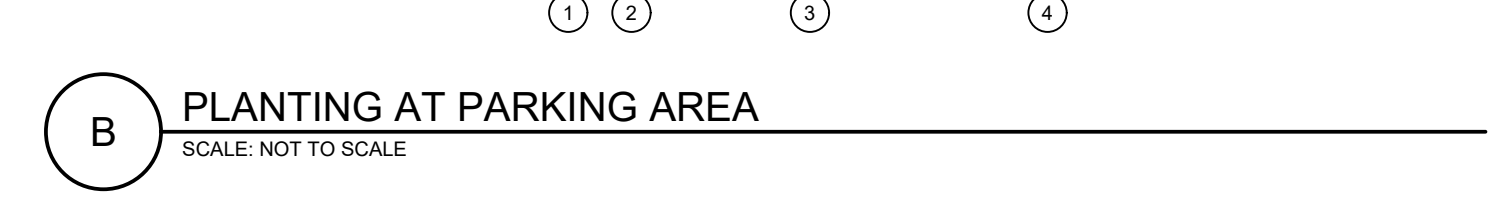
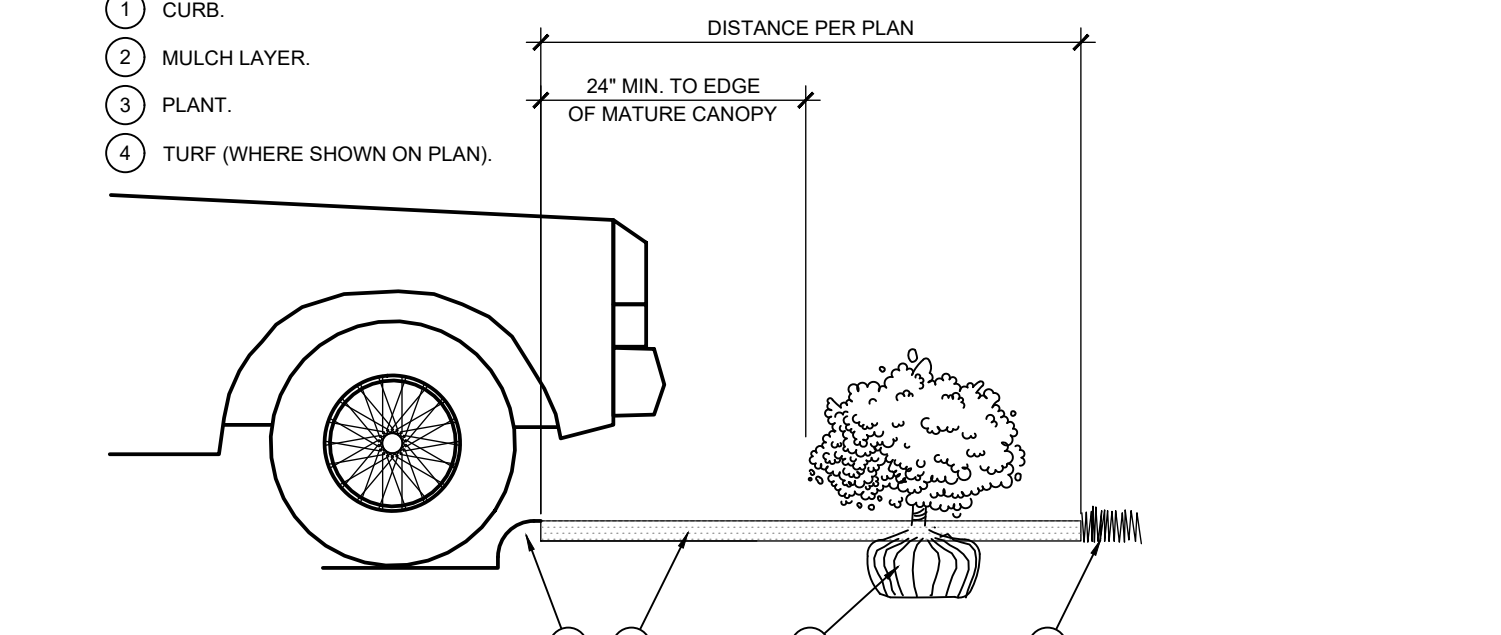
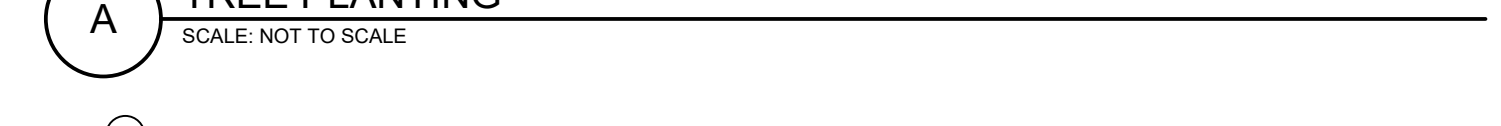
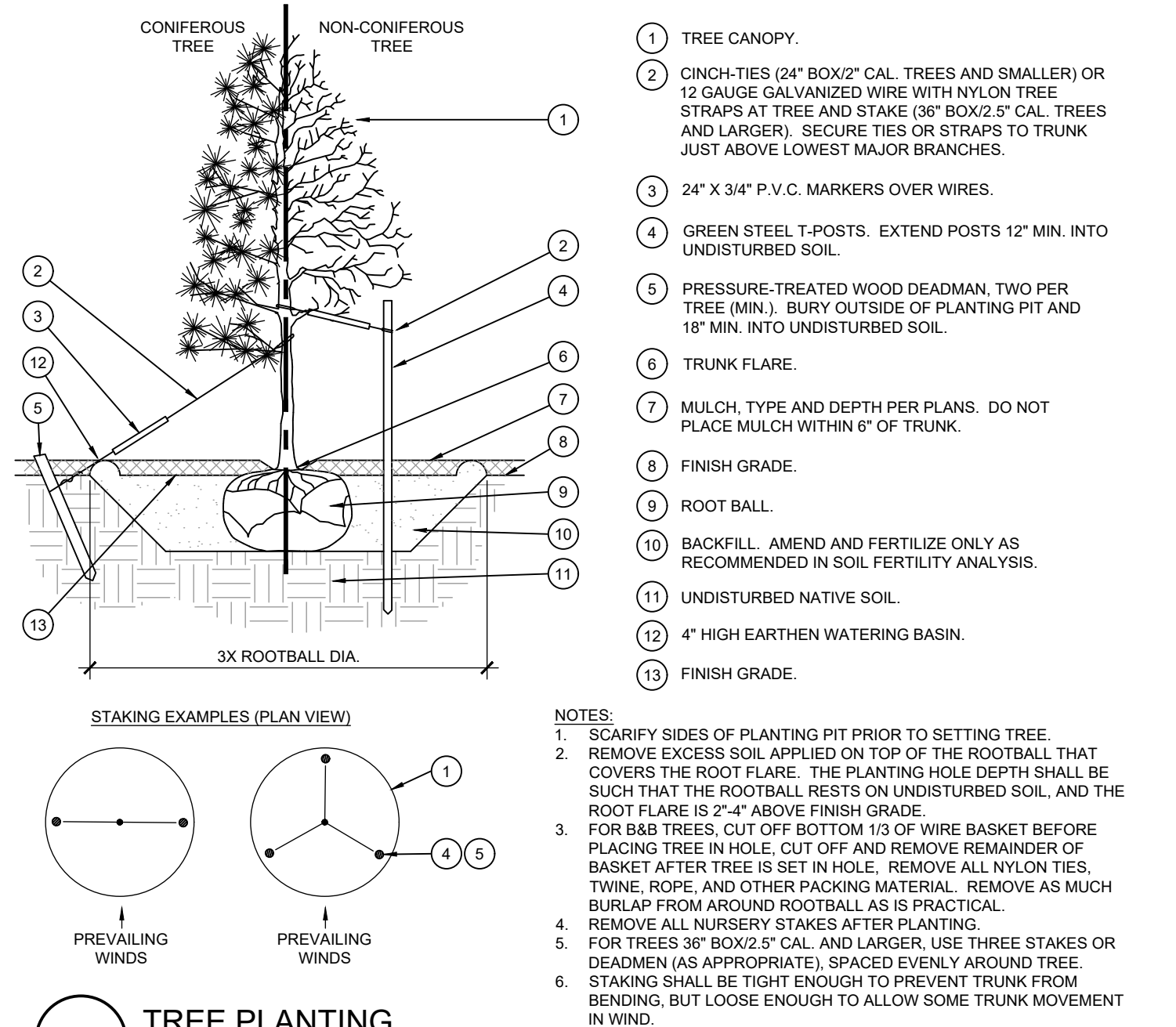
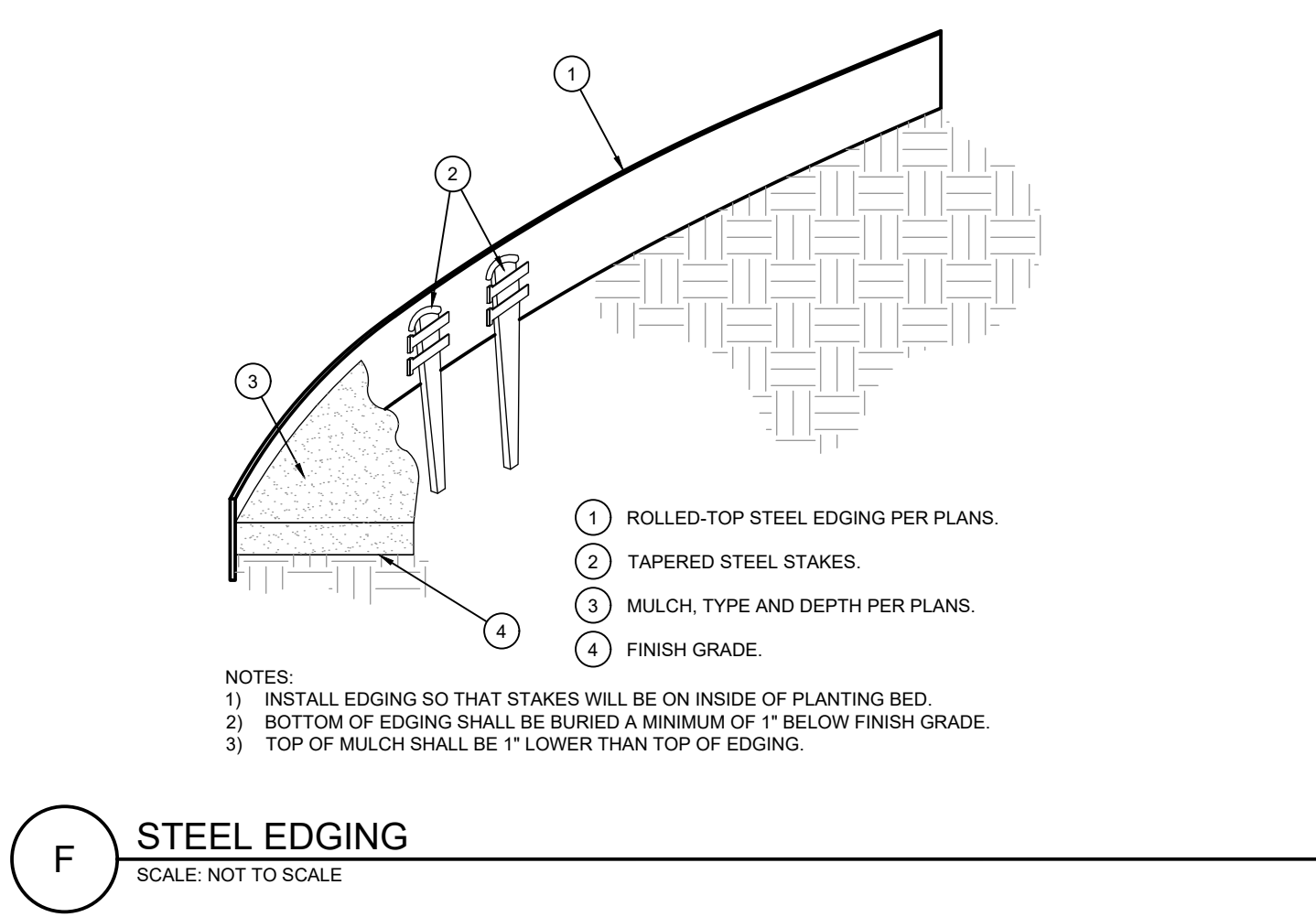
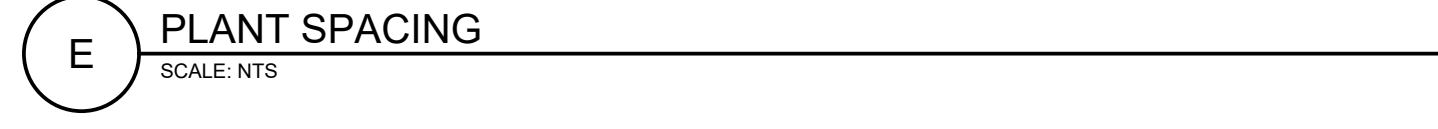
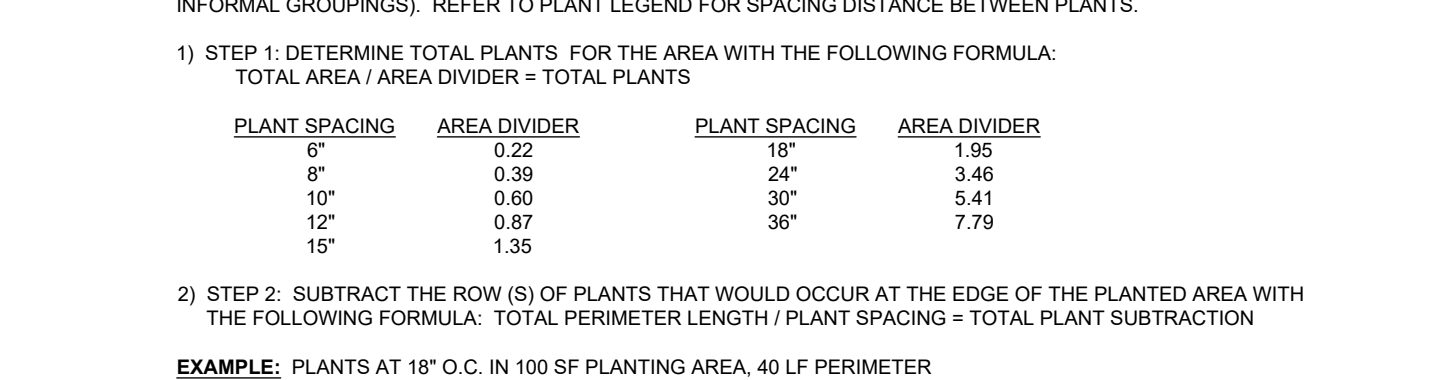
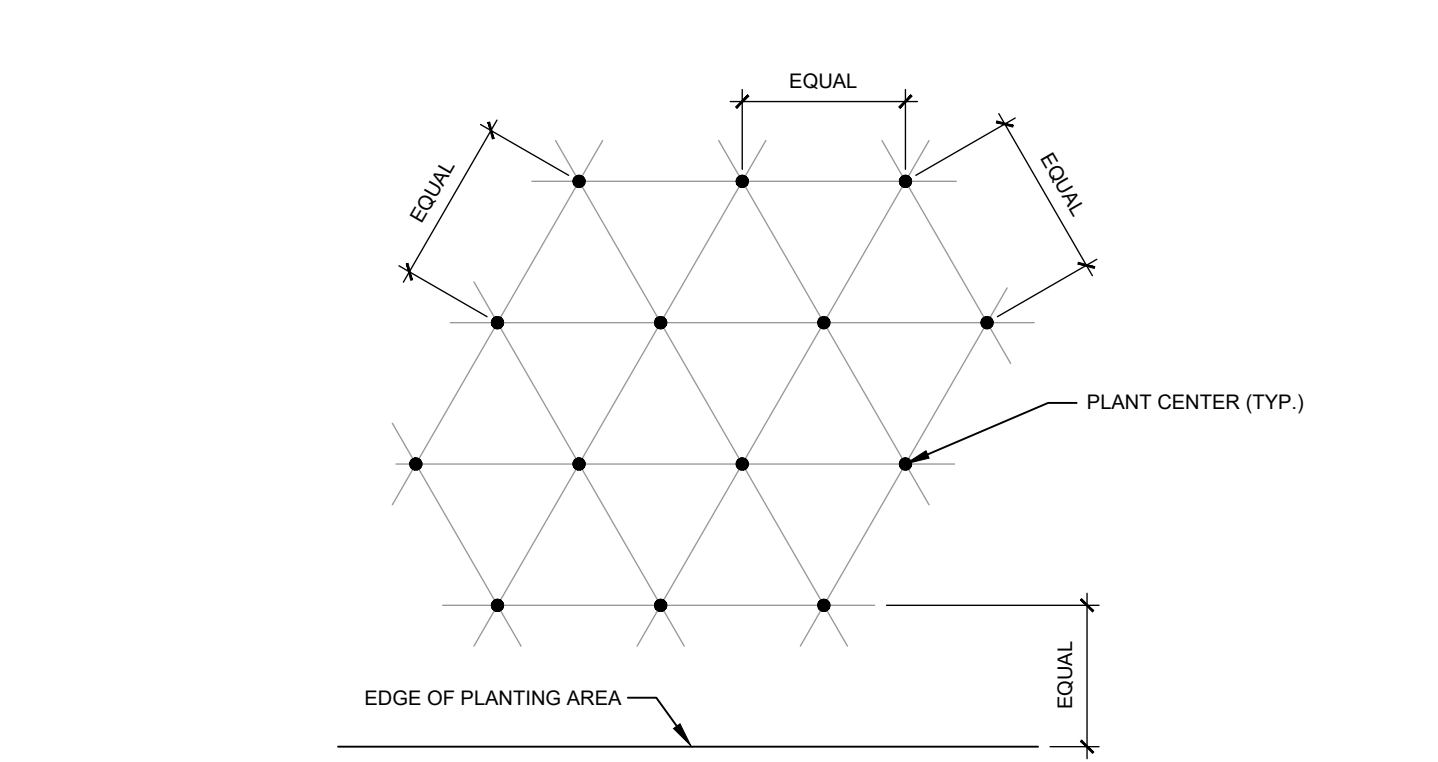
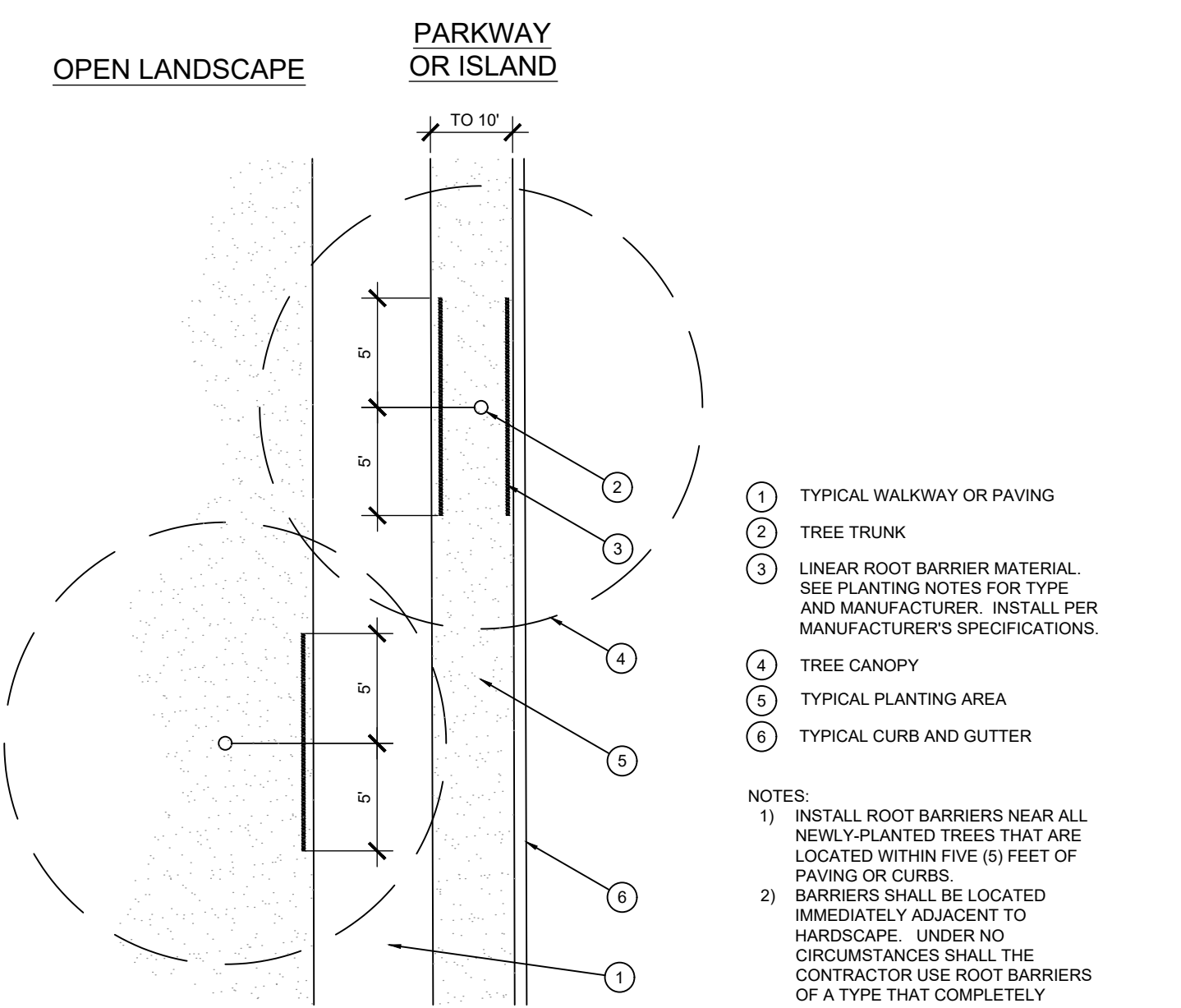

SITE PLAN
VICTORY AT FRONTIER SOUTH
BLOCK A, LOTS 1 AND 2
DEVAPP-25-0107

OWNER:
 VICTORY AT FRONTIER SOUTH, LP
 2911 TURTLE CREEK BLVD., SUITE 700
 DALLAS, TX 75219
 PH: 469.707.9555 CONTACT NAME: TONY RAMJI

APPLICANT:
 CLAYMOORE ENGINEERING, INC.
 3231 HARWOOD ROAD
 BEDFORD, TX 76021
 PH: 817.281.0572 CONTACT NAME: DREW DONOSKY

SURVEYOR:
 EAGLE SURVEYING, LLC
 210 SOUTH ELM STREET, SUITE #104
 DENTON, TX 76201
 PH: 940.222.3009 CONTACT NAME: MATTHEW RAABE

LEGAL DESCRIPTION:
 TRACT SITUATED IN THE SPENCER RICE SURVEY, ABSTRACT NO. 787, TOWN OF PROSPER, COLLIN COUNTY, TEXAS
 ZONING: PLANNED DEVELOPMENT - PD-116 (O)

CITY: PROSPER STATE: TEXAS

COUNTY: COLLIN SURVEY: SPENCER RICE ABSTRACT NO. 787

DESIGN: JC
 DRAWN: SS
 CHECKED: JC
 DATE: 03/16/2026

SHEET LP-4

FILE NO. 2025-071

TEXAS REGISTRATION #14199

CLAYMOORE ENGINEERING

3231 HARWOOD ROAD
 BEDFORD, TX 76021
 WWW.CLAYMOOREENG.COM

REGISTERED LANDSCAPE ARCHITECT
 STEPHEN W. GATES
 STATE OF TEXAS
 3470

03/16/2026

FRONTIER SOUTH
 N. PRESTON ROAD,
 TOWN OF PROSPER, TX

NO.	DATE	REVISION	BY

LANDSCAPE SPECIFICATIONS AND DETAILS