

LANDSCAPE PLAN
SCALE: 1" = 20'-0"

LANDSCAPE CALCULATIONS

STREET FRONTAGE:	
SIXTH ST:	90 LF
LARGE 3" CALIPER TREES REQUIRED:	3 TREES (1 TREE/40 LF)
LARGE 3" CALIPER TREES PROVIDED:	3
COLEMAN ST:	
LARGE 3" CALIPER TREES REQUIRED:	140 LF
LARGE 3" CALIPER TREES PROVIDED:	4 TREES (1 TREE/40 LF)
PARKING LOT	
TOTAL PARKING SPACES:	12
REQUIRED INTERIOR LANDSCAPE AREA:	240 SF (20 SF/ PARKING SPACE)
PROVIDED INTERIOR LANDSCAPE AREA:	324 SF
1 TREE PROVIDED AT THE TERMINUS OF EACH PARKING BAY 6FT WOODEN FENCE PROVIDED FOR SOLID SCREENING	
PERIMETER LANDSCAPE	
EAST PROPERTY LINE:	139 LF
TREES REQUIRED	
(1 ORNAMENTAL TREE/130 LF):	5
TREES PROVIDED:	5

MULCHES

AFTER ALL PLANTING IS COMPLETE, CONTRACTOR SHALL INSTALL 3" THICK LAYER OF 1" RIVER ROCK MULCH, BEIGE COLOR, IN ALL PLANTING AREAS (EXCEPT FOR TURF AND SEEDED AREAS). CONTRACTOR SHALL SUBMIT SAMPLES OF ALL MULCHES TO LANDSCAPE ARCHITECT AND OWNER FOR APPROVAL PRIOR TO CONSTRUCTION. ABSOLUTELY NO EXPOSED GROUND SHALL BE LEFT SHOWING ANYWHERE ON THE PROJECT AFTER MULCH HAS BEEN INSTALLED (SUBJECT TO THE CONDITIONS AND REQUIREMENTS OF THE "GENERAL GRADING AND PLANTING NOTES" AND SPECIFICATIONS)

PLANTING AND IRRIGATION GUARANTEE

THE LANDSCAPE CONTRACTOR SHALL GUARANTEE THAT ALL NEWLY INSTALLED AND EXISTING PLANTS SHALL SURVIVE FOR ONE YEAR AFTER FINAL OWNER ACCEPTANCE OF THE INSTALLATION WORK. THE CONTRACTOR SHALL ALSO BE RESPONSIBLE FOR APPROPRIATE WATER OF THE LANDSCAPE THROUGH INSTALLATION OF A PROPERLY DESIGNED IRRIGATION SYSTEM. THE OWNER SHALL APPROVE THE SYSTEM DESIGN BEFORE INSTALLATION OF PLANTS OR IRRIGATION.

SHADE TREES						
SYMBOL	BOTANICAL NAME	COMMON NAME	SIZE @ PLANTING	SPACING	QUANTITY	REMARKS
	ULMUS CRASSIFOLIA	CEDAR ELM	3" CALIBER 10' TO 12' HIGH	PER PLAN	2	

ORNAMENTAL TREES						
SYMBOL	BOTANICAL NAME	COMMON NAME	SIZE @ PLANTING	SPACING	QUANTITY	REMARKS
	ACER PALMATUM ATROPURPUREUM	JAPANESE RED MAPLE	3" CALIBER 8 TO 10' HIGH	PER PLAN	9	

GROUND COVER/GRASS						
SYMBOL	BOTANICAL NAME	COMMON NAME	SIZE @ PLANTING	SPACING	QUANTITY	REMARKS
	COLOCASIA	CAROLYN WHORTON CALADIUM	1.25 QUART	6" TO 9"	XX	
	CYNODON DACTYLON	BERMUDA GRASS	SOD	CONTINUOUS COVER	XX	

SHRUBS						
SYMBOL	BOTANICAL NAME	COMMON NAME	SIZE @ PLANTING	SPACING	QUANTITY	REMARKS
	BUXUS SEMPERVIRENS 'SUFFRUTICOSA'	DWARF ENGLISH BOXWOOD	3 GALLON	4'-0" O.C.	9	
	ILEX VOMITORIA NANA	DWARF YAUPON HOLLY	3 GALLON	4'-0" O.C.	9	

Town of Prosper landscape general notes

- Standard language and/or notations, as follows:
- Plant material shall be measured and sized according to the latest edition of the American Standard for Nursery Stock (ANSI Z60.1).
 - All plant substitutions are subject to Town approval and must be specified on the approved landscape plan.
 - Ground covers used in lieu of turf grass must provide complete coverage within one (1) year of planting and maintain adequate coverage as approved by the Town.
 - Trees must be planted four (4) feet or greater from curbs, sidewalks, utility lines, screening walls, and all structures. Single-trunk trees shall have a single, straight leader, and all trees shall be full, with balanced canopy. Major damage to trunk(s), or branches, will be cause for denial.
 - All root flares shall be set at three (3) to four (4) inches above surrounding grade
 - The tree pit shall be backfilled with native topsoil free of rock and other debris
 - Burlap, twine, and wire baskets shall be severed and removed from the top of the root ball.
 - A 3-4" layer of mulch shall be provided around the base of the planted tree. The mulch shall be pulled back 1-2" from the trunk of the tree.
 - No person(s) or entity may use improper or malicious maintenance or pruning techniques including, but not limited to, topping or other non symmetrical trimming of trees, damage from a backhoe, or use of fire or poison. Follow the American Standard for Nursery Stock (ANSI Z60.1) guidelines on pruning and maintenance.
 - Landscape Computations Table: square footage of required/provided landscape area for perimeter and interior parking, number of trees/shrubs required/provided; credits for existing trees and substitutions*, in lieu of payment
 - Hardscape and other materials— location, size, etc (i.e. trails and sidewalks, art, bridges, paving, benches, screens, fountains, ponds including depth of water, or other landscape features)*
 - Proposed plant materials— name (common and scientific) location, spacing size (height and spread at time of planting) in a legend. Create separate legends for: Trees for mitigation credits (show total required mitigation from Tree Mitigation Schedule and total credits) and plants for living screens in lieu of screening wall*
 - Label all plant symbols on plan by grouping (on individual pages).
 - Assure coverage of right-of-way complete to existing street.
 - Existing and proposed topography, with berms, which can encroach into non-TXDOT right-of-ways (maximize allowable space based on 3:1 height) detailing with one (1) foot contours and slope indicated.
 - Include tree mitigation plan note(s) for any transplants, trees in addition to those being mandatory and payment amounts. If no trees existing on this property, add this note: "NO EXISTING TREES ON THIS SITE".
 - Detailed structural designs of entryway features (separate sheet including easements and utilities), elevations including description of maintenance provisions
 - Topsoil shall be a minimum of eight (8) inches in depth in planting areas. Soil shall be free of stones, roots, and clods and any other foreign material that is not beneficial for plant growth.
 - All plant beds shall be top-dressed with a minimum of three (3) inches of mulch.
 - Trees overhanging walks and parking shall have a minimum clear branch height of seven (7) feet. Trees overhanging public street pavement drive aisles and fire lanes shall have a minimum clear branch height of fourteen (14) feet.
 - A visibility triangle must be provided at all intersections, where shrubs are not to exceed thirty (30) inches in height, and trees shall have a minimum clear trunk height of nine (9) feet.
 - Trees planted on a slope shall have the tree well at the average grade of the uphill slope.
 - All areas of less than three (3) feet in width shall be grass, groundcover, or some type of Decorative river rock, pavers, or concrete.
 - The owner, tenant, and/or their agents, if any, shall be jointly and severally responsible for the maintenance, establishment, and permanence of plant material. All landscaping shall be maintained in a neat and orderly at all times including, but not limited to, mowing, edging, pruning, fertilizing, watering, de-weeding, and trash removal.
 - Plant material that is damaged, destroyed, or removed shall be replaced with Plants meeting minimum specifications per landscape plan. All turf/ground cover areas are to be established prior to receipt of Certificate of Occupancy, unless otherwise approved by the Town.
 - An automatic irrigation system shall be provided to irrigate all landscape areas into streets, sidewalks, or alleys.
 - No planting areas shall exceed 3:1 slope (3 ft Horizontal to 1 ft Vertical).
 - Earthen berms shall not include construction debris.
 - All walkways shall meet ADA and TAS requirements.
 - Landscape installation must comply with approved landscape plans, and as-built plans submitted to Parks and Recreation, prior to final acceptance by the Town and/or obtaining a Certificate of Occupancy.
 - Final inspection and approval of screening walls, irrigation, and landscape is subject to all public utilities, including but not limited to manholes, valves, water meters, cleanouts, and other appurtenances being accessible, adjusted to grade, and to the Town of Prosper Public Works Department standards.
 - IMPORTANT: MINIMUM STANDARDS FOR PLANTS, AS SET FORTH IN THE ZONING ORDINANCE AND APPROVED LANDSCAPE PLANS ARE TAKEN SERIOUSLY BY THE TOWN AND PARKS AND RECREATION. INSTALLING INFERIOR PLANTS WITHOUT WRITTEN APPROVAL FROM A PARKS REPRESENTATIVE MAY RESULT IN REJECTION OF SOME OR ALL PLANTS, THEREBY DELAYING RECEIPT OF A CERTIFICATE OF OCCUPANCY. ARCHITECTS AND LANDSCAPE CONTRACTORS ARE STRONGLY ENCOURAGED TO NOTIFY THE PARKS DEPARTMENT TO DISCUSS POSSIBLE DEFICIENCIES PRIOR TO INSTALLATION.
 - Call Parks and Recreation at (972) 569-1160 at least forty-eight (48) hours prior to the following inspections:
Proposed trail alignment
Berm construction & grading
Escrow release
Final inspection

LOT ONE, BLOCK ONE, PROSPER CENTRAL ADDITION
ZONING CASE 23-0029

DATE: _____ REVISION: _____ BY: _____

LANDSCAPE PLAN
EAST 6TH STREET MIXED USE FACILITY
N COLEMAN & E. 6TH STREETS PROSPER, TEXAS 75078

THOMAS DESIGN TECHNOLOGIES
ENGINEERS DESIGNERS PROJECT MANAGERS
1312 RABBIT RIDGE CEDAR HILL, TEXAS 75104
PHONE: (972) 672-8927 EMAIL: rthomas3710@att.net
TBPE FIRM REGISTRATION NO. F-6086

DESIGNED BY: THOMAS DESIGN TECH	CONTRACT NUMBER: 23-036	SHEET NO.:
DRAWN BY: THOMAS DESIGN TECH	FILE NAME: E 6th Street Mixed Use Civil Plans.Dwg	LS-1
REVIEWED BY: OWNER	TOTAL SHEETS:	9
PLOT SCALE: AS NOTED		
DATE: FEBRUARY 06, 2024		

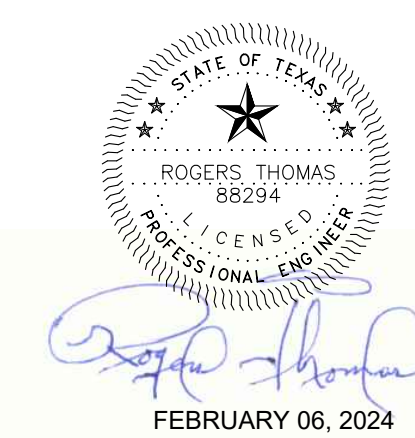

FEBRUARY 06, 2024

PLANTING SPECIFICATIONS

GENERAL

- A. QUALIFICATIONS OF LANDSCAPE CONTRACTOR**
- ALL LANDSCAPE WORK SHOWN ON THESE PLANS SHALL BE PERFORMED BY A SINGLE FIRM SPECIALIZING IN LANDSCAPE PLANTING.
 - A LIST OF SUCCESSFULLY COMPLETED PROJECTS OF THIS TYPE, SIZE AND NATURE MAY BE REQUESTED BY THE OWNER FOR FURTHER QUALIFICATION MEASURES.
 - THE LANDSCAPE CONTRACTOR SHALL HOLD A VALID NURSERY AND FLORAL CERTIFICATE ISSUED BY THE TEXAS DEPARTMENT OF AGRICULTURE, AS WELL AS OPERATE UNDER A COMMERCIAL PESTICIDE APPLICATOR LICENSE ISSUED BY EITHER THE TEXAS DEPARTMENT OF AGRICULTURE OR THE TEXAS STRUCTURAL PEST CONTROL BOARD.
- B. SCOPE OF WORK**
- WORK COVERED BY THESE SECTIONS INCLUDES THE FURNISHING AND PAYMENT OF ALL MATERIALS, LABOR, SERVICES, EQUIPMENT, LICENSES, TAXES AND ANY OTHER ITEMS THAT ARE NECESSARY FOR THE EXECUTION, INSTALLATION AND COMPLETION OF ALL WORK, SPECIFIED HEREIN AND / OR SHOWN ON THE LANDSCAPE PLANS, NOTES, AND DETAILS.
 - ALL WORK SHALL BE PERFORMED IN ACCORDANCE WITH ALL APPLICABLE LAWS, CODES AND REGULATIONS REQUIRED BY AUTHORITIES HAVING JURISDICTION OVER SUCH WORK, INCLUDING ALL INSPECTIONS AND PERMITS REQUIRED BY FEDERAL, STATE AND LOCAL AUTHORITIES IN SUPPLY, TRANSPORTATION AND INSTALLATION OF MATERIALS.
 - THE LANDSCAPE CONTRACTOR SHALL VERIFY THE LOCATION OF ALL UNDERGROUND UTILITY LINES (WATER, SEWER, ELECTRICAL, TELEPHONE, GAS, CABLE, TELEVISION, ETC.) PRIOR TO THE START OF ANY WORK.

PRODUCTS

- A. ALL MANUFACTURED PRODUCTS SHALL BE NEW.**
- B. CONTAINER AND BALLED-AND-BURLAPPED PLANTS:**
- FURNISH NURSERY-GROWN PLANTS COMPLYING WITH ANSI Z60.1-2004. PROVIDE WELL-SHAPED, FULLY BRANCHED, HEALTHY, VIGOROUS STOCK FREE OF DISEASE, INSECTS, EGGS, LARVAE, AND DEFECTS SUCH AS KNOTS, SUN SCALD, INJURIES, ABRASIONS, AND DISFIGUREMENT. ALL PLANTS WITHIN A SPECIES SHALL HAVE SIMILAR SIZE, AND SHALL BE OF A FORM TYPICAL FOR THE SPECIES. ALL TREES SHALL BE OBTAINED FROM SOURCES WITHIN 200 MILES OF THE PROJECT SITE, AND WITH SIMILAR CLIMATIC CONDITIONS.
 - ROOT SYSTEMS SHALL BE HEALTHY, DENSELY BRANCHED ROOT SYSTEMS, NON-POT-BOUND, FREE FROM ENCRICLING AND/OR GIRDLING ROOTS, AND FREE FROM ANY OTHER ROOT DEFECTS (SUCH AS J-SHAPED ROOTS).
 - ANY PLANT DEEMED UNACCEPTABLE BY THE LANDSCAPE ARCHITECT OR OWNER SHALL BE IMMEDIATELY REMOVED FROM THE SITE AND SHALL BE REPLACED WITH AN ACCEPTABLE PLANT OF LIKE TYPE AND SIZE AT THE CONTRACTOR'S OWN EXPENSE. ANY PLANTS APPEARING TO BE UNHEALTHY, EVEN IF DETERMINED TO STILL BE ALIVE, SHALL NOT BE ACCEPTED. THE LANDSCAPE ARCHITECT AND OWNER SHALL BE THE SOLE JUDGES AS TO THE ACCEPTABILITY OF PLANT MATERIAL.
 - ALL TREES SHALL BE STANDARD IN FORM, UNLESS OTHERWISE SPECIFIED. TREES WITH CENTRAL LEADERS WILL NOT BE ACCEPTED IF LEADER IS DAMAGED OR REMOVED. PRUNE ALL DAMAGED TWIGS AFTER PLANTING.
 - CALIPER MEASUREMENTS FOR STANDARD (SINGLE TRUNK) TREES SHALL BE AS FOLLOWS: SIX INCHES ABOVE THE ROOT FLARE FOR TREES UP TO AND INCLUDING FOUR INCHES IN CALIPER, AND TWELVE INCHES ABOVE THE ROOT FLARE FOR TREES EXCEEDING FOUR INCHES IN CALIPER.
 - MULTI-TRUNK TREES SHALL BE MEASURED BY THEIR OVERALL HEIGHT, MEASURED FROM THE TOP OF THE ROOT BALL.
 - ANY TREE OR SHRUB SHOWN TO HAVE EXCESS SOIL PLACED ON TOP OF THE ROOT BALL, SO THAT THE ROOT FLARE HAS BEEN COMPLETELY COVERED, SHALL BE REJECTED.
- C. SOD:** PROVIDE WELL-ROOTED SOD OF THE VARIETY NOTED ON THE PLANS. SOD SHALL BE CUT FROM HEALTHY, MATURE TURF WITH SOIL THICKNESS OF 3/4" TO 1". EACH PALLET OF SOD SHALL BE ACCOMPANIED BY A CERTIFICATE FROM SUPPLIER STATING THE COMPOSITION OF THE SOD.
- D. SEED:** PROVIDE BLEND OF SPECIES AND VARIETIES AS NOTED ON THE PLANS, WITH MAXIMUM PERCENTAGES OF PURITY, GERMINATION, AND MINIMUM PERCENTAGE OF WEED SEED AS INDICATED ON PLANS. EACH BAG OF SEED SHALL BE ACCOMPANIED BY A TAG FROM THE SUPPLIER INDICATING THE COMPOSITION OF THE SEED.
- E. TOPSOIL:** SANDY TO CLAY LOAM TOPSOIL, FREE OF STONES LARGER THAN 1/2" INCH, FOREIGN MATTER, PLANTS, ROOTS, AND SEEDS.
- F. COMPOST:** WELL-COMPOSTED, STABLE, AND WEED-FREE ORGANIC MATTER, pH RANGE OF 5.5 TO 8; MOISTURE CONTENT 30 TO 55 PERCENT BY WEIGHT; 100 PERCENT PASSING THROUGH 3/4-INCH SIEVE; SOLUBLE SALT CONTENT OF 5 TO 10 DECISIMENS/M; NOT EXCEEDING 0.5 PERCENT INERT CONTAMINANTS AND FREE OF SUBSTANCES TOXIC TO PLANTINGS. NO MANURE OR ANIMAL-BASED PRODUCTS SHALL BE USED.
- G. FERTILIZER:** GRANULAR FERTILIZER CONSISTING OF NITROGEN, PHOSPHORUS, POTASSIUM, AND OTHER NUTRIENTS IN PROPORTIONS, AMOUNTS, AND RELEASE RATES RECOMMENDED IN A SOIL REPORT FROM A QUALIFIED SOIL-TESTING AGENCY (SEE BELOW).
- H. MULCH:** SIZE AND TYPE AS INDICATED ON PLANS, FREE FROM DELETERIOUS MATERIALS AND SUITABLE AS A TOP DRESSING OF TREES AND SHRUBS.
- I. WEED FABRIC:** 5 OUNCE, WOVEN, NEEDLE-PUNCHED FABRIC, SUCH AS DEWITT PROS LANDSCAPE FABRIC (OR APPROVED EQUAL).
- J. TREE STAKING AND GUYING**
- STAKES: 6' LONG GREEN METAL T-POSTS.
 - GUY AND TIE WIRE: ASTM A 641, CLASS 1, GALVANIZED-STEEL WIRE, 2-STRAND, TWISTED, 0.106 INCH DIAMETER.
 - STRAP CHAFING GUARD: REINFORCED NYLON OR CANVAS AT LEAST 1-1/2 INCH WIDE, WITH GROMMETS TO PROTECT TREE TRUNKS FROM DAMAGE.
- K. STEEL EDGING:** PROFESSIONAL STEEL EDGING, 14 GAUGE THICK X 4 INCHES WIDE, FACTORY PAINTED DARK GREEN. ACCEPTABLE MANUFACTURERS INCLUDE COL-MET OR APPROVED EQUAL.
- L. PRE-EMERGENT HERBICIDE:** ANY GRANULAR, NON-STAINING PRE-EMERGENT HERBICIDE THAT IS LABELED FOR THE SPECIFIC ORNAMENTALS OR TURF ON WHICH IT WILL BE UTILIZED. PRE-EMERGENT HERBICIDES SHALL BE APPLIED PER THE MANUFACTURER'S LABELED RATES.

METHODS

- A. SOIL PREPARATION**
- BEFORE STARTING WORK, THE LANDSCAPE CONTRACTOR SHALL VERIFY THAT THE GRADE OF ALL LANDSCAPE AREAS ARE WITHIN +/-0.1' OF FINISH GRADE. THE CONTRACTOR SHALL NOTIFY THE OWNER IMMEDIATELY SHOULD ANY DISCREPANCIES EXIST.
 - SOIL TESTING:
 - AFTER FINISH GRADES HAVE BEEN ESTABLISHED, CONTRACTOR SHALL HAVE SOIL SAMPLES TESTED BY AN ESTABLISHED SOIL TESTING LABORATORY FOR THE FOLLOWING: SOIL TEXTURAL CLASS, GENERAL SOIL FERTILITY, pH, ORGANIC MATTER CONTENT, SALT (CEC), LIME, SODIUM ADSORPTION RATIO (SAR) AND BORON CONTENT. EACH SAMPLE SUBMITTED SHALL CONTAIN NO LESS THAN ONE QUART OF SOIL.
 - CONTRACTOR SHALL ALSO SUBMIT THE PROJECT'S PLANT LIST TO THE LABORATORY ALONG WITH THE SOIL SAMPLES.
 - THE SOIL REPORT PRODUCED BY THE LABORATORY SHALL CONTAIN RECOMMENDATIONS FOR THE FOLLOWING (AS APPROPRIATE): GENERAL SOIL PREPARATION AND BACKFILL MIXES, PRE-PLANT FERTILIZER APPLICATIONS, AND ANY OTHER SOIL RELATED ISSUES. THE REPORT SHALL ALSO PROVIDE A FERTILIZER PROGRAM FOR THE ESTABLISHMENT PERIOD AND FOR LONG-TERM MAINTENANCE.
 - THE CONTRACTOR SHALL INSTALL SOIL AMENDMENTS AND FERTILIZERS PER THE SOILS REPORT RECOMMENDATIONS. ANY CHANGE IN COST DUE TO THE SOIL REPORT RECOMMENDATIONS, EITHER INCREASE OR DECREASE, SHALL BE SUBMITTED TO THE OWNER WITH THE REPORT.
 - FOR BIDDING PURPOSES ONLY, THE SOIL PREPARATION SHALL CONSIST OF THE FOLLOWING:
 - TURF: INCORPORATE THE FOLLOWING AMENDMENTS INTO THE TOP 8" OF SOIL BY MEANS OF ROTOTILLING AFTER CROSS-RIPPING:
 - NITROGEN STABILIZED ORGANIC AMENDMENT - 4 CU. YDS. PER 1,000 S.F.
 - AMMONIUM PHOSPHATE 16-20-0 - 15 LBS PER 1,000 S.F.
 - AGRICULTURAL GYPSUM - 100 LBS PER 1,000 S.F.
 - TREES, SHRUBS, AND PERENNIALS: INCORPORATE THE FOLLOWING AMENDMENTS INTO THE TOP 8" OF SOIL BY MEANS OF ROTOTILLING AFTER CROSS-RIPPING:
 - NITROGEN STABILIZED ORGANIC AMENDMENT - 4 CU. YDS. PER 1,000 S.F.
 - 12-12-12 FERTILIZER - 10 LBS. PER CU. YD.
 - AGRICULTURAL GYPSUM - 10 LBS. PER CU. YD.
 - IRON SULPHATE - 2 LBS. PER CU. YD.
 - CONTRACTOR SHALL ENSURE THAT THE GRADE IN SOD AREAS SHALL BE 1" BELOW FINISH GRADE BEFORE INSTALLING SOIL AMENDMENTS, AND 2" BELOW FINISH GRADE IN SHRUB AREAS BEFORE INSTALLING SOIL AMENDMENTS. MULCH COVER WITHIN 6" OF CONCRETE WALKS AND CURBS SHALL NOT PROTRUDE ABOVE THE FINISH SURFACE OF THE WALKS AND CURBS. MULCH COVER WITHIN 12" OF WALLS SHALL BE AT LEAST 3" LOWER THAN THE TOP OF WALL.
 - ONCE SOIL PREPARATION IS COMPLETE, THE LANDSCAPE CONTRACTOR SHALL ENSURE THAT THERE ARE NO DEBRIS, TRASH, OR STONES LARGER THAN 1" REMAINING IN THE TOP 6" OF SOIL.

- B. GENERAL PLANTING**
- REMOVE ALL NURSERY TAGS AND STAKES FROM PLANTS.
 - EXCEPT IN AREAS TO BE PLANTED WITH ORNAMENTAL GRASSES, APPLY PRE-EMERGENT HERBICIDES AT THE MANUFACTURER'S RECOMMENDED RATE.
 - TRENCHING NEAR EXISTING TREES:
 - CONTRACTOR SHALL NOT DISTURB ROOTS 1-1/2" AND LARGER IN DIAMETER WITHIN THE CRITICAL ROOT ZONE (CRZ) OF EXISTING TREES, AND SHALL EXERCISE ALL POSSIBLE CARE AND PRECAUTIONS TO AVOID INJURY TO TREE ROOTS, TRUNKS, AND BRANCHES. THE CRZ IS DEFINED AS A CIRCULAR AREA EXTENDING OUTWARD FROM THE TREE TRUNK, WITH A RADIUS EQUAL TO 1' FOR EVERY 1" OF TRUNK DIAMETER-AT-BREAST-HEIGHT (4.5' ABOVE THE AVERAGE GRADE AT THE TRUNK).
 - ALL EXCAVATION WITHIN THE CRZ SHALL BE PERFORMED USING HAND TOOLS. NO MACHINE EXCAVATION OR TRENCHING OF ANY KIND SHALL BE ALLOWED WITHIN THE CRZ.
 - ALTER ALIGNMENT OF PIPE TO AVOID TREE ROOTS 1-1/2" AND LARGER IN DIAMETER. WHERE TREE ROOTS 1-1/2" AND LARGER IN DIAMETER ARE ENCOUNTERED IN THE FIELD, TUNNEL UNDER SUCH ROOTS. WRAP EXPOSED ROOTS WITH SEVERAL LAYERS OF BURLAP AND KEEP MOIST. CLOSE ALL TRENCHES WITHIN THE CANOPY DRIP LINES WITHIN 24 HOURS.
 - ALL SEVERED ROOTS SHALL BE HAND PRUNED WITH SHARP TOOLS AND ALLOWED TO AIR-DRY. DO NOT USE ANY SORT OF SEALERS OR WOUND PAINTS.
- C. TREE PLANTING**
- TREE PLANTING HOLES SHALL BE EXCAVATED TO MINIMUM WIDTH OF TWO TIMES THE WIDTH OF THE ROOTBALL, AND TO A DEPTH EQUAL TO THE DEPTH OF THE ROOTBALL LESS TWO INCHES.
 - SCARIFY THE SIDES AND BOTTOM OF THE PLANTING HOLE PRIOR TO THE PLACEMENT OF THE TREE. REMOVE ANY GLAZING THAT MAY HAVE BEEN CAUSED DURING THE EXCAVATION OF THE HOLE.
 - FOR CONTAINER TREES, TO REMOVE ANY POTENTIALLY GIRDLING ROOTS AND OTHER ROOT DEFECTS, THE CONTRACTOR SHALL SHAVE A 1" LAYER OFF OF THE SIDES AND BOTTOM OF THE ROOTBALL OF ALL TREES JUST BEFORE PLACING INTO THE PLANTING PIT. DO NOT "TEASE" ROOTS OUT FROM THE ROOTBALL.
 - INSTALL THE TREE ON UNDISTURBED SUBGRADE SO THAT THE TOP OF THE ROOTBALL IS TWO TO THREE INCHES ABOVE THE SURROUNDING GRADE.
 - BACKFILL THE TREE HOLE UTILIZING THE EXISTING TOPSOIL FROM ON-SITE. ROCKS LARGER THAN 1" DIA. AND ALL OTHER DEBRIS SHALL BE REMOVED FROM THE SOIL PRIOR TO THE BACKFILL. SHOULD ADDITIONAL SOIL BE REQUIRED TO ACCOMPLISH THIS TASK, IMPORT ADDITIONAL TOPSOIL FROM OFF-SITE AT NO ADDITIONAL COST TO THE OWNER.
 - THE TOTAL NUMBER OF TREE STAKES (BEYOND THE MINIMUMS LISTED BELOW) WILL BE LEFT TO THE LANDSCAPE CONTRACTOR'S DISCRETION. SHOULD ANY TREES FALL OR LEAN, THE LANDSCAPE CONTRACTOR SHALL STRAIGHTEN THE TREE, OR REPLACE IT SHOULD IT BECOME DAMAGED. TREE STAKING SHALL ADHERE TO THE FOLLOWING GUIDELINES:
 - 15 - 30 GAL TREES TWO STAKES PER TREE
 - 45 - 100 GAL TREES THREE STAKES PER TREE
 - MULTI-TRUNK TREES THREE STAKES PER TREE MINIMUM, POSITIONED AS NEEDED TO STABILIZE THE TREE.
 - UPON COMPLETION OF PLANTING, CONSTRUCT AN EARTH WATERING BASIN AROUND THE TREE. COVER THE INTERIOR OF THE TREE RING WITH THE WEED BARRIER CLOTH AND TOPDRESS WITH MULCH (TYPE AND DEPTH PER PLANS).
- D. SHRUB, PERENNIAL, AND GROUND COVER PLANTING**
- DIG THE PLANTING HOLES TWICE AS WIDE AND 2" LESS DEEP THAN EACH PLANT'S ROOTBALL. INSTALL THE PLANT IN THE HOLE. BACKFILL AROUND THE PLANT WITH SOIL AMENDED PER SOIL TEST RECOMMENDATIONS.
 - INSTALL THE WEED BARRIER CLOTH, OVERLAPPING IT AT THE ENDS. UTILIZE STEEL STAPLES TO KEEP THE WEED BARRIER CLOTH IN PLACE.
 - WHEN PLANTING IS COMPLETE, INSTALL MULCH (TYPE AND DEPTH PER PLANS) OVER ALL PLANTING BEDS, COVERING THE ENTIRE PLANTING AREA.
- E. SODDING**
- SOD VARIETY TO BE AS SPECIFIED ON THE LANDSCAPE PLAN.
 - LAY SOD WITHIN 24 HOURS FROM THE TIME OF STRIPPING. DO NOT LAY IF THE GROUND IS FROZEN.
 - LAY THE SOD TO FORM A SOLID MASS WITH TIGHTLY FITTED JOINTS. BUTT ENDS AND SIDES OF SOD STRIPS - DO NOT OVERLAP. STAGGER STRIPS TO OFFSET JOINTS IN ADJACENT COURSES.
 - ROLL THE SOD TO ENSURE GOOD CONTACT OF THE SOD'S ROOT SYSTEM WITH THE SOIL UNDERNEATH.
 - WATER THE SOD THOROUGHLY WITH A FINE SPRAY IMMEDIATELY AFTER PLANTING TO OBTAIN AT LEAST SIX INCHES OF PENETRATION INTO THE SOIL BELOW THE SOD.
- F. HYDROMULCHING**
- THE HYDROMULCH MIX (PER 1,000 SF) SHALL BE AS FOLLOWS:
 - WINTER MIX (OCTOBER 1 - MARCH 31)
 - 50# CELLULOSE FIBER MULCH
 - 2# UNHULLED BERMUDA SEED
 - 2# ANNUAL RYE SEED
 - 15# 15-15-15 WATER SOLUBLE FERTILIZER
 - SUMMER MIX (APRIL 1 - SEPTEMBER 30)
 - 50# CELLULOSE FIBER MULCH
 - 2# HULLED BERMUDA SEED
 - 15# 15-15-15 WATER SOLUBLE FERTILIZER
- G. CLEAN UP**
- DURING LANDSCAPE PREPARATION AND PLANTING, KEEP ALL PAVEMENT CLEAN AND ALL WORK AREAS IN A NEAT, ORDERLY CONDITION.
 - DISPOSED LEGALLY OF ALL EXCAVATED MATERIALS OFF THE PROJECT SITE.
- H. INSPECTION AND ACCEPTANCE**
- UPON COMPLETION OF THE WORK, THE LANDSCAPE CONTRACTOR SHALL PROVIDE THE SITE CLEAN, FREE OF DEBRIS AND TRASH, AND SUITABLE FOR USE AS INTENDED. THE LANDSCAPE CONTRACTOR SHALL THEN REQUEST AN INSPECTION BY THE OWNER TO DETERMINE FINAL ACCEPTABILITY.
 - WHEN THE INSPECTED PLANTING WORK DOES NOT COMPLY WITH THE CONTRACT DOCUMENTS, THE LANDSCAPE CONTRACTOR SHALL REPLACE AND/OR REPAIR THE REJECTED WORK TO THE OWNER'S SATISFACTION WITHIN 24 HOURS.
 - THE LANDSCAPE MAINTENANCE PERIOD WILL NOT COMMENCE UNTIL THE LANDSCAPE WORK HAS BEEN RE-INSPECTED BY THE OWNER AND FOUND TO BE ACCEPTABLE. AT THAT TIME, A WRITTEN NOTICE OF FINAL ACCEPTANCE WILL BE ISSUED BY THE OWNER, AND THE MAINTENANCE AND GUARANTEE PERIODS WILL COMMENCE.
- I. LANDSCAPE MAINTENANCE**
- THE LANDSCAPE CONTRACTOR SHALL BE RESPONSIBLE FOR THE MAINTENANCE OF ALL WORK SHOWN ON THESE PLANS FOR 90 DAYS BEYOND FINAL ACCEPTANCE OF ALL LANDSCAPE WORK BY THE OWNER. LANDSCAPE MAINTENANCE SHALL INCLUDE WEEKLY SITE VISITS FOR THE FOLLOWING ACTIONS (AS APPROPRIATE): PROPER PRUNING, RESTAKING OF TREES, RESETTING OF PLANTS THAT HAVE SETTLED, MOWING AND AERATION OF LAWNS, WEEDING, RESEEDING AREAS WHICH HAVE NOT GERMINATED WELL, TREATMENT OF INSECTS AND DISEASES, REPLACEMENT OF MULCH, REMOVAL OF LITTER, REPAIRS TO THE IRRIGATION SYSTEM DUE TO FAULTY PARTS AND/OR WORKMANSHIP, AND THE APPROPRIATE WATERING OF ALL PLANTINGS. THE LANDSCAPE CONTRACTOR SHALL MAINTAIN THE IRRIGATION SYSTEM IN PROPER WORKING ORDER, WITH SCHEDULING ADJUSTMENTS BY SEASON TO MAXIMIZE WATER CONSERVATION.
 - SHOULD SEEDED AND/OR SODDED AREAS NOT BE COVERED BY AN AUTOMATIC IRRIGATION SYSTEM, THE LANDSCAPE CONTRACTOR SHALL BE RESPONSIBLE FOR WATERING THESE AREAS AND OBTAINING A FULL, HEALTHY STAND OF GRASS AT NO ADDITIONAL COST TO THE OWNER.
 - TO ACHIEVE FINAL ACCEPTANCE AT THE END OF THE MAINTENANCE PERIOD, ALL OF THE FOLLOWING CONDITIONS MUST OCCUR:
 - THE LANDSCAPE SHALL SHOW ACTIVE, HEALTHY GROWTH (WITH EXCEPTIONS MADE FOR SEASONAL DORMANCY). ALL PLANTS NOT MEETING THIS CONDITION SHALL BE REJECTED AND REPLACED BY HEALTHY PLANT MATERIAL PRIOR TO FINAL ACCEPTANCE.
 - ALL HARDSCAPE SHALL BE CLEANED PRIOR TO FINAL ACCEPTANCE.
 - SODDED AREAS SHALL BE ACTIVELY GROWING AND MUST REACH A MINIMUM HEIGHT OF 1 1/2 INCHES BEFORE FIRST MOWING. HYDROMULCHED AREAS SHALL SHOW ACTIVE, HEALTHY GROWTH. BARE AREAS LARGER THAN TWELVE SQUARE INCHES SHALL BE RESEDDED OR RESEEDED (AS APPROPRIATE) PRIOR TO FINAL ACCEPTANCE. ALL SODDED TURF SHALL BE NEATLY MOWED.
- J. WARRANTY PERIOD, PLANT GUARANTEE AND REPLACEMENTS**
- THE LANDSCAPE CONTRACTOR SHALL GUARANTEE ALL TREES, SHRUBS, PERENNIALS, SOD, SEEDED/HYDROMULCHED AREAS, AND IRRIGATION SYSTEMS FOR A PERIOD OF ONE YEAR FROM THE DATE OF THE OWNER'S FINAL ACCEPTANCE (90 DAYS FOR ANNUAL PLANTS). THE CONTRACTOR SHALL REPLACE, AT HIS OWN EXPENSE AND TO THE SATISFACTION OF THE OWNER, ANY PLANTS WHICH DIE IN THAT TIME, OR REPAIR ANY PORTIONS OF THE IRRIGATION SYSTEM WHICH OPERATE IMPROPERLY.
 - AFTER THE INITIAL MAINTENANCE PERIOD AND DURING THE GUARANTEE PERIOD, THE LANDSCAPE CONTRACTOR SHALL ONLY BE RESPONSIBLE FOR REPLACEMENT OF PLANTS WHEN PLANT DEATH CANNOT BE ATTRIBUTED DIRECTLY TO OVERWATERING OR OTHER DAMAGE BY HUMAN ACTIONS. PROVIDE A MINIMUM OF (2) COPIES OF RECORD DRAWINGS TO THE OWNER UPON COMPLETION OF WORK. A RECORD DRAWING IS A RECORD OF ALL CHANGES THAT OCCURRED IN THE FIELD AND THAT ARE DOCUMENTED THROUGH CHANGE ORDERS, ADDENDA, OR CONTRACTOR/CONSULTANT DRAWING MARKUPS.

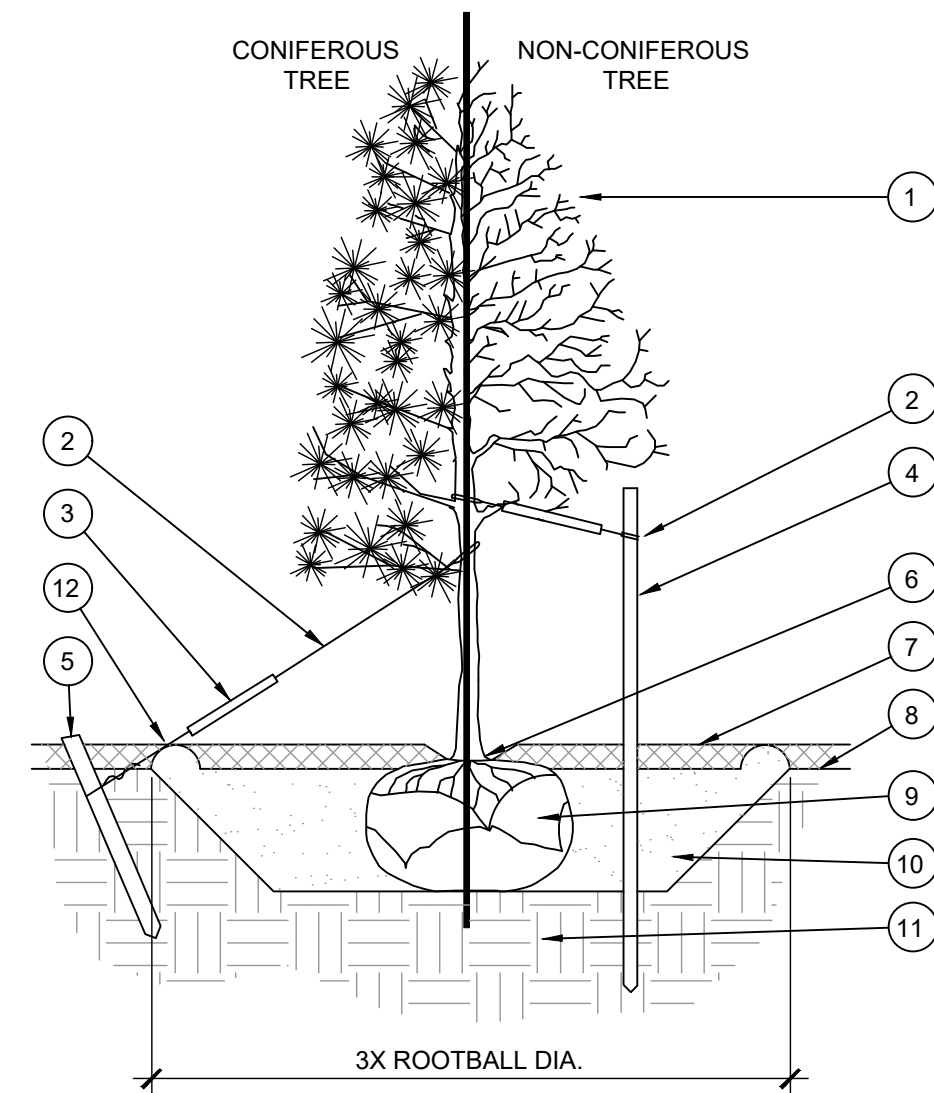

- TREE CANOPY.
- CINCH-TIES (24" BOX TREES AND SMALLER) OR 12 GAUGE GALVANIZED WIRE WITH NYLON TREE STRAPS AT TREE AND STAKE (36" BOX TREES AND LARGER); SECURE TIES OR STRAPS TO TRUNK JUST ABOVE LOWEST MAJOR BRANCHES.
- 24" X 3/4" P.V.C. MARKERS OVER WIRES.
- GREEN STEEL T-POSTS. EXTEND POSTS 12" MIN. INTO UNDISTURBED SOIL.
- PRESSURE-TREATED WOOD DEADMAN, TWO PER TREE (MIN.). BURY OUTSIDE OF PLANTING PIT AND 18" MIN. INTO UNDISTURBED SOIL.
- TRUNK FLARE.
- MULCH, TYPE AND DEPTH PER PLANS. DO NOT PLACE MULCH WITHIN 6" OF TRUNK.
- FINISH GRADE.
- ROOT BALL.
- BACKFILL. AMEND AND FERTILIZE ONLY AS RECOMMENDED IN SOIL FERTILITY ANALYSIS.
- UNDISTURBED NATIVE SOIL.
- 4" HIGH EARTHEN WATERING BASIN.

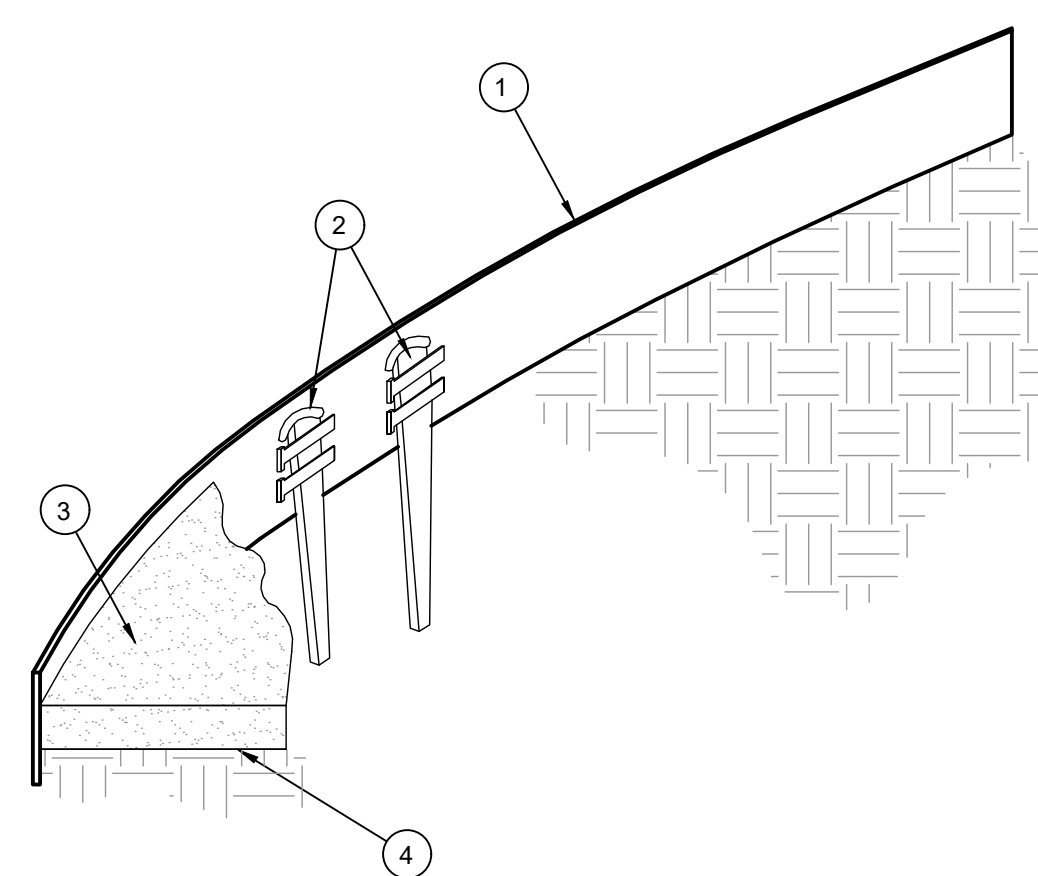

- ROLLED-TOP STEEL EDGING PER PLANS.
- TAPERED STEEL STAKES.
- MULCH, TYPE AND DEPTH PER PLANS.
- FINISH GRADE.

- NOTES:**
- INSTALL EDGING SO THAT STAKES WILL BE ON INSIDE OF PLANTING BED.
 - BOTTOM OF EDGING SHALL BE BURIED A MINIMUM OF 1" BELOW FINISH GRADE.
 - TOP OF MULCH SHALL BE 1" LOWER THAN TOP OF EDGING.

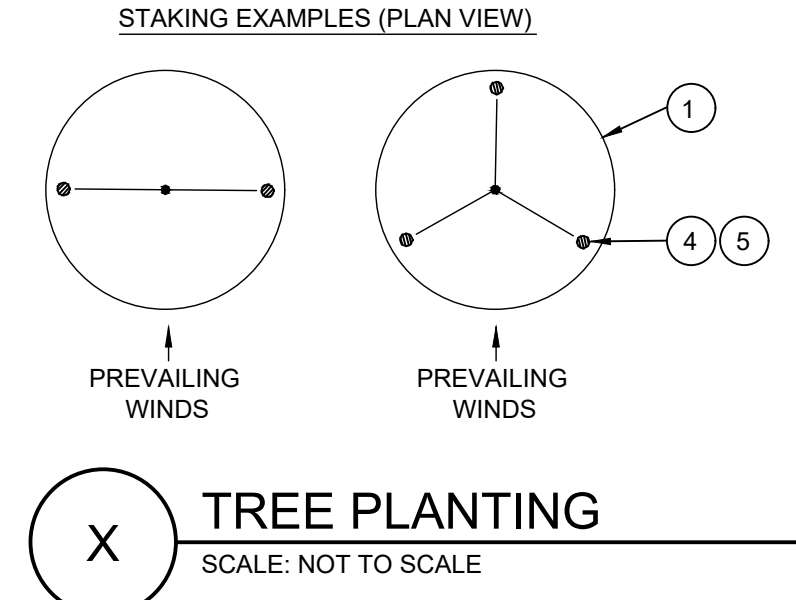

- NOTES:**
- SHRUB, PERENNIAL, OR ORNAMENTAL GRASS.
 - MULCH, TYPE AND DEPTH PER PLANS. PLACE NO MORE THAN 1" OF MULCH WITHIN 6" OF PLANT CENTER.
 - FINISH GRADE.
 - ROOT BALL.
 - BACKFILL. AMEND AND FERTILIZE ONLY AS RECOMMENDED IN SOIL FERTILITY ANALYSIS.
 - UNDISTURBED NATIVE SOIL.
 - 3" HIGH EARTHEN WATERING BASIN.
 - WEED FABRIC UNDER MULCH.



- CURB.
- MULCH LAYER.
- PLANT.
- TURF (WHERE SHOWN ON PLAN).

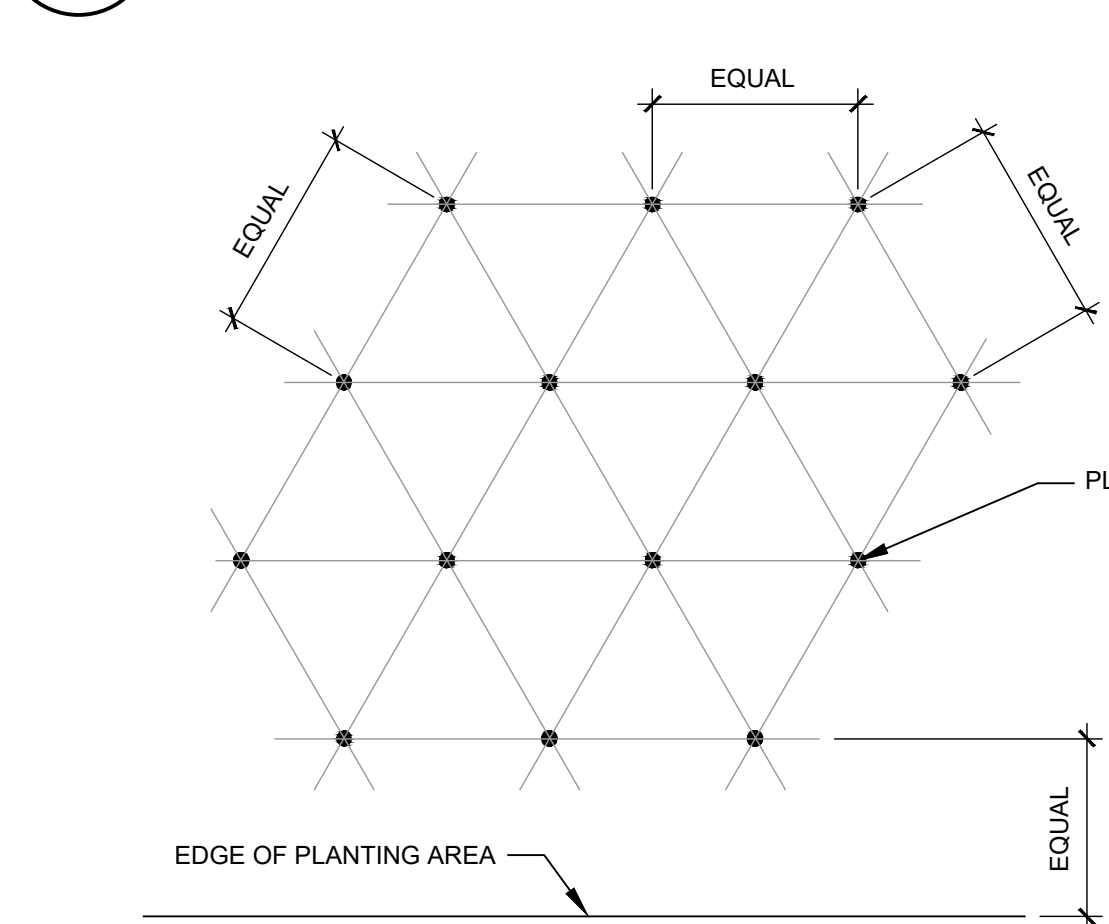
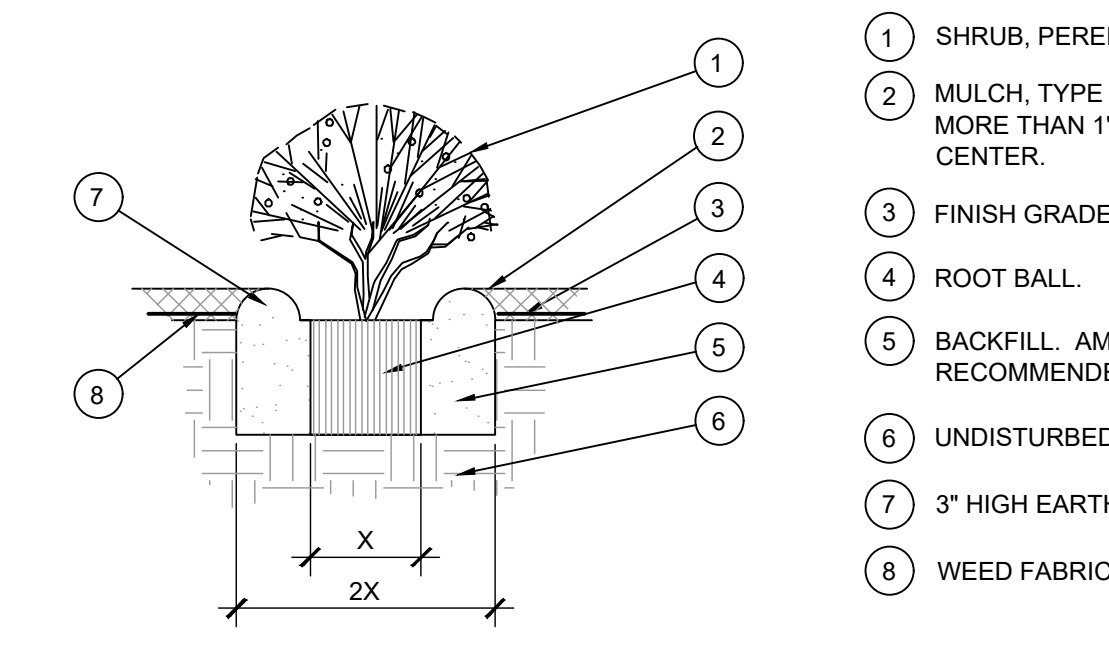

NOTE: ALL PLANTS SHALL BE PLANTED AT EQUAL TRIANGULAR SPACING (EXCEPT WHERE SHOWN ON PLANS AS INFORMAL GROUPINGS). REFER TO PLANT LEGEND FOR SPACING DISTANCE BETWEEN PLANTS.

PLANT SPACING	AREA DIVIDER TO DETERMINE NO. OF PLANTS
6"	0.25
8"	0.45
10"	0.69
12"	1
15"	1.56
18"	2.25
24"	4
30"	6.25
36"	9

EXAMPLE: PLANTS AT 18" O.C. IN 100 SF OF PLANTING AREA = 100/2.25 = 44 PLANTS

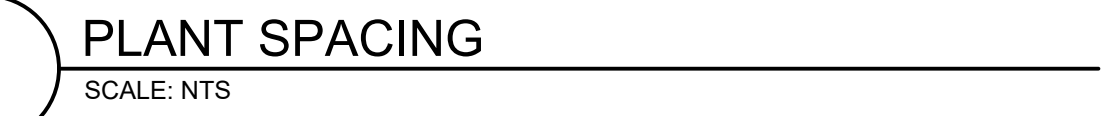

LOT ONE, BLOCK ONE, PROSPER CENTRAL ADDITION
ZONING CASE 23-0029

DATE	REVISION	BY

LANDSCAPING SPECIFICATIONS
EAST 6TH STREET MIXED USE FACILITY
N COLEMAN & E. 6TH STREETS PROSPER, TEXAS 75078

THOMAS DESIGN TECHNOLOGIES
ENGINEERS DESIGNERS PROJECT MANAGERS
1312 RABBIT RIDGE CEDAR HILL, TEXAS 75104
PHONE: (972) 672-8927 EMAIL: rthomas3710@AT.net
TBPFE FIRM REGISTRATION NO. F-6086

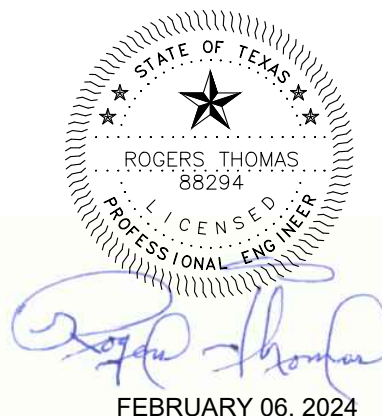

FEBRUARY 06, 2024

DESIGNED BY: THOMAS DESIGN TECH	CONTRACT NUMBER: 23-036	SHEET NO.: LS-2
DRAWN BY: THOMAS DESIGN TECH	FILE NAME: E 6th Street Mixed Use Civil Plans.Dwg	TOTAL SHEETS: 9
REVIEWED BY: OWNER	PLOT SCALE: AS NOTED	
DATE: FEBRUARY 06, 2024		