

Proposed retaining wall with screen wall to screen drive thru. Proposed new vegetation in front of retaining & screen wall. All lighting to remain.

Wall & fence will be reconstructed, in kind. The vegetation in this area will be updated/ supplemented.

Wall & fence will be reconstructed, in kind. The vegetation in this area will remain.

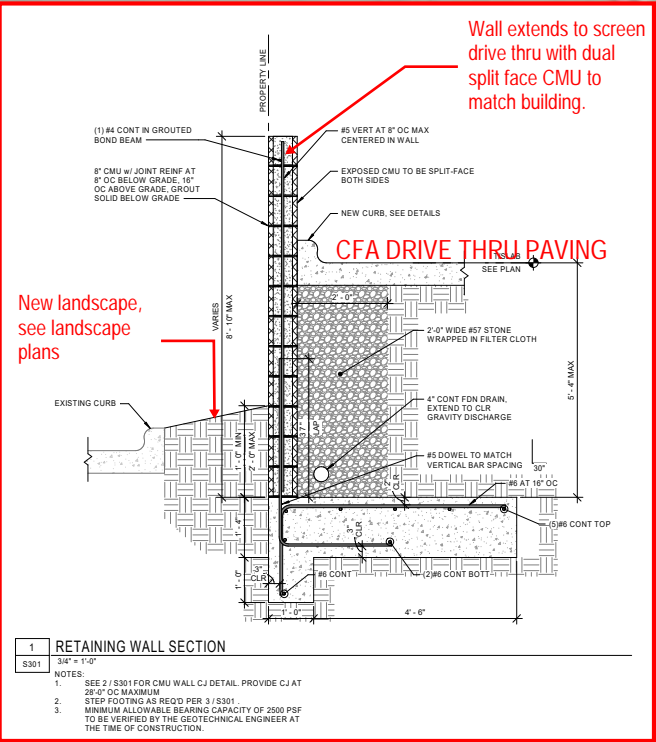

PROPOSED SCREEN WALL SCHEMATIC AT SOUTH PROPERTY LINE

CFA #3893 Gates of Prosper - Split-face CMU Wall at drive-thru & property line
1091 S. Preston Road, Prosper, TX 75078

