

Site Data Summary Table
Lot Area: 29,664.36 SF (0.689 AC)
Square Footage of Existing Structure: 1,365 SF
Proposed Use: Office*
Required Parking: 4 Spaces*
Provided Parking: 5 Spaces*
* Final use will dictate required parking count

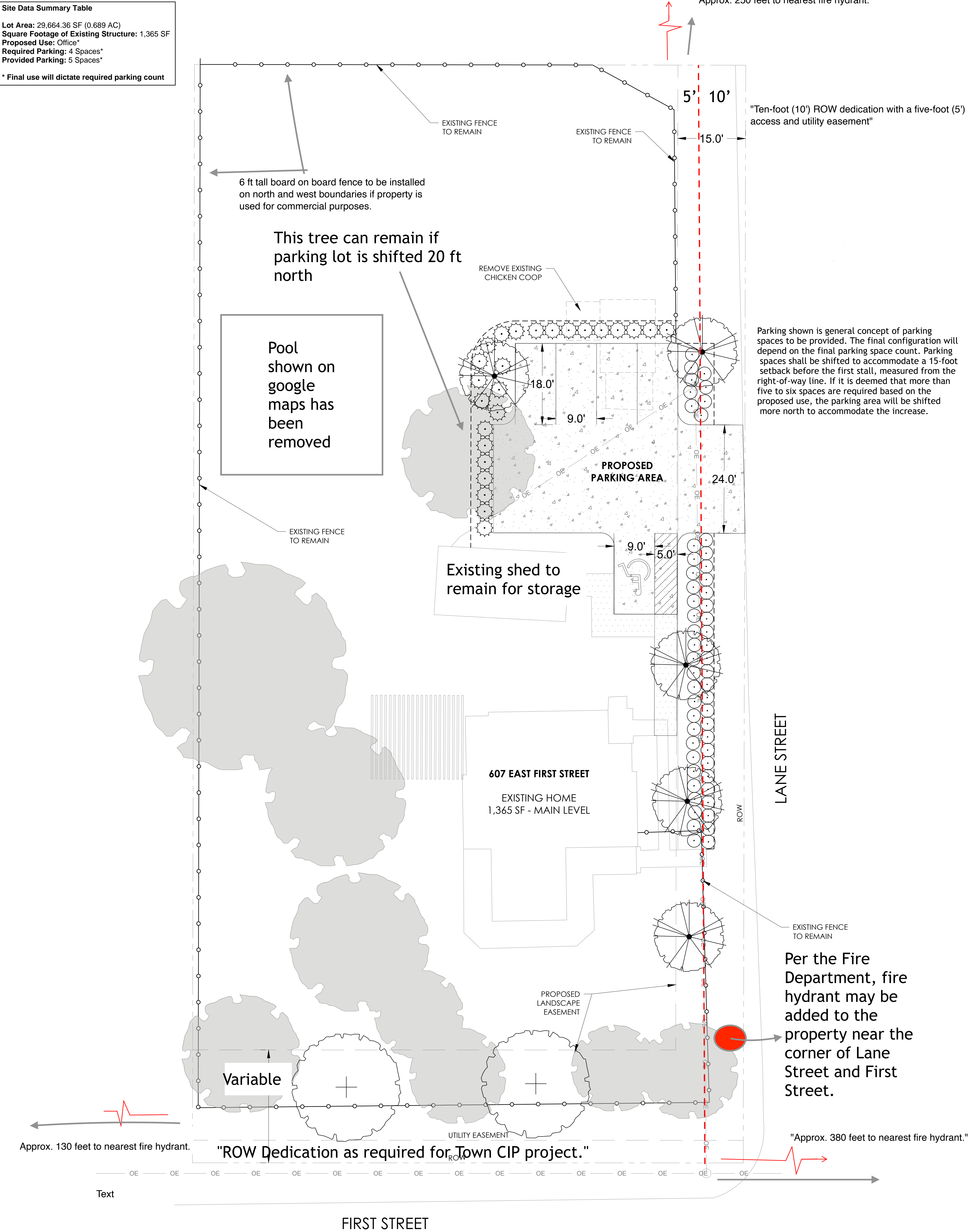

## 607 EAST FIRST STREET

ACREAGE: 0.681 ACRES  
TOWN PROJECT NUMBER: ZONE-25-0001  
EXHIBIT D - CONCEPT PLAN  
PROSPER, TEXAS  
APRIL 8, 2025

0 10 20  
SCALE IN FEET

