

Property ID: 38066 For Year

2024

View Map Print

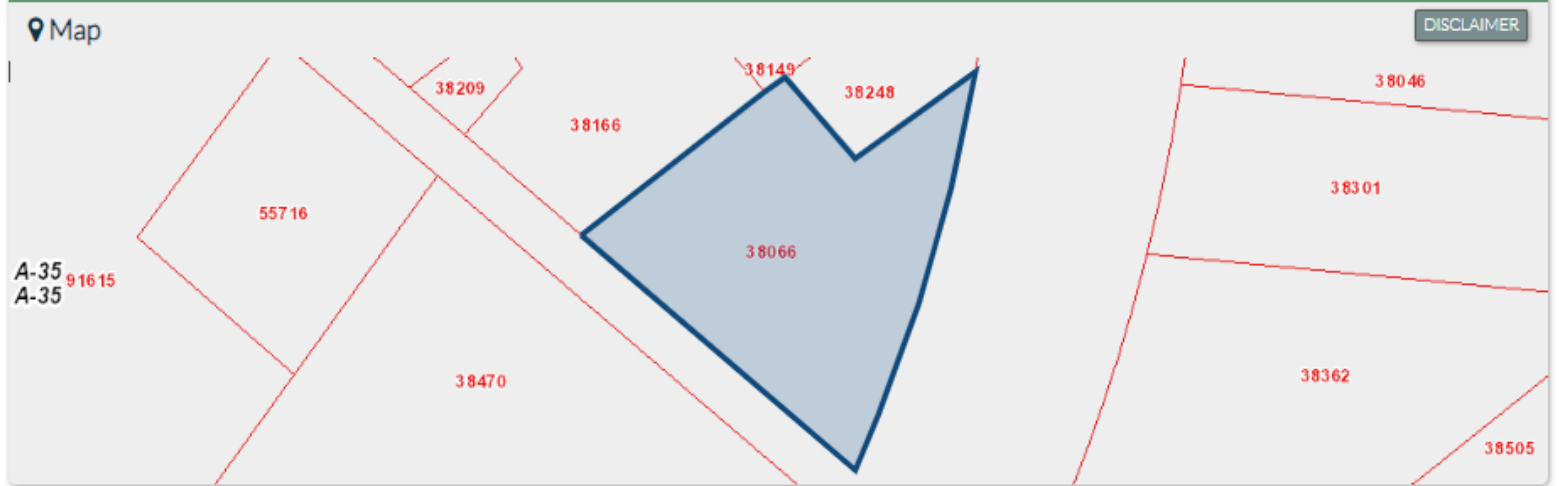

DISCLAIMER

Property Details		
Account		
Property ID:	38066	Geographic ID: A0035-00000-0146-00
Type:	Real	Zoning:
Property Use:	VL VACANT LAND	Condo:
Location		
Situs Address:	1019 HWY 35 S PORT LAVACA, TX 77979	
Map ID:	A0035-00090-0022-00	Mapsc0: 1550
Legal Description:	A0035 MAXIMO SANCHEZ, TRACT PT 30, ACRES 2.577	
Abstract/Subdivision:	A0035 - MAXIMO SANCHEZ	
Neighborhood:	1550	
Owner		
Owner ID:	55674	
Name:	SPEEDY STOP FOOD STORES	
Agent:		
Mailing Address:	PO BOX 1876 VICTORIA, TX 77902-1876	
% Ownership:	100.0%	
Exemptions:	For privacy reasons not all exemptions are shown online.	

Property Values	
Improvement Homesite Value:	\$0 (+)
Improvement Non-Homesite Value:	\$0 (+)
Land Homesite Value:	\$0 (+)
Land Non-Homesite Value:	\$207,670 (+)
Agricultural Market Valuation:	\$0 (+)
Market Value	
Market Value:	\$207,670 (=)
Agricultural Value Loss:	\$0 (-)
Appraised Value	
Appraised Value:	\$207,670 (=)
Homestead Cap Loss:	\$0 (-)
Assessed Value	
Assessed Value:	\$207,670
Ag Use Value:	\$0

Values displayed are 2024 preliminary values and are subject to change prior to certification. Information provided for research purposes only.