

DESIGN DATA:

2018 IRC
WIND VELOCITY: 145 MPH (Vult.)
IMPORTANCE CAT.: II
EXPOSURE: C

NOTE: KITCHEN AND BOILER ROOM CEILINGS
TO BE FIRE RESISTANT (2-HR), SEE DETAIL THIS SHEET

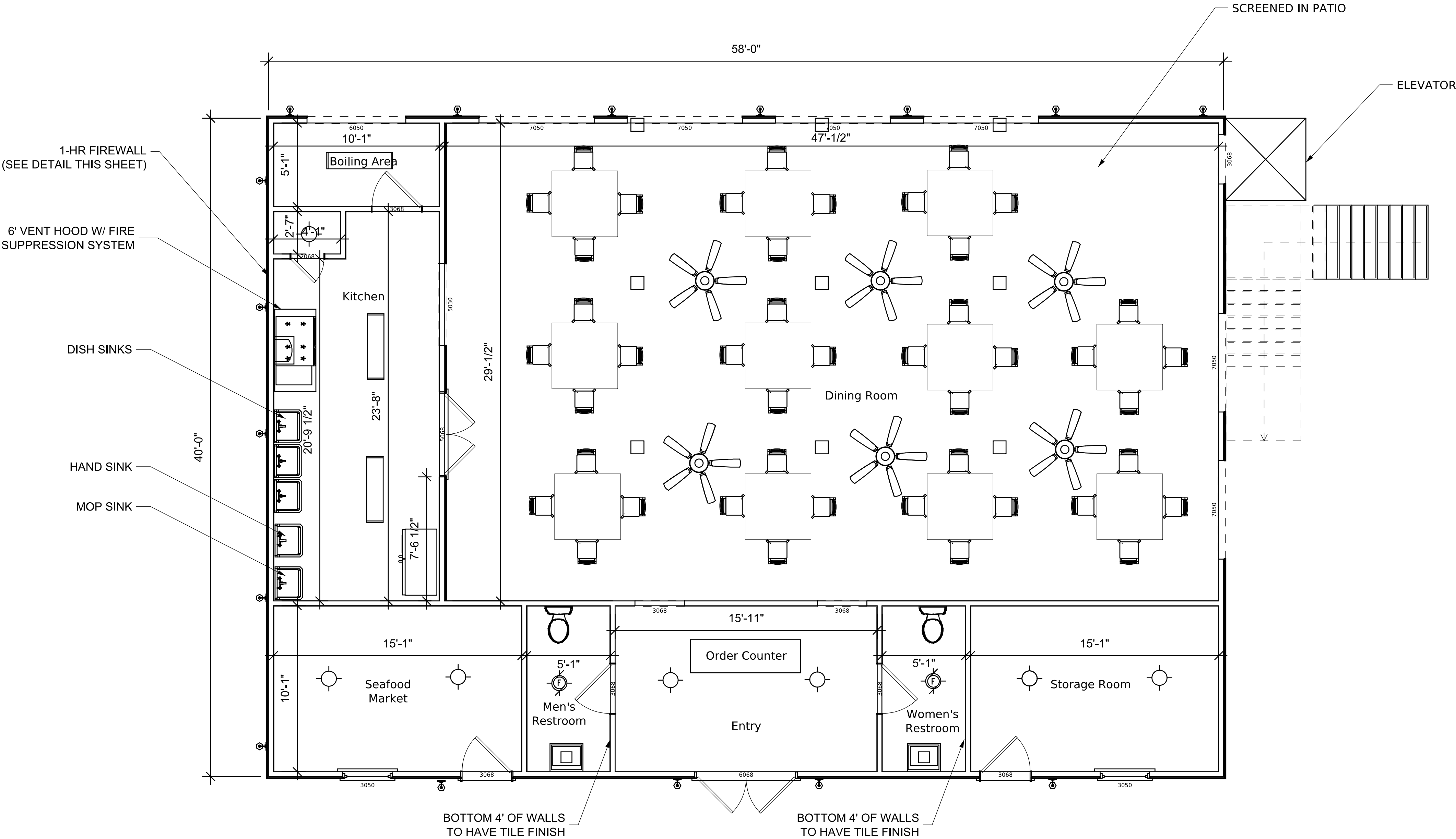

1st Floor Area: 2320 sf

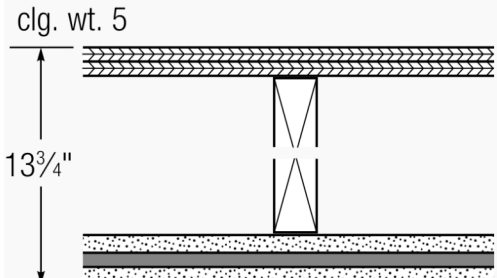
2 Hour Fire-Rated Construction		Dimensional Lumber		Acoustical Performance			Reference	
Construction Detail		Description	Test Number	STC	IIC	Test Number	ARL	Index
	cig. wt. 5	<ul style="list-style-type: none">Two layers 5/8" SHEETROCK FIRECODE C Core gypsum panels1" nominal wood sub and finished floor2 x 10 wood joist 16" o.c.RC-1 channel or equivalentjoints finished	UL Des L511			Assembly not recommended when sound control is a major consideration		B-71

2-HR FIRE RESISTANT CEILING DETAIL

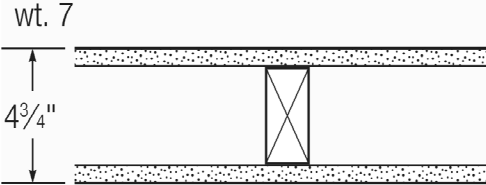
1 Hour Fire-Rated Construction		Loadbearing		Acoustical Performance		Reference	
Construction Detail		Description	Test Number	STC	Test Number	Index	
	wt. 7 49 1/4"	<ul style="list-style-type: none">5/8" SHEETROCK FIRECODE Core panels, or5/8" SHEETROCK UltraLight panels Firecode X, or5/8" Fiberox panels2 x 4 wood stud 16" or 24" o.c.optional insulation	UL Des U305, U314	32	RAL-TL11-129 Based on 5/8" SHEETROCK FIRECODE core panels, no sound bat	A-59	
				33	RAL-TL11-172 Based on 5/8" SHEETROCK UltraLight Panels Firecode X, no sound bat		
				34	RAL-TL11-173, RAL-TL11-130 Based on 5/8" SHEETROCK FIRECODE core panels or 5/8" SHEETROCK UltraLight Panels Firecode X with R-11 fiberglass sound bat		
				37	RAL-TL11-081, RAL-TL11-084 Based on double layer one side 5/8" SHEETROCK FIRECODE core panels or 5/8" SHEETROCK UltraLight Panels Firecode X with R-11 fiberglass sound bat		

1-HR FIRE RESISTANT WALL DETAIL

GENERAL NOTES

No.	REVISION/ISSUE	DATE

ORIENTATION	STAMP

ALL DRAWINGS ARE THE PROPERTY OF THE DESIGNER
AND THEY ARE NOT TO BE REPRODUCED IN WHOLE OR IN
PART WITHOUT THE WRITTEN CONSENT OF THE DESIGNER

CONTRACTOR TO CHECK AND VERIFY ALL DIMENSIONS
BEFORE COMMENCING WORK AND TO REPORT ANY
DISCREPANCIES TO THE DESIGNER

VEF Engineering
527 Elmhurst Drive
Port Lavaca, TX 77979
(361) 920-6240
TX Firm No. 17596

PROJECT NAME:
Nevarez House / Restaurant
212 S. Commerce Street
Port Lavaca, TX

CLIENT:
Kevin and Sasha Nevarez

DRAWING: **FLOOR PLAN**
1st Floor
SCALE: 1/4" = 1'-0" DATE: NOV. 2021

DRAWN BY: VEF	SHEET: 4
CHECKED BY: VEF	
APPROVED BY: VEF	