CITY OF PORT LAVACA

COUNCIL MEETING: OCTOBER 10, 2022

AGENDA ITEM __

DATE: 10.02.2022

TO: HONORABLE MAYOR AND CITY COUNCIL MEMBERS

FROM: JODY WEAVER, INTERIM CITY MANAGER;
WAYNE SHAFFER, PUBLIC WORKS DIRECTOR

SUBJECT: Skate Park improvement projects at Wilson park

BACKGROUND:

- 1) There is \$140,000 budgeted in Parks this year for Wilson Park improvements. We recently advertised for bids for the following scope of work approved by the Parks Board, which is shown on the attached Site Plan and Bid Form: (The engineer's estimate for the project scope was \$145,000)
 - Phase 1 of additional parking (11 spaces + 1 ADA space)
 - Sidewalks: from Seadrift St to skate surface; from existing parking lot to new phase 1 parking and to Seadrift St; from new parking to skate surface
 - 2 storm sewer inlets and pipes to provide drainage
 - Aluminum fencing along the right-of-way line of Seadrift Street
 - Domed wood posts to control where cars can travel over the grassed open area from the entrance road

A bid tabulation is attached detailing the 3 bids we received on September 27. The apparent low bidder is Sylva Construction with a bid of \$181,220.60.

- 2) We contacted Musco Lighting, who specializes in sports lighting and provided the existing lights at Wilson Park. They analyzed the skate surface and considered the potential future expansion and provided the attached design and Buyboard quote to light the skate park surface with between 14 min. and 35 max foot candles (see attached sketches). Their quote is \$70,732.00

FINANCIAL IMPACT:

The total cost to complete both the lighting and the parking improvements is $\$181,220.60 + \$70,732.00 = \$251,952.60$, which would require a budget amendment to fund \$111,952.60 from general fund reserves.

RECOMMENDATION:

So far, we have had steady use and care of the park. This phase 1 additional parking scope will provide further structure to and improve the appearance of the park. With the addition of LED lights, the park can be used after dark in conjunction with soccer games and ball games and we will have the opportunity to look into perhaps some skateboarding events to bring people in from out of town. The Park is open until 11 pm. The lights are able to be operated easily remotely and can be programmed to turn on at dusk and off at 11 pm – or any other times we choose. The lights should also help deter vandalism.

Understanding that the cost of construction continues to rise, we would like to see the parking and sidewalk improvements constructed now, adding \$41,220.60 from general fund reserves. Last year when we were thinking about a scope for the \$140,000, we had hoped to provide some lighting as well, but we quickly learned that the level of lighting recommended for a skatepark was more expensive than we were originally thought. Knowing that these

same lights will be more expensive next year, we would like to utilize \$70,732.00 of general fund reserves and go ahead purchase these lights now as well.

ATTACHMENTS:

- Site plan for Skate Park parking improvements
- Bid Tabulation
- Musco design
- Musco Buy Board quote



KEYED NOTES	
1	VAN ACCESSIBLE PARKING SPACE IN ACCORDANCE WITH THE STANDARD DETAIL, 100.
2	ACCESSIBLE PARKING SIGN IN ACCORDANCE WITH THE STANDARD DETAIL, 306.
3	WHEEL STOP IN ACCORDANCE WITH THE STANDARD DETAIL, 306.
4	4" WIDE WHITE PAINTED STRIPE.
5	4" WIDE WHITE PAINTED STRIPE, WATCH @ 2' SPACING, 45°.
6	6" x 3" DOMED TIMBER POST @ 8' - 0" O.C. POSTS SHALL BE IN ACCORDANCE WITH DMS 1209. TIMBER POSTS AND BLOCKS FOR BEAM GUARD FENCE. * PAINTED TIMBER POSTS NOT PERMITTED. FINISHED GRADE ELEVATION TO BOTTOM OF TIMBER POST SHALL BE 49'.
7	ALUMINUM FENCE, 48", BLACK, 3 RAIL, COMMERCIAL GRADE.
8	PRECAST CONCRETE GRATE INLET, GRATE SIZE, TOP OF GRATE & FLOW LINE(S) INDICATED ON PLAN.
9	GROUTED STORM SEWER CONNECTION IN ACCORDANCE WITH THE STANDARD DETAIL. VERIFY LOCATION & DEPTH OF STORM SEWER FOR RECONNECTION, NOTIFY ENGINEER IMMEDIATELY OF ANY DISCREPANCIES, 905.
10	OPEN/CUT & PATCH EXISTING ASPHALT BASE PAVEMENT, TRENCH EXCAVATION & RESTORATION SHALL BE IN ACCORDANCE WITH STANDARD DETAILS. THE CONTRACTOR SHALL PROVIDE & MAINTAIN ALL NECESSARY WARNING & SAFETY DEVICES (FLASHING LIGHTS, FLAG MEN, BARRICADES, SIGNS, ETC) TO PROTECT PUBLIC SAFETY UNTIL THE WORK HAS BEEN COMPLETED. ALL BARRICADES SHALL BE PERFORMED IN ACCORDANCE WITH THE CURRENT TEXAS MANUAL OF UNIFORM TRAFFIC CONTROL DEVICES.

ISSUE

☐ PRELIMINARY

☐ REVIEW

☐ PERMITTING

☒ BIDDING

☐ CONSTRUCTION

REVISIONS	

2004 N. Commerce, Victoria, Texas 77901 • 361.576.9836
urbanvictoria.com • TREF# F-160

PROJECT
**CoPL SKATE PARK
PARKING LOT
IMPROVEMENTS**

WILSON PARK
FORT LAVACA, TEXAS

TITLE
CIVIL SITE PLAN

DATE 08/09/22
JOB NUMBER E24785.00
SHEET

C3
PAGE 3 of 6

CITY OF PORT LAVACA

SKATE PARK PARKING LOT IMPROVEMENTS BID FORM

BID DATE: SEPTEMBER 27, 2022 2:00 PM

ITEM NO.	DESCRIPTION	ESTIMATED QTY	UNIT	TOTAL PRICE		
				K-C Lease Service, LLC	Lester Contracting, Inc.	Sylva Construction, LLC
GENERAL						
1.	Mobilization, Insurance and Bonds (Maximum 5% of Base Bid)	1	LS	\$ 29,000.00	\$ 9,500.00	\$ 8,629.50
2.	Barricading & Traffic Control (Furnish, Install, Maintain & Remove Signs & Warning Devices) (Includes Flagmen, Traffic Handling & Temporary Striping)	1	LS	\$ 3,000.00	\$ 1,050.00	\$ 2,400.00
3.	Construction Staking	1	LS	\$ 2,000.00	\$ 5,000.00	\$ 5,000.00
4.	Storm Water Pollution Prevention Plan (Prepare, Implement and Maintain Storm Water Plan and Controls)	1	LS	\$ 2,000.00	\$ 2,500.00	\$ 3,200.00
SUBTOTAL GENERAL				\$ 36,000.00	\$ 18,050.00	\$ 19,229.50
STORM SEWER IMPROVEMENTS						
5.	Grate Inlet (24" x 24")	3	EA	\$ 12,000.00	\$ 8,700.00	\$ 8,763.00
6.	Furnish & Install Storm Sewer Main (12") (0' - 5' Cut)	77	LF	\$ 19,250.00	\$ 2,772.00	\$ 5,289.90
7.	Grouted Storm Sewer Connection	1	EA	\$ 2,000.00	\$ 600.00	\$ 340.00
SUBTOTAL STORM SEWER IMPROVEMENTS				\$ 33,250.00	\$ 12,072.00	\$ 14,392.90

PAVING IMPROVEMENTS				K-C	Lester	Sylva
8.	Concrete Sidewalk	3,085	SF	\$ 37,020.00	\$ 31,621.25	\$ 26,685.25
9.	Site Grading	1	LS	\$ 50,000.00	\$ 6,500.00	\$ 2,400.00
10.	Lime Stabilized Subgrade (6")	910	SY	\$ 39,130.00	\$ 9,555.00	\$ 13,468.00
11.	Lime	15	Ton	\$ 5,925.00	\$ 4,200.00	\$ 5,193.75
12.	Limestone Base (8")	910	SY	\$ 54,600.00	\$ 30,030.00	\$ 28,392.00
13.	Prime Coat	910	SY	\$ 4,550.00	\$ 4,049.50	\$ 3,203.20
14.	Single Course Seal Coat	910	SY	\$ 9,100.00	\$ 14,560.00	\$ 11,557.00
15.	Hot Mix Paving	910	SY	\$ 36,400.00	\$ 30,712.50	\$ 24,506.30
SUBTOTAL PAVING IMPROVEMENTS				\$ 236,725.00	\$ 131,228.25	\$ 115,405.50
MISCELLANEOUS IMPROVEMENTS						
16.	Domed Timber Post (6' - 3")	83	EA	\$ 20,750.00	\$ 11,620.00	\$ 11,595.10
17.	Precast Concrete Wheel Stop	12	EA	\$ 3,600.00	\$ 1,440.00	\$ 1,347.60
18.	Pavement Markings (Permanent) (4" White) (Sherwin Williams SetFast Acrylic Traffic Marking Paint)	510	LF	\$ 1,275.00	\$ 1,530.00	\$ 1,096.50
19.	Pavement Markings (Permanent) (International Disable Symbol) (Sherwin Williams SetFast Acrylic Traffic Marking Paint)	1	EA	\$ 200.00	\$ 650.00	\$ 85.00
20.	Accessible Parking Sign Installation (Permanent) (Measured Per Post)	1	EA	\$ 1,000.00	\$ 450.00	\$ 586.00
21.	Aluminum Fence (48", 3 rail, aluminum)	225	LF	\$ 20,250.00	\$ 14,062.50	\$ 17,482.50
SUBTOTAL MISCELLANEOUS IMPROVEMENTS				\$ 47,075.00	\$ 29,752.50	\$ 32,192.70
TOTAL BASE BID				\$ 353,050.00	\$ 191,102.75	\$ 181,220.60

calendar days
Bid Bond

120 days
✗

120 days
✗

110 days
✗

Wilson Park Youth Football And Skate Park
Port Lavaca,TX

Lighting System

Pole / Fixture Summary						
Pole ID	Pole Height	Mtg Height	Fixture Qty	Luminaire Type	Load	Circuit
P1	40'	40'	2	TLC-LED-400	0.80 kW	A
		40'	1	TLC-LED-600	0.58 kW	A
P2	40'	40'	1	TLC-LED-400	0.40 kW	A
		40'	1	TLC-LED-600	0.58 kW	A
P3	40'	40'	2	TLC-LED-600	1.16 kW	A
3			7		3.52 kW	

Circuit Summary			
Circuit	Description	Load	Fixture Qty
A	Skate Park	3.52 kW	7

Fixture Type Summary							
Type	Source	Wattage	Lumens	L90	L80	L70	Quantity
TLC-LED-400	LED 5700K - 75 CRI	400W	46,500	>120,000	>120,000	>120,000	3
TLC-LED-600	LED 5700K - 75 CRI	580W	66,600	>120,000	>120,000	>120,000	4

Light Level Summary

Calculation Grid Summary								
Grid Name	Calculation Metric	Illumination					Circuits	Fixture Qty
		Ave	Min	Max	Max/Min	Ave/Min		
Blanket Grid	Horizontal	7.63	0	36	10235.02		A	7
Skate Park	Horizontal	26.6	14	35	2.50	1.90	A	7
Skate Park	Perpendicular	26.6	14	35	2.50	1.90	A	7

From Hometown to Professional

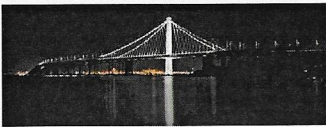

We Make It Happen.

EQUIPMENT LIST FOR AREAS SHOWN

QTY	LOCATION	SIZE	GRADE ELEVATION	MOUNTING HEIGHT	Luminaires			
					TYPE	QTY / POLE	THIS GRID	OTHER GRIDS
1	P1	40'	-	40'	TLC-LED-600	1	1	0
				40'	TLC-LED-400	1/1*	2	0
1	P2	40'	-	40'	TLC-LED-600	1	1	0
				40'	TLC-LED-400	1	1	0
1	P3	40'	-	40'	TLC-LED-600	2	2	0
3	TOTALS					7	7	0

* This structure utilizes a back-to-back mounting configuration

Wilson Park Youth Football And Skate Park
Port Lavaca, TX

GRID SUMMARY

Name: Skate Park
Size: 0' x 0'
Spacing: 10.0' x 10.0'
Height: 3.0' above grade

ILLUMINATION SUMMARY

MAINTAINED HORIZONTAL FOOTCANDLES

Entire Grid

Scan Average: 26.60
Maximum: 35
Minimum: 14
Avg / Min: 1.88
Max / Min: 2.50
UG (adjacent pts): 1.73
CU: 0.58
No. of Points: 84

LUMINAIRE INFORMATION

Applied Circuits: A
No. of Luminaires: 7
Total Load: 3.52 kW

Guaranteed Performance: The ILLUMINATION described above is guaranteed per your Musco Warranty document and includes a 0.95 dirt depreciation factor.

Field Measurements: Individual field measurements may vary from computer-calculated predictions and should be taken in accordance with IESNA RP-6-15.

Electrical System Requirements: Refer to Amperage Draw Chart and/or the "Musco Control System Summary" for electrical sizing.

Installation Requirements: Results assume $\pm 3\%$ nominal voltage at line side of the driver and structures located within 3 feet (1m) of design locations.



We Make It Happen.

Not to be reproduced in whole or part without the written consent of Musco Sports Lighting, LLC. ©1981, 2022 Musco Sports Lighting, LLC.

ILLUMINATION SUMMARY

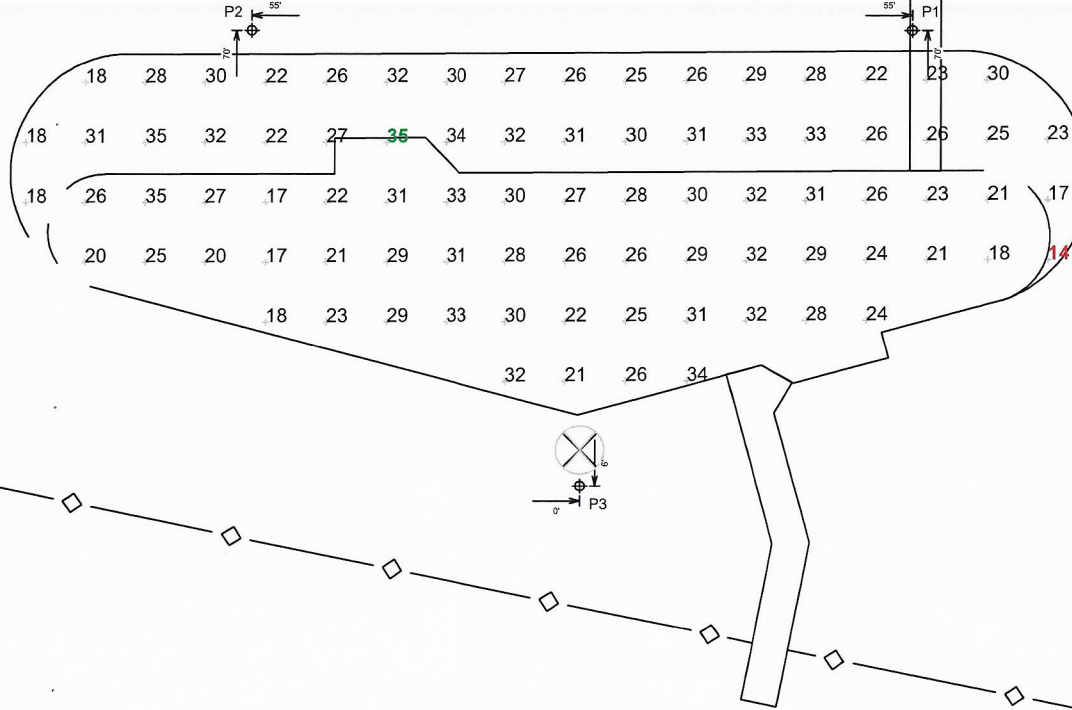

SCALE IN FEET 1 : 20



ENGINEERED DESIGN By: Ethan Arnold · File #221336C · 29-Sep-22

Wilson Park Youth Football And Skate Park
Port Lavaca, TX

GRID SUMMARY

Name: Blanket Grid
Size: 0' x 0'
Spacing: 10.0' x 10.0'
Height: 3.0' above grade

ILLUMINATION SUMMARY

MAINTAINED HORIZONTAL FOOT CANDLES
Entire Grid
Scan Average: 7.63
Maximum: 36
Minimum: 0
Avg / Min: 2181.22
Max / Min: 10235.02
UG (adjacent pts): 6.58
CU: 0.99
No. of Points: 504
LUMINAIRE INFORMATION
Applied Circuits: A
No. of Luminaires: 7
Total Load: 3.52 kW

Guaranteed Performance: The ILLUMINATION described above is guaranteed per your Musco Warranty document and includes a 0.95 dirt depreciation factor.

Field Measurements: Individual field measurements may vary from computer-calculated predictions and should be taken in accordance with IESNA RP-6-15.

Electrical System Requirements: Refer to Amperage Draw Chart and/or the "Musco Control System Summary" for electrical sizing.

Installation Requirements: Results assume $\pm 3\%$ nominal voltage at line side of the driver and structures located within 3 feet (1m) of design locations.

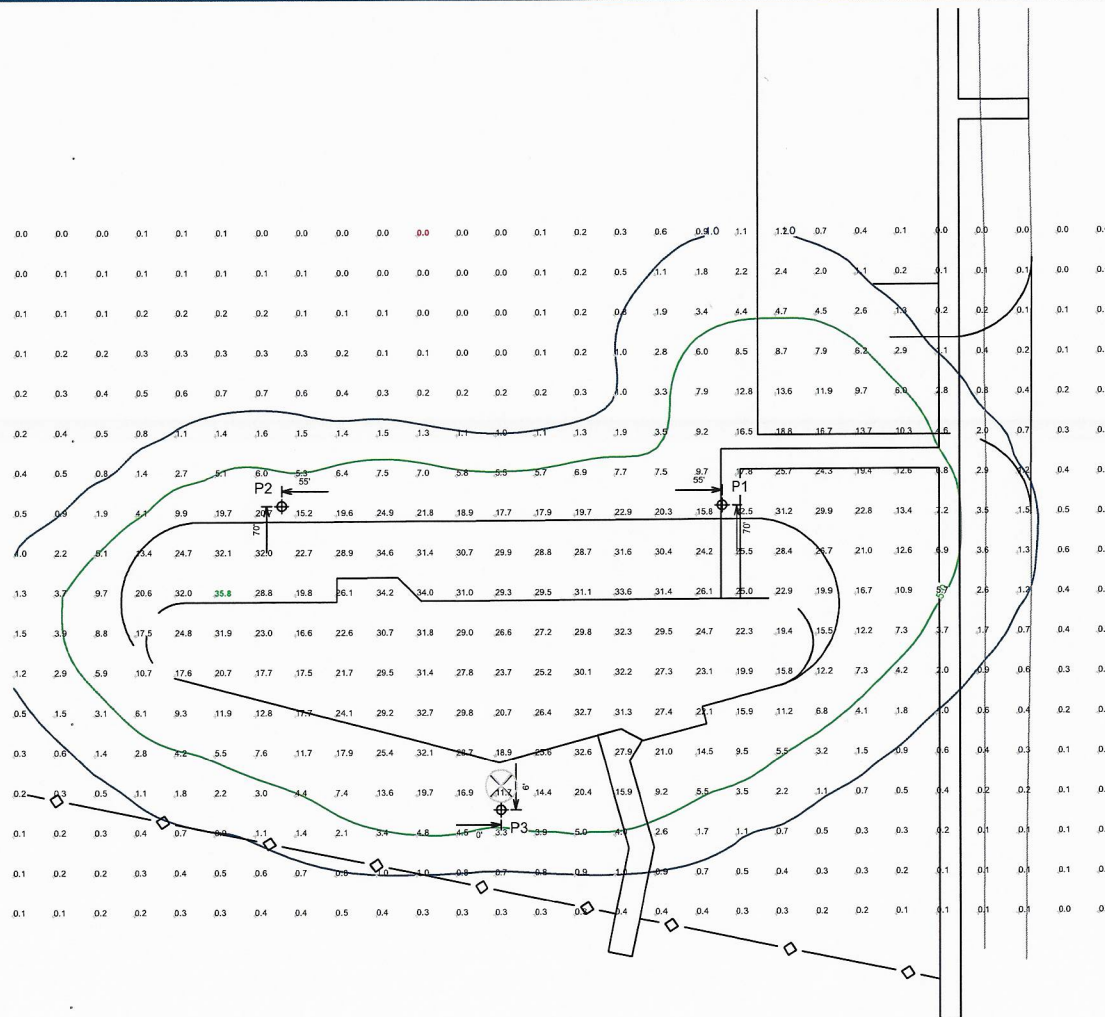

NOTES: Contour lines indicate cutoff of horizontal light at 5.0 and 1.0 fc

SCALE IN FEET 1 : 30

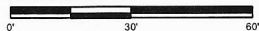

ENGINEERED DESIGN By: Ethan Arnold · File #221336C · 29-Sep-22

Pole location(s) + dimensions are relative to 0,0 reference point(s) ⊗



Not to be reproduced in whole or part without the written consent of Musco Sports Lighting, LLC. ©1981, 2022 Musco Sports Lighting, LLC.

ILLUMINATION SUMMARY

Wilson Park Youth Football And Skate Park
Port Lavaca, TX

EQUIPMENT LAYOUT

INCLUDES:

• Skate Park

Electrical System Requirements: Refer to Amperage Draw Chart and/or the "Musco Control System Summary" for electrical sizing.

Installation Requirements: Results assume $\pm 3\%$ nominal voltage at line side of the driver and structures located within 3 feet (1m) of design locations.

EQUIPMENT LIST FOR AREAS SHOWN

QTY	LOCATION	Pole		MOUNTING HEIGHT	Luminaires		QTY / POLE
		SIZE	GRADE ELEVATION		TYPE		
1	P1	40'	-	40'	TLC-LED-600		1
1	P2	40'	-	40'	TLC-LED-600		1
1	P3	40'	-	40'	TLC-LED-600		2
3	TOTALS						2

* This structure utilizes a back-to-back mounting configuration

SINGLE LUMINAIRE AMPERAGE DRAW CHART

Ballast Specifications (See min power factor)	Line Amperage Per Luminaire (max draw)							
	208 (60)	220 (60)	240 (60)	277 (60)	347 (60)	380 (60)	480 (60)	
Single Phase Voltage	2.3	2.2	2.0	1.7	1.4	1.3	1.0	
TLC-LED-400	3.4	3.2	3.0	2.6	2.0	1.9	1.5	
TLC-LED-600								

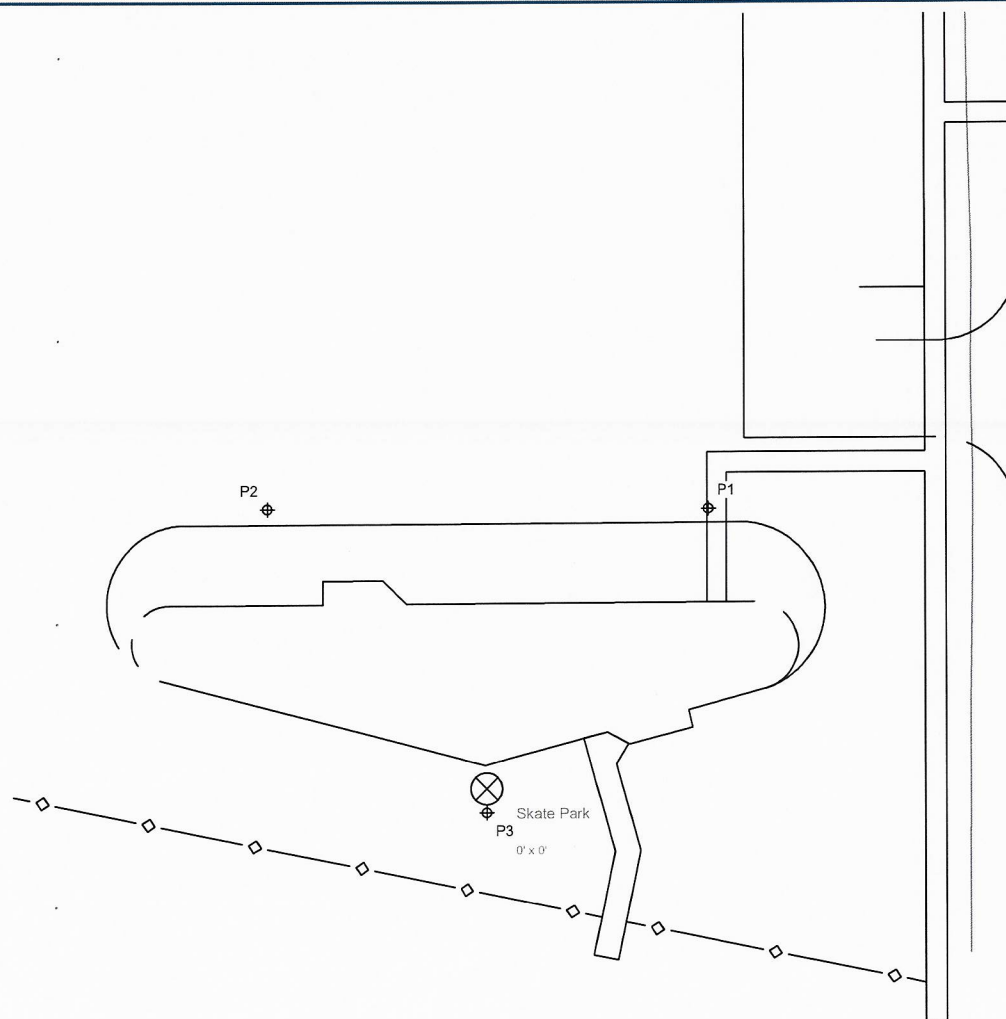

SCALE IN FEET 1 : 30

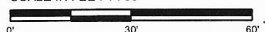

ENGINEERED DESIGN By: Ethan Arnold · File #221336C · 29-Sep-22

Pole location(s) Ⓢ dimensions are relative to 0,0 reference point(s) Ⓢ



We Make It Happen®

Not to be reproduced in whole or part without the written consent of Musco Sports Lighting, LLC. ©1981, 2022 Musco Sports Lighting, LLC.

EQUIPMENT LAYOUT



We Make It Happen®

Control-Link® – Control & Monitoring System

The only monitoring service of its kind, Control-Link® delivers the peace of mind that comes with knowing that your sports lighting system is being managed efficiently and your field is always ready to play.

With 24/7 support from a fully-staffed Musco team, Control-Link makes scheduling, controlling, and monitoring your lights simple and convenient.

Simple and Convenient

You can enter scheduling information, as well as control and monitor your lights from anywhere, at anytime, by using our mobile app on your smart phone, our easy-to-use website, or by contacting Control-Link Central's team of operators via phone, email, or fax.

Supportive and Reliable

Control-Link Central™ is located at Musco's home office and our team of support staff is there for you 24/7, helping with scheduling, monitoring for outages, taking care of last-minute changes, troubleshooting problems, and providing customer training.

Efficient and Cost Effective

With Control-Link, you won't have to worry about your lights being left on by accident or staff traveling from field to field to physically turn lights off. Through our automated scheduling system you'll realize a significant reduction in energy consumption and operating costs.

You'll also receive usage data reports by facility, field, and/or end-user—stored electronically at Control-Link Central—which will enhance your financial planning ability for the months and years ahead.

Existing customers contact the [Control-Link website](#), email schedule@musco.com or call us at **877.347.3319**.



Request Information

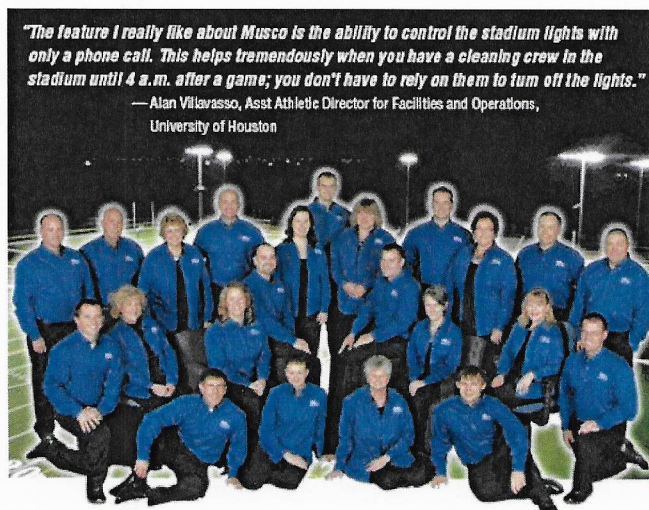

Quote

Date: September 29, 2022
Expiration date: October 29, 2022
To: Cyndi Heysquierdo

Project: Wilson Park Skate Park
Port Lavaca, TX
Musco Project Number: 221336

BuyBoard

Master Project: 218434, Contract Number: 677-22, Expiration: 09/30/2023
Commodity: Parks and Sports Field Lighting Products and Installation Services

All purchase orders should note the following:
BuyBoard purchase – Contract Number: 677-22

Quotation Price – Materials Delivered to Job Site and Installation

Skate Park -\$ 70,732

Sales tax of the equipment is not included.

Quote is confidential. Pricing and lead times are effective for 30 days only. Prices are subject to change if the order is not released within 60 days from the date of the purchase.

Light-Structure System™ with Total Light Control – TLC for LED™ technology

System Description

- Factory aimed and assembled luminaries
- (3) Galvanized steel poles for the Skate Park
- (3) Pre-cast concrete bases with integrated lightning grounding
- Pole length factory assembled wire harnesses
- Factory wired and tested remote electrical component enclosures
- UL listed assemblies
- Enhanced corrosion protection

Tie into Existing Control Systems and Services

- Control-Link® control and monitoring system to provide remote on/off control and monitoring with 24/7 customer support

Operation and Warranty Services

- Product assurance and warranty program that covers materials and onsite labor, eliminating 100% of your maintenance costs for 25 years
- Support from Musco's Lighting Services Team – over 170 Team members dedicated to operating and maintaining your lighting system

Musco Scope

- Provide design and layout for lighting system
- Test and final aim equipment

Installation Services Provided

[See attached scope of work]



Quote

Responsibilities of Buyer

- Confirm pole or luminaire locations, supply voltage and phase required for lighting system prior to production
- Provide electrical design and materials for electrical distribution system
- Buyer is responsible for getting electrical power to the site, coordination with the utility, and any power company fees

Payment Terms

Final payment terms are subject to approval by Musco credit department. Final payment shall not be withheld by Buyer on account of delays beyond the control of Musco.

Delivery Timing

Approximately 8 weeks for delivery of materials to the job site from the time of order, submittal approval, and confirmation of order details including voltage, phase, and pole/luminaire locations.

Notes

Quote is based on following conditions:

- Shipment of entire project together to one location.
- 480 Volt, 3 phase electrical system requirement.
- Structural code and wind speed = 2018 IBC, 150 mi/h, Exposure C, Importance Factor 1.
- Due to the built-in custom light control per luminaire, pole or luminaire locations need to be confirmed prior to production. Changes to pole or luminaire locations after the product is sent to production could result in additional charges.
- Standard soil conditions – rock, bottomless, wet, or unsuitable soil may require additional engineering, special installation methods and additional cost.

Thank you for considering Musco for your lighting needs. Please contact me with any questions or if you need additional details.

Tim Oordt
Senior Sales Representative
Musco Sports Lighting, LLC
100 1st Avenue West – PO Box 808
Oskaloosa, IA 52577, USA
Phone: 512-658-6884
E-mail: tim.oordt@musco.com



**Wilson Park Multipurpose Field & Skate Park
Port Lavaca, TX
Turnkey Scope of Work**

Customer Responsibilities:

1. Complete access to the site for construction utilizing standard 2-wheel drive rubber tire equipment.
2. Locate existing underground utilities not covered by your local utilities. (i.e. water lines, electrical lines, irrigation systems, and sprinkler heads). Musco or Subcontractor will not be responsible for repairs to unmarked utilities.
3. Locate and mark field reference points per Musco supplied layout. (i.e. home plate, center of FB field)
4. Pay for extra costs associated with foundation excavation in non-standard soils (rock, caliche, high water table, collapsing holes, etc.) or soils not defined in geo-technical report. Standard soils are defined as soils that can be excavated using standard earth auguring equipment.
5. Pay any power company fees and requirements.
6. Pay all permitting fees and obtain the required electrical permitting.
7. Provide area on site for disposal of spoils from foundation excavation.
8. Provide area on site for dumpsters.
9. Provide sealed Electrical Plans. (If required)

Musco Responsibilities:

1. Provide required foundations, poles, electrical enclosures, luminaires, wire harnesses, and control cabinets.
2. Provide layout of pole locations and aiming diagram.
3. Provide Contract Management as required.
4. Provide stamped foundation designs based on soils that meet or exceed those of a Class 5 material as defined by 2018 IBC Table 1806.2.
5. Assist our installing subcontractor and ensure our responsibilities are satisfied.

Subcontractor Responsibilities

General:

1. Obtain any required permitting.
2. Contact your local udig for locating underground public utilities and then confirm they have been clearly marked.
3. Contact the facility owner/manager to confirm the existing private underground utilities and irrigation systems have been located and are clearly marked to avoid damage from construction equipment. Notify owner and repair damage to marked utilities. Notify owner and Musco regarding damage which occurred to unmarked utilities.
4. Provide labor, equipment, and materials to off load equipment at jobsite per scheduled delivery.
5. Provide storage containers for material, (including electrical components enclosures), as needed.
6. Provide necessary waste disposal and daily cleanup.
7. Provide adequate security to protect Musco delivered products from theft, vandalism or damage during the installation.
8. Keep all heavy equipment off playing fields when possible. Repair damage to grounds which exceeds that which would be expected. Indentations caused by heavy equipment traveling over dry ground would be an example of expected damage. Ruts and sod damage caused by equipment traveling over wet grounds would be an example of damage requiring repair.
9. Provide startup and aiming as required to provide complete and operating sports lighting system.
10. Installation to commence upon delivery and proceed without interruption until complete. Notify Musco immediately of any breaks in schedule or delays.



Quote

Foundations, Poles, and Luminaires:

1. Mark and confirm pole locations per the aiming diagram provided. If there are any issues, immediately notify your Musco Project Manager.
2. Provide labor, materials, and equipment to install (3) LSS foundations as specified on Layout and per the stamped foundation drawings, if applicable.
3. Remove spoils and dispose of off site.
4. Provide labor, materials, and equipment to assemble Musco TLC-LED luminaires, electrical component enclosures, poles, and pole harnesses.
5. Provide labor, equipment, and materials to erect (3) dressed LSS Poles and aim utilizing the pole alignment beam.

Electrical:

1. Provide labor, materials, and equipment to reuse existing electrical service panels as required.
2. Provide labor, materials, and equipment to install all underground conduit, wiring, pull boxes etc. and terminate wiring as required.
3. Provide as-built drawings on completion of installation, **(if required)**.

Control System:

1. Provide labor, equipment, and materials to install the zone adder kit and contactor into the existing Soccer Musco control and monitoring cabinet
2. Check all zones to make sure they work in both auto and manual mode.
3. Commission Control-Link® by contacting Control-Link Central™ at 877-347-3319.

