

**CITY OF PORT LAVACA
REQUEST FOR VARIANCE**

Date: August 18, 2021

Name: SSC Signs & Lighting on behalf of Prosperity Bank

Address: 1107 TX-35
Port Lavaca, TX 77979

Reason for request: DIRECT HARDSHIP ON THE BUSINESS

Prosperity Bank's hardship for this location and the need for the increased height and allowed square footage on the pylon sign, is without approval on the size requested, Prosperity Bank will lack visibility and not be able to fairly advertise their business with the neighboring competition and businesses. In addition, just as the neighboring Whataburger, this site has severe visibility issues due to the power lines on the property. Prosperity Bank would like to increase the height of the pylon to 75' overall height pylon with approximately 360 sqft main-id cabinet due to the proximity of the highway and to give their customers better visibility of the location.

SIGN SCHEDULE

LOCATION	SIGN TYPE	QTY	ITEM DESCRIPTION	LOCATION	SIGN TYPE	QTY	ITEM DESCRIPTION	LOCATION	SIGN TYPE	QTY	ITEM DESCRIPTION
001	PS.00	1	PYLON SIGN	008	DS.36	1	DIRECTIONAL SIGN	015	PS.01	1	PARKING SIGN
002	ICL.16	1	ILLUMINATED CHANNEL LETTERS	009	DS.36	1	DIRECTIONAL SIGN	016	DV.01	1	DOOR VINYL
003	ICL.16	1	ILLUMINATED CHANNEL LETTERS	010	DS.36	1	DIRECTIONAL SIGN	017	WV.01	1	WINDOW VINYL
004	ICL.11	1	ILLUMINATED CHANNEL LETTERS	011	DS.36	1	DIRECTIONAL SIGN	018	PB-CG	1	CLUTTER GURAD
005	ICL.41	1	ILLUMINATED CHANNEL LOGO	012	DS.36	1	DIRECTIONAL SIGN				
006	ICS.01	1	ILLUMINATED CABINET SIGN	013	DS.36	1	DIRECTIONAL SIGN				
007	DS.36	1	DIRECTIONAL SIGN	014	PS.01	1	PARKING SIGN				

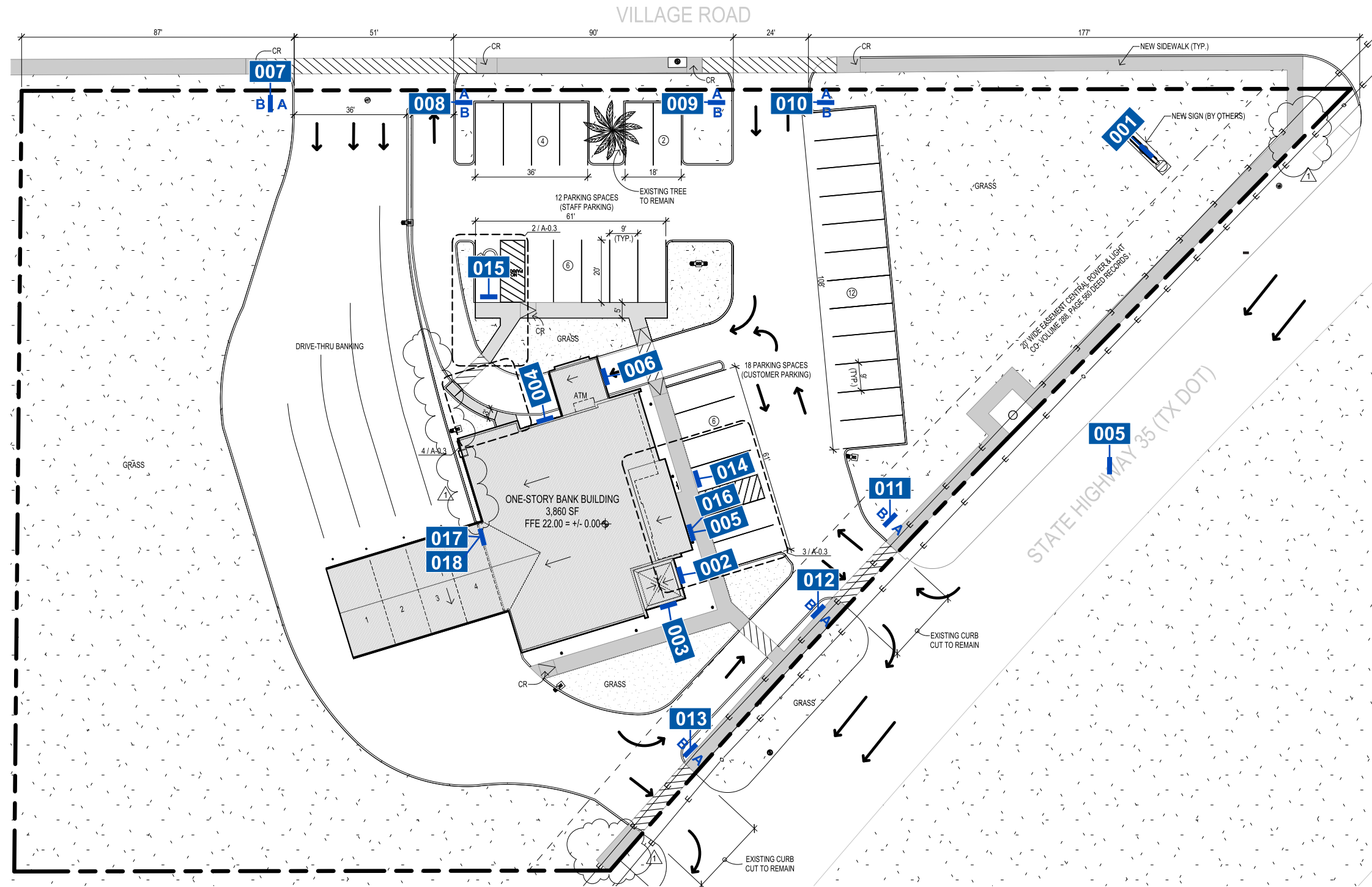

NOTES

-DIRECTIONAL SIGNS TO BE PLACED 5FT AWAY FROM PROPERTY LINE

CLIENT
 PROSPERITY
 PORT LAVACA
ADDRESS
 1107 TX-35
 PORT LAVACA TX 77979
DATE 8.20.2021
DESIGNER - RH
DRAWING NO.
 21OP377-2

REVISION **DATE**
 1. ADD NOTE 001, REVISE SIZE 004
 ADD EXIT SIGN RSH 6.8

2. CUSTOMER REVISE RSH 8.20

APPROVAL DATE -

APPROVED BY -

This sign is intended to be installed in accordance with the requirements of Article 600 of the National Electrical Code and/or other applicable local codes. This includes proper grounding and bonding of the sign. Dimensions are approximate & may change due to construction factors or exact field conditions. Color shown areas close as printing will allow; Always follow written specifications. All rights reserved: This design has been created for you in connection with a project being planned for you by SSC Signs & Lighting. It may not be reproduced in any manner without prior consent.

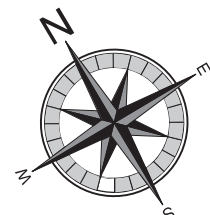

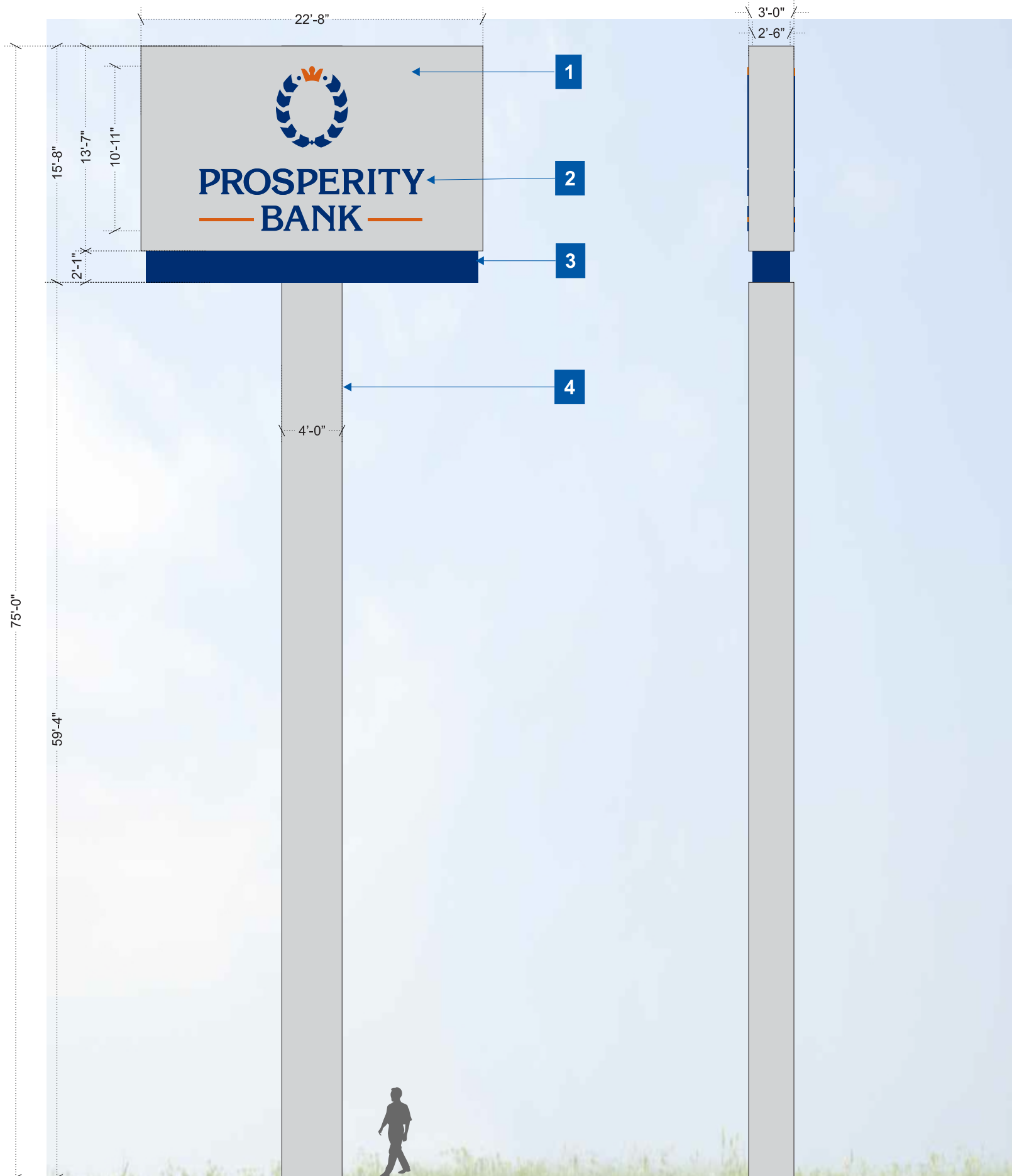

1. FABRICATED ALUMINUM SIGN CABINET W/ 2" ALUM. SQ. TUBE FRAME. .090 ALUM. ROUTED OUT FACES. CABINET PAINTED TO MATCH MP 41 342SP BRUSHED ALUMINUM.. INTERNALLY ILLUMINATED WITH EVERYLITE 3D 6500 WHITE LEDS.

2. PUSH THRU CLEAR ACRYLIC GRAPHIC WITH FIRST SURFACE TRANSLUCENT VINYL BLUE 3M 3630-36 & BURNT ORANGE 3M 3630-124. SECOND SURFACE VINYL TO BE 3M 3635-70 DIFFUSER

3. REVEAL PAINTED TO MATCH BLUE PMS 288C WITH A ALUMINUM C CHANNEL ABOVE TO ACCOMMODATE ACCENT SLOAN BLUE (701269-BLSJ1-MB) LEDS

4. FABRICATED .125 ALUMINUM CLADDING PAINTED TO MATCH BRUSHED ALUMINUM.

PRELIM ENGINEERING - WINDLOAD REQUIREMENTS FOR THIS AREA IS 120MPH, NOTE: SEALED ENGINEERING REQUIRED

CLIENT

PROSPERITY
PORT LAVACA
ADDRESS

1107 TX-35
PORT LAVACA TX 77979

DATE 8.20.2021

DESIGNER - RH

DRAWING NO.

21OP377-2

REVISION DATE

1. ADD NOTE 001,REVISE SIZE 004
ADD EXIT SIGN RSH 6.8

2. CUSTOMER REVISE RSH 8.20

APPROVAL DATE -

APPROVED BY -

This sign is intended to be installed in accordance with the requirements of Article 600 of the National Electrical Code and/or other applicable local codes. This includes proper grounding and bonding of the sign. Dimensions are approximate & may change due to construction factors or exact field conditions. Color shown areas close as printing will allow; Always follow written specifications. All rights reserved: This design has been created for you in connection with a project being planned for you by SSC Signs & Lighting. It may not be reproduced in any manner without prior consent.

- V1 - VINYL 3M 3630-187 INFINITY BLUE
- V2 - VINYL 3M 3630-124 BURNT ORANGE
- V3 - VINYL 3M 3635-70 DIFFUSER
- P1 - PAINT TO MATCH MP 41 342SP BRUSHED ALUMINUM
- P2 - PAINT TO MATCH PROSPERITY BLUE PMS: 288C