

1. THE MINIMUM COMPRESSIVE STRENGTH AT 28 DAYS SHALL BE 3,500 P.S.I. AND SHALL COMPLY WITH ACI 318.
2. REINFORCING STEEL SHALL COMPLY WITH ASTM A615 AND SHALL HAVE A YIELD STRENGTH OF 60,000 P.S.I.
3. BACKFILLING AGAINST REINFORCED RETAINING WALL/CURB SHALL NOT BE PERMITTED UNTIL CONCRETE HAS REACHED IT'S 28 DAY STRENGTH. CARE SHALL BE TAKEN TO AVOID EXERTING LARGE IMPACT FORCES ON THE RETAINING WALL.

TURN DOWN CURB DETAIL  
NOT TO SCALE

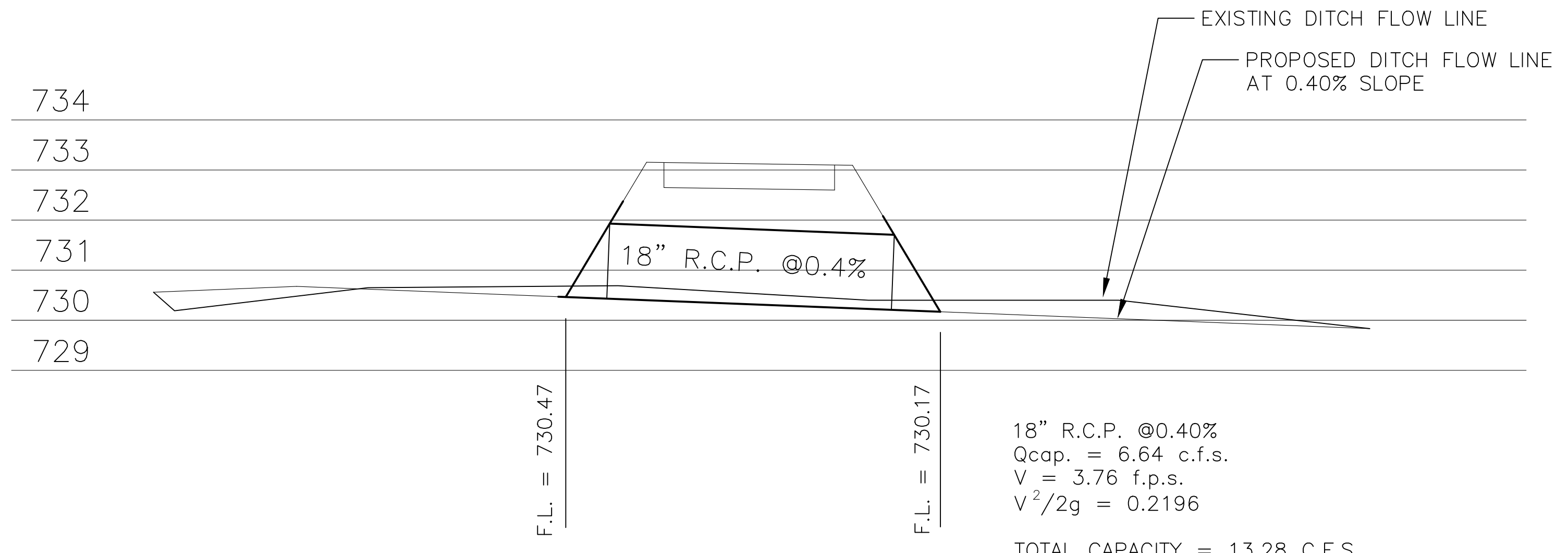
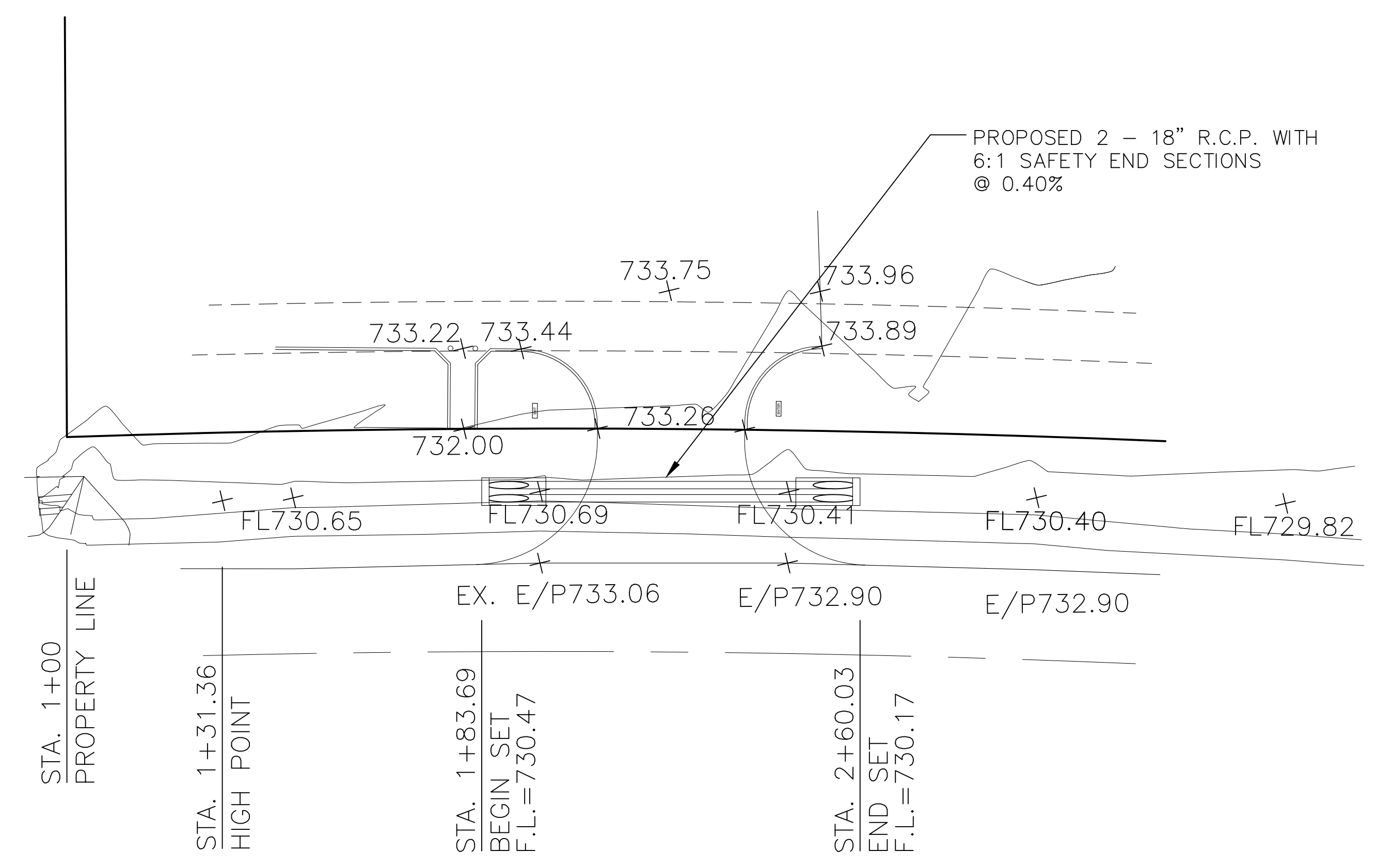

CULVERT PIPES  
H 1" = 20'  
V 1" = 2'

18" R.C.P. @0.40%  
Qcap. = 6.64 c.f.s.  
V = 3.76 f.p.s.  
V<sup>2</sup>/2g = 0.2196  
  
TOTAL CAPACITY = 13.28 C.F.S.  
NOTE: AS DITCH FILLS UP SOME OF THE  
RUNOFF WILL FLOW TO THE SOUTH THROUGH  
THE TWO 12" R.C.P.s

CULVERT & TURN DOWN CURB DETAIL						
SONIC DRIVE-IN						
MERRIFIELD ESTATES FIRST SECTION						
TOWN OF PONDER, TEXAS						
WALTER NELSON AND ASSOCIATES FIRM No. 0062 1812 CARLA AVENUE ARLINGTON, TEXAS 76014 (817) 642-9119						
DESIGN	DRAWN	SCALE	DATE	NOTES	FILE	NO.
W.J.N.	W.J.N.	1"=20'	4-2022	COLEMAN		