

ROOF ASSEMBLY R-1 (ALTERNATE):
FULLY ADHERED 60 MIL. PVC MEMBRANE ROOFING OVER 1/4" DENSDECK PRIME ON 5" PLYISO RIGID INSULATION ABOVE METAL DECK (STAGGER JOINTS IN LAYERS OF INSULATION & TAPE TOP LAYER W/ MANUFACTURER APPROVED TAPE TO CREATE A VAPOR BARRIER)

ROOF ASSEMBLY R-1:
FULLY ADHERED 60 MIL. TPO MEMBRANE ROOFING OVER 1/2" DENSDECK PRIME ROOF BOARD OVER 2 LAYERS OF 2.5" RIGID INSULATION BOARD ABOVE METAL DECK (SEE STRUCTURAL DRAWINGS FOR DECK SPECS.) (STAGGER JOINTS IN LAYERS OF INSULATION & TAPE TOP LAYER WITH MANUFACTURER APPROVED TAPE TO CREATE A VAPOR BARRIER)

ALTERNATE A-1

BASE BID

NOTE:
OFFSET INSULATION BOARD 1/2 WIDTH OF LENGTH BETWEEN TOP AND BOTTOM LAYERS. TAPE TOP LAYER OF INSULATION.

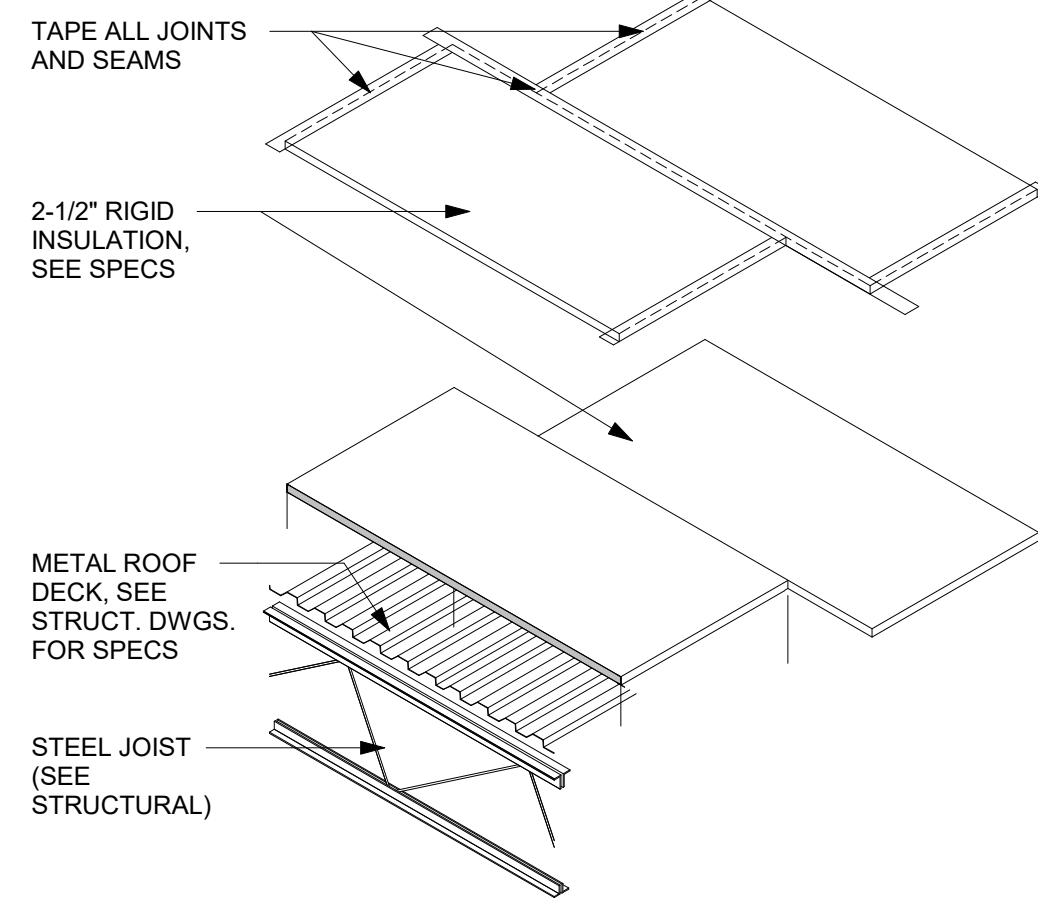

2 ROOF INSULATION EXPLODED ASSEMBLY
Scale: 1 1/2" = 1'-0"

3 ROOF INSULATION LAYOUT
Scale: 1/2" = 1'-0"

ROOF PLAN LEGEND

DS - DOWNSPOUT
HP - HIGHPOINT
LP - LOWPOINT

ROOF PLAN NOTES

1. PROVIDE ALL FLASHING MATERIALS AND METHODS AS APPROVED BY THE MANUFACTURER FOR A FULL WATERPROOF SYSTEM.
2. IT IS THE CONTRACTOR'S RESPONSIBILITY TO REVIEW OTHER DRAWINGS FOR ROOF PENETRATIONS NOT SHOWN.
3. DO NOT ALLOW ROOF PENETRATIONS OF MECHANICAL AND/OR PLUMBING EQUIPMENT TO EXCEED THE HEIGHT OF THE PARAPET WALLS. NOTIFY THE ARCHITECT OF ANY DISCREPANCY PRIOR TO ANY ROOF TOP INSTALLATION. THE FRONT ELEVATION OF THE BUILDING. IF PNE PLANS SHOW PENETRATIONS ON THESE LOCATIONS, IT SHOULD BE RE-ROUTED AT THE BACK OF THE ROOF.
4. SEE MECH. PLUMB. & ELECT. DRAWINGS FOR OTHER ROOF PENETRATIONS. ROOFING CONTRACTOR SHALL FLASH ALL PENETRATIONS. PENETRATIONS SHOWN ARE APPROX AND MAY NOT BE ALL REQUIRED. PAINT ALL ROOF PENETRATION PIPES TO MATCH ROOF COLOR.
5. PROVIDE CRICKETS AT ALL ROOF TOP MECHANICAL UNITS AND OTHER ROOF PENETRATIONS. ALSO PROVIDE CRICKETS ALONG PERIMETER OF ROOF AND ELSEWHERE SHOWN ON ROOF PLAN.
6. GO TO COORDINATE EXACT LOCATIONS OF EACH DOWNSPOUT (DS) ON ELEVATIONS ON SHEET 5.10 & 5.11 WITH ALL UNDERGROUND STORM WATER CONNECTIONS, IF REQUIRED.
7. ALL EXPOSED EXTERIOR SOFFIT/OVERHANG SHALL BE OF MP-2. SEE RCP @ 5.10 & 5.11 FOR METAL SOFFIT NOT SHOWN ON THIS SHEET. OVERHANG DIMENSIONS SHOWN ABOVE ARE PROJECTING FROM THE OUTSIDE FACE OF THE BRICK VENEER WALL TO THE FACE OF THE METAL FASCIA FRAMING. SEE WALL SECTIONS 1/5.22, 5.25, 5.26 & 1/5.27.
8. PROVIDE PERFORATED ALUMINUM LEAF GUARD IN ALL GUTTERS.
9. ALL DIMENSIONS TO BE VIF PRIOR TO ROOF FABRICATION & INSTALLATION.

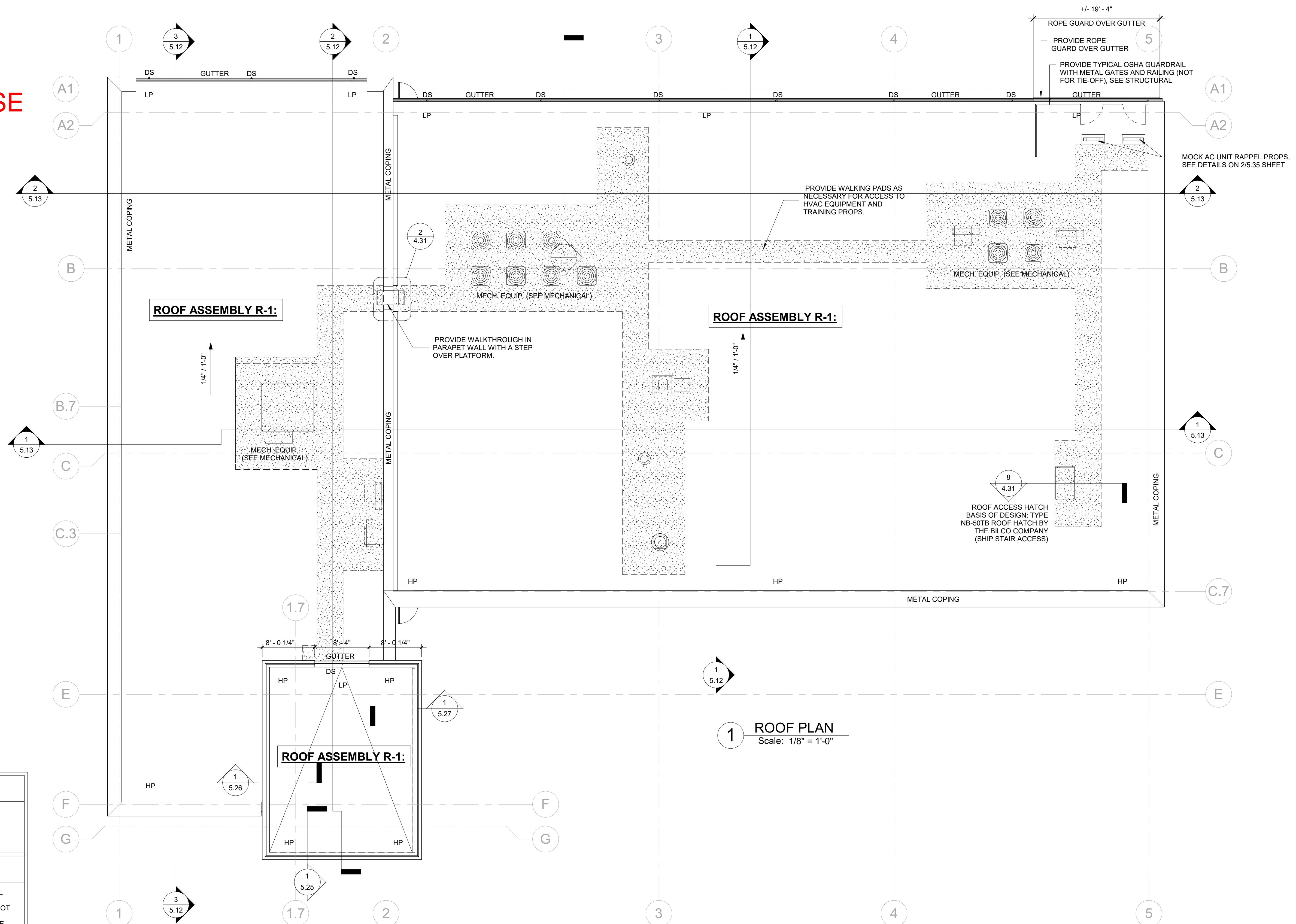

1 ROOF PLAN
Scale: 1/8" = 1'-0"

100% BID SET FOR CONSTRUCTION

Project No. 1733

Date: 09/16/2024
Drawn by: KP/IS/SH/AJP/GC
Checked by: KCM
Revisions:

STEWART-COOPER-NEWELL ARCHITECTS, P.A.

THIS DRAWING IS THE PROPERTY OF STEWART-COOPER-NEWELL ARCHITECTS, P.A. AND IS LOANED TO YOU FOR YOUR PROJECT ONLY. IT IS NOT TO BE REPRODUCED OR COPIED IN ANY MANNER WITHOUT THE WRITTEN PERMISSION OF STEWART-COOPER-NEWELL ARCHITECTS, P.A.

LIC. NO. 51313
GASTONIA, N.C.

719 East Second Avenue
Gastonia, NC 28054
Phone: 704.865.0311
Fax: 704.865.0046

Stewart-Cooper-Newell Architects
www.scn-architects.com

1.800.671.0621

6205
09/16/2024

A NEW FIRE HEADQUARTERS STATION FOR THE TOWN OF PINEVILLE
PINEVILLE, NC

ROOF PLAN AND NOTES

Sheet No. 4.30