



© STEWART-COOPER-NEWELL ARCHITECTS, P.A.
THIS DRAWING IS THE PROPERTY OF STEWART-COOPER-NEWELL ARCHITECTS, P.A. AND IS SUBJECT TO FEDERAL COPYRIGHT LAWS. THIS DRAWING MAY NOT BE REPRODUCED, COPIED, OR USED IN ANY MANNER WITHOUT THE WRITTEN PERMISSION OF STEWART-COOPER-NEWELL ARCHITECTS, P.A.

719 East Second Avenue
Gastonia, NC 28054
Phone: 704.865.0311
Fax: 704.865.0046

Stewart Cooper · Newell Architects
www.scn-architects.com



SEAL
34288
9-16-24
BRIAN V. CRUTCHFIELD
REGISTERED PROFESSIONAL ENGINEER

NEW FIRE HEADQUARTERS FOR THE TOWN OF PINEVILLE
311 N POLK STREET, PINEVILLE, NC 28134

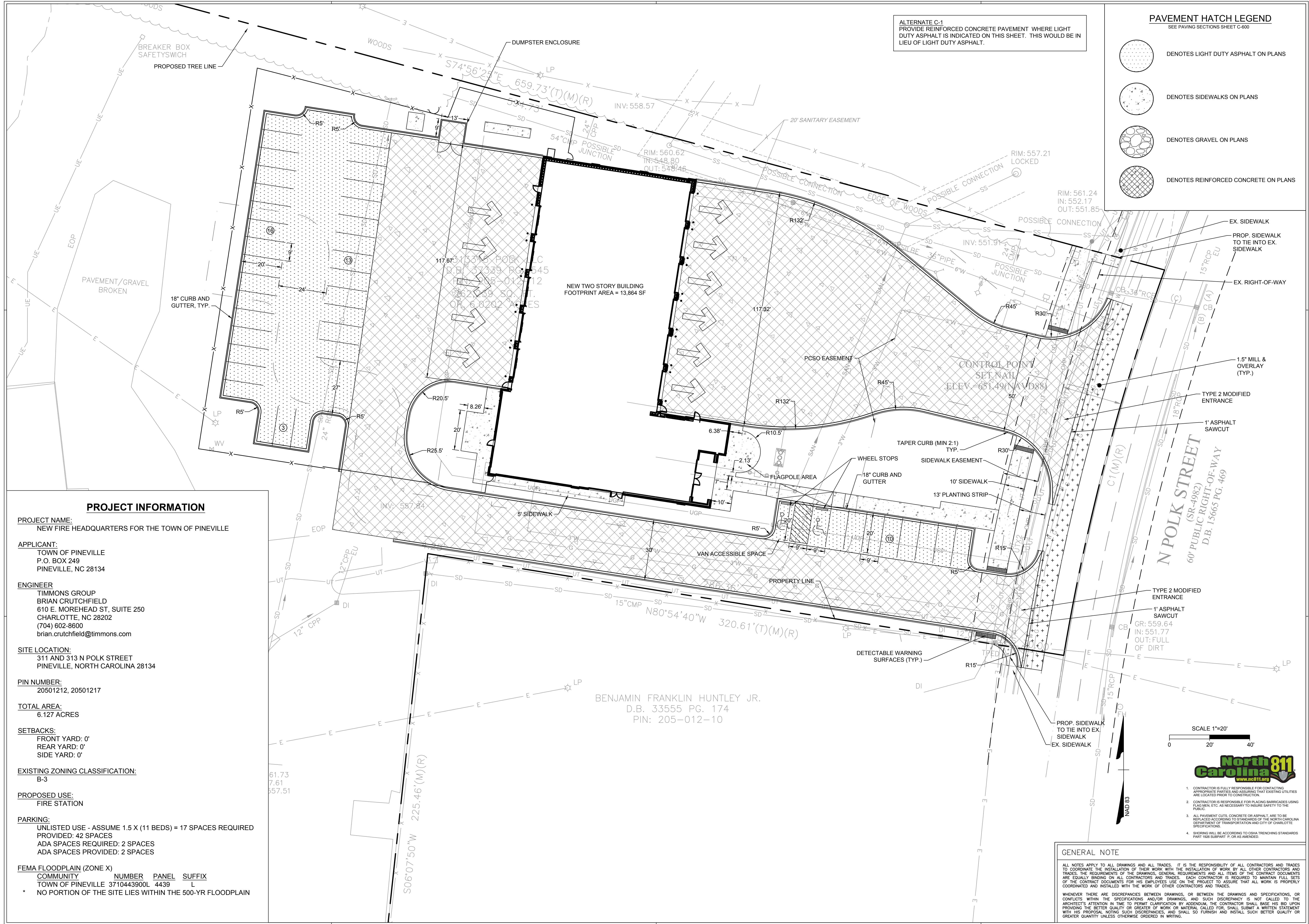

ALTERNATE C-1
PROVIDE REINFORCED CONCRETE PAVEMENT WHERE LIGHT DUTY ASPHALT IS INDICATED ON THIS SHEET. THIS WOULD BE IN LIEU OF LIGHT DUTY ASPHALT.

PAVEMENT HATCH LEGEND
SEE PAVING SECTIONS SHEET C-600

	DENOTES LIGHT DUTY ASPHALT ON PLANS
	DENOTES SIDEWALKS ON PLANS
	DENOTES GRAVEL ON PLANS
	DENOTES REINFORCED CONCRETE ON PLANS

PROJECT INFORMATION

PROJECT NAME:
NEW FIRE HEADQUARTERS FOR THE TOWN OF PINEVILLE

APPLICANT:
TOWN OF PINEVILLE
P.O. BOX 249
PINEVILLE, NC 28134

ENGINEER:
TIMMONS GROUP
BRIAN CRUTCHFIELD
610 E. MOREHEAD ST. SUITE 250
CHARLOTTE, NC 28202
(704) 602-8600
brian.crutchfield@timmons.com

SITE LOCATION:
311 AND 313 N POLK STREET
PINEVILLE, NORTH CAROLINA 28134

PIN NUMBER:
20501212, 20501217

TOTAL AREA:
6.127 ACRES

SETBACKS:
FRONT YARD: 0'
REAR YARD: 0'
SIDE YARD: 0'

EXISTING ZONING CLASSIFICATION:
B-3

PROPOSED USE:
FIRE STATION

PARKING:
UNLISTED USE - ASSUME 1.5 X (11 BEDS) = 17 SPACES REQUIRED
PROVIDED: 42 SPACES
ADA SPACES REQUIRED: 2 SPACES
ADA SPACES PROVIDED: 2 SPACES

FEMA FLOODPLAIN (ZONE X)
COMMUNITY NUMBER PANEL SUFFIX
TOWN OF PINEVILLE 3710443900L 4439 L
* NO PORTION OF THE SITE LIES WITHIN THE 500-YR FLOODPLAIN

BENJAMIN FRANKLIN HUNTLEY JR.
D.B. 33555 PG. 174
PIN: 205-012-10

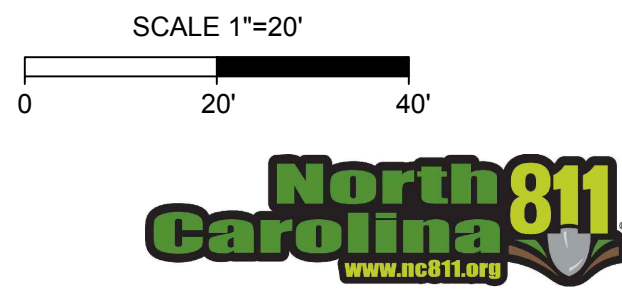

GENERAL NOTE
ALL NOTES APPLY TO ALL DRAWINGS AND ALL TRADES. IT IS THE RESPONSIBILITY OF ALL CONTRACTORS AND TRADES TO COORDINATE THE INSTALLATION OF THEIR WORK WITH THE INSTALLATION OF WORK BY ALL OTHER CONTRACTORS AND TRADES. THE REQUIREMENTS OF THE DRAWINGS, GENERAL REQUIREMENTS AND ALL ITEMS OF THE CONTRACT DOCUMENTS ARE EQUALLY BINDING ON ALL CONTRACTORS AND TRADES. EACH CONTRACTOR IS REQUIRED TO MAINTAIN FULL SETS OF THE CONTRACT DOCUMENTS FOR HIS EMPLOYEES USE ON THE PROJECT TO ASSURE THAT ALL WORK IS PROPERLY COORDINATED AND INSTALLED WITH THE WORK OF OTHER CONTRACTORS AND TRADES.
WHENEVER THERE ARE DISCREPANCIES BETWEEN DRAWINGS, OR BETWEEN THE DRAWINGS AND SPECIFICATIONS, OR CONFLICTS WITHIN THE SPECIFICATIONS AND/OR DRAWINGS, AND SUCH DISCREPANCY IS NOT CALLED TO THE ARCHITECT'S ATTENTION IN TIME TO PERMIT CLARIFICATION BY ADDENDUM, THE CONTRACTOR SHALL BASE HIS BID UPON PROVIDING THE BETTER QUALITY OR GREATER QUANTITY OF WORK OR MATERIAL CALLED FOR, SHALL SUBMIT A WRITTEN STATEMENT WITH HIS PROPOSAL NOTING SUCH DISCREPANCIES, AND SHALL SO FURNISH AND INSTALL SUCH BETTER QUALITY OR GREATER QUANTITY UNLESS OTHERWISE ORDERED IN WRITING.