

PETERSBURG BOROUGH
SPECIAL USE PERMIT
APPLICATION

CODE TO:	110.000.404110
BASE FEE:	\$50.00
PUBLIC NOTICE FEE:	\$70.00
TOTAL:	\$120.00

DATE RECEIVED: _____ RECEIVED BY: _____ CHECK NO. or CC: # 5254

APPLICANT/AGENT **LEGAL OWNER (IF DIFFERENT THAN APPLICANT/AGENT)**

NAME <u>JASON C. ANDERSON</u>	NAME
MAILING ADDRESS <u>PO Box 1841</u>	MAILING ADDRESS
CITY/STATE/ZIP <u>Petersburg AK 99833</u>	CITY/STATE/ZIP
PHONE <u>907.650.7403</u>	PHONE
EMAIL <u>andjulie@gmail.com</u>	EMAIL

PROPERTY INFORMATION

PHYSICAL ADDRESS or LEGAL DESCRIPTION:

208 N. 4th Corner of Excel + N. 4th

PARCEL ID:	ZONE:	OVERLAY:
------------	-------	----------

CURRENT USE OF PROPERTY: <u>Residence</u>	LOT SIZE: <u>50 x 100</u>
--	------------------------------

PROPOSED USE OF PROPERTY (IF DIFFERENT):

SEPTIC SYSTEM: Is there a septic system on the property? YES NO

What is current or planned system? Municipal DEC-approved on-site system

WATER SOURCE: Municipal Cistern/Roof Collection Well

LEGAL ACCESS TO LOT(S) (Street Name): Excel St.

TYPE OF APPLICATION

Use of Borough Right-of-Way. Please submit site plan showing area you will be developing/using.

Other:

SUBMITTALS:

Please submit additional information as required for specific permit. See specific application for more information.

SIGNATURE(S):

I hereby affirm all of the information submitted with this application is true and correct to the best of my knowledge. I also affirm that I am the true and legal property owner or authorized agent thereof for the property subject herein.

Applicant(s): _____ Date: _____

Owner(s): Jan C. Anderson Date: 3/31/21

19.76 SPECIAL USE APPLICATION

(SUBMIT WITH SITE PLAN)

Applicant(s): Jason + Julie Anderson

Address or PID: 208 N. 4th

Project Summary: Install greenhouse, fence + planter boxes on or partially on Borough property adjacent to yard/lot.

Conditions of approval as required in Petersburg Municipal Code 19.76.020:

(Note that all regulations and requirements of Title 19 must be satisfied in order to qualify for a conditional use permit.)

1. The Borough Assembly may issue the permit if the request, as approved by the Planning Commission, is found to be of beneficial nature to the community and that adjacent and surrounding property will not be adversely impacted.

There are instances when the private sector needs to use borough property for uses other than what the property was initially intended for. An example would be to use a platted, but undeveloped, right-of-way for private access to private property.

Explain how your application meets these conditions:

Lot was filled by previous owners creating useable, contiguous yard space. Planting flowers + vegetables in this space allows for use of remaining yard for pets, kids + winter boat storage. No installations will effect current borough or neighboring uses. ~~but~~

N. 4th St.

S 00°18'00" W 50.00'

IRON ROD

WOOD POWER POLE

EXCEL ST

PORCH

30.2'

1 1/2 STORY HOUSE
W/ CONC. BASEMENT

30.2'

37.3'

37.1'

14.4'

5'

5' PORCH

42' to
Property
Line



***** = PROPOSED FENCE

----- = PROPOSED/EXISTING
GREENHOUSE + GARDEN BOX

SLOPE





Anderson Property 208 N. 4th Street 01-006-207

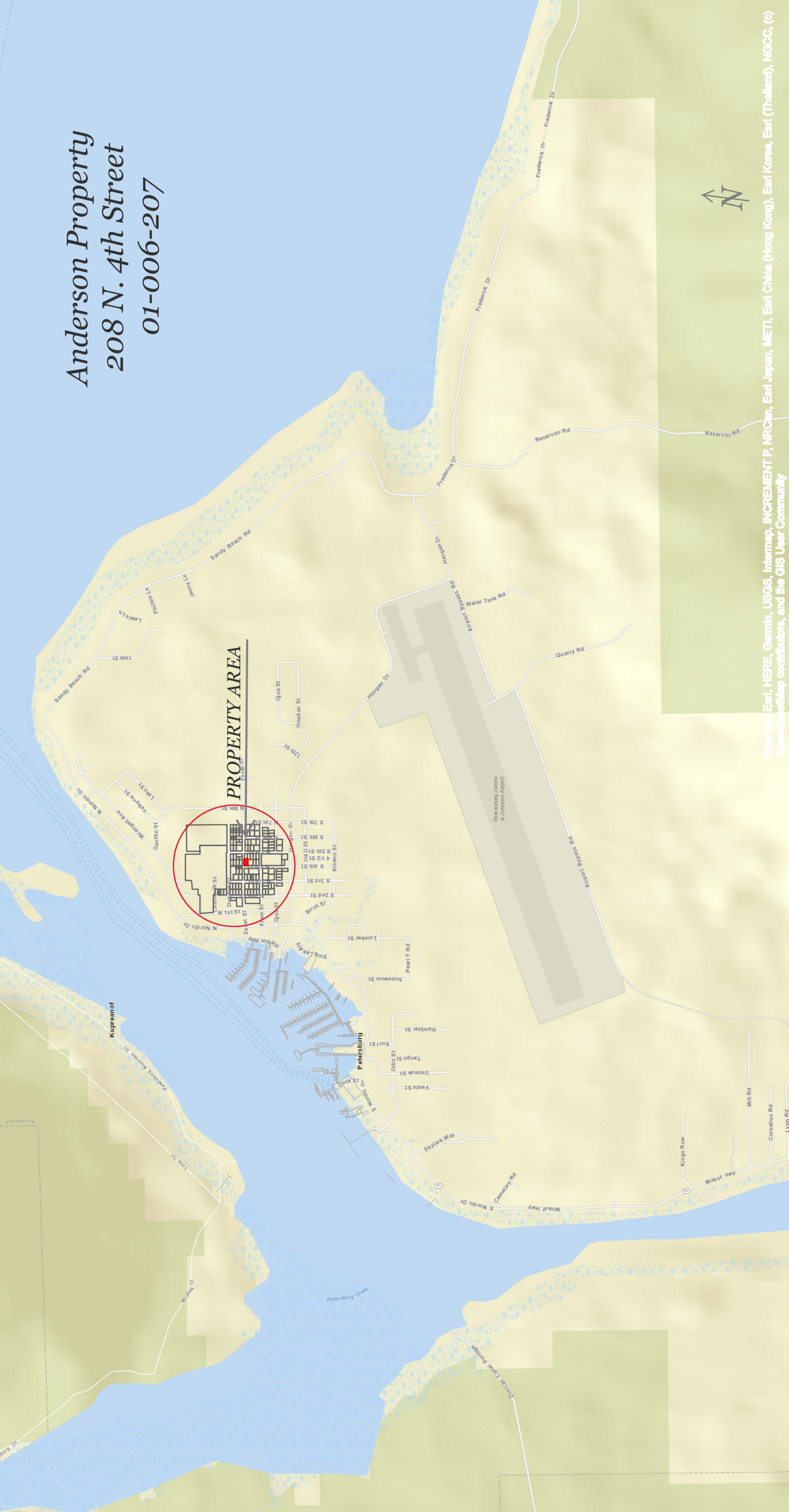

PROPERTY AREA

Sources: Esri, HERE, Garmin, USGS, Intermap, INCREMENT P, NRCan, Esri Japan, METI, Esri China (Hong Kong), Esri Korea, Esri (Thailand), NGCC, (c) OpenStreetMap contributors, and the GIS User Community

CHARLES W ST

01007165
01007166
01007167
01007168

01006010
Petersburg Schools

01006050

Anderson Property
208 N. 4th Street
01-006-207

DOLPHIN ST

01007245 01007246
01007255 01007247
01007253 01007248
01007251 01007249

01007234

01007236

01006103 01006105
01006111 01006106
01006112 01006107
01006113 109

01006100
01007260 01006120
01007262 01006118

01006125 01006127
01006155 01006149
01006152 01006151
130 131 132 133
145 140 139 134
144 141 138 135
143 142 137 136

EXCEL ST

01007310 01007311
01007318 01007312
01007317 01007313
01007316 01007314
01007315 01007314

01007301

01007320 01006201
01007321
01007322 01006206
01007323
01007324
01007325

01006207 01006209
01006210
01006211
01006216 01006212
01006214 01006213

01006220 01006221
01006229 01006222
01006227 01006223
01006225 01006224

01006230 01006231
01006239 01006232
01006234 01006233

N 1ST ST

N 2ND ST

N 4TH ST

N 5TH ST

N 6TH ST

N 7TH ST

N 8TH ST

N 8TH ST

FRAM ST

01007361 01007362
01007369 01007364
01007366 01007365

01007370 01006700
01007373 50190010
50190010

01006720
US Forest Service housing
01006728 01006722

01006738 01006730
01006737 01006732
01006736 01006733
01006749 01006740
01006748 01006741
01006742

01006749 01006740
01006748 01006741
01006742

01006749 01006740
01006748 01006741
01006742

01006749 01006740
01006748 01006741
01006742

01006749 01006740
01006748 01006741
01006742

GJOA ST

01007437

01007450 01007451
01006710 01006711
01006712 01006711

01006728 01006722

01006807 01006807

01006807 01006807

01006807 01006807

01006807 01006807

01006807 01006807

