



91 Hwy 105

103 Hwy 105
Palmer Lake, Co.
80133

Existing Electric Pole
1 40'4"
2 18'4"
3 36'4"
4 52'7"

Existing Fire Hydrant
1 42'2"
2 54'6"
3 40'1"
4 18'3"

75 Hwy 105

Sewer Main

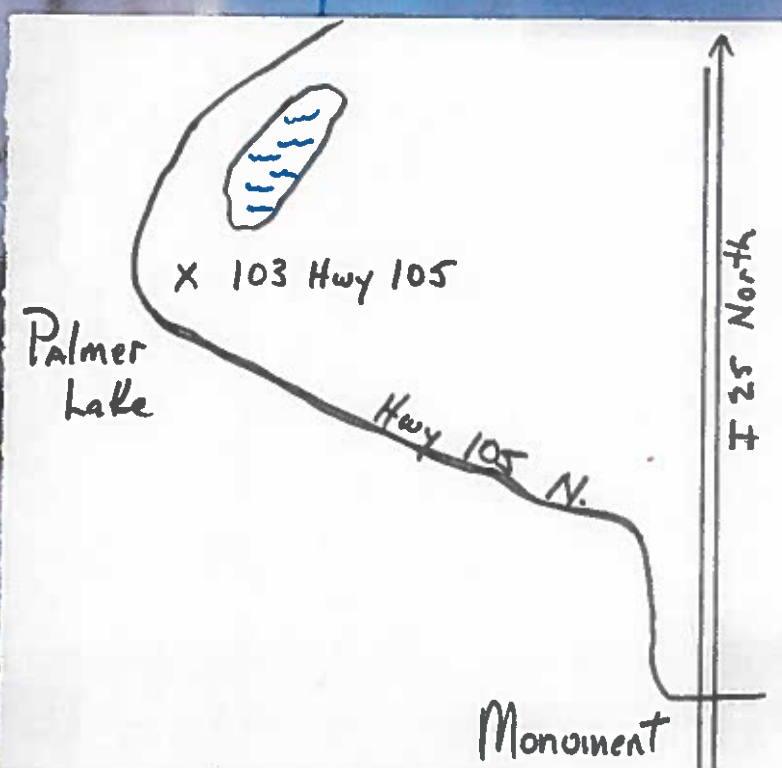

9:49

88



New Bathroom



30 m

Palmer Lake Restoration Grp.
Palmer Lake Pickleball Courts
AT Centennial Park

Tim Caves 719-640-0485
rtimcaves@yahoo.com

NORTH

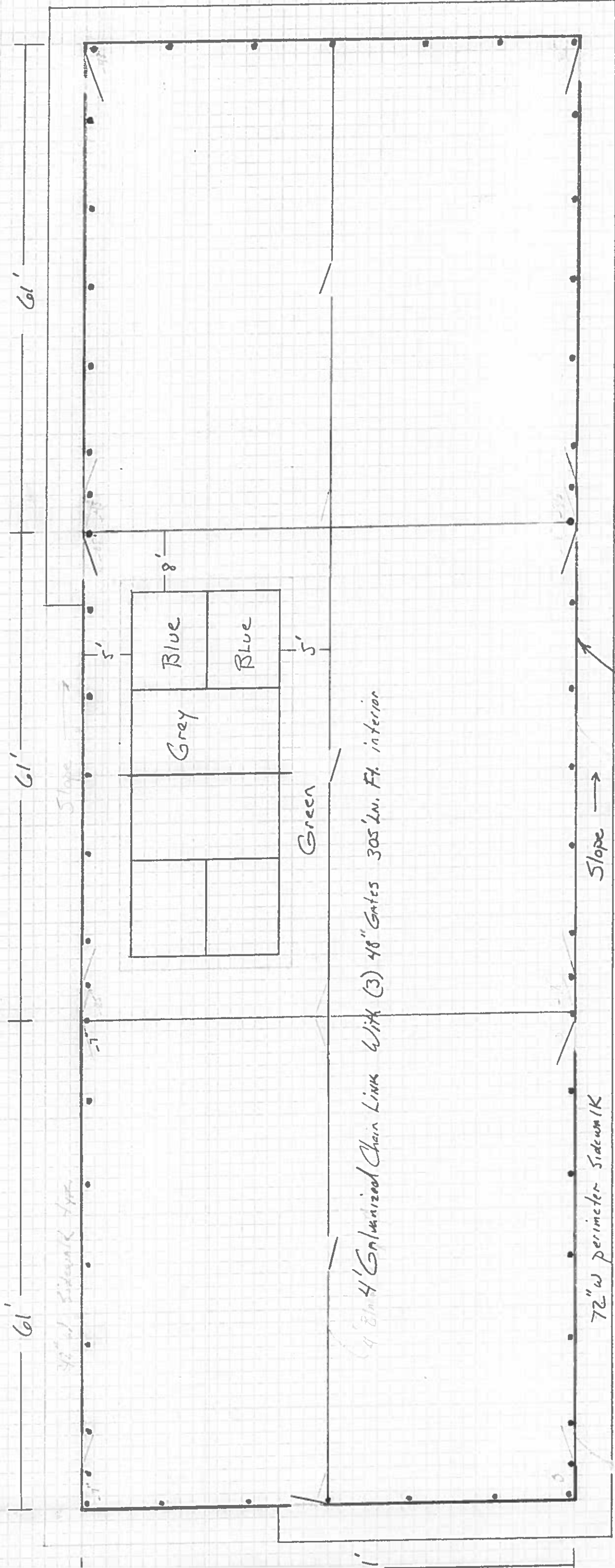

48\" x 8' Gate type (G)

8' Galvanized Chain link with 6 gates 488 Lu. Ft.