

REQUEST FOR PROPOSAL FORM

PROJECT: Pedestrian Bridge Erosion Repair
 OWNER: Town of Palmer Lake
 DUE DATE: Monday May 2, 2022, 5:00 p.m. MST

THE UNDERSIGNED PROPOSER, having familiarized himself with the conditions affecting the performance of the work and with the Contract Drawings, as prepared by GMS, Inc., Consulting Engineers and others, all of which are attached and made a part hereof, hereby proposes to furnish all plant, equipment, labor, materials and supervision to perform the work summarized hereafter for each proposal amount inserted.

The total proposal cost for each item includes all work necessary to complete that portion of the project described in each item and given on the Contract Drawings, and the total of all proposal costs represents the entire scope of work covered by the Contract Drawings. The proposal shall include all safety, protection and temporary containment measures necessary to preclude pedestrian traffic from interfering with work activities and to maintain public safety around the work site. The attached Contract Drawings Include:

1. Sheet 1 of 3 – West Abutment Plan, Pedestrian Bridge Erosion Repair, prepared by GMS, Inc. dated April 25, 2022
2. Sheet 2 of 3 – Section and Elevation, Pedestrian Bridge Erosion Repair, prepared by GMS, Inc. dated April 25, 2022
3. Sheet 3 of 3 – Riprap Plan, Pedestrian Bridge Erosion Repair, prepared by GMS, Inc. dated April 25, 2022
4. Sheet 1 – Temporary Clearance Envelope, Bridge Standards, prepared by UP/BNSF Railway, Inc. dated January 5, 2016

The Proposer certifies that this Proposal is genuine and is not made in the interest of, or on the behalf of, any undisclosed person, firm or corporation, and that this Proposal has been arrived at independently, without consultation, communication or agreement as to any matter relating to this Proposal with any other Proposer or competitor.

The Owner may select the proposal that best suits the Owner's needs for the project. The Owner reserves the right to reject a proposal if it does not support the Owner's best interest in completing the work.

WORK ITEM	PROPOSAL COST
No. 1: Furnish all labor, equipment and materials to install Flow-Fill erosion repair, including surface cleaning and preparation of existing soil and concrete footing; placement and support of formwork; placement, curing and finishing of Flow-Fill with fiber reinforcement and all miscellaneous items, complete in place.	\$ _____
No. 2: Furnish all labor, equipment and materials to install Riprap Erosion Protection, including installation and anchoring of filter fabric; placement of riprap; finishing and cleanup of disturbed areas and all miscellaneous items, complete in place.	\$ _____
TOTAL OF ALL PROPOSAL ITEMS	\$ _____

The Proposer will initiate construction activities by the following date: _____

The Proposer will complete construction activities by the following date: _____

Firm Name: _____ Phone Number: _____

Business Address: _____ By (title): _____

Signature: _____

Date: _____

MAIN LINE TRACK LOCATION IN 100' R.O.W.
 ACCOMMODATES FUTURE TRACKS EITHER SIDE (PER
 UP/BNSF GUIDELINES PLAN NO. 711100 SHT. 1)

REMOVE EXG POLES

FENCING TO BE PROVIDED MINIMUM 500' TOTAL CENTERED
 ON BRIDGE THIS PHASE - TYPICAL BOTH SIDES OF R.O.W.

EXISTING GRAVEL
 PAVED PARKING

LIMITS OF CONSTRUCTION

NEW CONC WALK

EXISTING DRIVE

FUTURE PIER PROTECTION TO BE
 PROVIDED IF 3RD SET OF FUTURE
 TRACKS ADDED EAST OF EXISTING
 TRACKS

LIMITS OF CONSTRUCTION

8' TALL HIGH TENSION WIRE NO-CLIMB FENCE
 - 300 LF EA. SIDE 2'-0" O.S. R.O.W.

NO WORK BEYOND THIS LINE
 THIS PHASE EXCEPT FENCE

NO WORK BEYOND THIS LINE
 THIS PHASE EXCEPT FENCE

100.00 R.O.W.

TOP TRAILS
 30.83

236.40

75.00

84.39

26

27

MILE MARKER 52 ±.24 MI. N.
 OF BRIDGE SITE (NO'S
 ASCEND TO S.)

EXG TRAIL TO REMAIN

EXG UPRR ACCESS RD

CONCRETE SLAB ON GRADE
 LANDINGS 3 LOCATIONS

GRAVEL TRAILS TYPICAL

FIBER OPTIC LINES - HAND
 LOCATE PRIOR TO EXCAVATION

CONC. & STEEL BRIDGE PIERS
 & FOUNDATIONS

EXISTING RETAINING WALLS

EXISTING TRAIL TO REMAIN

LIMITS OF CONSTR. THIS
 PHASE - GC PROVIDE TEMP
 SECURITY/CONSTR. FENCE ALL
 AROUND BOTH SIDES R.O.W.



HCDA
 HCDA ENGINEERING, INC.
 STRUCTURAL CONSULTANTS
 666 PUEBLO AVE SUITE 400
 COLORADO SPRINGS, COLORADO 80903
 (719) 535-7784 FAX (719) 571-3175

fisher architecture
 719-580-4356 www.fisharch.com
 po box 1395 palmer lake, co 80123

Palmer Lake
 Colorado
 Rockin' The
 Rails Park
 Pedestrian
 Bridge
 100% Design
 Submittal

Mile Post No. 52.24

Colo Springs Subdivision

Palmer Lake, CO

El Paso County

Latitude & Longitude

39.122872/-104.91345

ISSUED: 03/7/17

REVD: 11/9/17, 1/15/18, 1/30/18
 8/28/18, 9/18/18

DRAWN BY: WLF

CHECKED BY: JH/CG/JF

Bridge &
 Embankment
 Overall Site
 Plan

C1.1

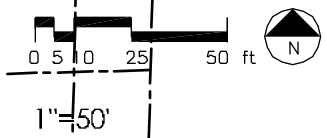

Bridge & Embankment Overall Site Plan

1"=50'

FENCING NOTES:

1. "EXCLUSION FENCE" PER COLORADO DEPT OF WILDLIFE GUIDE IS DESIGNED TO PREVENT PASSAGE OF LARGE WILDLIFE. DESIGN HAS BEEN ADAPTED W/ FINER WOVEN WIRE MESH TO BE "NO CLIMB".
2. INSTALL ALL FENCING IN COMPLIANCE W/ NATURAL RESOURCE, AGRICULTURE, AND ENGINEERING SERVICE - NRAES 11 "HIGH-TENSILE WIRE FENCING" INCLUDING ALL H (COMPRESSION) BRACES, BRACE WIRE, PINS, & STAPLES.
3. SEE OVERALL PLAN SHT C1.1 FOR ILOCATION AND EXTENT OF FENCING - CORRESPONDS TO CONSTRUCTION LIMITS THIS PHASE OF CONSTRUCTION.
4. ADDITIONAL FENCING TO BE PROVIDED IN FUTURE PARK CONSTRUCTION PHASES.

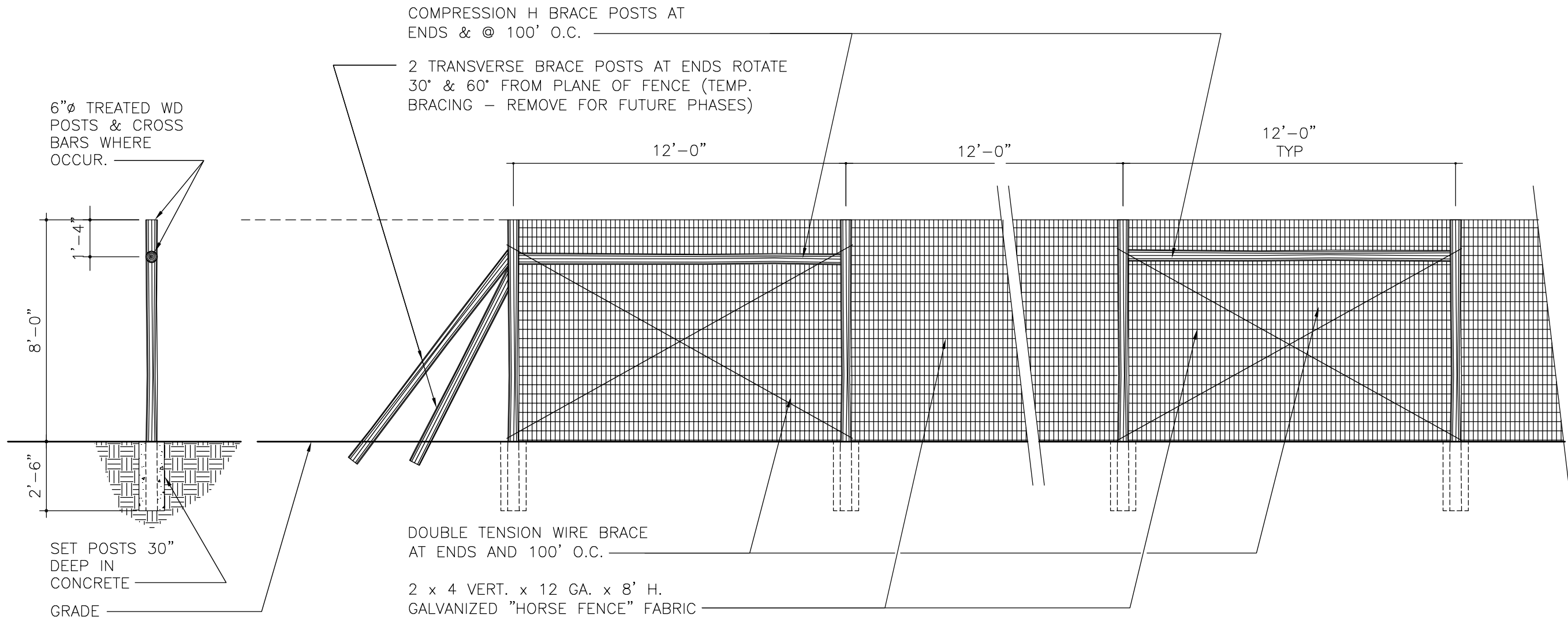

High Tension Wire Exclusion Fencing

1/4"=1'-0"



HCDA
 HCDA ENGINEERING, INC.
 STRUCTURAL CONSULTANTS
 545 E. PIKES PEAK AVENUE, SUITE 100
 COLORADO SPRINGS, COLORADO 80903
 (719)633-7784 FAX (719)471-3173

fisher architecture
 719-660-4356 www.fisharch.com
 po box 1395, palmer lake, co 80133

Palmer Lake
 Colorado

Rockin' The
 Rails Park

Pedestrian
 Bridge

Bridge Bid
 Set

Mile Post No. 52.24

Colo Springs Subdivision

Palmer Lake, CO

El Paso County

Latitude & Longitude

39.122872/-104.91345

ISSUED: 5/11/18

REVD: .

DRAWN BY: WLF

CHECKED BY: JH/CG/JF

High Tension
 Wire Exclusion
 Fencing

C3.1

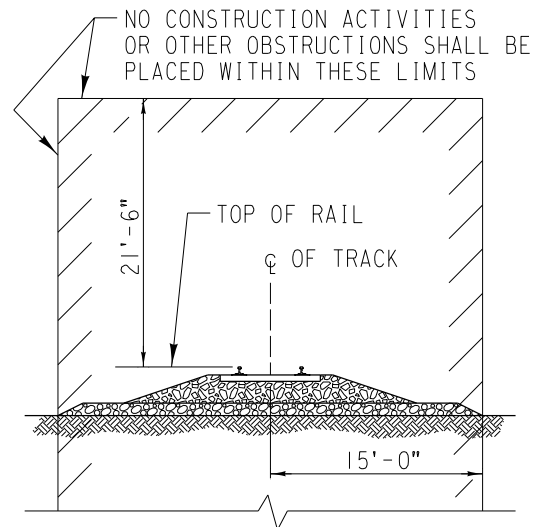

MINIMUM CONSTRUCTION CLEARANCE ENVELOPE
(NORMAL TO RAILROAD)



BNSF
RAILWAY

BRIDGE STANDARDS

GRADE SEPARATION GUIDELINES

**TEMPORARY CLEARANCE
ENVELOPE**

DESIGN BY: RAF	CHECKED BY: AMH
APPROVED:	
<i>Rick Friesen</i>	
UPRR - SENIOR MANAGER STRUCTURES DESIGN	
<i>Auston M. Huest</i>	
BNSF - ASSISTANT DIRECTOR STRUCTURES DESIGN	

FILE OWNER: UPRR	DATE: 1/05/16
PLAN NO.: 711000	SHEET: 1

PLOTTED: 5/12/2016 9:14:09 AM