

Memo

To: Honorable Mayor & City Council,

From: Utility Superintendent Victor Kane

CC: City Administrator Dylan Mulfinger

Reference: 1st Ave SE – Discussion

Date: 05/04/21

Greetings,

I would like to address a safety concern in the 200 block of 1st Ave SE and Rock Island Road. The issue is the angle at which this road section intersects the four lanes of Rock Island Road. Currently to exit from 1st onto the highway you have to look back over your shoulder to get a good visual angle. If you are pulling from Berryman's Family Dentistry to go north you actually end up pulling straight at the stop sign to attempt a legal stop. Causing you to block a portion of the roadway.

I believe the limited traffic count has helped hold down the number of incidents at this intersection over the years. Originally this section had a lumber yard driveway "sparsely used" followed by a residence and a car wash. The area is not a main outlet from any heavily populated residential area. Even the recent addition of the Berryman Dentistry office only adds sparse traffic. However, all of that is about to change with the increased traffic of the new Dollar General location. Thus, I have proposed three options for your consideration.

Option one is to allowing traffic flow as it currently exists.

Option two is make this a southbound one-way road. It will be an inconvenience for some as all access to the dentistry office will come off Rock Island Road. It would keep the traffic flow in one direction while stopping the increased traffic from exiting north onto the highway.

Option three is to not allow access north onto the highway from this road. Then you could access both businesses from either direction. While removing the unsafe situation created when exiting to the north onto the highway. We could do this with signage and crosshatch striping to indicate this is not a through road.

I believe the third option to be the best. Chief Logan has been consulted and is in agreement. I respectfully ask the council for approval to proceed with option three.

Thank you for your time.
Victor Kane

From the Desk of
Oelwein Utility Superintendent Victor Kane

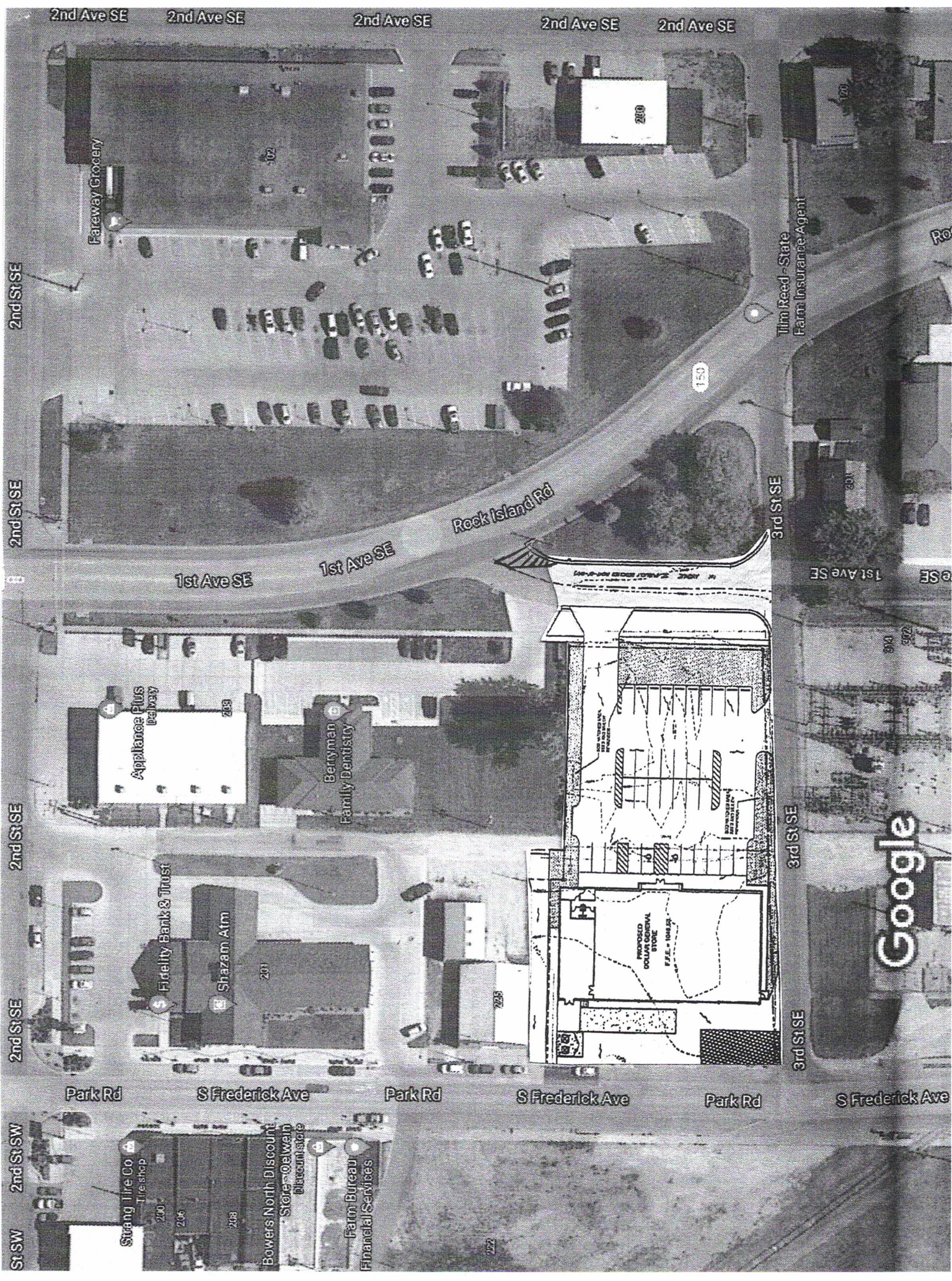

2nd Ave SE

2nd Ave SE

2nd Ave SE

2nd Ave SE

2nd Ave SE

2nd St SE

2nd St SE

2nd St SE

2nd St SE

2nd St SW

Fareway Grocery

Strang Tire Co
Tire Shop

Bowers North Discount
Stores @ Belwin
Discount Store

Farm Bureau
Financial Services

Appliance Plus
Delivery

Fidelity Bank & Trust

Shazam ATM

Beryman
Family Dentistry

1st Ave SE

1st Ave SE

Rock Island Rd

S Frederick Ave

Park Rd

S Frederick Ave

Tim Reed - State
Farm Insurance Agent

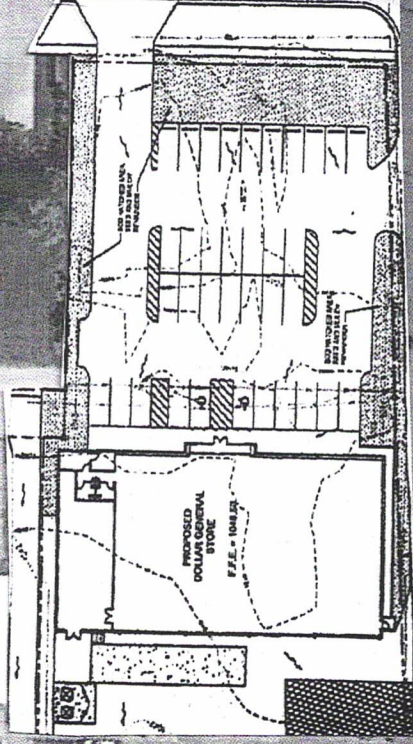

3rd St SE

3rd St SE

Google

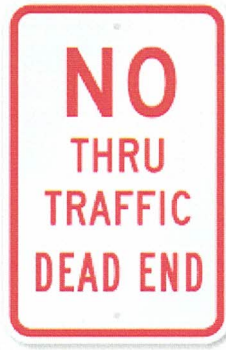

gg120782137 GoGraph.com

