



2020 Pool Season

Governors Proclamation 05-20-2020

C. Swimming Pools: A swimming pool, as defined in Iowa Code 135:1 may reopen for the limited purpose of lap swimming and conducting swimming lessons, but only to the extent that the establishment operating the pool takes reasonable measures under the circumstances of each establishment to ensure social distancing of employees and patrons, increased hygiene practices, and other public health measures to reduce the risk of transmission of COVID-19 consistent with guidance issued by the Iowa Department of Public Health. Except for these limited purposes, all swimming pools and spas, wading pools, water slides, wave pools, spray pads, and bathhouses, as defined in Iowa Code 135I.1, shall continue to be closed.

Entry

- Entry to parking lot barricaded off
- Traffic will flow in from the west and exit to north on 5th St.
- Rules will be delivered at this time
- \$1 entry fee, first come first serve, exact amount no change
- Allow 18 patrons in at a time for maximum time length of 40 min of swim time
- Time starts and ends at established schedule
- Everyone is tested and will not be allowed in with temp over 100 degrees
- All staff will wear a mask to enter facility and wear through the duration of shift
- Markings on the front entry for social distancing

Shower rooms

- Patrons must wearing swim suit/face mask to enter, bringing in only a towel and goggles
- Lockers are blocked off for no usage
- One lavatory available for usage in women's and men's sides
- Everyone required to shower before entering deck area
- Door to pool deck area remains open at all times
- Shower controls disinfected after each use

Deck area

- Water fountains not available
- Concessions area not open- roped off
- Slide not available – too many contact points
- Boards not available – too many contact points
- Tiki area not available – too many contact points
- Anyone breaking any rules will be asked to leave immediately
- All children must be accompanied by an adult
- Adult concession staff enforcing social distancing
- One deck chair will be put out for each lap lane for personal items
- Swimmers will be limited to that area of their seat on the deck
- All swimmers walk directly to lap area
- Swimmers stay in their area and not get out of the pool



PARKS / CEMETERY / AQUATICS / CAMPGROUND

Park and Recreation

Oelwein.fun

Staff

- Punch time cards not used – limit common areas
- Masked when enter property
- Disinfection every two hour turnover
- Need 4 guards on duty at all times when operating
- Manager on duty
- One front desk employee
- One staff member guiding traffic
- One person at the front door
- Two staff members ensuring social distancing/disinfecting
- 10 employees per hour of operation

Scheduling

- No pool parties – guards hours will be maxed to run facility as proposed

Weekday Times

- 7:00 to 9:00 Lap swim/aerobics
- 9:30 to 10:15 Swim Lessons
- 10:45 to 12:45 Lap Swim
- 1:15 to 1:45 Lap Swim
- 2:15 to 2:45 Lap Swim
- 3:15 to 4:00 Swim Lessons
- 4:30 to 5:15 Swim Lessons

Weekend Times

- 9:30 to 11:30 Lap Swim
- 12:00 to 2:00 Lap Swim
- 2:30 to 4:30 Lap Swim
- 5:00 to 7:00 Lap Swim

Hours

Weekdays

- 10 hours of operation daily
- 50 hours of operation x 10 employees = 500 hours per week
- 500/24 employees = 21 hours a week per employee

Weekends

- 9.5 hours operation daily
- 19 hours of operation x 10 employees = 190 hours per weekend
- 190 /24 employees = 9 hours a weekend per employee



PARKS / CEMETERY / AQUATICS / CAMPGROUND

Park and Recreation

Oelwein.fun

Levels: only offer 3 to reduce number of groups in the pool

- **Introductory** – similar to levels 1 and 2 or parent toddler. Getting kids used to the water. Family member will need to be in the water with kid to avoid contact.
- **Intermediate** – similar to levels 3 & 4. Possibly family member and/or will need guard assistance at times (This will be the hardest level to figure out because kids are old enough/good enough swimmers they don't like their parents help, but need some type of help)
- **Advanced** – levels 4, 5, and 6 – students in this group are either working on learning all of the strokes or have learned them and are working on mastering them.

*We need to stress students would not be tested during these lessons, but more so focused on getting kids in the water and keeping them swimming. Taking a year off swimming could have major effects on kids' swimming ability later.

Class sizes:

- Offer 3 courses at the same time (would each use different part of the pool)
 - Introductory: 3 students plus 3 adults plus 1 guard
 - Intermediate: 3 students plus 3 adults plus 1 guard
 - Advanced: 4 students plus 1 guard
 - Total of 19 people (does not include manager there)



Lap Swim Rules for 2020 Season

- Anyone that has experienced a fever and or has a temperature over 100 degrees will not be allowed entry
- Only swimmers will be allowed entry, no one sits on the deck to observe
- Social distancing of 6' is mandatory
- Adults may only supervise one child family member under 14 per visit
- Only family members of an immediate family household may play together in the pool
- Exact payment of \$1 at the front desk, no change given period.
- Take only essential items into facility and leave at assigned chair
- Everyone patron will wear a mask from their car until they shower, from shower to pool, when you exit the pool you will put mask back on until you get back into your vehicle.
- Everyone will shower before entering the pool deck area
- Proceed directly to the pool
- No concessions are available
- No reentry if need to leave the pool area for any reason



Staff Disinfections

- Disinfection of the facility with bleach/water solution – Morning, facility closures, end of the day
 - Bleach will be diluted to specifications by manager
- Front area
 - All counter tops
 - cash register
 - doors
 - all common touch areas
- Shower areas
 - All shower areas
 - Toilets
 - Sinks
 - floors
- Deck areas
 - Deck will be applied with bleach/water solution before start of the day and at end
 - Ladder handrails
 - Guard elevated stands will be wiped down
 - Shade structure posts
 - Dedicated chair for lap swimmer



PARKS / CEMETERY / AQUATICS / CAMPGROUND

Park and Recreation

Oelwein.fun

Budget

- 84 days normal operation

	FY 2016	FY 2017	FY 2018	FY 2019
Revenue	65,170.30	56,515.09	50,141.49	49,163.13
Expense	<u>112,033.09</u>	<u>118,429.24</u>	<u>100,076.17</u>	<u>101,765.42</u>
	46,862.79	61,914.15	49,934.68	52,602.29
Per day	557.89	737.07	594.46	626.21

Average per day **\$628.90**

Lap Swim

Charging \$1 admission per patron
 18 patrons / 2-hour increments / 4 sessions
\$72 per day in revenue x 70 days
\$5,040

Swim Lessons

Charging \$30 per student
 Three sessions x 27 kids per session
81 students x \$30
\$2,430

Total maximum revenue for season **\$7,470**

Full operational chemicals and utilities

- \$4-6k Hydrochloric acid – used to keep pool water pH in balance
- \$8-9k Chlorine/Stabilizer/Sunscreen/Shock
- \$25k Gas/electricity – varies depending on weather
- \$50k Wages

- 30 hours per week per employee x 24 employees =720 hours weekly
- Median \$8 x 720 hours x 10 weeks = \$57,600 in labor

Parking Lot Direction



- All vehicles enter from the west entrance
- Staff stops vehicles at check point to get head count
- Give list of rules and requirements
- Once limit of patrons is reached the west entrance will be blocked off and all others told to try again next session
- Proceed to parking spot and walk to entrance to pay
- After two hours everyone will exit the pool deck out the west gate to their vehicles
- All traffic will proceed to 5th street to leave property
- ½ hour of cleaning and disinfecting will commence

Flow of Patrons for Lap Swim

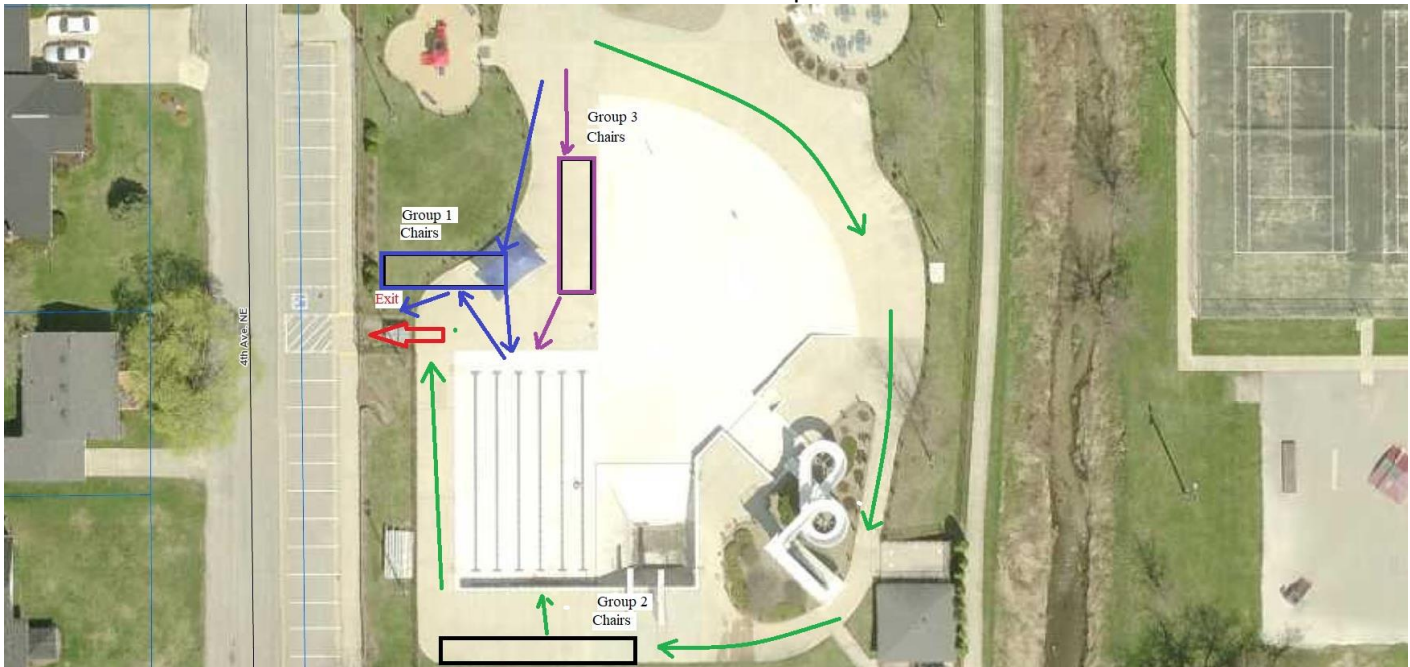

- Group 1 showers, leaves belongings on chairs and gets in pool for 40 min allotment
- Group 2 goes through showers and goes to their chairs and enter pool once group 1 has cleared the pool
- Group 3 gets ready and enters pool once group 2 has exited the pool.

Right now – other communities

- Grinnell Filling just to protect
- Sioux City Filling in next 2 weeks, won't open at least into June
- North Liberty Plan to fill and circulate by end of month to see if open
- Orange City Ready to fill
- Mason City Power washing not filling
- West Union Power washed waiting to see if can open
- Norwalk Cleaning and prepping in case open
- Oelwein Power washed waiting to see if can open
- Osceola Not Opening
- Mason City Not Opening
- Sergeant Bluff Not Opening
- Waukon Recommending to not open for season
- Vinton June 15th, in can't then July 1, then won't after that
- Cedar Rapids Not Opening
- Marion Not Opening
- Charles City Not Opening
- Calmar Not Opening
- Manchester Planning June 15
- Boone Not Opening

Parking Lot Direction



- All vehicles enter from the west entrance
- Staff stops vehicles at check point to get head count
- Give list of rules and requirements
- Once limit of patrons is reached the west entrance will be blocked off and all others told to try again next session
- Proceed to parking spot and walk to entrance to pay
- After two hours everyone will exit the pool deck out the west gate to their vehicles
- All traffic will proceed to 5th street to leave property
- ½ hour of cleaning and disinfecting will commence



PARKS / CEMETERY / AQUATICS / CAMPGROUND

Park and Recreation

Oelwein.fun

Swim Lessons

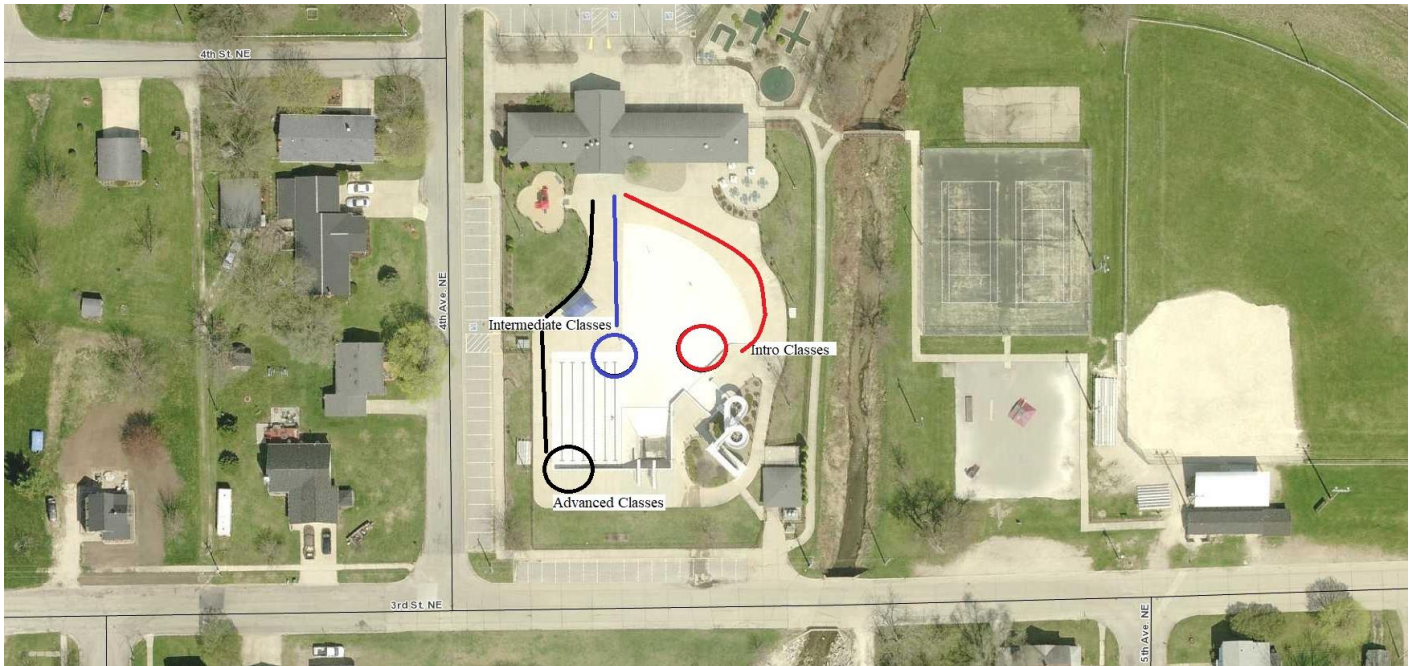

- Three levels of classes offered in two week increments
- Everyone exits through the west gate when done with lessons
- Parents/observers will not be allowed/unless assisting with lesson
- Direct routes from the shower house to the area of instruction