

OELWEIN EVENT CENTER PARKING LOT IMPROVEMENTS

FOR CITY OF OELWEIN OELWEIN, IOWA

23-500
FAYETTE COUNTY
JULY 2023

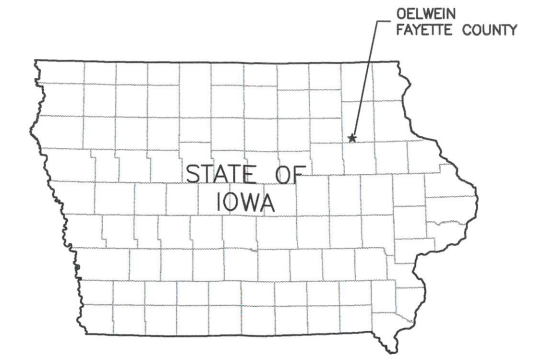

Sheet Number	Sheet Title
A.01	TITLE
A.02	LEGEND
C.01	GENERAL NOTES AND ESTIMATED QUANTITIES
C.02	SUPPLEMENTAL SPECIFICATIONS
C.03	NORTH PARKING LOT EXISTING CONDITION AND REMOVAL PLANS
C.04	EAST PARKING LOT EXISTING CONDITION AND REMOVAL PLANS
D.01	NORTH PARKING LOT SITE PLAN
D.02	EAST PARKING LOT SITE PLAN
D.03	NORTH PARKING LOT GRADING AND PAVING PLAN
D.04	EAST PARKING LOT GRADING AND PAVING PLAN
M.01	NORTH PARKING LOT STORMWATER PLAN & PROFILE

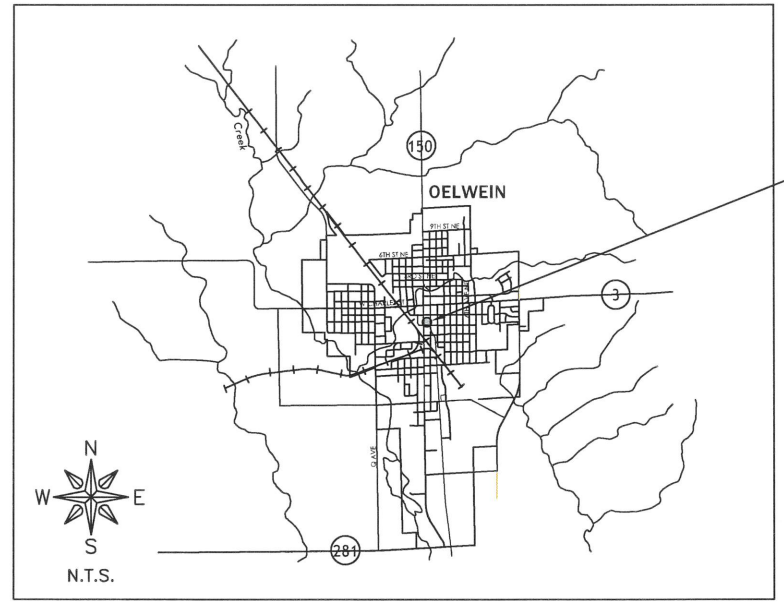

LOCATION MAP

OWNER/DEV	CITY OF OELWEIN
ADDRESS	20 2ND AVE. SW
	OELWEIN, IOWA 50662
P#	319-283-5440
F#	319-283-4032

CITY ADMINISTRATION	
MAYOR.....	BRETT DEVORE
COUNCIL MEMBERS.....	DAVID GARRIGUS
	DAVE LENZ
	LYNDA PAYNE
	KAREN SEEDERS
	TOM STEWART
	MATT WEBER
CITY ADMINISTRATOR.....	DYLAN MULFINGER
CITY CLERK.....	BARBARA RIGDON

UTILITIES	
UTILITY TYPE	COMMON NAME
WATER & SEWER	OELWEIN, CITY OF
ELECTRIC	ALLIANT
TELEPHONE	CENTURY LINK
GAS	ALLIANT
CABLE	MEDIACOM

(CONTRACTOR TO BE RESPONSIBLE FOR COORDINATING ANY ADJUSTMENTS TO BE MADE.)

FEHR GRAHAM

ENGINEERING & ENVIRONMENTAL

ILLINOIS IOWA WISCONSIN

WEST UNION, IOWA
128 S VINE STREET
WEST UNION, IA 52175
P# (563) 422-5131

THE 2023 VERSION OF THE STATEWIDE URBAN STANDARD SPECIFICATIONS FOR PUBLIC IMPROVEMENTS, ALSO KNOWN AS SUDAS (2023), PLUS FEHR GRAHAM SUPPLEMENTAL SPECIFICATIONS AND SPECIAL PROVISIONS SHALL APPLY TO CONSTRUCTION WORK ON THIS PROJECT.

BID SET

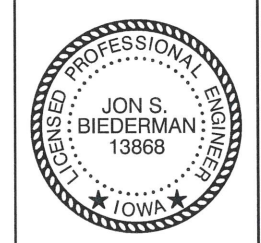

I hereby certify that this engineering document was prepared by me or under my direct personal supervision and that I am a duly licensed Professional Engineer under the laws of the State of Iowa.

[Signature] 7/9/2023
Date

Jon S. Biederman, P.E.
License Number 13868
My license renewal date is December 31, 2024.
Pages or sheets covered by this seal: All

ORIGINAL SET FOR PROJECT: 23-500		DATE CREATED: JULY 2023
REVISIONS		
REV. NO.	DESCRIPTION	DATE

ABBREVIATIONS

<	ANGLE
ABC	AGGREGATE BASE COURSE
ACI	ACRE(S)
ACI	AMERICAN CONCRETE INSTITUTE
AGR	AGGREGATE
AISC	AMERICAN INSTITUTE OF STEEL CONSTRUCTION
ALT	ALTERNATE
ARCH	ARCHITECT
ASPH	ASPHALT
ASTM	AMERICAN SOCIETY OF TESTING AND MATERIALS
B	BALL VALVE
BFP	BACKFLOW PREVENTER
BIT	BITUMINOUS
BLDG	BUILDING
BLK	BLOCKING
BM	BENCHMARK
BOT	BOTTOM
BSMT	BASEMENT
BV	BUTTERFLY VALVE
B-B	BACK-TO-BACK OF CURB DIMENSION
CL or C	CENTERLINE
C to C	CENTER TO CENTER
C & G	CURB AND GUTTER
CF	CUBIC FEET
CHD	CHORD LENGTH
CI	CAST IRON PIPE
CHK	CHECK VALVE
CLR	CLEAR
CMP	CORRUGATED METAL PIPE
CMU	CONCRETE MASONRY UNIT
CTY	COUNTY
CONC	CONCRETE
CONT	CONTINUOUS
C-B	CENTERLINE TO BACK OF CURB DIMENSION
COORD	COORDINATE
CU	COPPER PIPING
CTRS	CENTERS
CY	CUBIC YARDS
CS	CORPORATION STOP
D	DEGREE OF CURVE
DEP	DEPRESSED
DET	DETAIL
DIAG	DIAGONAL
DIM	DIMENSION
DI	DUCTILE IRON PIPE
DN	DOWN
DNSTR	DOWNSTREAM
DP	DRAINAGE PIPE/STORM PIPE
DWG	DRAWING
E	EAST
EJ	EXPANSION JOINT
EL	ELEVATION
EP	EDGE OF PAVEMENT
EQUIP	EQUIPMENT
EQUIV	EQUIVALENT
EW	EACH WAY
EXP	EXPANSION
EX, EXIST	EXISTING
EXT	EXTERIOR
E =	EXTERNAL DISTANCE
FD	FLOOR DRAIN
FDN	FOUNDATION
FE	FIELD ENTRANCE
FF	FINISH FLOOR
FIL	FILLET
FIN	FINISH
FL	FLOW LINE
FLR	FLOOR
FM	FORCE MAIN
FND	FOUND
FRMG	FRAMING
FTG	FOOTING
F-F	FACE TO FACE
GA	GAUGE
GI	GALVANIZED IRON PIPE
GRD	GRADE
GRS	GRATING SUPPORT
GRT	GROUT
GV	GAS VALVE
GYP	GYPSUM
HSE	HOUSE
HC	HORIZONTAL CURVE
HMA	HOT MIX ASPHALT
HNGR	HANGER
HORIZ	HORIZONTAL
H.P.	HIGH POINT
HW	HOT WATER
HWH	HOT WATER HEATER
I	IN
ID	INSIDE DIAMETER
INT	INTERIOR
INV	INVERT ELEVATION; BASED ON BENCH MARK DATUM
IP	IRON PIPE
JST	JOIST
L	LENGTH OF CURVE
LAT	LATERAL
LAV	LAVATORY
LF	LINEAL FEET
L.P.	LOW POINT
LT	LEFT OF SURVEY BASE LINE
MAX	MAXIMUM
ME	MATCH EXISTING
MH	MANHOLE
MIN	MINIMUM
MJ	MECHANICAL JOINT
MTL	METAL
N	NORTH
No. or #	NUMBER
NOM	NOMINAL
NTS	NOT TO SCALE
OC	ON CENTER
OD	OUTSIDE DIAMETER
OO	OUTSIDE TO OUTSIDE
OPNG	OPENING
OPP	OPPOSITE
PC	POINT OF CURVATURE
PCC	PORTLAND CEMENT CONCRETE
PCF	POUNDS PER CUBIC FOOT
PDP	PERFORATED DRAIN PIPE

PE	POLYETHYLENE PIPE
PI	POINT OF INTERSECTION
PL	PLATE
PLG	PLUG VALVE
PLP	POLYPROPYLENE PIPE
PLYWD	PLYWOOD
PM	PRINCIPAL MERIDIAN
PR	PRESSURE REGULATORS
PRC	POINT OF REVERSE CURVATURE
PRESS	PRESSURE
PR, PROP	PROPOSED
PRV	PRESSURE REDUCING VALVE
PSF	POUNDS PER SQUARE FOOT
PSI	POUNDS PER SQUARE INCH
PSL	PIPE SLEEVE
PT	POINT OF TANGENCY
PLG	PLUG VALVE
PVC	POLYVINYL CHLORIDE (PLASTIC) PIPE
R	RADIUS
RDCR	REDUCER
RCCP	REINFORCED CONCRETE CYLINDER PIPE
RCP	REINFORCED CONCRETE PIPE
RD	ROOF DRAIN
REINF	REINFORCING
REQD	REQUIRED
ROW	RIGHT OF WAY
RFT	RAFTER
RND	ROUND
RMR	RAILROAD
RRSP	RAILROAD SPIKE
RT	RIGHT
R&R	REMOVE AND REPLACE
S	SOUTH
SB	STREAM BED
SCHED	SCHEDULE
SEC	SECTION
SF	SQUARE FEET
SHR	SHOWER
SHT	SHEET
SHTG	SHEATHING
SP	SANITARY PIPE
SPA	SPACING OR SPACES
SPEC	SPECIFICATION
SQ	SQUARE
SS	SANITARY SERVICE
STA	STATION
STD	STANDARD
STL	STEEL
STRUCT	STRUCTURAL
SW	SIDEWALK
SY	SQUARE YARDS
SYM	SYMMETRICAL
TAN	TANGENT LENGTH
TBC	TOP BACK OF CURB
TBM	TEMPORARY BENCH MARK; BASED ON BENCHMARK DATUM
TD	TILE DRAIN
THK	THICK
TR	TREAD
TY	TYPE
TYP	TYPICAL
U.O.N.	UNLESS OTHERWISE NOTED
UP	UTILITY POLE
UPSTR	UPSTREAM
UR	URINAL
USGS	US GEOLOGICAL SURVEY
VC	VERTICAL CURVE
VCP	VITRIFIED CLAY PIPE
VERT	VERTICAL
VOL	VOLUME
VPC	VERTICAL POINT OF CURVATURE
VPI	VERTICAL POINT OF INTERSECTION
VPRC	VERTICAL POINT OF REVERSE CURVATURE
VPT	VERTICAL POINT OF TANGENCY
W	WEST
WC	WATER CLOSET
WF	WIDE FLANGE
WM	WATER MAIN
WMQ	WATER MAIN QUALITY
WV	WATER VALVE
WGT	WEIGHT
WP	WEATHER PROOF
WS	WATER SERVICE
WWF	WELDED WIRE FABRIC
W	WITH
W/O	WITHOUT
XP	EXPLOSION PROOF

HATCH PATTERNS

	EARTH - FILL		BRICK
	EARTH - UNDISTURBED		STEEL
	ROCK (GEOLOGICAL)		INSULATION (LOOSE/ BATT)
	STONE OR RIP RAP		INSULATION (RIGID)
	GRAVEL		WOOD (ROUGH)
	CONCRETE		WOOD (BLOCKING)
	CONCRETE BLOCK		WOOD (FINISH)
	CMU		DETECTABLE WARNING
	ASPHALT PAVEMENT		

SYMBOLS

EXISTING		CIVIL		PROPOSED	
	EXISTING R.O.W.		RIGHT-OF-WAY LINE		PROPOSED R.O.W.
	PROPERTY LINE		CENTERLINE		SETBACK LINE
	EASEMENT LINE		SECTION LINE		SECTION CORNER
	COORDINATE POINT ON GRID SYSTEM		FOUND OR SET PROPERTY PIN		RIGHT-OF-WAY MARKER
	BENCHMARK		CONTOUR LINE		SPOT ELEVATION (AT)
	FENCE LINE		TIP OUT CURB AND GUTTER		SAWCUT, LIMITS OF PAVEMENT REMOVAL & REPLACEMENT
	DECIDUOUS TREE W/ SIZE		CONIFEROUS TREE W/ SIZE		TREE STUMP
	HEDGEROW		BUSH OR SHRUB		TREE LINE
	CONSTRUCTION LIMIT LINE		SIGN (MULTIPLE POST, SINGLE POST, STREET SIGN)		GUARD RAIL
	RAILROAD TRACKS		BUILDING		MAILBOX
	FLAGPOLE		BOLLARD		AIR CONDITIONER
EXISTING		MISC		PROPOSED	
	S.B. #XX		MONITORING WELL		S.B. #XX
	REVISION NUMBER		OUTLINE OF DETAILED AREA		SECTION NUMBER - SHEET WHERE SHOWN
EXISTING		SANITARY SEWER		PROPOSED	
	SANITARY SEWER		SANITARY SEWER		SANITARY SEWER SERVICE
	SANITARY SEWER FORCE MAIN		SANITARY SEWER FORCE MAIN		SANITARY CLEANOUT
	SANITARY MANHOLE		SANITARY MANHOLE		WYE FITTING

EXISTING		WATER		PROPOSED	
	WATER SERVICE		WATER SERVICE		WATER PIPE
	FIRE HYDRANT		FIRE HYDRANT		YARD HYDRANT
	WATER VALVE WITH BOX		WATER VALVE WITH BOX		CURB STOP W/CURB BOX
	REDUCER		REDUCER		WATER VALVE VAULT
	11.25' BEND		11.25' BEND		22.50' BEND
	45' BEND		45' BEND		90' BEND
	TEE		TEE		CAP
	WATER METER		WATER METER		SPRINKLER HEAD
	TRACER WIRE BOX		TRACER WIRE BOX		
EXISTING		STORM SEWER		PROPOSED	
	STORM SEWER		STORM SEWER		DRAIN TILE
	DITCH LINE (PAVED)		DITCH LINE (PAVED)		DITCH LINE (UNPAVED)
	STORM MANHOLE		STORM MANHOLE		CATCH BASIN
	STORM SEWER INLET		STORM SEWER INLET		STORM SEWER INLET - BEHIND CURB
	DOWNSPOUT		DOWNSPOUT		CULVERT AND SIZE
	RCCP OR RCP EQRS (RCAP) END SECTION		RCCP OR RCP EQRS (RCAP) END SECTION		METAL OR HDPE END SECTION
	FLOW DIRECTION		FLOW DIRECTION		
EXISTING		EROSION CONTROL		PROPOSED	
	EROSION CONTROL BLANKET		EROSION CONTROL BLANKET		TEMPORARY AND PERMANENT SEEDING AREA
	UNDISTURBED AREA		UNDISTURBED AREA		STABILIZED CONSTRUCTION ENTRANCE
	INLET PROTECTION		INLET PROTECTION		TEMPORARY SEDIMENT TRAP
	CULVERT INLET PROTECTION		CULVERT INLET PROTECTION		ROCK OUTLET PROTECTION
	ROCK CHECK DAM - COURSE AGGREGATE		ROCK CHECK DAM - COURSE AGGREGATE		ROCK CHECK DAM - RIP RAP
	DITCH CHECK		DITCH CHECK		

EXISTING		UTILITY		PROPOSED	
	FIBER OPTIC LINE		FIBER OPTIC LINE		UNDERGROUND TV CABLE
	CABLE TV RISER PEDESTAL		CABLE TV RISER PEDESTAL		OVERHEAD UTILITY
	UNDERGROUND ELECTRIC		UNDERGROUND ELECTRIC		ELECTRIC RISER PEDESTAL
	ELECTRIC MANHOLE		ELECTRIC MANHOLE		UNDERGROUND TELEPHONE
	TELEPHONE RISER PEDESTAL		TELEPHONE RISER PEDESTAL		TELEPHONE MANHOLE
	UTILITY POLE		UTILITY POLE		UTILITY POLE W/ METER
	UTILITY POLE W/ TRANSFORMER		UTILITY POLE W/ TRANSFORMER		UTILITY POLE W/ LIGHT
	UTILITY POLE WITH GUY WIRE AND ANCHOR		UTILITY POLE WITH GUY WIRE AND ANCHOR		LIGHT (MAST MOUNTED)
	LIGHT POLE (SINGLE FIXTURE)		LIGHT POLE (SINGLE FIXTURE)		YARD LIGHT
	GAS MAIN		GAS MAIN		GAS METER
	GAS VALVE		GAS VALVE		GAS STRUCTURE
	TRANSFORMER		TRANSFORMER		GENERATOR
EXISTING		TRAFFIC RELATED		PROPOSED	
	CONTROLLER		CONTROLLER		MAST ARM ASSEMBLY AND POLE
	SIGNAL HEAD AND POST		SIGNAL HEAD AND POST		SIGNAL HEAD
	PEDESTRIAN HEAD		PEDESTRIAN HEAD		PEDESTRIAN PUSH-BUTTON
	HAND HOLE		HAND HOLE		DOUBLE HAND HOLE
	HAND HOLE OR JUNCTION BOX		HAND HOLE OR JUNCTION BOX		HEAVY-DUTY HAND HOLE
	EXISTING CONDUIT (LENGTH AND SIZE) PROP GALVANIZED STEEL OR PVC CONDUIT UPPER NUMERAL INDICATES LENGTH "T" INDICATES CONDUIT IN TRENCH "P" INDICATED CONDUIT PUSHED LOWER NUMERAL INDICATES SIZE AND TYPE		EXISTING CONDUIT (LENGTH AND SIZE) PROP GALVANIZED STEEL OR PVC CONDUIT UPPER NUMERAL INDICATES LENGTH "T" INDICATES CONDUIT IN TRENCH "P" INDICATED CONDUIT PUSHED LOWER NUMERAL INDICATES SIZE AND TYPE		LUMINAIRE
	ARROW - THROUGH, TURN LEFT		ARROW - THROUGH, TURN LEFT		ARROW - THROUGH
	ARROW - TURN LEFT		ARROW - TURN LEFT		ARROW - TURN RIGHT
	ARROW - TURN RIGHT		ARROW - TURN RIGHT		ONE DIRECTION TURN ONLY
	HANDICAPPED PARKING STALL		HANDICAPPED PARKING STALL		TRAFFIC DETECTOR LOOP
	TRAFFIC CONTROL BOX		TRAFFIC CONTROL BOX		

FEHR GRAHAM
ENGINEERING & ENVIRONMENTAL

ILLINOIS
IOWA
WISCONSIN

OWNER/DEVELOPER:
CITY OF OELWEIN
20 2ND AVE. SW
OELWEIN, IOWA 50662

PROJECT AND LOCATION:
OELWEIN EVENT CENTER PARKING
LOT IMPROVEMENTS
OELWEIN, IOWA

DRAWN BY: LTF
APPROVED BY: JSB
DATE: JULY 2023
SCALE: AS NOTED

REVISIONS		
REV. NO.	DESCRIPTION	DATE

DRAWING:
LEGEND

SET TYPE: BID SET
G:\C30\23\23-500\Plans\23-500 Plans.dwg, A.02

JOB NUMBER:
23-500

SHEET NUMBER:
A.02

GENERAL NOTES

1. ALL WORK SHALL CONFORM TO AND BE PERFORMED IN ACCORDANCE WITH ALL APPLICABLE CODES AND ORDINANCES.
2. THE URBAN STANDARD SPECIFICATIONS FOR PUBLIC IMPROVEMENTS (SUDAS), 2023 EDITION PLUS SUPPLEMENTAL SPECIFICATIONS AND SPECIAL PROVISIONS AS PREPARED BY FEHR GRAHAM SHALL BE CONSIDERED A PART OF THESE DOCUMENTS AS IF BOUND HEREIN.
3. THE QUANTITIES INDICATED ON THE PROPOSAL FORM ARE APPROXIMATE ONLY, AND DO NOT CONSTITUTE A WARRANTY OR GUARANTEE BY THE JURISDICTION AS TO THE ACTUAL QUANTITIES INVOLVED IN THE WORK. SUCH QUANTITIES ARE TO BE USED FOR THE PURPOSE OF COMPARISON OF BIDS AND DETERMINING THE AMOUNT OF BID SECURITY, CONTRACT, AND PERFORMANCE, PAYMENT, AND MAINTENANCE BOND. IN THE EVENT OF DISCREPANCIES BETWEEN UNIT PRICES AND UNIT PRICE EXTENSIONS LISTED IN A BIDDER'S PROPOSAL, UNIT PRICES SHALL GOVERN AND UNIT PRICE EXTENSIONS SHALL BE CORRECTED, AS NECESSARY, FOR AGREEMENT WITH UNIT PRICES. THE JURISDICTION EXPRESSLY RESERVES THE RIGHT TO INCREASE OR DECREASE THE QUANTITIES DURING CONSTRUCTION, AND TO MAKE REASONABLE CHANGES IN DESIGN, PROVIDED SUCH CHANGES DO NOT MATERIALLY CHANGE THE INTENT OF THE CONTRACT. THE AMOUNT OF WORK TO BE PAID FOR SHALL BE BASED UPON THE ACTUAL QUANTITIES PERFORMED.
4. CONSTRUCTION SURVEY FOR THIS PROJECT TO BE PROVIDED BY THE OWNER. THE CONTRACTOR IS REQUIRED TO PROVIDE MINIMUM OF TWO BUSINESS DAYS' NOTICE TO THE ENGINEER WHEN REQUESTING STAKES.
5. THE CONTRACTOR SHALL NOTIFY ALL APPROPRIATE ENGINEERING DEPARTMENTS AND UTILITY COMPANIES PRIOR TO CONSTRUCTION. ALL NECESSARY PRECAUTIONS SHALL BE TAKEN TO AVOID DAMAGE TO ANY EXISTING UTILITY. IOWA CODE 480, UNDERGROUND FACILITIES INFORMATION, REQUIRES NOTICE TO IOWA ONE CALL (1-800-292-8989) NOT LESS THAN 48 HOURS BEFORE EXCAVATION, EXCLUDING WEEKENDS AND LEGAL HOLIDAYS.
6. THE LOCATION OF EXISTING UNDERGROUND UTILITIES AND ROCK ELEVATIONS ARE SHOWN IN AN APPROXIMATE WAY ONLY AND HAVE NOT BEEN INDEPENDENTLY VERIFIED BY THE OWNER OR ITS REPRESENTATIVE. THE CONTRACTOR SHALL DETERMINE THE EXACT LOCATION OF ALL EXISTING UTILITIES AND ROCK ELEVATIONS BEFORE COMMENCING WORK, AND AGREES TO BE FULLY RESPONSIBLE FOR ANY AND ALL DAMAGES WHICH MIGHT BE OCCASIONED BY THE CONTRACTOR'S FAILURE TO LOCATE AND PRESERVE ANY AND ALL UNDERGROUND UTILITIES AND ROCK ELEVATIONS.
7. THE CONTRACTOR SHALL VISIT THE SITE AND INSPECT THE PROJECT AREA AND BECOME THOROUGHLY FAMILIAR WITH THE ACTUAL JOB CONDITIONS PRIOR TO BIDDING AND THE START OF ANY WORK. FAILURE TO VISIT THE SITE SHALL NOT RELIEVE THE CONTRACTOR FROM PERFORMING THE WORK IN ACCORDANCE WITH THESE DRAWINGS.
8. THE CONTRACTOR SHALL VERIFY AT THE SITE, ALL DIMENSIONS AND CONDITIONS SHOWN ON THE DRAWINGS, AND SHALL NOTIFY THE ENGINEER OF ANY DISCREPANCIES, OMISSIONS, AND/OR CONFLICT PRIOR TO PROCEEDING WITH THE WORK.
9. THE CONTRACTOR SHALL NOT SCALE DRAWINGS. DIMENSIONS SHALL GOVERN. LARGE SCALE DRAWINGS SHALL GOVERN OVER SMALL SCALE DRAWINGS. NOTES AND DETAILS ON THE DRAWINGS SHALL APPLY TO ALL SIMILAR CONDITIONS WHETHER THEY ARE REPEATED OR NOT.
10. THE CONTRACTOR SHALL BE RESPONSIBLE FOR ANY DAMAGE TO EXISTING FACILITIES OUTSIDE THE CONSTRUCTION LIMITS RESULTING FROM NEGLIGENCE.
11. CONTRACTOR SHALL PROTECT EXISTING FACILITIES, BUILDINGS, AND OTHER APPURTENANCES NOT TO BE REMOVED FROM THE SITE DURING THE CONSTRUCTION ACTIVITIES.
12. CONTRACTOR SHALL CONFINE HIS WORK TO THE CONSTRUCTION LIMITS AND EASEMENTS. IF THE CONTRACTOR OBTAINS ADDITIONAL EASEMENT FOR THE STORAGE OF EQUIPMENT AND MATERIALS, COPIES OF THE AGREEMENTS WITH THE PROPERTY OWNERS SHALL BE PROVIDED TO THE OWNER.
13. CONTRACTOR SHALL SUBMIT A DETAILED CONSTRUCTION SCHEDULE AND STAGING PLAN A MINIMUM OF TWO (2) DAYS PRIOR TO THE PRECONSTRUCTION MEETING.
14. CONTRACTOR SHALL BE RESPONSIBLE TO MAINTAIN ACCESS TO INDIVIDUAL PROPERTIES DURING CONSTRUCTION WHENEVER PRACTICAL. CONTRACTOR SHALL NOTIFY RESIDENTS OF ACCESS RESTRICTIONS MINIMUM OF 24 HOURS PRIOR TO REMOVAL OF EXISTING ACCESS.
15. CONTRACTOR SHALL SUBMIT FOR ACCEPTANCE WORK PLANS AND SCHEDULES FOR ACCOMPLISHMENT OF TEMPORARY AND PERMANENT EROSION CONTROL PRIOR TO THE START OF CONSTRUCTION.
16. CONTRACTOR SHALL COORDINATE TEMPORARY DISRUPTION OF UTILITY SERVICES WITH THE CITY OF OELWEIN, AFFECTED UTILITY COMPANIES AND/OR AFFECTED PROPERTY OWNERS WHEN RELOCATING EXISTING FACILITIES, CONNECTING TO EXISTING FACILITIES AND PLACING NEW SERVICES.

ESTIMATED QUANTITIES

NO.	CODE	DESCRIPTION	QUANTITY	UNIT
1	2010-D-3	TOPSOIL, OFF-SITE, 10" THICK	68.00	CY
2	2010-E	EXCAVATION, CLASS 10	1565.00	CY
3	2010-I	SUBGRADE TREATMENT, ENGINEERING FABRIC	189.50	SY
4	2010-J	SUBBASE, CRUSHED STONE, MODIFIED	1810.75	TON
5	2010-999-A	CRUSHED STONE, SALVAGE AND PLACE	120.00	TON
6	2010-999-B	LANDSCAPE ROCK, 3/4" DIA	42.00	TON
7	4020-A-1	STORM SEWER, TRENCHED, DUAL WALL HDPE, 8" DIA.	36.00	LF
8	4020-A-1	STORM SEWER, TRENCHED, DUAL WALL HDPE, 10" DIA.	85.00	LF
9	6010-B	INTAKE, SW-512, 24" DIA, WITH PCC BOXOUT	1.00	EA
10	6010-B	INTAKE, SW-512, 12" DIA	1.00	EA
11	6010-G	CONNECTION TO EXISTING INTAKE	1.00	EA
12	7010-A	PAVEMENT, PCC, REINFORCED, 8" THICK	40.60	SY
13	7010-A	PAVEMENT, PCC, REINFORCED, 7" THICK	93.30	SY
14	7010-E	CURB AND GUTTER, PCC, 2'+/- WIDE, 8" THICK	162.50	LF
15	7020-B	PAVEMENT, ASPHALT, 4" THICK	2785.20	SY
16	7030-A	REMOVAL OF SIDEWALK	211.10	SY
17	7030-E	SIDEWALK, PCC, REINFORCED, 6" THICK	301.90	SY
18	7030-F	BRICK/PAVER SIDEWALK BAND, SALVAGE AND REPLACE	1.00	LS
19	7030-G	DETECTABLE WARNING	22.00	SF
20	7040-H	PAVEMENT REMOVAL	2605.60	SY
21	7040-I	CURB AND GUTTER REMOVAL	15.00	LF
22	7999-A	WHEEL STOP	29.00	EA
23	8020-B	PAINTED PAVEMENT MARKINGS, SOLVENT/WATERBORNE	1.00	LS
24	8030-A	TEMPORARY TRAFFIC CONTROL	1.00	LS
25	8040-A	TRAFFIC SIGNS	6.00	EA
26	9010-A	CONVENTIONAL SEEDING, FERTILIZING, AND MULCHING	0.09	AC
27	11,020-A	MOBILIZATION	1.00	LS



ILLINOIS
IOWA
WISCONSIN

OWNER/DEVELOPER:
CITY OF OELWEIN
20 2ND AVE. SW
OELWEIN, IOWA 50662

PROJECT AND LOCATION:
OELWEIN EVENT CENTER PARKING
LOT IMPROVEMENTS
OELWEIN, IOWA

DRAWN BY: LTF
APPROVED BY: JSB
DATE: JULY 2023
SCALE: AS NOTED

REVISIONS		
REV. NO.	DESCRIPTION	DATE

DRAWING:
GENERAL NOTES AND ESTIMATED QUANTITIES

SET TYPE: BID SET
G:\C30\23\23-500\Plans\23-500 Plans.dwg, C:01

JOB NUMBER:
23-500

SHEET NUMBER:
C.01

DIVISION 1 – GENERAL PROVISIONS AND COVENANTS

SECTION 1010
1.03 – DEFINITIONS AND TERMS
JURISDICTION: THE JURISDICTION IS THE CITY OF OELWEIN. ANY REFERENCE TO EITHER SHALL BE CONSIDERED ONE IN THE SAME.

SECTION 1020
1.14 – OPENING OF PROPOSALS
ONLY BID TOTALS WILL BE MADE PUBLICLY AVAILABLE AT AND IMMEDIATELY AFTER THE BID OPENING. AN ITEMIZED BID TABULATION WILL BE MADE PUBLICLY AVAILABLE FOR INTERESTED PARTIES AFTER THE PROJECT HAS BEEN AWARDED BY THE OWNER.

SECTION 1030
1.02 – RELEASE OF BID SECURITY
A. THE JURISDICTION SHALL RETAIN THE BID SECURITY OF THE LOWEST THREE BIDDERS. THE BID SECURITIES OF THE THREE LOWEST BIDDERS WILL BE RELEASED AFTER THE JURISDICTION'S APPROVAL OF THE CONTRACT EXECUTED BY THE LOWEST RESPONSIVE, RESPONSIBLE BIDDER.

SECTION 1040
1.05 – PLANS
SUDAS STANDARD SPECIFICATIONS APPLY. IN ADDITION TO SECTION 1040–1.05 THE FOLLOWING APPLY.
A. CONTRACTOR'S BIDS SHALL BE BASED ON THE FINAL PLANS AND ANY ADDENDUM RECEIVED.
C. CAD FILES OR ELECTRONIC SURFACE INFORMATION WILL BE MADE AVAILABLE AS AN ELECTRONIC FILE TO THE CONTRACTOR FOLLOWING AWARD OF THE PROJECT. SINCE REVISIONS OR ADDITIONS TO ELECTRONIC FILES MAY OCCUR AT ANY TIME, THE CONTRACTOR AGREES TO INDEMNIFY, AND HOLD HARMLESS THE JURISDICTION AND ENGINEER, ITS OFFICERS, AGENTS, AND EMPLOYEES FROM AND AGAINST ANY AND ALL CLAIMS, SUITS, LOSSES, DAMAGES OR COSTS, INCLUDING REASONABLE ATTORNEY'S FEES, ARISING FROM THE USE OF ANY ELECTRONIC FILES RECEIVED.

1.06 – INCREASE OR DECREASE OF WORK
B. QUANTITY CHANGE, REGARDLESS OF THE PERCENTAGE INCREASE OR DECREASE OF THE TOTAL BID, SHALL NOT AFFECT THE UNIT BID PRICE OF THAT ITEM.

1.14 – MUNICIPAL TERMINATION FOR CONVENIENCE CLAUSE
THE JURISDICTION, BY WRITTEN NOTICE, MAY TERMINATE THIS CONTRACT, IN WHOLE OR IN PART, WHEN IT IS IN THE JURISDICTION'S INTEREST. IF THIS CONTRACT IS TERMINATED, THE RIGHTS, DUTIES, AND OBLIGATIONS OF THE PARTIES, INCLUDING COMPENSATION TO THE CONTRACTOR, SHALL BE AS AGREED AS FOLLOWS: A REASONABLE PRORATION COMPENSATING CONTRACTOR FOR WORK PERFORMED AS DETERMINED BY THE JURISDICTION'S ENGINEER FOLLOWING THE NOTICE AND PROCEDURE OUTLINED HEREIN: AFTER RECEIPT OF A NOTICE OF TERMINATION, AND EXCEPT AS OTHERWISE DIRECTED BY THE JURISDICTION, THE CONTRACTOR SHALL IMMEDIATELY PROCEED WITH THE FOLLOWING OBLIGATIONS, REGARDLESS OF ANY DELAY IN DETERMINING OR ADJUSTING ANY AMOUNTS DUE UNDER THIS CLAUSE:
A. STOP WORK AS SPECIFIED IN THIS NOTICE.
B. PLACE NO FURTHER SUBCONTRACTS OR ORDERS (REFERRED TO AS SUBCONTRACTS IN THIS CLAUSE) FOR MATERIALS, SERVICES, OR FACILITIES EXCEPT AS NECESSARY TO COMPLETE THE CONTINUED PORTION OF THE CONTRACT.
C. TERMINATE ALL SUBCONTRACTS TO THE EXTENT THEY RELATE TO THE WORK TERMINATED.
D. ASSIGN TO THE JURISDICTION, ALL RIGHT, TITLE, AND INTEREST OF THE CONTRACTOR UNDER THE SUBCONTRACTS TERMINATED, IN WHICH CASE THE GOVERNMENT SHALL HAVE THE RIGHT TO SETTLE OR TO PAY ANY TERMINATION SETTLEMENT PROPOSAL ARISING OUT OF THOSE TERMINATIONS.
E. WITH APPROVAL OR RATIFICATION TO THE EXTENT REQUIRED BY THE JURISDICTION, SETTLE ALL OUTSTANDING LIABILITIES AND TERMINATE ALL SETTLEMENT PROPOSALS ARISING FROM THE TERMINATION OF SUBCONTRACTS; THE APPROVAL OR RATIFICATION WILL BE FINAL FOR PURPOSES OF THIS CLAUSE.
F. AS DIRECTED BY THE JURISDICTION, TRANSFER TITLE AND DELIVER TO THE GOVERNMENT --
1. THE FABRICATED OR UNFABRICATED PARTS, WORK IN PROCESS, COMPLETED WORK, SUPPLIES, AND OTHER MATERIAL PRODUCED OR ACQUIRED FOR THE WORK TERMINATED.
2. THE COMPLETED OR PARTIALLY COMPLETED PLANS, DRAWINGS, INFORMATION, AND OTHER PROPERTY THAT, IF THE CONTRACT HAD BEEN COMPLETED, WOULD BE REQUIRED TO BE FURNISHED TO THE GOVERNMENT.
G. COMPLETE ALL WORK NOT TERMINATED.
H. TAKE ANY ACTION THAT MAY BE NECESSARY, OR THAT THE JURISDICTION MAY DIRECT, FOR THE PROTECTION AND PRESERVATION OF THE PROPERTY RELATED TO THIS CONTRACT THAT IS IN THE POSSESSION OF THE CONTRACTOR AND IN WHICH THE JURISDICTION HAS OR MAY ACQUIRE AN INTEREST.
I. USE ITS BEST EFFORTS TO SELL, AS DIRECTED OR AUTHORIZED BY THE JURISDICTION, ANY PROPERTY OF THE TYPES REFERRED TO IN THIS TERMINATION FOR CONVENIENCE CLAUSE; PROVIDED, HOWEVER, THAT THE CONTRACTOR
1. IS NOT REQUIRED TO EXTEND CREDIT TO ANY PURCHASER.
2. MAY ACQUIRE THE PROPERTY UNDER THE CONDITIONS PRESCRIBED BY, AND AT PRICES APPROVED BY, THE JURISDICTION. THE PROCEEDS OF ANY TRANSFER OR DISPOSITION WILL BE APPLIED TO REDUCE ANY PAYMENTS TO BE MADE BY THE GOVERNMENT UNDER THIS CONTRACT, CREDITED TO THE PRICE OR COST OF THE WORK, OR PAID IN ANY OTHER MANNER DIRECTED BY THE JURISDICTION.
J. THE CONTRACTOR SHALL SUBMIT COMPLETE TERMINATION INVENTORY SCHEDULES NO LATER THAN 120 DAYS FROM THE EFFECTIVE DATE OF TERMINATION, UNLESS EXTENDED IN WRITING BY THE JURISDICTION UPON WRITTEN REQUEST OF THE CONTRACTOR WITHIN THIS 120-DAY PERIOD.
K. AFTER TERMINATION, THE CONTRACTOR SHALL SUBMIT A FINAL TERMINATION SETTLEMENT PROPOSAL TO THE JURISDICTION. THE CONTRACTOR SHALL SUBMIT THE PROPOSAL PROMPTLY, BUT NO LATER THAN 1 YEAR FROM THE EFFECTIVE DATE OF TERMINATION, UNLESS EXTENDED IN WRITING BY THE JURISDICTION UPON WRITTEN REQUEST OF THE CONTRACTOR WITHIN THIS 1-YEAR PERIOD. HOWEVER, IF THE JURISDICTION DETERMINES THAT THE FACTS JUSTIFY IT, A TERMINATION SETTLEMENT PROPOSAL MAY BE RECEIVED AND ACTED ON AFTER 1 YEAR OR ANY EXTENSION. IF THE CONTRACTOR FAILS TO SUBMIT THE PROPOSAL WITHIN THE TIME ALLOWED, THE JURISDICTION OFFICER MAY DETERMINE, ON THE BASIS OF INFORMATION AVAILABLE, THE AMOUNT, IF ANY, DUE THE CONTRACTOR BECAUSE OF THE TERMINATION AND SHALL PAY THE AMOUNT DETERMINED.
L. AFTER RECEIPT OF THE FINAL TERMINATION PROPOSAL, THE PROPOSAL WILL BE REVIEWED BY THE JURISDICTION'S ENGINEER, AND A FINAL DETERMINATION RECOMMENDATION BY THE ENGINEER SHALL BE FINAL AND AGREED TO SETTLEMENT.
M. IF THE TERMINATION IS PARTIAL, THE CONTRACTOR MAY FILE A PROPOSAL WITH THE JURISDICTION FOR AN EQUITABLE ADJUSTMENT OF THE PRICE(S) OF THE CONTINUED PORTION OF THE CONTRACT. THE JURISDICTION SHALL MAKE ANY EQUITABLE ADJUSTMENT AGREED UPON. ANY PROPOSAL BY THE CONTRACTOR FOR AN EQUITABLE ADJUSTMENT UNDER THIS CLAUSE SHALL BE REQUESTED WITHIN 90 DAYS FROM THE EFFECTIVE DATE OF TERMINATION UNLESS EXTENDED IN WRITING BY THE JURISDICTION.

SECTION 1050
1.03 – COOPERATION BY THE CONTRACTOR – SPECIAL ATTENTION TO THIS SECTION IS REQUESTED OF ALL BIDDING CONTRACTORS
1.10 – LINE AND GRADE STAKES
A. THE CONTRACTOR IS REQUIRED TO PROVIDE MINIMUM OF TWO BUSINESS DAYS' NOTICE TO THE ENGINEER WHEN REQUESTING STAKES.
1.12 – SALVAGE
A. ALL ASPHALT SURFACING SHALL BE HAULED TO THE CITY OF OELWEIN PUBLIC WORKS FACILITY AT 4TH STREET SW AND 7TH AVENUE SW. ALL OTHER MATERIALS REMOVED SHALL BECOME PROPERTY OF THE CONTRACTOR TO PROPERLY DISPOSE OF.

SECTION 1060
1.04 – STORAGE OF MATERIALS
THE PROJECT LOCATION MAY BE USED AS A STAGING AREA FOR STORAGE OF EQUIPMENT AND MATERIALS FOR THIS PROJECT. OTHER AREAS USED BY THE CONTRACTOR SHALL BE RETURNED TO A CONDITION SIMILAR TO THAT PRIOR TO CONSTRUCTION. THIS INCLUDES, BUT IS NOT LIMITED TO: SMOOTHING ANY RUTS, REMOVING ALL TRASH AND DEBRIS, RESEEDING THE AREA, AND REPLACING ANY DAMAGED SURFACING. NO PAYMENT WILL BE MADE FOR WORK OR MATERIALS REQUIRED TO RETURN STAGING AREA TO PRECONSTRUCTION CONDITION.

SECTION 1070
2.02 – CONVENIENCE AND SAFETY – SPECIAL ATTENTION TO THIS SECTION IS REQUESTED OF ALL BIDDING CONTRACTORS
C. WORK SHALL BE COMPLETED IN A MANNER THAT WILL CAUSE THE LEAST INCONVENIENCE AND ANNOYANCE TO THE PUBLIC AND PROPERTY OWNERS ABUTTING THE WORK AREA AND SHALL PROVIDE ACCESS TO THE ABUTTING PROPERTY TO THE GREATEST EXTENT PRACTICABLE. CONTRACTOR SHALL NOTIFY PROPERTY OWNERS A MINIMUM OF 48 HOURS IN ADVANCE WHEN ACCESS WILL BE RESTRICTED TO THEIR PROPERTIES.

2.06 – TRAFFIC CONTROL
A. 3. TRAFFIC CONTROL SHALL BE PAID FOR BY LUMP SUM AS SPECIFIED IN SECTION 8030 AND SHALL INCLUDE ANY AND ALL TRAFFIC CONTROL USED ON THE PROJECT AS OUTLINED IN SECTION 8030, INCLUDING BUT NOT LIMITED TO FLAGGERS, PILOT CARS, SIGNS, BARRICADES, SAFETY CLOSURES, ETC., IF NECESSARY. THE CONTRACTOR SHALL TAKE FULL RESPONSIBILITY FOR TRAFFIC CONTROL AND HOLD BOTH THE JURISDICTION AND THE JURISDICTIONAL ENGINEER HARMLESS.
2.13 – BORROW AND WASTE SITES
A. CONTRACTOR SHALL SECURE AND OPERATE, AT ITS OWN EXPENSE, SITES FOR DISPOSAL OF CLASS 12 ROCK EXCAVATION, STRUCTURES, PCC, AND RUBBISH AND DEBRIS. CONTACT FOR POSSIBLE ACCEPTANCE OF PCC: GREG BRYAN, CELL 319.239.1336. GREG WILL HAVE A DISPOSAL FEE, DISCUSS WITH HIM PRIOR TO PREPARING BID.
3.01 – PERFORMANCE, PAYMENT, AND MAINTENANCE BOND
B. PRODUCTS AND COMPLETED OPERATIONS SHALL BE MAINTAINED FOR THE DURATION OF THE WORK; AND SHALL BE FURTHER MAINTAINED FOR A MINIMUM PERIOD OF TWO (2) YEARS AFTER FINAL ACCEPTANCE AND PAYMENT.

3.02 – INSURANCE REQUIREMENTS
C. 2. U. NOT APPLICABLE.
6. ADDITIONAL INSURED ENDORSEMENTS –
C. SEE SECTION 1070, PART 3.06 FOR INFORMATION ON ALL REQUIRED ENDORSEMENTS WHICH INCLUDE NAMING OF THE JURISDICTION AS AN ADDITIONAL INSURED, CANCELLATION AND MATERIAL CHANGE ENDORSEMENT, AND NONWAIVER OF GOVERNMENTAL IMMUNITY.
3.05 – PROPERTY INSURANCE – NOT APPLICABLE
SECTION 1080

1.02 – CONTRACT TIME
A. 3. CONTRACTOR SHALL FULLY COMPLETE THE PROJECT BY OCTOBER 27, 2023.
SECTION 1090
1.05 – PROGRESS PAYMENTS
D. PARTIAL PAY ESTIMATE SHALL BE SUBMITTED BY THE CONTRACTOR TO THE ENGINEER BY THE THURSDAY FOLLOWING THE LAST SATURDAY OF THE MONTH FOR WORK COMPLETED THROUGH THE LAST SATURDAY OF THE MONTH.

DIVISION 2 – EARTHWORK

SECTION 2010
1.03 – SUBMITTALS
A. THE JURISDICTIONAL ENGINEER HEREBY REQUESTS THAT ALL MATERIALS TO BE INCORPORATED INTO THE WORK HAVE CERTIFICATIONS FURNISHED WHICH SHOW THAT THE MATERIALS COMPLY WITH SPECIFICATIONS PRIOR TO ANY CONSTRUCTION.

1.08 – MEASUREMENT AND PAYMENT
D. 3.A. THICKNESS SHALL BE AS SPECIFIED ON PLANS.
E. 1.B. NO ADDITIONAL MEASUREMENTS WILL BE MADE; PAYMENT QUANTITY SHALL BE PLAN QUANTITY.
1.C. ESTIMATES OF EARTHWORK FOR THE PROJECT ARE AS FOLLOWS: FILL REQUIRED (SHRINKAGE FACTOR OF 1.3 USED IN CALCULATING) – 0 CY; CUT MATERIAL – 1565 CY; BALANCE – 1565 CY EXCESS (WASTE). CONTRACTOR SHALL BE RESPONSIBLE FOR THE PROPER REMOVAL AND DISPOSAL OF THE EXCESS EXCAVATED MATERIAL. THE VOLUME IS CALCULATED BETWEEN THE DATUM SURFACE AND THE EXISTING SURFACE WITH THE EXISTING PAVEMENT VOLUME DEDUCTED. THE DATUM SURFACE IS THE TOP OF PROPOSED SUBGRADE.
3. E. NO ADDITIONAL PAYMENT WILL BE MADE FOR HAULING OF SALVAGED EXCAVATED MATERIAL, AS NOTED IN SECTION 1050, 1.12, AS IT SHALL BE INCIDENTAL TO CLASS 10 EXCAVATION.
3. F. EXCAVATION SHALL INCLUDE SUBGRADE PREPARATION AT NO ADDITIONAL COST.
3. G. CONTRACTOR TO COMPLETE PROOF ROLLING AS REQUIRED IN PART 3.06, B. NO ADDITIONAL PAYMENT WILL BE MADE FOR PROOF ROLLING, AS IT SHALL BE INCIDENTAL TO THE EXCAVATION BID ITEM.
2. NO SEPARATE PAYMENT SHALL BE MADE FOR SUBGRADE PREPARATION AS IT SHALL BE INCIDENTAL TO THE EXCAVATION.
I. SUBGRADE TREATMENT:
1. MEASUREMENT: THE FOOTPRINT AREA OF THE LANDSCAPE ROCK WILL BE MEASURED IN SQUARE YARDS.
3. INCLUDES: ALSO INCLUDES ANCHORS FOR FABRIC.
J. SUBBASE:
1. MEASUREMENT SHALL BE BY THE TON OF MATERIAL PLACED BASED ON WEIGHT TICKETS. PLACEMENT BEYOND THAT INDICATED IN THE PLANS OR AS DIRECTED BY THE ENGINEER WILL BE MEASURED AND CONVERTED TO TONS USING A FACTOR OF 140 LBS./CU.FT. AND DEDUCTED FROM THE WEIGHT INDICATED BY THE TICKET TOTALS. MODIFIED SUBBASE, IDOT GRADATION #14, SHALL BE USED.
999–A CRUSHED STONE, SALVAGE AND PLACE
a. MEASUREMENT: CRUSHED STONE SALVAGED AND PLACED SHALL BE MEASURED IN TONS BASED ON AREA AND THICKNESS AND UNIT WEIGHT OF 140 LB/CUBIC FOOT.
b. PAYMENT: PAYMENT WILL BE AT THE UNIT PRICE PER TON FOR THE FOR THE QUANTITY OF CRUSHED STONE SALVAGED AND PLACED.
C. INCLUDES: WORK INCLUDES, BUT IS NOT LIMITED TO, REMOVAL OF CRUSHED STONE, STOCKPILE ON SITE, PLACEMENT AND COMPACTION AS PAVING BASE.
999–B LANDSCAPE ROCK, ¾" DIA.
a. MEASUREMENT: MEASUREMENT WILL BE IN TONS FOR THE QUANTITY OF GRANULAR STABILIZATION MATERIAL REQUIRED FOR THE AREA AND THICKNESS INDICATED ON THE PLANS.
b. PAYMENT: PAYMENT WILL BE AT THE UNIT PRICE PER TON FOR THE FOR THE QUANTITY OF LANDSCAPE ROCK FURNISHED AND PLACED.
C. INCLUDES: WORK INCLUDES, BUT IS NOT LIMITED TO, FURNISHING AND PLACING LANDSCAPE ROCK TO FINISHED GRADE. PRODUCT SHALL BE RIVER ROCK, DECORATIVE, WITH NO STONES LARGER THAN ¾" DIAMETER. MATERIAL SHALL BE APPROVED BY OWNER PRIOR TO DELIVERY. PROVIDE MINIMUM 10 LB. SAMPLE FOR APPROVAL.

2.04 – FOUNDATION MATERIALS
C. SUBGRADE TREATMENT:
6. GEOTEXTILES: COMPLY WITH IDOT STANDARD SPEC. TABLE 4196.01–3 (FABRIC FOR USE AS EMBANKMENT EROSION CONTROL) FOR FABRIC BELOW LANDSCAPE ROCK.

3.04 – EMBANKMENT CONSTRUCTION
E. TYPE A COMPACTION REQUIRED FOR ALL EMBANKMENT CONSTRUCTION AND SUBGRADE PREPARATION.
3.06 – SUBGRADE PREPARATION
A. A DISK OF THE SIZE INDICATED IN SECTION 2010, PART 3.04, C. 4 SHALL BE USED TO TURN AND MIX ALL SOILS IN CUT OR FILL SECTIONS. TYPE A COMPACTION REQUIRED FOR ALL SUBGRADE PREPARATION.

DIVISION 3 – TRENCH AND BACKFILL

SECTION 3010
1.03 – SUBMITTALS
B. RESULTS OF STANDARD PROCTOR AND IN-PLACE DENSITY TESTS WILL NOT BE REQUIRED.
2.02 – BEDDING MATERIAL
A. 1. USE CLEAN STONE FOR PIPE ENVELOPE IN WET TRENCH OR AS DIRECTED BY THE ENGINEER. IOWA DOT GRADATION NO. 11, 12 OR 31 SHALL BE USED FOR PIPE ENVELOPE IN DRY TRENCH UNLESS OTHERWISE DIRECTED BY THE ENGINEER. CONTRACTOR SHALL NOTE ON WEIGH TICKETS USE OF MATERIAL AND SHALL STOCKPILE SEPARATE FROM STREET SUBBASE.
3.05 – PIPE BEDDING AND BACKFILL
PIPE EMBEDMENT REQUIREMENTS FOR RIGID GRAVITY PIPE:
RCP: CLASS R–1
RCAP AND RCEP: CLASS R–5
PIPE EMBEDMENT REQUIREMENTS FOR FLEXIBLE GRAVITY PIPE:
DIP: CLASS F–1
PVC TRUSS PIPE AND DR18: CLASS F–2
HDPE SINGLE & DUAL WALL, PVC GRAVITY PIPE (SDR 23.5, 26, 35): CLASS F–3
PIPE EMBEDMENT REQUIREMENTS FOR PRESSURE PIPE:
DIP: CLASS P–1
PVC DR18: CLASS P–3
3.07 – DRAINAGE TILE REPAIR
CONTRACTOR SHALL REPAIR ANY DRAINAGE TILE DAMAGED BY TRENCHING OPERATIONS. DAMAGED DRAINAGE TILE SHALL BE REPAIRED WITH SCHEDULE 40 PVC OF THE SAME NOMINAL INTERIOR DIAMETER AS THE EXISTING DRAINAGE TILE. A MINIMUM 2' LENGTH OF PIPE ON EACH SIDE OF THE TRENCH SHALL BE PLACED ON UNDISTURBED GROUND. PVC REPAIR SECTION SHALL BE ABUTTED TO EXISTING TILE ENDS WITH 1/8" MAXIMUM JOINT SPACING AND JOINT WRAPPED WITH ENGINEERING FABRIC. TRENCH BACKFILL BELOW TILE REPAIR SHALL BE COMPACTED TO 95% STANDARD PROCTOR DENSITY. GRANULAR PIPE ENVELOPE WILL NOT BE REQUIRED FOR TILE REPAIR. DRAINAGE TILES SHALL BE REPLACED SO THAT THE FORMER GRADIENT AND ALIGNMENT IS RESTORED. CONTRACTOR SHALL FURNISH ALL MATERIALS. DRAINAGE TILE REPAIR SHALL BE INCIDENTAL FOR ALL TILE REPAIRS WITH TILE CROSSING TRENCH PERPENDICULAR PLUS OR MINUS 70 DEGREES TO THE TRENCH UNLESS OTHERWISE INDICATED IN THE PLANS OR CONTRACT DOCUMENTS. REPAIR OF TILE CROSSINGS WITHIN 20 DEGREES OF PARALLEL TO THE TRENCH SHALL HAVE A SEPARATE PAYMENT ITEM.

DIVISION 4 – SEWERS AND DRAINS

SECTION 4020
1.03 – SUBMITTALS
A. THE JURISDICTIONAL ENGINEER HEREBY REQUESTS THAT ALL MATERIALS TO BE INCORPORATED INTO THE WORK HAVE CERTIFICATIONS FURNISHED WHICH SHOW THAT THE MATERIALS COMPLY WITH SPECIFICATIONS PRIOR TO ANY CONSTRUCTION.

1.08 – MEASUREMENT AND PAYMENT
A. 1. A. MEASURE EACH SIZE AND TYPE OF PIPE INSTALLED FROM INSIDE WALL OF INTAKE/MANHOLE TO INSIDE WALL OF INTAKE/MANHOLE.
2.01 – STORM SEWERS
A. 2. STORM SEWER MAIN TO BE DUAL WALL HDPE.

DIVISION 6 – STRUCTURES FOR SANITARY AND STORM

SECTION 6010
1.03 – SUBMITTALS
THE JURISDICTIONAL ENGINEER HEREBY REQUESTS THAT ALL MATERIALS TO BE INCORPORATED INTO THE WORK HAVE CERTIFICATIONS FURNISHED WHICH SHOW THAT THE MATERIALS COMPLY WITH SPECIFICATIONS PRIOR TO ANY CONSTRUCTION.

1.08 – MEASUREMENT AND PAYMENT
B. 3. ALSO INCLUDES 5' X 5' PCC BOXOUT PER SUDAS DETAIL PV–103 FOR ONE INTAKE AS SPECIFIED AND PER BID ITEM. OTHER INTAKE DOES NOT REQUIRE PCC BOXOUT.

DIVISION 7 – STREETS & RELATED WORK

SECTION 7010
1.03 – SUBMITTALS

ALL SUBMITTALS LISTED IN THE STANDARD SPECIFICATIONS SHALL BE PROVIDED.
D. CERTIFIED PLANT INSPECTION BY THE CONTRACTOR IS NOT REQUIRED ON THIS PROJECT.
STANDARD IOWA DOT PLANT REPORT FORMS SHALL BE COMPLETED BY THE CONTRACTOR/SUPPLIER AND SUBMITTED TO THE JURISDICTIONAL ENGINEER WEEKLY. IOWA DOT STANDARD FORM 830212 FOR READY MIX CONCRETE (LOAD TICKETS) SHALL BE COMPLETED FOR EACH LOAD FOR COLLECTION AT THE GRADE.
1.08 – MEASUREMENT AND PAYMENT
E. 3. INCLUDES RT JOINT FOR CONNECTION TO ADJACENT PCC.
I. 1. CONTRACTOR WILL NOT BE REQUIRED TO PERFORM PLASTIC CONCRETE TESTING, AIR, SLUMP, CYLINDERS, AND/OR BEAMS TO BE COMPLETED BY THE JURISDICTIONAL ENGINEER. CONTRACTOR SHALL PROVIDE MATERIALS FOR THESE TESTS.
2. NO ADDITIONAL PAYMENT WILL BE MADE FOR MATURITY TESTING, AS THIS SHALL BE INCIDENTAL TO THE PCC PAVEMENT BID ITEM.
3. JURISDICTIONAL ENGINEER RESERVES THE RIGHT TO REQUIRE THICKNESS CORES IF PAVING OPERATIONS OR EDGE THICKNESS INDICATE A THICKNESS DEFICIENCY. IF CORES NOT REQUIRED, THIS BID ITEM WILL BE DELETED.

2.01 – MATERIALS
J. 1. CLASS 3 DURABILITY ONLY FOR THIS PROJECT.
H. ALL METALLIC BARS SHALL BE EPOXY COATED WITH CUT ENDS SEALED.
2.02 – MIX DESIGN
A. 1. MINIMUM COMPRESSIVE STRENGTH SHALL BE 4,500 PSI AT 28 DAYS. CONTRACTOR MAY USE CLASS M, C–SUD, OR C.V.–SUD MIXES, BUT NO ADDITIONAL PAYMENT SHALL BE MADE FOR THESE MIXES.

SECTION 7020

1.03 – SUBMITTALS
ALL SUBMITTALS LISTED IN THE STANDARD SPECIFICATIONS SHALL BE PROVIDED.
2.01 – ASPHALT MATERIALS
A. USE THE FOLLOWING MATERIALS FOR THE BASE AND SURFACE COURSE:
1. BASE (2.5" THICK): HMA STANDARD TRAFFIC (ST), 3/4", PG 58–28S
2. SURFACE (1.5" THICK): HMA STANDARD TRAFFIC (ST), ½", PG 58–28S

SECTION 7030
1.08 – MEASUREMENT AND PAYMENT
E. 3. INCLUDES EPOXY COATED REBAR AT DIMENSIONS SPECIFIED ON PLANS.
F. 1. MEASUREMENT: LUMP SUM MEASUREMENT; NO MEASUREMENT WILL BE MADE.
2. PAYMENT: PAYMENT WILL BE AT THE CONTRACT LUMP SUM PRICE.
3. INCLUDES: UNIT PRICE INCLUDES, BUT IS NOT LIMITED TO, REMOVAL OF BRICKS IN GOOD CONDITION, STORAGE UNTIL REPLACED, FORMING OF NEW PCC FOR BRICK PATTERN (PCC BASE BELOW BRICK PAID WITH SIDEWALK ITEM), BRICK PLACEMENT, SAND JOINT FILL.
I. CONTRACTOR WILL NOT BE REQUIRED TO PERFORM PLASTIC CONCRETE TESTING, AIR, SLUMP, CYLINDERS, AND/OR BEAMS TO BE COMPLETED BY THE JURISDICTIONAL ENGINEER. CONTRACTOR SHALL PROVIDE MATERIALS FOR THESE TESTS WITHOUT ADDITIONAL PAYMENT.
2.01 – PORTLAND CEMENT CONCRETE MIX
A. CLASS C, 4,500 PSI AT 28 DAYS COMPRESSIVE STRENGTH REQUIRED.
2.07 – DETECTABLE WARNINGS
A. DETECTABLE WARNINGS SHALL BE PRE-MANUFACTURED PANELS. PANELS SHALL BE UNCOATED CAST IRON.
3.04 – PCC RECREATIONAL TRAILS, SIDEWALKS, AND DRIVEWAYS
F. 2. B. 3. ALL TRANSVERSE CONTRACTION JOINTS SHALL BE SAWED. JOINTS MAY BE SAWED AS SOON AS CONCRETE HAS HARDENED SUFFICIENTLY TO ALLOW SAWING WITHOUT RAVELING, MOVING OF AGGREGATE, OR SCUFFING THE FINISHED SURFACE, BUT WITHIN 24 HOURS OF PLACEMENT. JOINTS MAY BE SAWED WITH A 1/8" INCH BLADE SAW TO A DEPTH OF 1/3 THE PAVEMENT THICKNESS. USE A STRAIGHTEDGE IF JOINTS ARE SAWED WITH A HAND-HELD SAW.
3. B. 2. ALL LONGITUDINAL CONTRACTION JOINTS SHALL BE SAWED. JOINTS MAY BE SAWED WITH A 1/8 INCH BLADE TO A DEPTH OF 1/3 THE PAVEMENT THICKNESS. USE A STRAIGHTEDGE IF JOINTS ARE SAWED WITH A HAND-HELD SAW.
5. B. SEALING OF EXPANSION AND ISOLATION JOINTS IS REQUIRED. TRIM PREFORMED JOINT MATERIAL TO A DEPTH OF ½ INCH BELOW THE CONCRETE SURFACE. ENSURE THE JOINT IS CLEAN AND DRY. INSTALL JOINT SEALANT PER MANUFACTURER'S RECOMMENDATIONS.

SECTION 7040

1.08 – MEASUREMENT AND PAYMENT
H. 3. NO ADDITIONAL PAYMENT WILL BE MADE FOR HAULING AND DISPOSAL OF REMOVED PAVEMENT, AS IT SHALL BE INCIDENTAL TO THE BID ITEM, INCLUDES REMOVAL OF ALL LAYERS OF PAVEMENT OR FLOOR PER SQUARE YARD. PAYMENT FOR INDIVIDUAL LAYERS WILL NOT BE MADE. INCLUDES REMOVAL OF FOUNDATION WALL AS DESCRIBED IN PLANS.
I. 3. INCLUDES ALSO FULL DEPTH SAW CUT 2' FROM BACK OF CURB AND AT BEGINNING AND END OF REMOVAL.

SECTION 7999
1.08 – MEASUREMENT AND PAYMENT
A. WHEEL STOP:
1. MEASUREMENT: EACH WHEEL STOP FURNISHED AND PLACED WILL BE COUNTED.
2. PAYMENT: PAYMENT WILL BE MADE AT THE CONTRACT UNIT PRICE FOR EACH WHEEL STOP PLACED.
3. INCLUDES: UNIT PRICE INCLUDES, BUT IS NOT LIMITED TO, PLACING AND ANCHORING WHEEL STOP. WHEEL STOP SHALL BE LDPE PLASTIC, INTEGRALLY COLORED YELLOW, 6' LONG (MIN.) X 5.75" WIDE (MIN.) X 4" TALL (MIN.). ANCHORS SHALL BE MINIMUM 14" LONG GALVANIZED STEEL SPIKES.

DIVISION 8 – TRAFFIC CONTROL

SECTION 8020 – PAVEMENT MARKINGS
1.08 – MEASUREMENT AND PAYMENT
B. 1. MEASUREMENT: LUMP SUM MEASUREMENT; NO MEASUREMENT WILL BE MADE.
2. PAYMENT: PAYMENT WILL BE AT THE CONTRACT LUMP SUM PRICE.
3. INCLUDES: UNIT PRICE INCLUDES, BUT IS NOT LIMITED TO, LAYOUT, SURFACE PREPARATION, AND APPLICATION OF PAINT FOR PARKING STRIPES AND HANDICAP ACCESSIBLE PARKING SPACES AND NO PARKING AISLES/AREAS. PAINT COLOR SHALL BE WHITE.

SECTION 8040

1.08 – MEASUREMENT AND PAYMENT
A. TRAFFIC SIGNS BY EACH
1. MEASUREMENT: EACH SIGN LOCATION INSTALLED, REGARDLESS OF NUMBER OR SIZE OF SIGN, WILL BE COUNTED.
2. PAYMENT: PAYMENT WILL BE AT THE UNIT PRICE PER EACH SIGN LOCATION.
3. INCLUDES: UNIT PRICE INCLUDES, BUT IS NOT LIMITED TO, SIGN BLANK, APPLICATION OF REFLECTIVE SHEETING (DIAMOND GRADE OR EQUAL) WITH SYMBOL/MESSAGE, ALL MOUNTING HARDWARE, PLACEMENT OF SIGN. SIGN POST SHALL BE SQUARE PERFORATED STEEL WITH BREAKAWAY BASE ANCHOR AND HARDWARE.

DIVISION 9 – SITE WORK & LANDSCAPING

SECTION 9010
1.02 – DESCRIPTION OF WORK
COMPLETED INSTALLATION SHALL INCLUDE PREPARATION OF THE SEEDBED, FURNISHING AND INSTALLING SEED, FERTILIZER AND MULCH, MAINTENANCE, AND GUARANTEE FOR COMPLETED SEEDED AREAS.
1.07 – SPECIAL REQUIREMENTS
A. WARRANTY IS REQUIRED AND IS INCIDENTAL TO THE SEEDING BID ITEM. NO SEPARATE BID ITEM IS ALLOWED. WARRANTY IS FOR ONLY PERMANENT SEEDING WITHIN THE DATES FOR EACH VARIETY SPECIFIED PER SECTION 9010, 2.02.
B. WARRANTY PERIOD IS TWO FULL YEARS FROM ACCEPTANCE.
1.08 – MEASUREMENT AND PAYMENT
A. 1. SEEDING FOR A COMPLETED INSTALLATION SHALL BE MEASURED IN ACRES, OF ACCEPTED SEEDING WITHIN THE CONTRACT OR EASEMENT LIMITS. SEEDING ITEM INCLUDES SUPPLYING AND APPLYING PROPER SEED, FERTILIZER, AND MULCH. DIFFERENT PAYMENT FOR METHOD OF APPLICATION WILL NOT BE ALLOWED. AT THE CONTRACTOR'S OPTION, HYDRAULIC OR PNEUMATIC SEEDING MAY BE USED, BUT WILL NOT BE PAID SEPARATELY.
4. FERTILIZING SHALL BE INCIDENTAL TO THE SEEDING BID ITEM AND WILL NOT BE PAID SEPARATELY.
5. MULCHING SHALL BE INCIDENTAL TO THE SEEDING BID ITEM AND WILL NOT BE PAID SEPARATELY.
E. WARRANTY FOR SEEDING, FERTILIZING, AND MULCHING IS REQUIRED BUT IS INCIDENTAL TO THE SEEDING BID ITEM. WARRANTY PERIOD SHALL BE FOR TWO FULL YEARS FROM THE DATE OF ACCEPTANCE. NO SEPARATE BID ITEM IS ALLOWED.
2.02 – SEED MIXTURES
ALL SEEDING SHALL BE TYPE 1 (PERMANENT LAWN MIXTURE).
3.08 – RE-SEEDING
A. WHEN ALL WORK RELATED TO SEEDING ON AN AREA HAS BEEN COMPLETED BUT IS WASHED OUT OR DAMAGED PRIOR TO FINAL ACCEPTANCE OF THE SEEDING AREA, THE AREA SHALL BE RESEEDED, REFERTILIZED, AND REMULCHED WITHOUT ADDITIONAL COMPENSATION.
3.10 – ACCEPTANCE AND WARRANTY
B. 1. REQUIRED BUT INCIDENTAL TO THE SEEDING BID ITEM AND SHALL NOT BE PAID SEPARATELY.
2. THE WARRANTY PERIOD IS TWENTY-FOUR MONTHS BEGINNING ON THE DATE OF ACCEPTANCE.



ILLINOIS
IOWA
WISCONSIN

OWNER/DEVELOPER:
CITY OF OELWEIN
20 2ND AVE. SW
OELWEIN, IOWA 50662

PROJECT AND LOCATION:
OELWEIN EVENT CENTER PARKING
LOT IMPROVEMENTS
OELWEIN, IOWA

DRAWN BY: LTF
APPROVED BY: JSB
DATE: JULY 2023
SCALE: AS NOTED

REVISIONS		
REV. NO.	DESCRIPTION	DATE

DRAWING:
SUPPLEMENTAL SPECIFICATIONS

SET TYPE: BID SET
G:\C30\23\23-500\Plans\23-500 Plans.dwg, C:02

JOB NUMBER:
23–500

SHEET NUMBER:
C.02

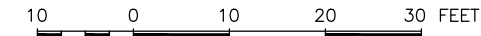

NOTE:
REMOVE ANY FOUNDATIONS ENCOUNTERED TO 2.5' BELOW FINISHED SURFACE. INCIDENTAL TO PAVEMENT REMOVAL.

REMOVE FOUNDATIONS TO DEPTH NECESSARY TO CONSTRUCT STORM DRAIN LINE.

FULL DEPTH SAW CUT REQUIRED FOR REMOVALS ADJACENT TO STRUCTURES AND SURFACING THAT WILL REMAIN.

HAUL ASPHALT TO CITY OF OELWEIN STOCKPILE AT PUBLIC WORKS FACILITY AT 4TH ST. SW AND 7TH AVE. SW.

CONTRACTOR TO DISPOSE OF PCC AND OTHER WASTE MATERIALS.

REPLACE TOPSOIL IN SIDEWALK PLANTER TO ORIGINAL DEPTH

PAYMENT FOR PAVEMENT REMOVAL IS PER UNIT PRICE PER SY FOR ALL COMBINED LAYERS ENCOUNTERED. SEPARATE PAYMENT FOR INDIVIDUAL LAYERS ENCOUNTERED WILL NOT BE MADE.

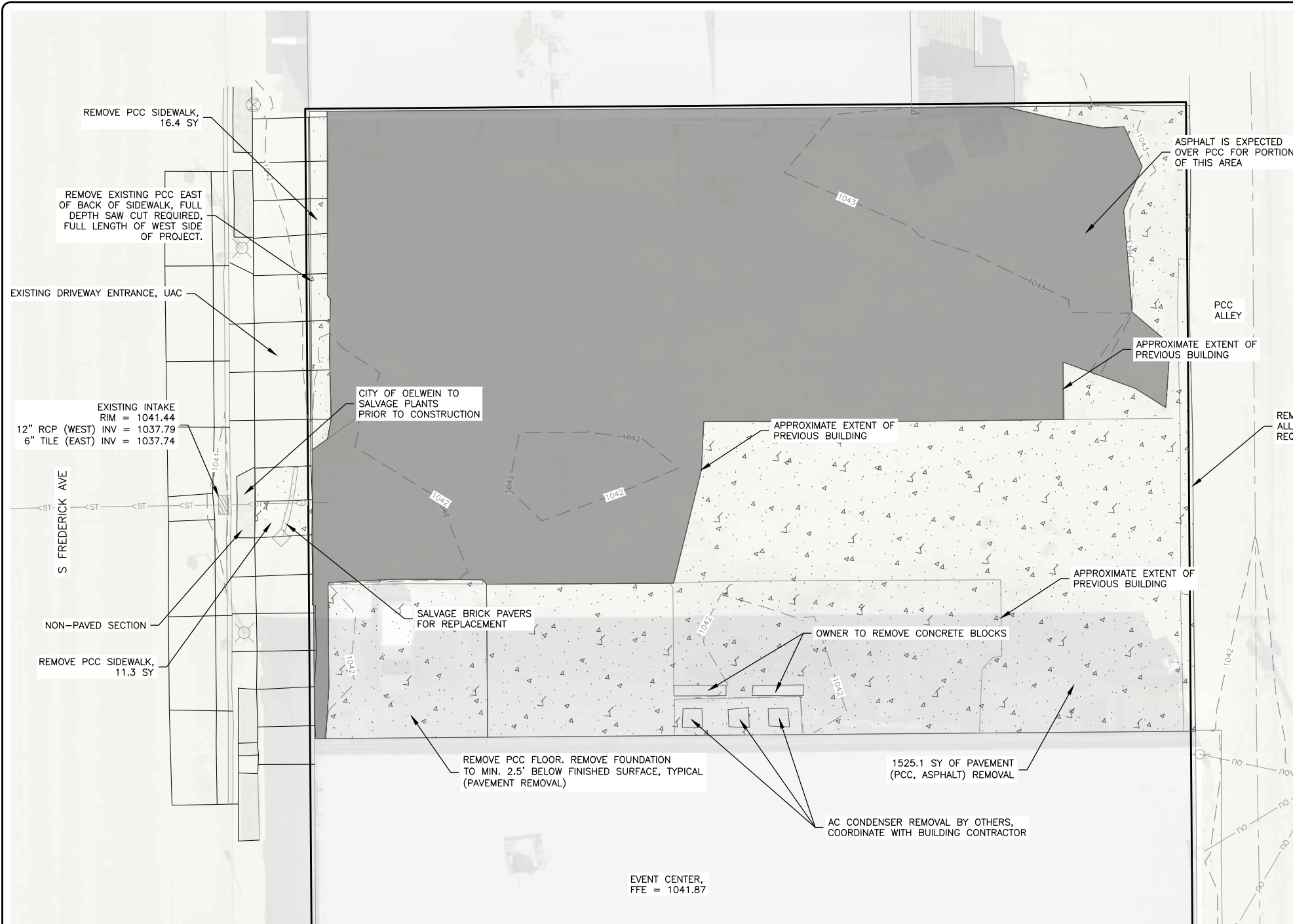

BM1

- BM1 = 104+TOP NW BOLT LUM BASE (CP 1380)
N-3713190.17, E-5348098.57, ELEV-1042.47
- BM2 = 105+CUT X TBC (CP1381)
N-3713370.86, E-5348081.52, ELEV-1042.96
- BM3 = 105+CUT X PCC (CP1382)
N-3713351.91, E-5347849.52, ELEV-1041.35
- BM4 = 104+NW BOLT FH NOT BURY TAG (CP1666)
N-3713252.61, E-5347898.71, ELEV-1042.42

FEHR GRAHAM
ENGINEERING & ENVIRONMENTAL

ILLINOIS
IOWA
WISCONSIN

OWNER/DEVELOPER:
CITY OF OELWEIN
20 2ND AVE. SW
OELWEIN, IOWA 50662

PROJECT AND LOCATION:
OELWEIN EVENT CENTER PARKING
LOT IMPROVEMENTS
OELWEIN, IOWA

DRAWN BY: LTF
APPROVED BY: JSB
DATE: JULY 2023
SCALE: AS NOTED

REVISIONS		
REV. NO.	DESCRIPTION	DATE

DRAWING:
NORTH PARKING LOT EXISTING CONDITION
AND REMOVAL PLANS

SET TYPE: BID SET
G:\C30\23\23-500\Plans\23-500 Plans.dwg, C.03

JOB NUMBER:
23-500

SHEET NUMBER:
C.03

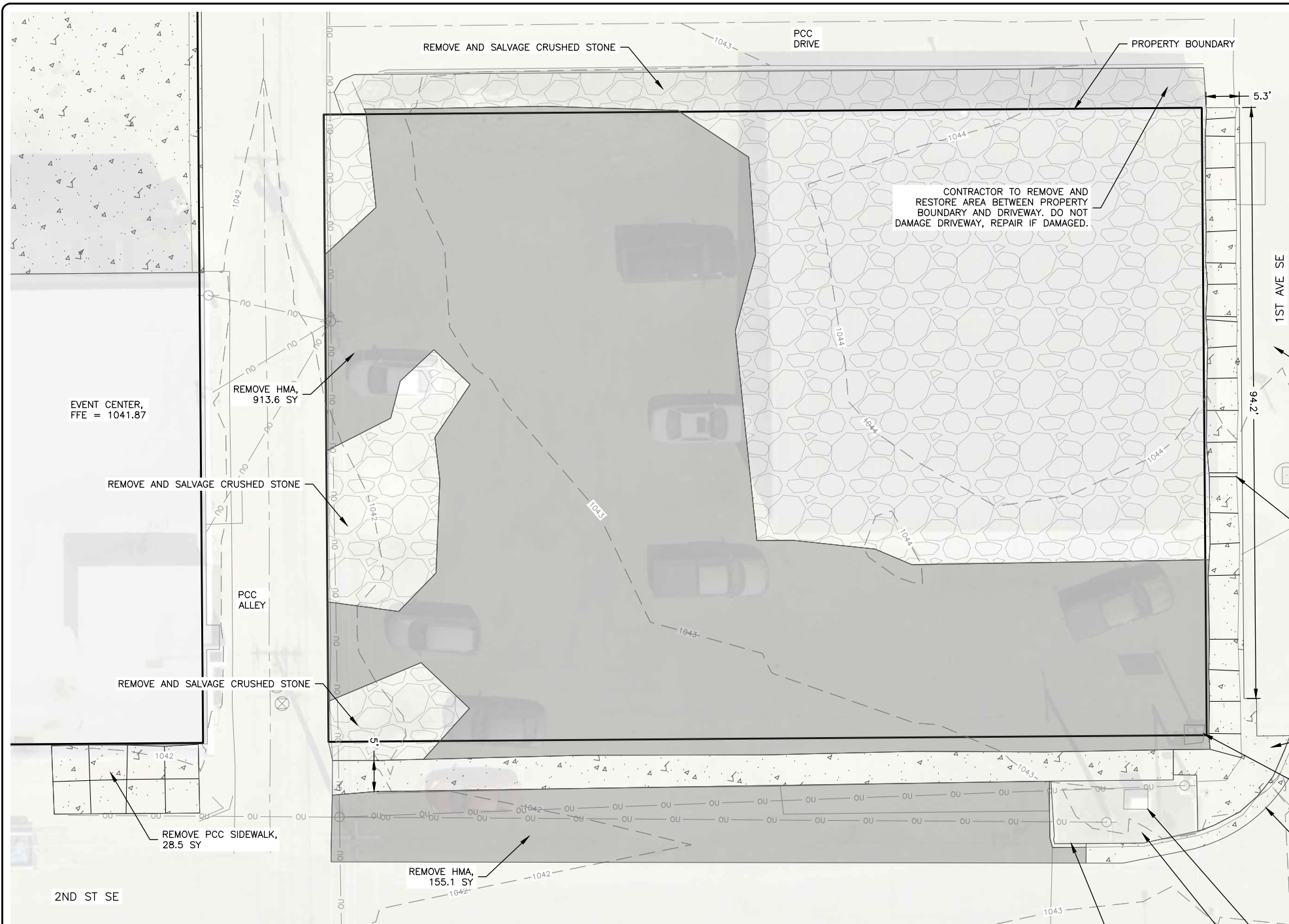

NOTE:
 SALVAGE CRUSHED STONE FOR REUSE AS PAVING BASE. 3" THICKNESS ASSUMED TO BE SALVAGED. 120 TONS ESTIMATED.

FULL DEPTH SAW CUT REQUIRED FOR REMOVALS.

HAUL ASPHALT TO CITY OF OELWEIN STOCKPILE AT PUBLIC WORKS FACILITY AT 4TH ST. SW AND 7TH AVE. SE.

CONTRACTOR TO DISPOSE OF PCC AND OTHER WASTE MATERIALS.

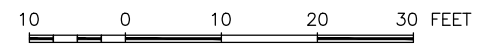

CONTRACTOR TO REMOVE AND RESTORE AREA BETWEEN PROPERTY BOUNDARY AND DRIVEWAY. DO NOT DAMAGE DRIVEWAY, REPAIR IF DAMAGED.

EVENT CENTER, FFE = 1041.87

REMOVE HMA, 913.6 SY

REMOVE AND SALVAGE CRUSHED STONE

PCC ALLEY

REMOVE AND SALVAGE CRUSHED STONE

REMOVE PCC SIDEWALK, 28.5 SY

2ND ST SE

REMOVE HMA, 155.1 SY

REMOVE CURB 15 LF

CABINET, DO NOT DISTURB

REMOVE 24" OF EXISTING SOIL 16.7 CY

REMOVE PCC SIDEWALK, 154.9 SY

CONCRETE SIGN BASE, REMOVE TO MINIMUM 2.5' BELOW FINISHED GROUND SURFACE

PCC REMOVAL, 11.8 SY

REMOVE PCC SIDEWALK TO EXISTING JOINT

PCC SIDEWALK TO REMAIN

BM1

BM1 = 104+TOP NW BOLT LUM BASE (CP 1380) N-3713190.17, E-5348098.57, ELEV-1042.47
BM2 = 105+CUT X TBC (CP1381) N-3713370.86, E-5348081.52, ELEV-1042.96
BM3 = 105+CUT X PCC (CP1382) N-3713351.91, E-5347849.52, ELEV-1041.35
BM4 = 104+NW BOLT FH NOT BURY TAG (CP1666) N-3713252.61, E-5347898.71, ELEV-1042.42

FEHR GRAHAM
 ENGINEERING & ENVIRONMENTAL

ILLINOIS
 IOWA
 WISCONSIN

OWNER/DEVELOPER:
 CITY OF OELWEIN
 20 2ND AVE. SW
 OELWEIN, IOWA 50662

PROJECT AND LOCATION:
 OELWEIN EVENT CENTER PARKING
 LOT IMPROVEMENTS
 OELWEIN, IOWA

DRAWN BY: LTF
 APPROVED BY: JSB
 DATE: JULY 2023
 SCALE: AS NOTED

REVISIONS		
REV. NO.	DESCRIPTION	DATE

DRAWING:
 EAST PARKING LOT EXISTING CONDITION
 AND REMOVAL PLANS

SET TYPE: BID SET
G:\C30\23\23-500\Plans\23-500 Plans.dwg, C.04

JOB NUMBER:
 23-500

SHEET NUMBER:
 C.04

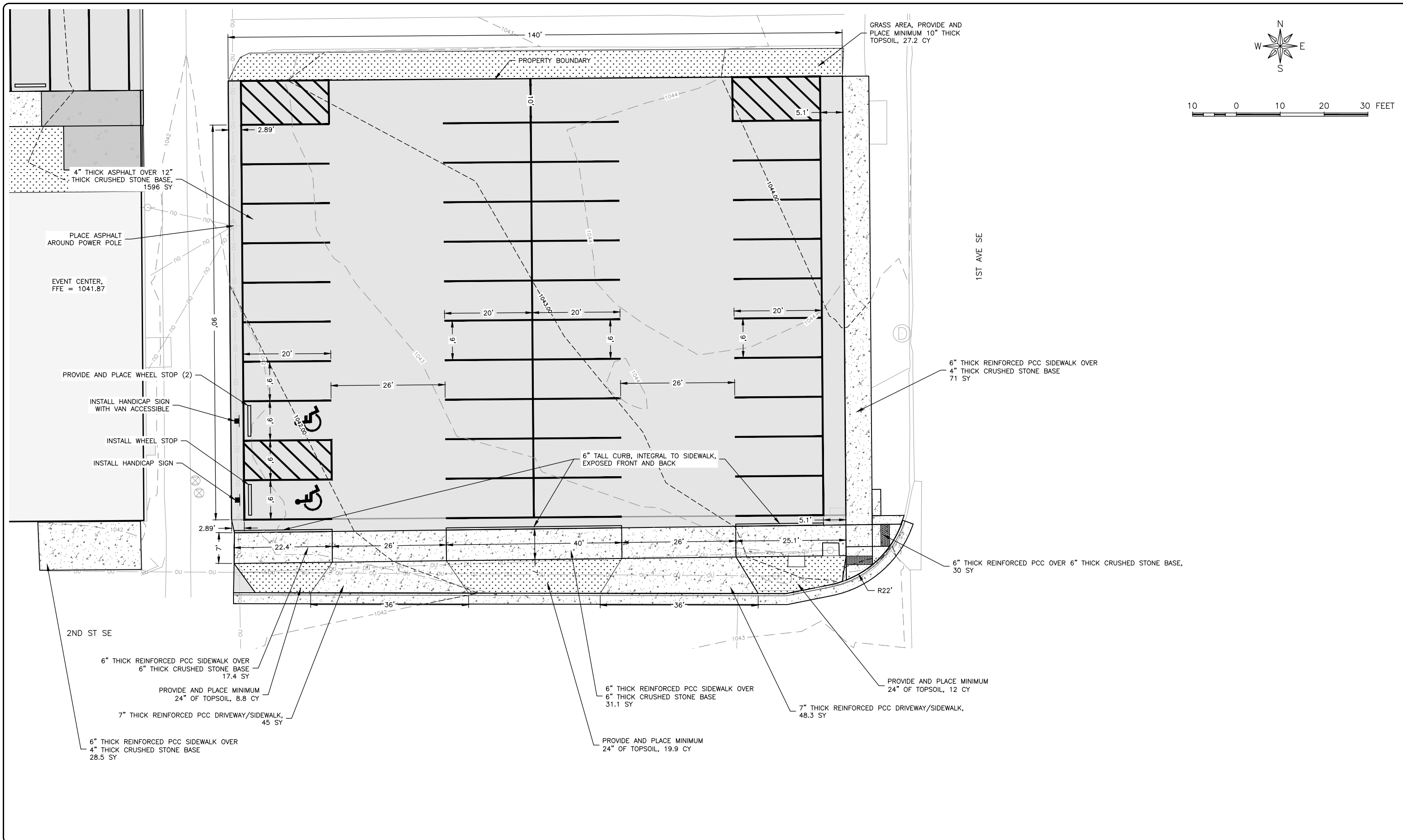

FEHR GRAHAM
ENGINEERING & ENVIRONMENTAL

ILLINOIS
IOWA
WISCONSIN

OWNER/DEVELOPER:
CITY OF OELWEIN
20 2ND AVE. SW
OELWEIN, IOWA 50662

PROJECT AND LOCATION:
OELWEIN EVENT CENTER PARKING
LOT IMPROVEMENTS
OELWEIN, IOWA

DRAWN BY: LTF
APPROVED BY: JSB
DATE: JULY 2023
SCALE: AS NOTED

REVISIONS		
REV. NO.	DESCRIPTION	DATE

DRAWING:
EAST PARKING LOT SITE PLAN

SET TYPE: BID SET
G:\C30\23\23-500\Plans\23-500 Plans.dwg, D.02

JOB NUMBER:
23-500

SHEET NUMBER:
D.02

NOTES:
 BACKFILL FULL STORM LINE TRENCH
 WITH POROUS BACKFILL, IDOT
 GRADATION #29, PROVIDE CONTACT
 WITH MODIFIED SUBBASE.

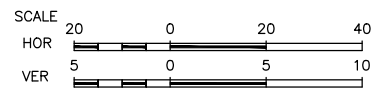
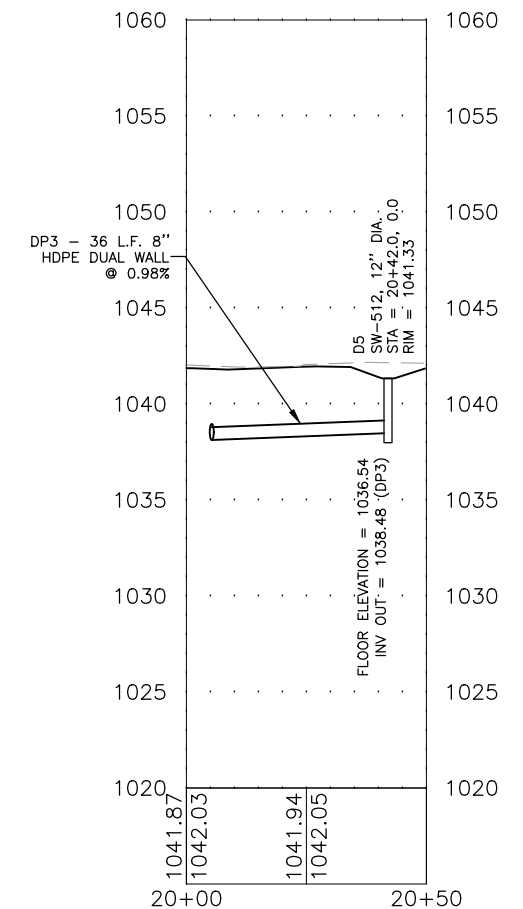
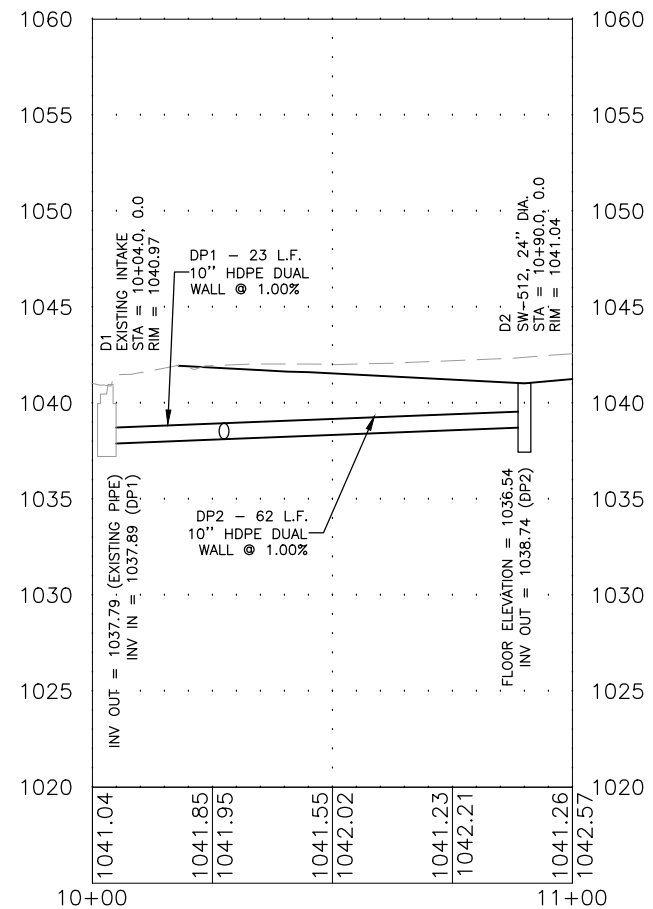
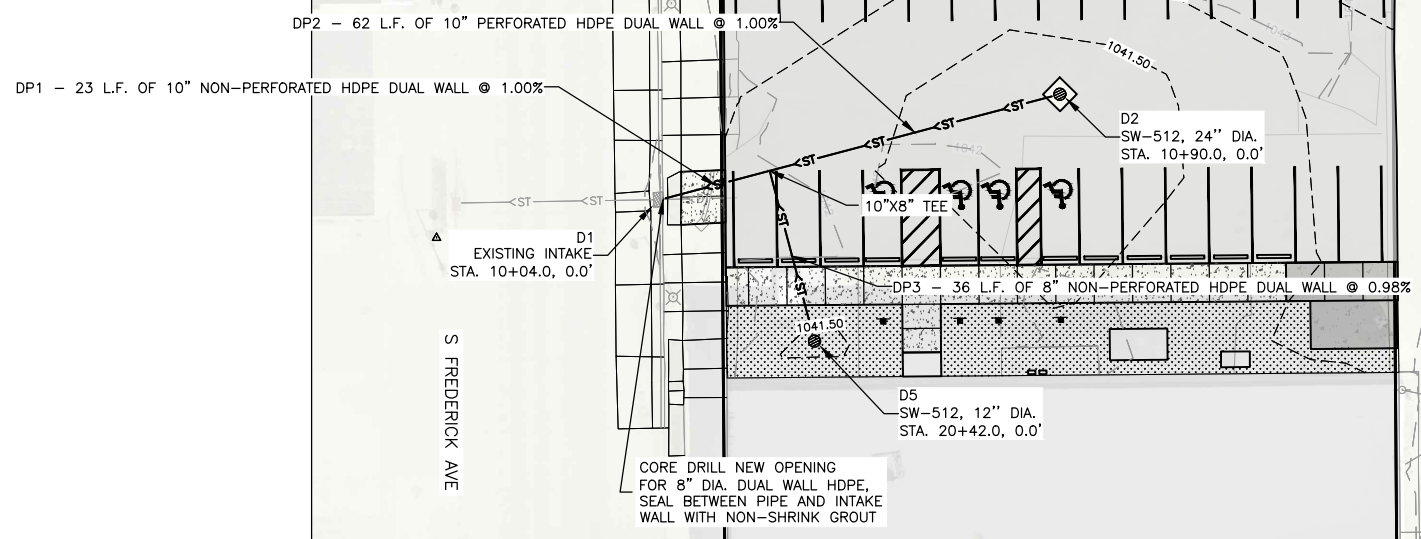

FEHR GRAHAM
 ENGINEERING & ENVIRONMENTAL

ILLINOIS
 IOWA
 WISCONSIN

OWNER/DEVELOPER:
 CITY OF OELWEIN
 20 2ND AVE. SW
 OELWEIN, IOWA 50662

PROJECT AND LOCATION:
 OELWEIN EVENT CENTER PARKING
 LOT IMPROVEMENTS
 OELWEIN, IOWA

DRAWN BY: LTF
 APPROVED BY: JSB
 DATE: JULY 2023
 SCALE: AS NOTED

REVISIONS		
REV. NO.	DESCRIPTION	DATE

DRAWING:
 NORTH PARKING LOT STORMWATER PLAN &
 PROFILE

SET TYPE: **BID SET**
 G:\C30\23\23-500\Plans\23-500 Plans.dwg, M.01

JOB NUMBER:
 23-500

SHEET NUMBER:
 M.01

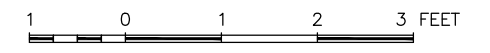
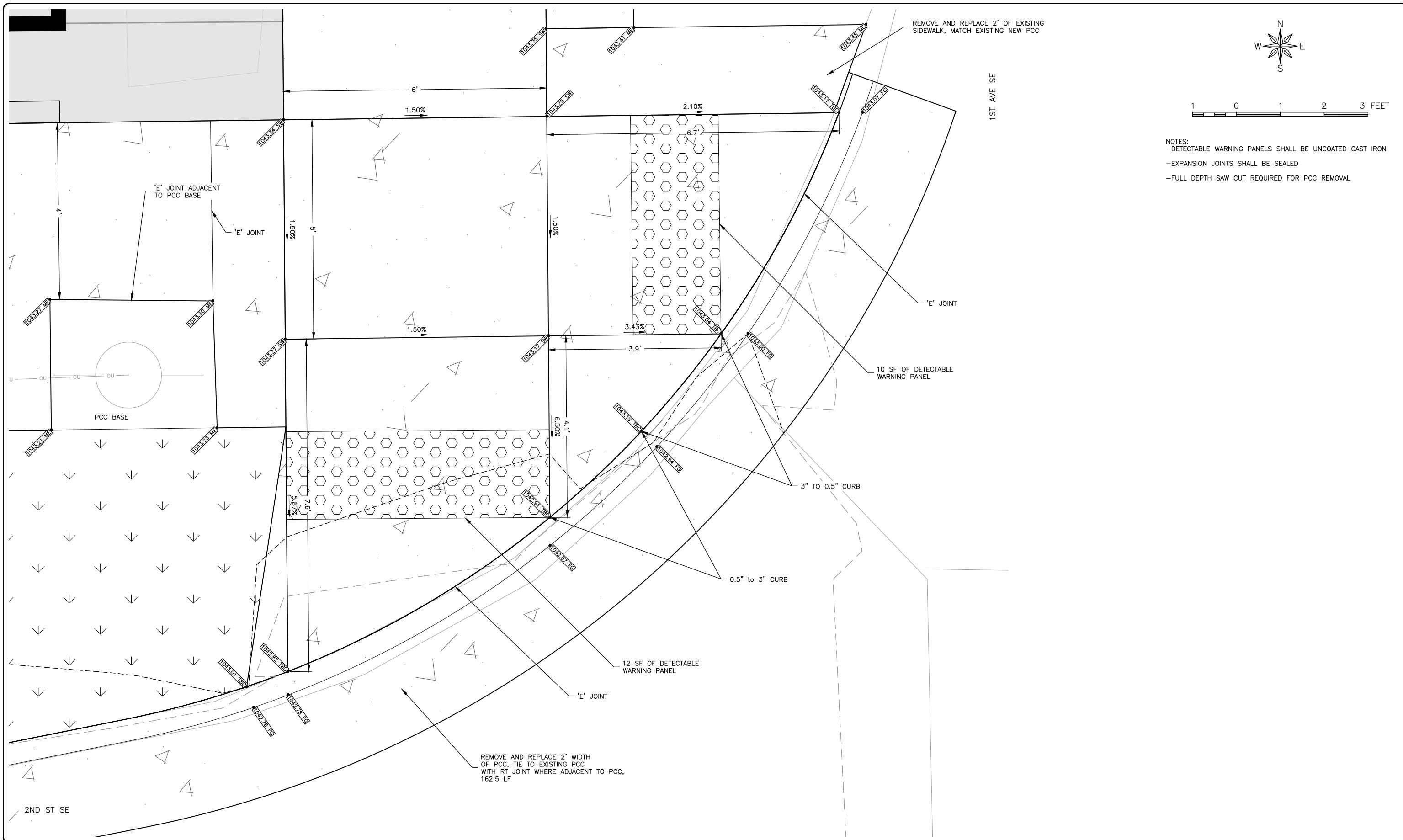

- NOTES:
- DETECTABLE WARNING PANELS SHALL BE UNCOATED CAST IRON
 - EXPANSION JOINTS SHALL BE SEALED
 - FULL DEPTH SAW CUT REQUIRED FOR PCC REMOVAL

FEHR GRAHAM
ENGINEERING & ENVIRONMENTAL

ILLINOIS
IOWA
WISCONSIN

OWNER/DEVELOPER:
CITY OF OELWEIN
20 2ND AVE. SW
OELWEIN, IOWA 50662

PROJECT AND LOCATION:
OELWEIN EVENT CENTER PARKING
LOT IMPROVEMENTS
OELWEIN, IOWA

DRAWN BY: LTF
APPROVED BY: JSB
DATE: JULY 2023
SCALE: AS NOTED

REVISIONS		
REV. NO.	DESCRIPTION	DATE

DRAWING:
SIDEWALK PLAN

SET TYPE: **BID SET**
G:\C30\23\23-500\Plans\23-500 Plans.dwg, S.01

JOB NUMBER:
23-500

SHEET NUMBER:
S.01