



NOT TO SCALE

Fire Circulation Drive

EXHIBIT A



OCEANS NORMAN  
NRHS PORTER HEALTH VILLAGE  
NORMAN, OK

**SMC**  
SMC Consulting Engineers, P.C.  
815 West Main - Oklahoma City, OK 73106  
PH: 405-232-7715 Fax: 405-232-7859

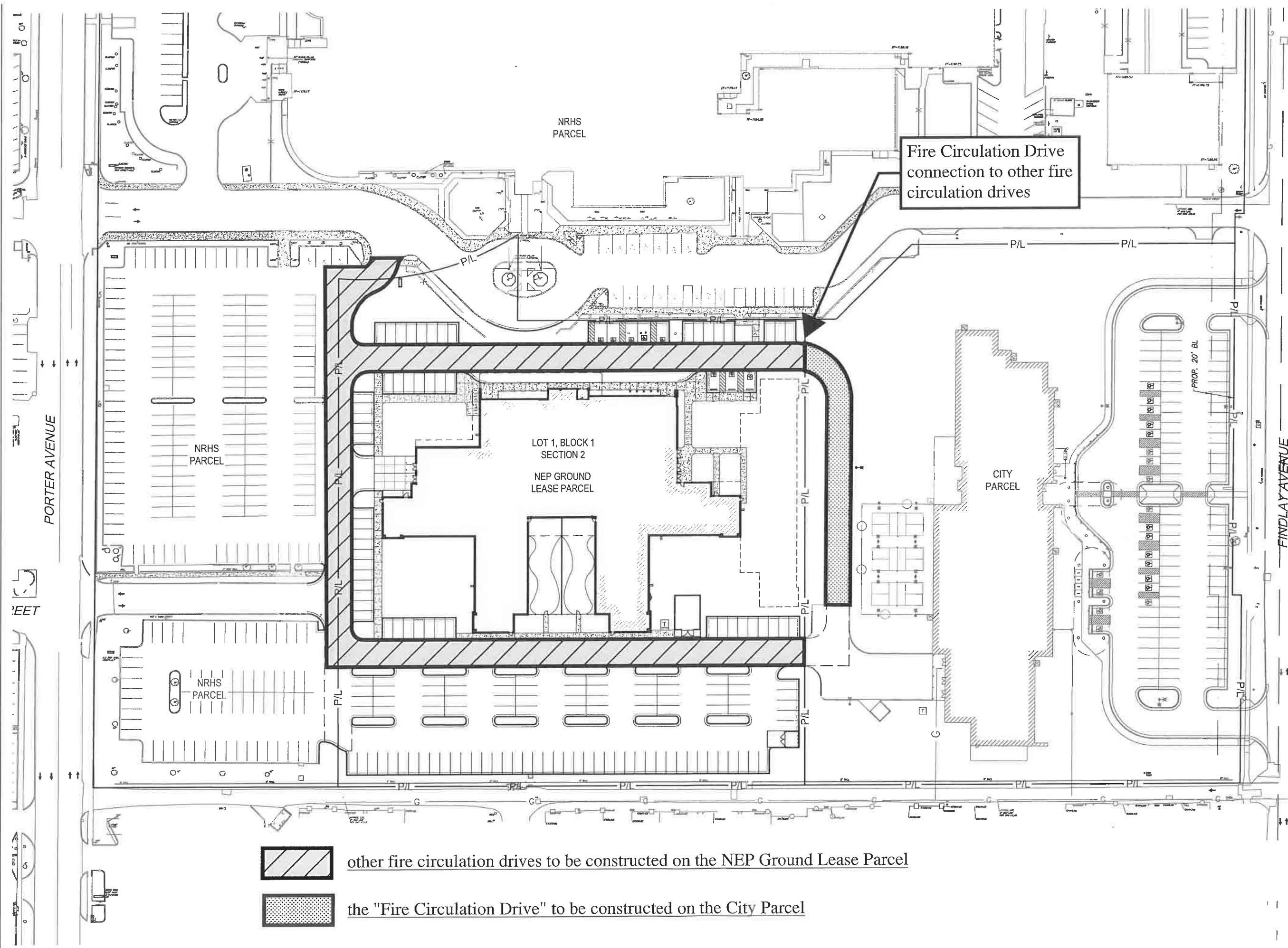
SMC PROJECT NO. 6437.00  
DATE: NOV. 28, 2022



Fire Circulation Drive connection to other fire circulation drives

-  other fire circulation drives to be constructed on the NEP Ground Lease Parcel
-  the "Fire Circulation Drive" to be constructed on the City Parcel

PORTER AVENUE

FINDLAY AVENUE

LOT 1, BLOCK 1  
SECTION 2  
NEP GROUND  
LEASE PARCEL

NRHS  
PARCEL

NRHS  
PARCEL

NRHS  
PARCEL

CITY  
PARCEL

PROP. 20' BL

FEET

0 1