

ALTA/NSPS LAND TITLE SURVEY
318 E. COMANCHE STREET
Norman, Cleveland County, Oklahoma



TOPOGRAPHIC LEGEND

- AIR CONDITIONER UNIT
- LIGHT POLE
- POWER POLE
- ELECTRIC RISER
- GAS VALVE
- SPRINKLER HEAD
- SPRINKLER VALVE
- FIRE HYDRANT
- WATER METER
- WATER VALVE BOX
- SANITARY SEWER MANHOLE
- SANITARY SEWER CLEANOUT
- SANITARY SEWER LAMPHOLE
- ROOF DRAIN
- GUARD POST
- SIGN
- ELECTRIC UNDERGROUND LINE
- OVERHEAD ELECTRIC LINE
- SANITARY SEWER LINE
- WATER LINE
- GAS LINE
- STORM DRAIN LINE
- CURB AND GUTTER
- CONCRETE
- ASPHALT
- GRAVEL
- BRICK

SCHEDULE B-II

The following items refer to Chicago Title Insurance Co.
Title Commitment No. 710702000931
Effective Date: September 16, 2020 at 7:00 AM
1.-8. NOT SURVEY MATTERS

SURVEYOR'S CERTIFICATE

To:
-Liberty National Bank and Trust company of Oklahoma City
-Chicago Title Oklahoma Co.
-Chicago Title Insurance Company

I, Matt C. Barnum, a Registered Professional Land Surveyor, do hereby certify to the aforesaid parties, as of the date set forth above that I or others under my direct supervision, have made a careful survey of a tract of land described as follows:
Lots Ten (10), Eleven (11), Twelve (12), Thirteen (13), Fourteen (14), Fifteen (15), and Sixteen (16), in Block Twenty-four (24), of the ORIGINAL TOWN OF NORMAN, Cleveland County, Oklahoma, according to the recorded plat thereof.

- This is to certify that this map or plat and the survey on which it is based were made in accordance with the 2016 Minimum Standard Detail Requirements for ALTA/NSPS Land Title Surveys, jointly established and adopted by ALTA and NSPS, and includes Items 1, 2, 4, 8, 9, 11 and 20, of Table A thereof. The fieldwork was completed on December 14, 2020.
- This survey meets or exceeds the requirements set forth by the "Oklahoma Minimum Standards for the Practice of Land Surveying" as adopted by the Oklahoma State Board of Licensure for Professional Engineers and Land Surveyors
- Issuing a new Title Policy or a re-dating of an existing policy which references this map and survey without the benefit of an update of said survey by Lemke Land Surveying shall terminate any liability expressed or implied hereon

TABLE 'A' NOTES

- As Shown on Survey Drawings.
- The physical address of property is 318 E. Comanche Street, Norman, OK 73069.
- The property described hereon contains 0.56 acres, more or less.
- As Shown on Survey Drawings.
- No Parking Spaces were observed at the time of this Survey.
- As Shown on Survey Drawings.
- Lemke Land Surveying carries and keeps current a Professional Liability Insurance Policy.

UTILITY WARNING:
The underground utilities shown have been located from record documents or field locations by the operator. The surveyor makes no guarantee that the underground utilities shown comprise all such utilities in the area either in service or abandoned. The surveyor further does not warrant that the underground utilities shown are in the exact location indicated although the surveyor does certify that they are located as accurately as possible from the information available. The surveyor has not physically located the underground utilities.
Utility elevations and sizes may have been measured under adverse field conditions. Upon exposing the utility, elevations and line sizes should be verified by the contractor prior to construction. Contractor should verify critical elevations using the benchmark provided by the surveyor or engineer. Any discrepancies should be immediately brought to the engineer's and surveyor's attention.
Call OKIE Ticket Nos. 20121214230124

MEMBERS NOTIFIED:
S00376 USIC/Cox Comm/OKC S00376
S00444 USIC/ONG/West OK S00444
T09079 Norman City of T09079
S00442 USIC/OG&E OKC METRO S00442
T11158 AT&T Distribution T11158

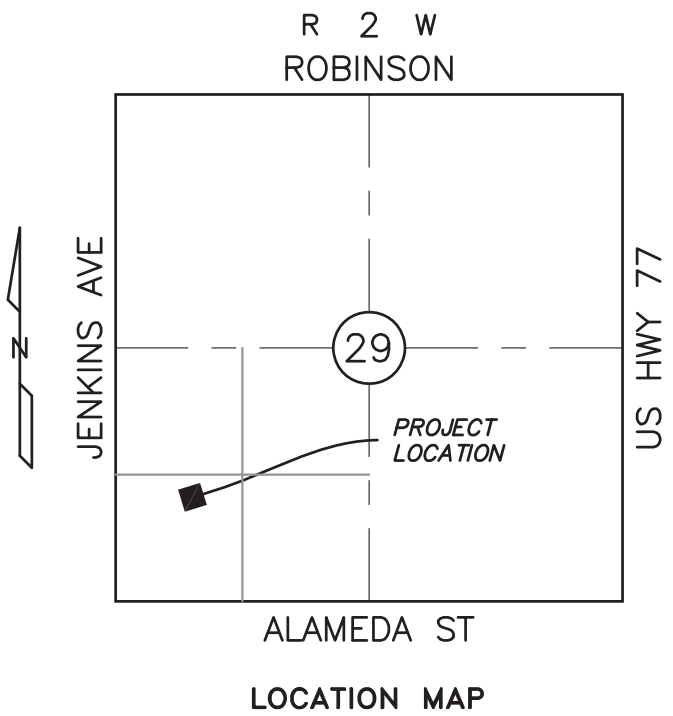
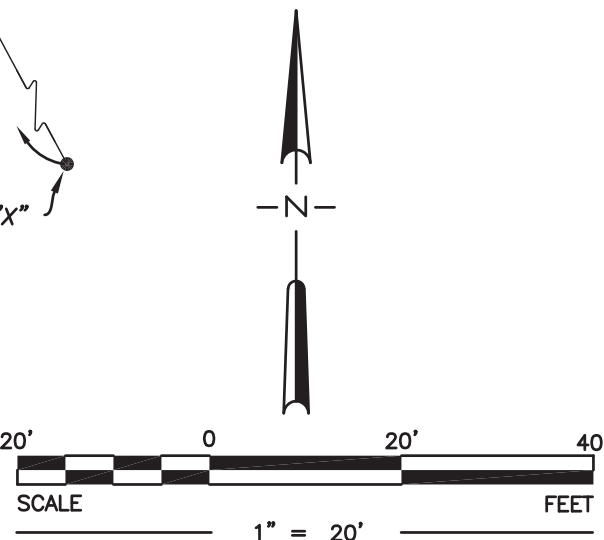

MATT C. BARNUM, P.L.S. NO. 1742
DATED: 12/23/2020

LEMKE LAND SURVEYING
3328 WEST COMANCHE STREET
NORMAN, OK 73069
PH: (405) 366-8541 FAX: (405) 366-8540
CA # 6975 http://www.lemke-ls.com

| Surveyed By: | PR/RT | SA | MB |
|--------------|-------|-------------|----|
| Drawn By: | | | |
| Approved By: | | | |
| Date: | | 12/22/2020 | |
| Scale: | | 1" = 20' | |
| Project No: | | 01651520.00 | |

ALTA/NSPS LAND TITLE SURVEY

318 E. COMANCHE STREET
CITY OF NORMAN, CLEVELAND COUNTY, OKLAHOMA

CITY OF NORMAN
P.O. BOX 370, NORMAN OK 73070

Sheet Number
1

Sheet 1 of 1