

**Total Front Yard Area - 25' x 50' - Total 1250sqft**

**Max Front Yard Coverage - 50% of 1250sqft = 625sqft**

**Current Front Yard Coverage - 367sqft**

**Additional Coverage with Proposed Paving - 138sqft**

**Total Front Yard Coverage - After Additional Paving - 505sqft**

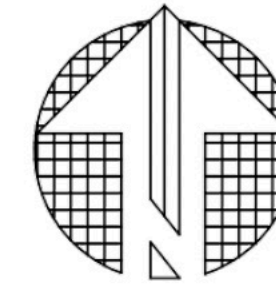

SCALE: 1"=20'

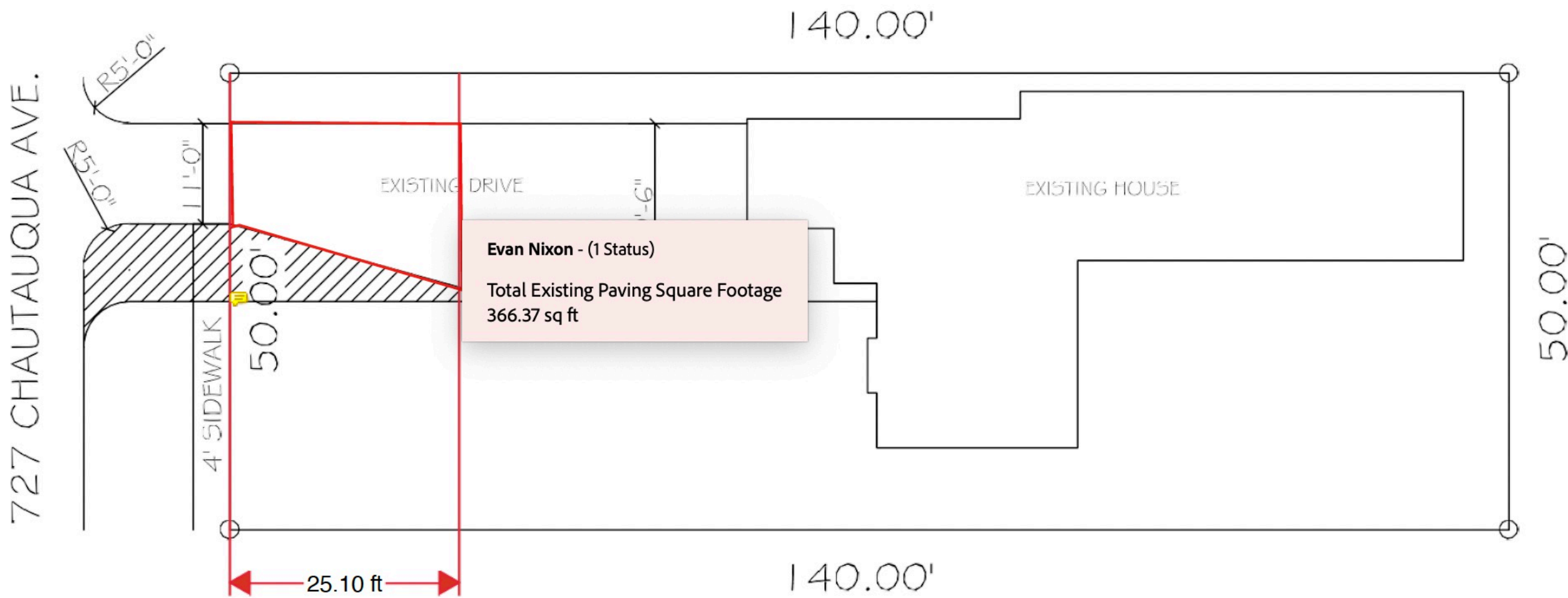

 NEW ADDITIONAL DRIVE AND APPROACH

THIS DOCUMENT IS THE PROPERTY OF PREFERRED PLANS, INC. IT IS TO BE USED ONLY FOR THE PROJECT AND SITE SPECIFICALLY IDENTIFIED HEREIN. ANY REUSE OR MODIFICATION OF THIS DOCUMENT WITHOUT THE WRITTEN CONSENT OF PREFERRED PLANS, INC. IS STRICTLY PROHIBITED.

DATE: 12/31/2023  
SCALE: AS SHOWN

**Evan Nixon**  
2024-10-09 16:11:37  
25.10 ft

727 26TH AVE NW STE. 201  
NORWALK, OR 97162  
TEL: 503-447-8999  
www.preferredplans.us



PLOT PLAN  
1

727 CHAUTAUQUA AVE.

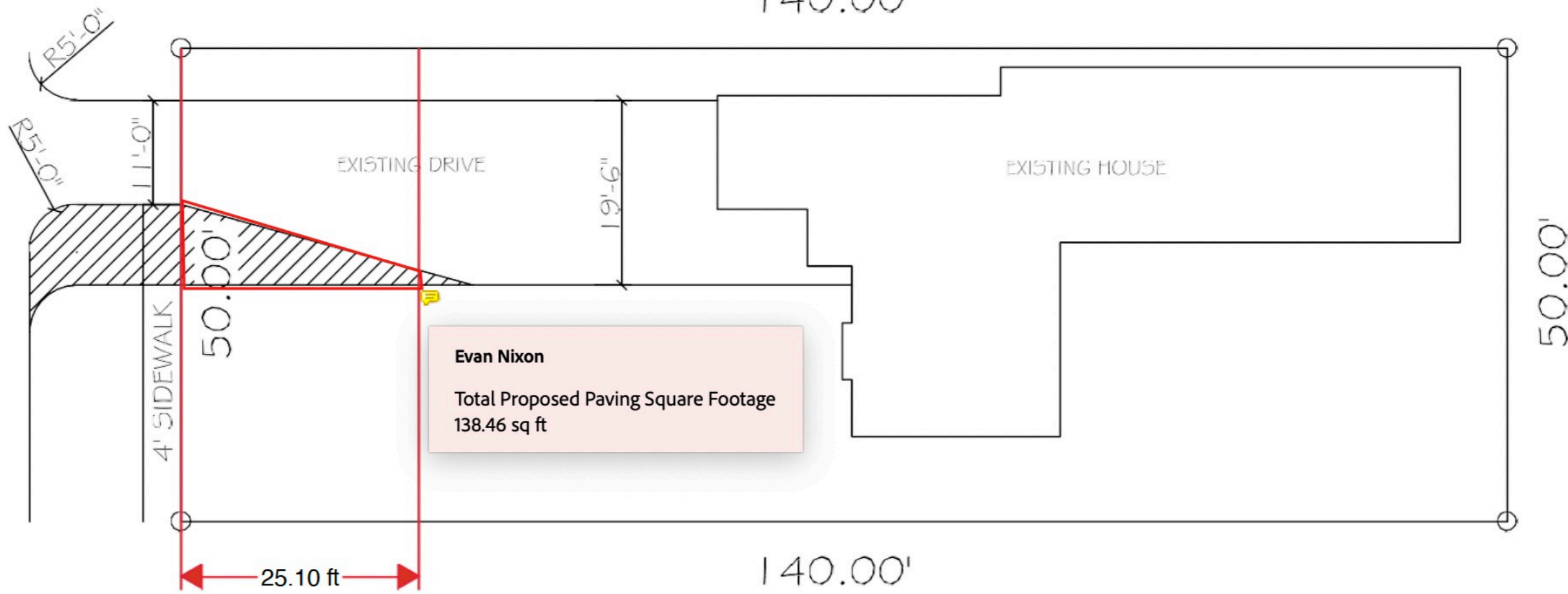

 NEW ADDITIONAL DRIVE AND APPROACH

**Evan Nixon**  
Total Proposed Paving Square Footage  
138.46 sq ft

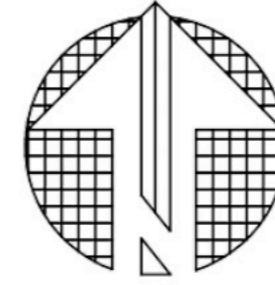

SCALE: 1"=20'

ALL DIMENSIONS SHALL BE TO FACE UNLESS OTHERWISE NOTED. THIS PLAN IS FOR INFORMATION ONLY AND DOES NOT CONSTITUTE A CONTRACT. THE CLIENT IS RESPONSIBLE FOR OBTAINING ALL NECESSARY PERMITS AND APPROVALS FROM THE LOCAL GOVERNMENT. THE CLIENT SHALL BE RESPONSIBLE FOR OBTAINING ALL NECESSARY PERMITS AND APPROVALS FROM THE LOCAL GOVERNMENT.

DATE: 12/8/2023

SCALE: AS SHOWN

**Evan Nixon**  
2024-10-09 16:11:37

---

25.10 ft

727 26TH AVE NW STE. 201  
NORWALK, OR 97162  
TEL.: 503-447-6999  
www.preferredplans.net



PLOT PLAN  
1