

LEGEND

	EXISTING 1' CONTOUR		PROP. WHEEL STOP
	EXISTING 5' CONTOUR		PROP. FES
	PROPOSED 1' CONTOUR		PROP. HC RAMP
	PROPOSED 5' CONTOUR		PROP. POWER POLE
	BOUNDARY LINE		PROP. SS MANHOLE
	RIGHT OF WAY LINE		PROP. GAS METER
	EASEMENT LINE		PROP. SIGN
	EXISTING CURB AND GUTTER		PROP. FIRE ROUTE SIGN
	PROPOSED CURB AND GUTTER		PROP. INLETS (SEE GRADING PLAN FOR TYPE)
	OVERHEAD ELECTRIC LINE		VERTICAL SEPARATION REQUIREMENT
	UNDERGROUND ELECTRIC LINE		NOTE: REFER TO SURVEYING LEGEND FOR EXISTING STRUCTURES IDENTIFICATION
	GAS LINE		
	UNDERGROUND TELEPHONE LINE		
	UNDERGROUND FIBER OPTIC LINE		
	SANITARY SEWER LINE		
	WATERLINE		
	RETAINING WALL		
	SCREEN WALL		
	WIRE FENCE		
	CHAIN LINK FENCE		
	BENCHMARK		
	PROP. FIRE HYDRANT		
	PROP. WATER VALVE		
	PROP. WATER METER		
	PROP. ELECT. METER		
	PROP. LIGHT POLE		
	PROP. BOLLARD		
	PROP. TRANSFORMER		
	PROP. PARKING COUNT		

NOTE: CONTRACTOR IS RESPONSIBLE FOR ENSURING THAT ALL PROPOSED WORK MEETS ADA REQUIREMENTS. REFER TO www.access-board.gov/ada-aba/ada-standards-doj.cfm

NOTE: CONTRACTOR SHALL CONSTRUCT AND INSTALL WHEEL STOPS, SIGNS, AND ADA RAMPS AT ALL HANDICAP SPACES.

SITE NOTES

- A. CONTRACTOR SHALL REFER TO THE CONSTRUCTION DOCUMENTS INCLUDING BUT NOT LIMITED TO THE WRITTEN SPECIFICATIONS, CONSTRUCTION DRAWINGS, STORM WATER POLLUTION PLAN, AND GEOTECHNICAL REPORT.
- B. ALL CONSTRUCTION SHALL BE IN STRICT ACCORDANCE WITH THE OWNERS DESIGN GUIDELINES AND SPECIFICATIONS, AND WHERE APPLICABLE SHALL MEET THE REQUIREMENTS OF THE GOVERNING/PERMITTING AUTHORITY HAVING JURISDICTION.
- C. CONTRACTOR IS RESPONSIBLE FOR THEIR OWN HORIZONTAL AND VERTICAL CONTROL, REFERENCE POINTS AND CONSTRUCTION STAKING AS INCIDENTAL TO THE PROJECT.
- D. THE CONTRACTOR SHALL FIELD VERIFY EXISTING ELEVATIONS/PROPERTY LINES/UTILITIES/DRAINAGE PRIOR TO CONSTRUCTION START.
- E. ALL WORK NOT CLASSIFIED AS A CONTRACT PAY ITEM SHALL BE CONSIDERED AS INCIDENTAL AND THE COST THEREOF SHALL BE INCLUDED IN THE UNIT PRICE BID FOR ITEMS WHICH ARE CLASSIFIED FOR PAYMENT.
- F. CONTRACTOR SHALL REFER TO THE ARCHITECTURAL AND MEP PLANS AND SPECIFICATIONS BEING A PART OF THE CONSTRUCTION DOCUMENTS FOR THE EXACT LOCATIONS AND DIMENSIONS OF ENTRY, EXIT PORCHES, PRECISE BUILDING DIMENSIONS, EXACT BUILDING UTILITY ENTRANCE, AND DOWNSPOUT LOCATIONS/SPECIFICATIONS/DETAILS.
- G. ALL DIMENSIONS SHOWN ARE TO THE FACE OF CURB (FC) UNLESS OTHERWISE NOTED.
- H. PARKING LOT STRIPING SHALL BE 4" WIDE AND WHITE IN COLOR. HANDICAP PARKING STALLS STRIPING AND SIGNAGE SHALL BE IN STRICT ACCORDANCE WITH FEDERAL, STATE, AND LOCAL REQUIREMENTS.
- I. UNLESS OTHERWISE NOTED ALL RADII SHALL BE 3'.
- J. BUILDING DIMENSIONS ARE TO OUTSIDE OF MASONRY, UNLESS OTHERWISE SHOWN.
- K. CONTRACTOR SHALL REFER TO THE ARCHITECTURAL PLANS AND SPECIFICATIONS FOR ACTUAL LOCATION AND DETAILS OF ALL UTILITY ENTRANCES. CONTRACTOR SHALL COORDINATE INSTALLATION OF UTILITIES IN SUCH A MANNER AS TO AVOID CONFLICTS AND ASSURE PROPER DEPTHS ARE ACHIEVED, AS WELL AS COORDINATED WITH ANY UTILITY COMPANIES FOR APPROVED LOCATIONS AND SCHEDULING OF TIE-INS/CONNECTIONS TO THEIR FACILITIES.
- L. REFER TO ARCHITECTURE PLANS FOR SITE LIGHTING AND ELECTRICAL CONDUIT PLANS. POLE LOCATIONS ARE SHOWN ON THIS SHEET FOR REFERENCE ONLY. IT IS THE CONTRACTOR'S RESPONSIBILITY TO IDENTIFY AND ADJUST ANY CONSTRUCTED CONFLICTS WITH UNDERGROUND UTILITIES, SIDEWALKS, ETC.
- M. CHECK ARCHITECTURAL PLANS FOR EXACT DOWNSPOUT LOCATIONS.
- N. CONTRACTOR SHALL REFER TO LANDSCAPE AND IRRIGATION PLAN FOR LOCATION AND CONSTRUCTION DETAILS OF LANDSCAPING AND IRRIGATION.

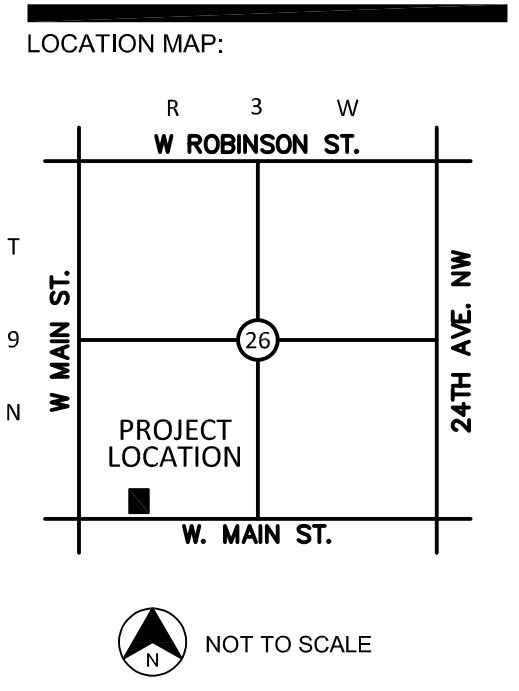

PROJECT:
DUNKIN DONUTS REPLAT
 NORMAN, OKLAHOMA
 PROJECT NUMBER: 24099
 DRAWING DATE: 12.30.24
 ISSUE DATE: 12.30.24

SEAL:
 SUBMITTAL:
PERMIT SET

REVISIONS:

MARK	DATE	DESCRIPTION

THESE PLANS AND DRAWINGS ARE NOT TO BE REPRODUCED, CHANGED OR COPIED IN ANY FORM OR MANNER WHATSOEVER WITHOUT FIRST OBTAINING THE WRITTEN PERMISSION AND CONSENT OF CEDAR CREEK CONSULTING INC. THIS SHEET IS NOT TO BE USED FOR CONSTRUCTION UNLESS THE ISSUE DATE IN THE TITLE BLOCK COINCIDES WITH OR POST DATES THE DRAWING DATE. ANY CHANGES MADE FROM THESE PLANS WITHOUT CONSENT OF CEDAR CREEK CONSULTING INC. ARE UNAUTHORIZED AND SHALL RELIEVE CEDAR CREEK CONSULTING OF RESPONSIBILITY FOR ALL CONSEQUENCES ARISING OUT OF SUCH CHANGES.

DRAWING TITLE:
OVERALL SITE PLAN
 SHEET:
C1.02

