

# POLLARD & WHITED SURVEYING, INC.

6901 72<sup>nd</sup> Avenue NE Norman, OK 73026  
office (405)366-0001  
tpollard@pwsurveying.com

May 21, 2026

**City Of Norman Planning Commission**  
and City of Norman Staff Members  
201 W. Gray  
Norman, OK 73070

**Re: Variance Request for proposed Certificate of Survey (COS) Subdivision**  
to be known as **"Nugent Estates"**  
in the SW1/4 of Sec.4,T8N,R1W, I.M.  
Norman, Cleveland County, Oklahoma

## To all interested parties,

An application has been submitted to the City of Norman Staff for **"Nugent Estates"**. The proposed subdivision is located in the SW1/4 of Section 4, T8N, R1W. The location can be generally described as: Located on the East side of 84<sup>th</sup> Avenue SE approximately 3 tenths of a mile (1650') North of State Highway 9 in Norman.

This letter is a request for variance of the proposed COS Subdivision to be known as **"Nugent Estates"** to the City of Norman, Cleveland County, Oklahoma. The applicant is asking the City of Norman to allow them to vary from the full Twenty (20) foot width and to construct a private road of a minimum of Twelve (12) foot width.

**"Nugent Estates"** will consist of only Three (3) residential tracts. Each tract will be accessed by a private road easement to be known as "McGregor Lane". McGregor will originate on 84<sup>th</sup> Avenue SE and extend East to access each of the tracts. Only Three (3) tracts will be served by this private drive and the Applicants would request a variance be granted to allow this private drive to only be Twelve (12) feet wide.

If you have any questions or concerns about this request, please call me at my office (405)366-0001, mobile (405)443-8100, or you can email me at tpollard@pwsurveying.com.

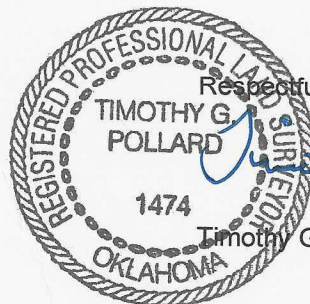

Respectfully,

Timothy G. Pollard, PLS