

**EASEMENT DESCRIPTION: (VARIABLE WIDTH EASEMENT IN PART OF THE NW/4)**

A strip, piece or parcel of land being variable in width lying on a tract of land recorded in Book 4231, Page 516 and being a part of the Northwest Quarter (NW/4) of Section Eleven (11), Township Nine (9) North, Range Three (3) West of the Indian Meridian, Cleveland County, Oklahoma, being more particularly described as follows:

Beginning at the Southwest corner of said NW/4; Thence N00°11'10"E on the West line of said NW/4, a distance of 2229.43 feet; Thence N22°17'02"E, a distance of 443.83 feet to a point on the North Line of said NW/4; Thence N89°20'20"E, on said North Line, a distance of 108.59 feet; Thence S22°17'02"W, a distance of 493.03 feet; Thence S01°22'26"W, a distance of 175.55 feet; Thence S00°02'23"E, a distance of 193.77 feet; Thence S00°08'09"E, a distance of 467.83 feet; Thence S00°07'43"E, a distance of 399.29 feet; Thence S00°09'03"E, a distance of 390.20 feet; Thence S00°12'57"E, a distance of 383.41 feet; Thence S00°11'52"E, a distance of 174.00 feet to a point on the South Line of said NW/4; Thence S89°12'19"W, on said South Line, a distance of 83.70 feet to the Point of Beginning.

Containing 5.34 acres more or less.

**BASIS OF BEARING:**

Per provided description, the Basis of Bearing is Grid, NAD-83, Oklahoma South Zone, U.S. Feet. The Reference Bearing is the North line of the NW/4 of said Section 11, taken to bear N89°20'20"E as shown hereon.



**Surveyor's Certificate:**

I, Jay Washburn, Oklahoma Licensed Professional Land Surveyor, No. 1707, do hereby certify that this plat of survey meets the Oklahoma Minimum Standards for the practice of land surveying as adopted by the Oklahoma State Board of Licensure for Professional Engineers and Land Surveyors.

  
Jay Washburn, PLS

03/03/2020  
Date:

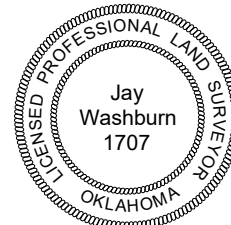

**CookPLS National, Inc**

8213 Glade Ave. Oklahoma City, OK 73132  
918-869-6398  
Ok CA# 8035 exp. 06-30-2020

Client: WESTERN FARMERS ELECTRIC COOP

Date: AN 2/2/2020

Checked: JW 3/3/2020

Drafted: JGW 3/3/2020

Scale: 1" = 500'