

TRAFFIC SIGNAL LEGEND

EXISTING	PROPOSED	DESCRIPTION
		TRAFFIC SIGNAL CONTROLLER
		ELEC. CONDUIT (SIZE NOTED ON PLANS)
		SIZE II PULL BOX
		SIZE II PULL BOX WITH APRON
		PULL BOX
		VEHICULAR SIGNAL HEAD WITH BACKPLATE
		PEDESTRIAN SIGNAL HEAD
		VIDEO DETECTION CAMERA
		OPTICAL DETECTOR SYMBOL
		PEDESTRIAN PUSH BUTTON
		MAST ARM MOUNTED SIGN
		PEDESTAL POLE
		SERVICE POLE
		MAST ARM WITH POLE AND LUMINAIRE
		SIGNAL HEAD NUMBER (SEE TABLE #1)
		VIDEO DETECTION AREA
		VIDEO DETECTION AREA

TABLE #2 MAST ARMS AND POLES

POLE	STATION	OFFSET	POLE TYPE	MAST ARM	FOOTING	MAST ARM SPACING (FROM C. OF POLE)
B	15+74	52' LT.	32' MH POLE	45' TS & 15' L.M.A.	S-55	19, 31, 40, 43
C	15+90	54' LT.	10' PED POLE	-	P-3	-
D	16+73	61' LT.	10' PED POLE	-	P-3	-
E	16+76	50' LT.	32' MH POLE	50' T.S. & 15' L.M.A.	S-55	19, 32, 40, 48
F	16+85	40' RT.	32' MH POLE	50' T.S. & 15' L.M.A.	S-55	10, 21, 34, 43, 46
G	16+66	56' RT.	10' PED POLE	-	P-3	-
H	15+92	57' RT.	32' MH POLE	40' T.S. & 15' L.M.A.	S-40	8, 22, 30, 28
I	15+74	40' RT.	10' PED POLE	-	P-3	-

GENERAL UTILITY NOTES:

1. THE CONTRACTOR SHALL FIELD VERIFY ALL EXISTING UTILITIES PRIOR TO BEGINNING CONSTRUCTION. IF CONFLICTS ARE DISCOVERED, THE CONTRACTOR SHALL NOTIFY THE TRAFFIC ENGINEER IMMEDIATELY.
2. THE CONTRACTOR SHALL BE RESPONSIBLE FOR THE REPLACEMENT AND/OR REPAIR OF ALL PRIVATE AND PUBLIC UTILITIES DAMAGED DURING CONSTRUCTION.
3. THE CONTRACTOR SHALL POT-HOLE THE DEPTH OF ALL UTILITIES (INCLUDING SEWER) WITHIN TWO (2) FEET OF A TRAFFIC SIGNAL POLE FOOTING BEFORE STARTING ANY EXCAVATION OF THE SIGNAL POLE FOOTING(S).

NOTES:
1. VIDEO VEHICLE DETECTION WILL BE PROVIDED FOR THIS INTERSECTION. THE DETECTOR LOOPS SHOWN ON THE PAVEMENT ARE SHOWN ONLY TO DEPICT THE AREAS OF DETECTION FOR THE VIDEO.

2. CROSSWALKS NOT SHOWN FOR CLARITY. SEE STRIPING PLAN FOR DETAILS.

3. SIGNAL HEADS 3, 6 & 7 SHALL REMAIN BAGGED UNTIL EB APPROACH IS OPERATIONAL.

4. POWER FROM OG&E WILL ENTER NEW BREAKER BOX TO BE INSTALLED BY THE CONTRACTOR. CONTRACTOR WILL RUN POWER WIRE TO THE CABINET.

5. EXISTING CONDUITS TO BE ABANDONED.

TABLE #3 ELECTRICAL CABLE TO CONTROLLER "A" LOCATION

DESCRIPTION	REVISIONS	DATE
6	OKLA	

DESCRIPTION	REVISIONS	DATE

DESCRIPTION	REVISIONS	DATE

CABLE TERMINAL IDENTIFICATION CODE	
EXAMPLE: B - 12C/VC/OC	(VC) VIDEO CABLE
(B) SIGNAL POLE LOCATION	(OC) OPTICAL CABLE
(12C) TWELVE CONDUCTOR CABLE	

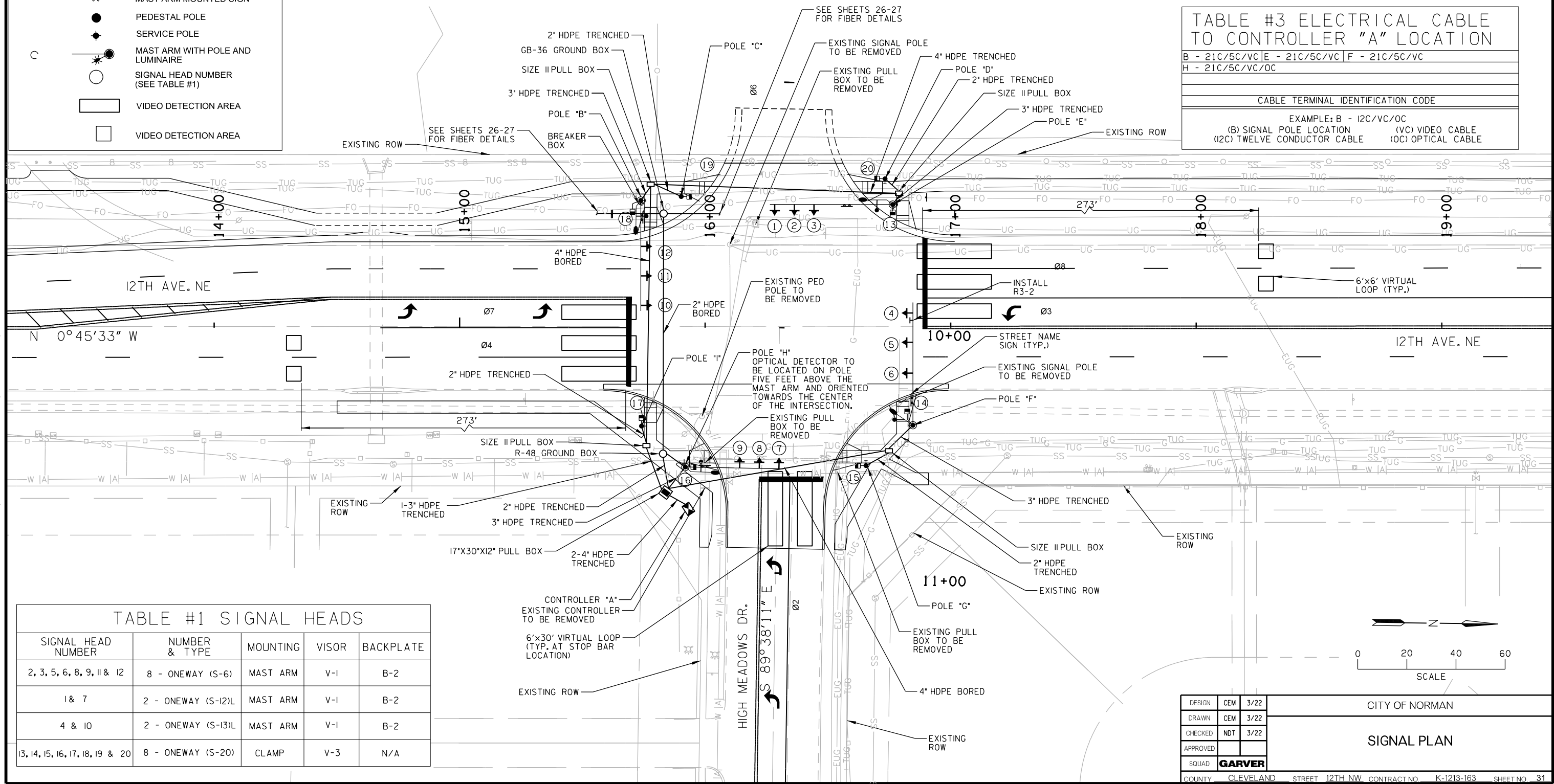
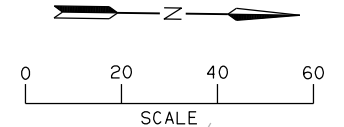

TABLE #1 SIGNAL HEADS

SIGNAL HEAD NUMBER	NUMBER & TYPE	MOUNTING	VISOR	BACKPLATE
2, 3, 5, 6, 8, 9, 11 & 12	8 - ONEWAY (S-6)	MAST ARM	V-1	B-2
1 & 7	2 - ONEWAY (S-12)L	MAST ARM	V-1	B-2
4 & 10	2 - ONEWAY (S-13)L	MAST ARM	V-1	B-2
13, 14, 15, 16, 17, 18, 19 & 20	8 - ONEWAY (S-20)	CLAMP	V-3	N/A



DESIGN	CEM	3/22	CITY OF NORMAN
DRAWN	CEM	3/22	
CHECKED	NDT	3/22	
APPROVED			
SQUAD	GARVER		

COUNTY	CLEVELAND	STREET	12TH NW	CONTRACT NO.	K-1213-163	SHEET NO.	31
--------	-----------	--------	---------	--------------	------------	-----------	----

5/20/2022 9:27:30 AM L:\2022\2017741 - 12th Avenue NE & High Meadows Drive\Drawings\2HM.SC.01.dgn