

GRANT OF EASEMENT

E-2425-41

KNOW ALL MEN BY THESE PRESENTS:

THAT, Cleveland County Land, Inc., in consideration of the sum of One Dollar (\$1.00), receipt of which is hereby acknowledged, and for and upon other good and valuable considerations, do hereby grant, bargain, sell, and convey unto the City of Norman, a municipal corporation, **a trail easement and right-of-way**, over, across, and under the following described real estate and premises situated in the City of Norman, Cleveland County, Oklahoma, to wit:

(Tract 6-20' Trail Easement)

A tract of land lying in the Southwest Quarter (SW/4) of Section Thirteen (13) Township Nine (9) North, Range Two (2) West of the Indian Meridian, Norman, Cleveland County, Oklahoma being more particularly described as follows:

COMMENCING at the northwest corner of said SW/4;

THENCE South 00°32'22" East, along the west line of said SW/4, a distance of 669.00 feet to the northwest corner of a tract of land described in WARRANTY DEED, recorded in Book 6757, Page 13, Cleveland County Clerk's Office;

THENCE North 89°26'17" East, along the north line of said WARRANTY DEED, a distance of 50.00 feet to the POINT OF BEGINNING;

THENCE continuing North 89°26'17" East, along said north line, a distance of 20.00 feet;

THENCE South 00°32'22" East, parallel with said west line, a distance of 457.88 feet, to a point on the south line of said WARRANTY DEED;

THENCE South 89°26'17" West, along said south line, a distance of 20.00 feet;

THENCE North 00°32'22" West, parallel with said west line, a distance of 457.88 feet to the POINT OF BEGINNING.

Said tract of land contains an area of 9,158 square feet or 0.2102 acres, more or less.

SEE ATTACHMENT "A" & "B" FOR LEGAL AND EXHIBIT

with the right of ingress and egress to and from the same, for the purpose of surveying, laying out, constructing, maintaining, and operating an easement as indicated below:

20' TRAIL EASEMENT

To have and to hold the same unto the said City, its successors, and assigns forever.

SIGNED and delivered this 22 day of May, 2025.

BY: _____

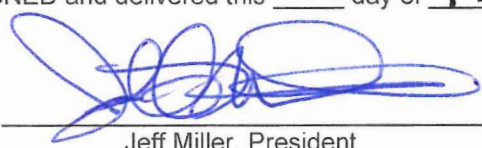

Jeff Miller, President

REPRESENTATIVE ACKNOWLEDGMENT

STATE OF OKLAHOMA,
COUNTY OF Cleveland ss:

Before me, the undersigned, a Notary Public in and for said County and State, on this 22 day of May, 2025 personally appeared Jeff Miller, to me known to be the identical person(s) who executed the foregoing grant of easement and acknowledged to me that he executed the same as his free and voluntary act and deed for the uses and purposes therein set forth.

WITNESS my hand and seal the day and year last above written.

My Commission Expires: 10/08/27

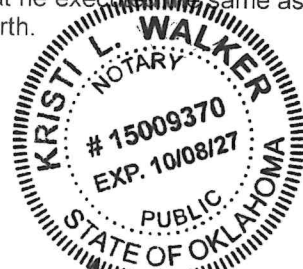

Kristi L. Walker
Notary Public

CITY ATTORNEY

Approved as to form and legality this 30 day of May, 2025.

Christina Luckala
City Attorney

NORMAN CITY COUNCIL

Approved and accepted by the Council of the City of Norman, this _____ day of _____, 2025.

Mayor

ATTEST:

City Clerk

SEAL:

ATTACHMENT "A"

LEGAL DESCRIPTION

Tract 6 - 20' Trail Easement

A tract of land lying in the Southwest Quarter (SW/4) of Section Thirteen (13) Township Nine (9) North, Range Two (2) West of the Indian Meridian, Norman, Cleveland County, Oklahoma being more particularly described as follows:

COMMENCING at the northwest corner of said SW/4;

THENCE South 00°32'22" East, along the west line of said SW/4, a distance of 669.00 feet to the northwest corner of a tract of land described in WARRANTY DEED, recorded in Book 6757, Page 13, Cleveland County Clerk's Office;

THENCE North 89°26'17" East, along the north line of said WARRANTY DEED, a distance of 50.00 feet to the POINT OF BEGINNING;

THENCE continuing North 89°26'17" East, along said north line, a distance of 20.00 feet;

THENCE South 00°32'22" East, parallel with said west line, a distance of 457.88 feet, to a point on the south line of said WARRANTY DEED;

THENCE South 89°26'17" West, along said south line, a distance of 20.00 feet;

THENCE North 00°32'22" West, parallel with said west line, a distance of 457.88 feet to the POINT OF BEGINNING.

Said tract of land contains an area of 9,158 square feet or 0.2102 acres, more or less.

The bearing of North 00°32'22" West as shown on the west line of the Southwest Quarter (SW/4) of Section 13, Township 9 North, Range 2 West, I.M., as established using the Oklahoma State Plane Coordinate System South Zone NAD83 (NSRS 2011), was used as the basis of bearing for this survey.

Prepared by:

Justin Smith, PLS No. 1868
Smith Roberts Baldischwiler, LLC
100 N.E. 5th Street
Oklahoma City, OK 73104
(405) 840-7094
Date: March 14, 2025

ATTACHMENT "B"

TRACT 6

20' TRAIL EASEMENT

P.O.C.

N.W. CORNER OF THE S.W. QUARTER
SEC. 13, T. 9 N., R. 2 W, I.M.
FND. BENT PK NAIL

33' STAT. R.O.W.

N. LINE OF THE S.W. QUARTER
SEC. 13, T. 9 N., R. 2 W, I.M.

THOUSAND HILLS HOLDINGS, LLC
BOOK 6757, PAGE 19 R 2 W

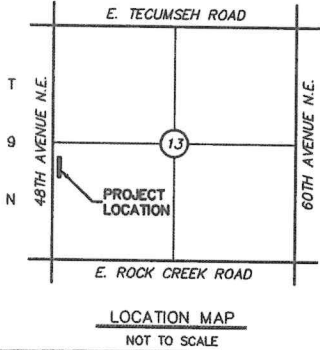

N 89°26'17" E 50.00'
P.O.B. N 89°26'17" E 20.00'

48TH AVENUE N.E.
(Public Road)

CLEVELAND COUNTY LAND, INC.
BOOK 6757, PAGE 13
TRACT 6

N 00°32'22" W 457.88'
S 00°32'22" E 457.88'
S 89°26'17" W 20.00'

(SEE ATTACHMENT "A" FOR LEGAL DESCRIPTION)

GENERAL NOTES:

1. The bearing of North 00°32'22" West as shown on the west line of the Southwest Quarter (SW/4) of Section 13, Township 9 North, Range 2 West, I.M., as established using the Oklahoma State Plane Coordinate System South Zone NAD83 (NSRS 2011), was used as the basis of bearing for this survey.

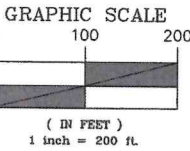
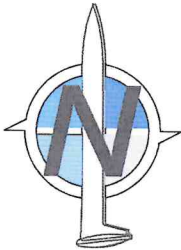

Project Number
117,940
Scale
1"=200'
Sheet No.
85 of 98



ENGINEERING
SURVEYING
PLANNING

OKLAHOMA CITY
100 N.E. 28th Street
Oklahoma City,
Oklahoma 73104
T: 405.840.7804
F: 405.840.9116
www.srbol.com

NORMAN
2500 McGee Drive
Suite 100
Norman, OK 73072
T: 405.418.2288
F: 405.418.2389
srb@srbol.com

CERTIFICATE OF AUTHORIZATION NO. 3949

File: Z:\117940\48TH AND ROCK CREEK RDU AND TRAIL EASEMENTS.DWG